

Plat  
of the

Griffin Ditch Extension

Jan 12. 1889

Range 8 Town 7.

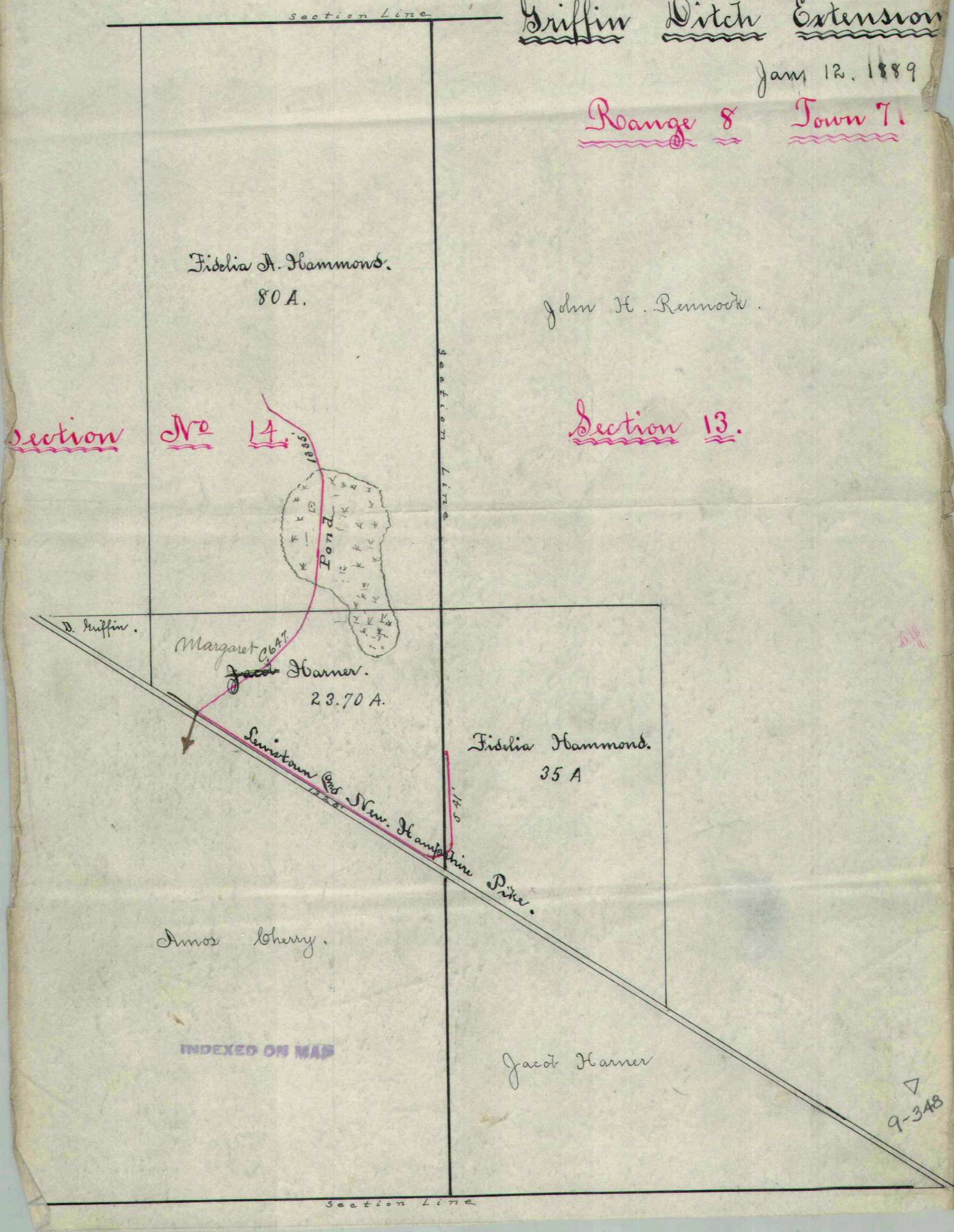

Fidelia A. Hammond.  
80 A.

John H. Remond.

Section 12

Section 13.

D. Huffin.

Margaret Abbott  
Jacob Hamner.  
23.70 A.

Fidelia Hammond.  
35 A

Amos Cherry.

INDEXED ON MAP

Jacob Hamner

9-348