

**BLOOMFIELD**

**TOWNSHIP**

**1966**

# BLOOMFIELD TOWNSHIP

## INDEX MAP

ORDER OF NUMBERS SECTION-TOWN-RANGE

SCALE 40 CHAINS TO THE INCH

CORRECTED TO:  
January 1, 1966  
JANUARY 1, 1967  
JANUARY 1, 1968  
JANUARY 1, 1969

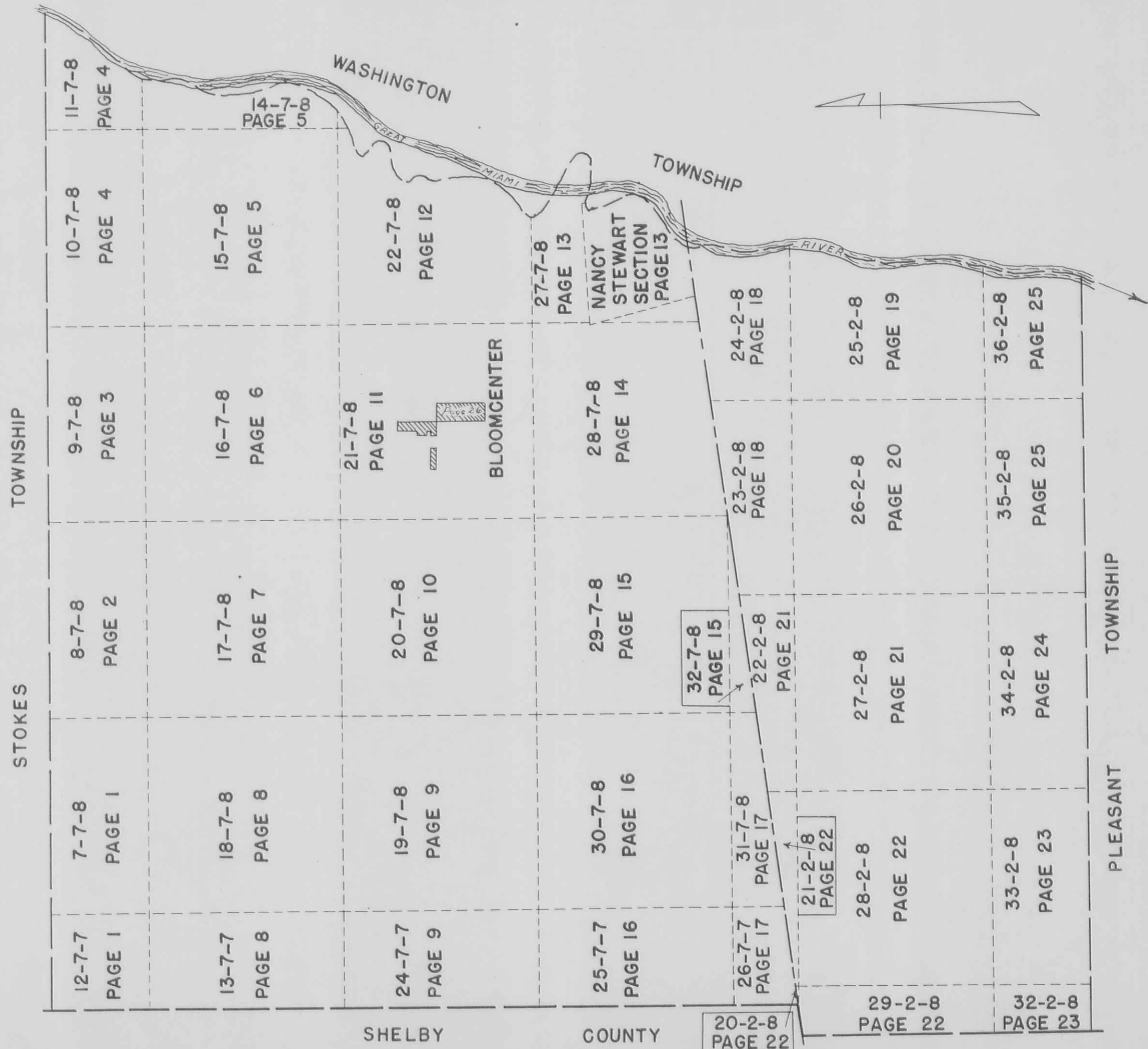

D. E. Gilbert  
Nov. 23, 1959

# BLOOMFIELD TOWNSHIP INDEX

	SECTION	TOWN	RANGE	PAGE
<p>TOWNS SOUTH OF LATITUDE 41</p> <p>RANGES EAST OF OHIO INDIANA LINE</p>	12	7	7	1
	13	7	7	8
	24	7	7	9
	25	7	7	16
	26	7	7	17
	7	7	8	1
	8	7	8	2
	9	7	8	3
	10	7	8	4
	11	7	8	4
	14	7	8	5
	15	7	8	5
	16	7	8	6
	17	7	8	7
	18	7	8	8
	19	7	8	9
20	7	8	10	
21	7	8	11	
22	7	8	12	
27	7	8	13	
NANCY STEWART	7	8	13	
28	7	8	14	
29	7	8	15	
30	7	8	16	
31	7	8	17	
32	7	8	15	
<p>TOWNS NORTH OF GREAT MIAMI RIVER</p> <p>RANGES EAST OF OHIO INDIANA LINE</p>	20	2	8	22
	21	2	8	22
	22	2	8	21
	23	2	8	18
	24	2	8	18
	25	2	8	19
	26	2	8	20
	27	2	8	21
	28	2	8	22
	29	2	8	22
	32	2	8	23
33	2	8	23	
34	2	8	24	
35	2	8	25	
36	2	8	25	
BLOOMCENTER				26

← 23 - 7 - 8 PAGE 12

BLOOMFIELD TOWNSHIP

SECTION 12 TOWN 7 S. RANGE 7 E.  
SECTION 7 TOWN 7 S. RANGE 8 E.

SCALE 10 CHAINS TO THE INCH

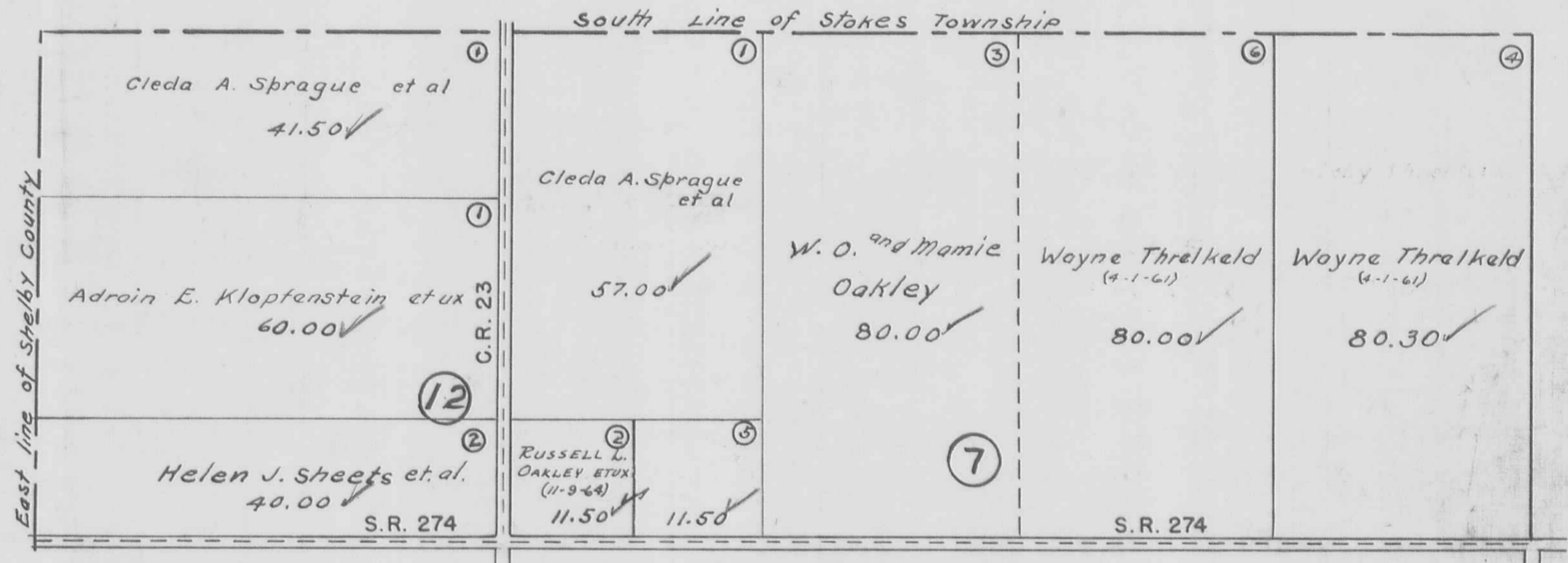

See Page 2

See Page 8

BLOOMFIELD TOWNSHIP  
SECTION 8 TOWN 7 S. RANGE 8 E.  
SCALE 10 CHAINS TO THE INCH

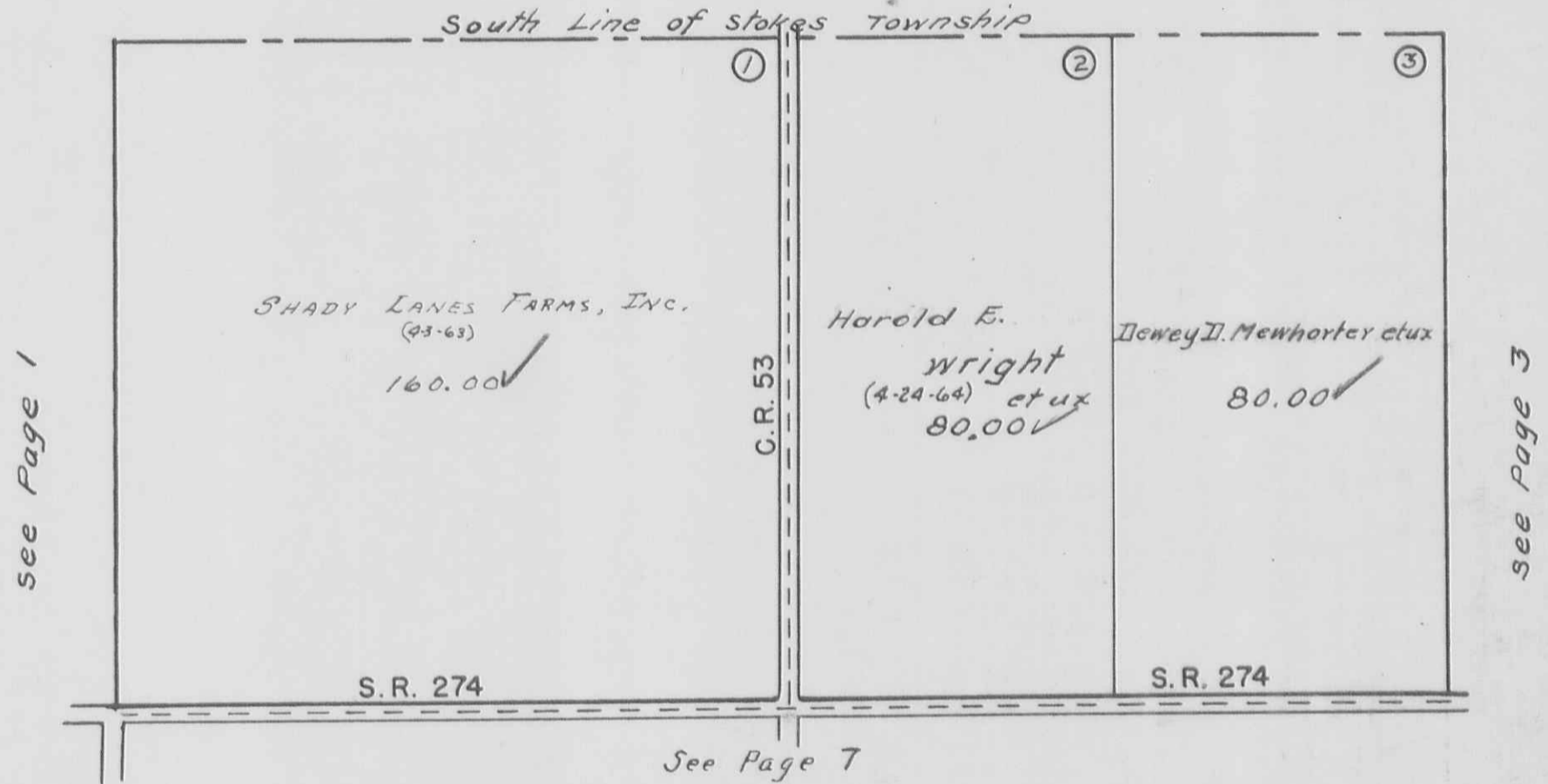

BLOOMFIELD TOWNSHIP

SECTION 9 TOWN 7 S. RANGE 8 E.

SCALE 10 CHAINS TO THE INCH

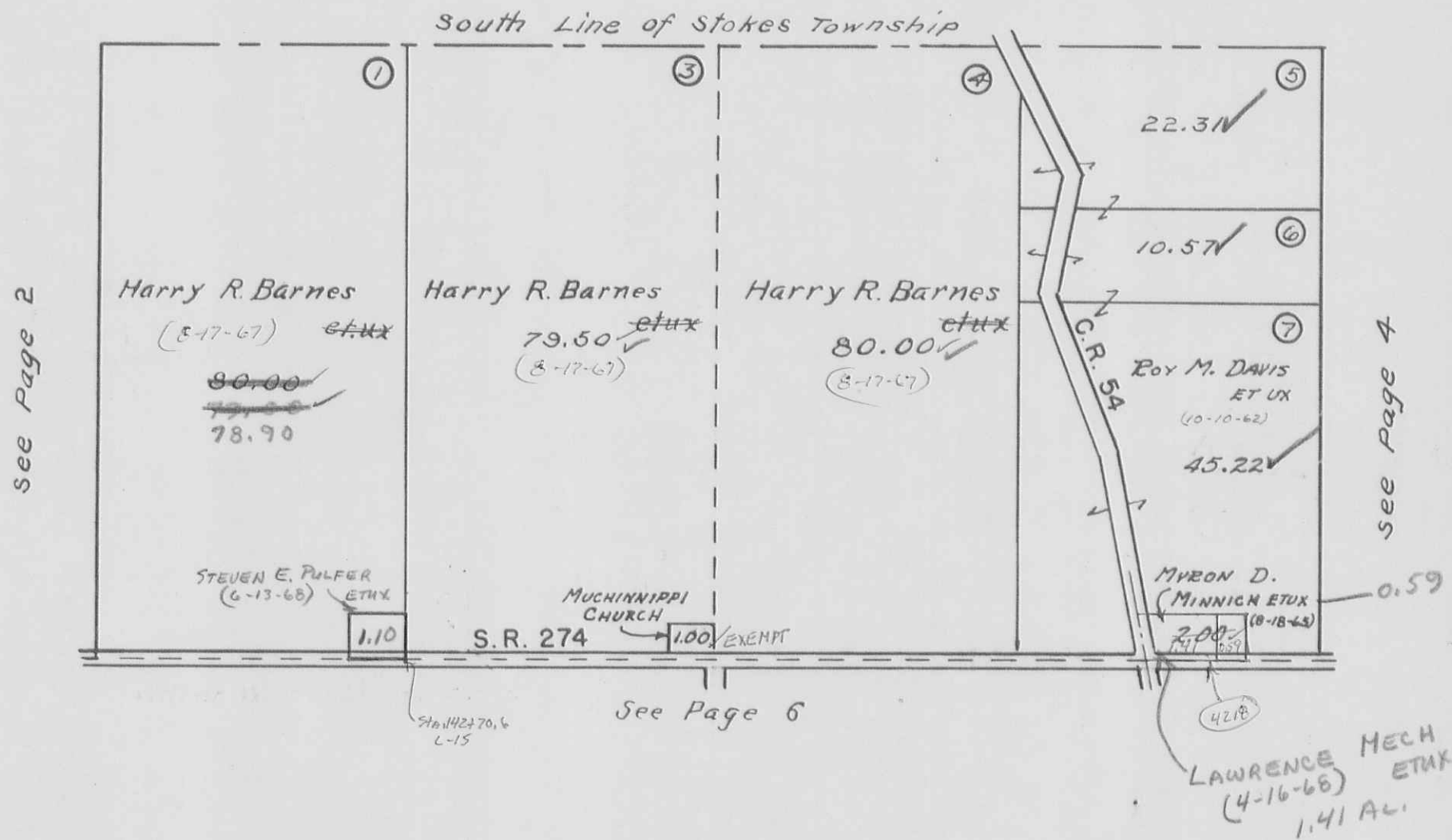

BLOOMFIELD TOWNSHIP

SECTION 10 TOWN 7 S. RANGE 8 E.

SECTION 11 TOWN 7 S. RANGE 8 E.

SCALE 10 CHAINS TO THE INCH

Handwritten notes: 27.25, 20.75, 58.00

see Page 3

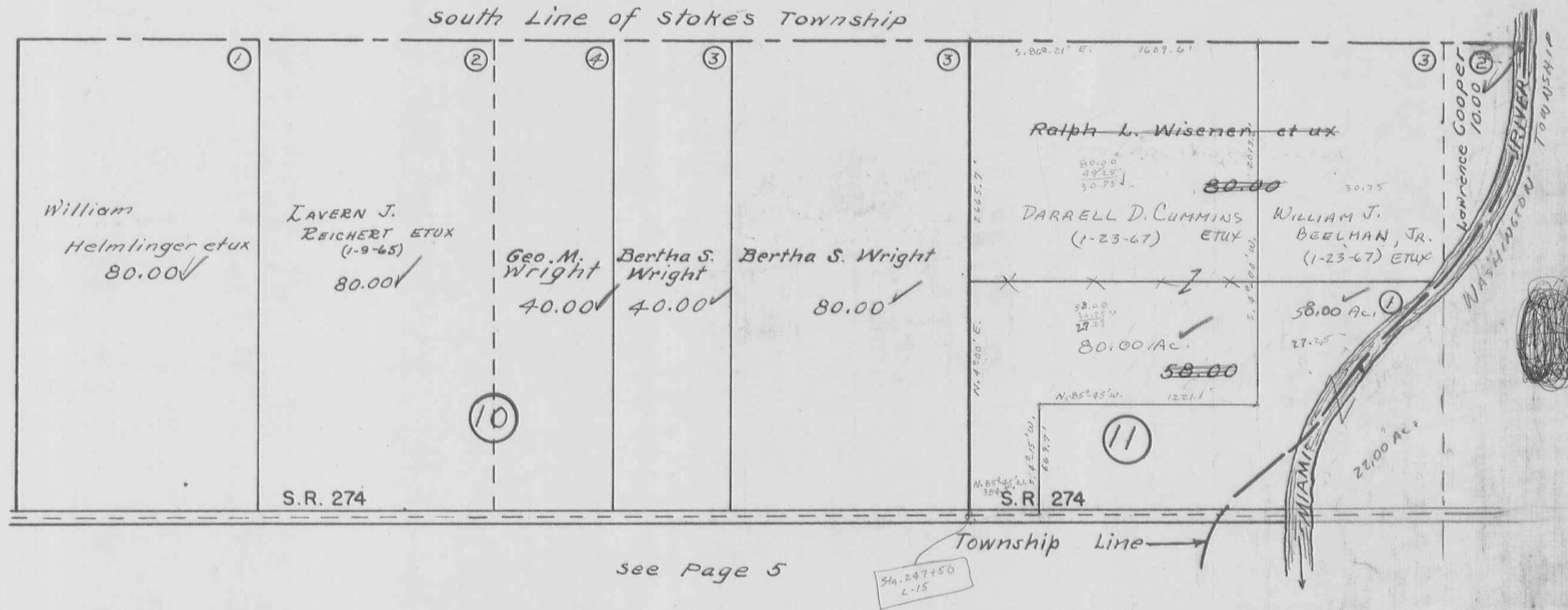

see Page 5

BLOOMFIELD TOWNSHIP

SECTION 14 TOWN 7 S. RANGE 8 E.  
SECTION 15 TOWN 7 S. RANGE 8 E.

SCALE 10 CHAINS TO THE INCH

See Page 4

S.R. 274

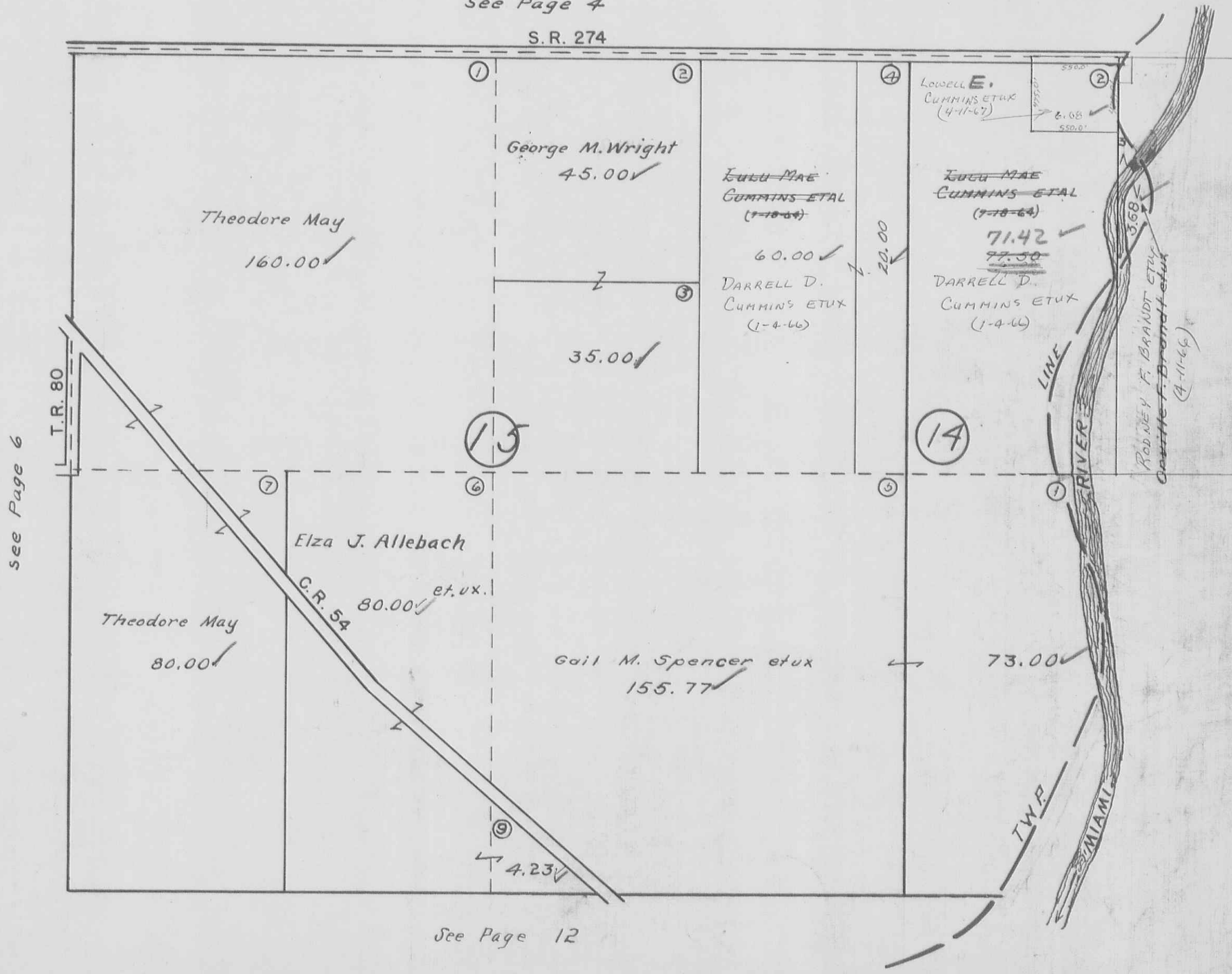

see Page 6

See Page 12



BLOOMFIELD TOWNSHIP  
SECTION 16 TOWN 7 S. RANGE 8 E.  
SCALE 10 CHAINS TO THE INCH

See Page 3

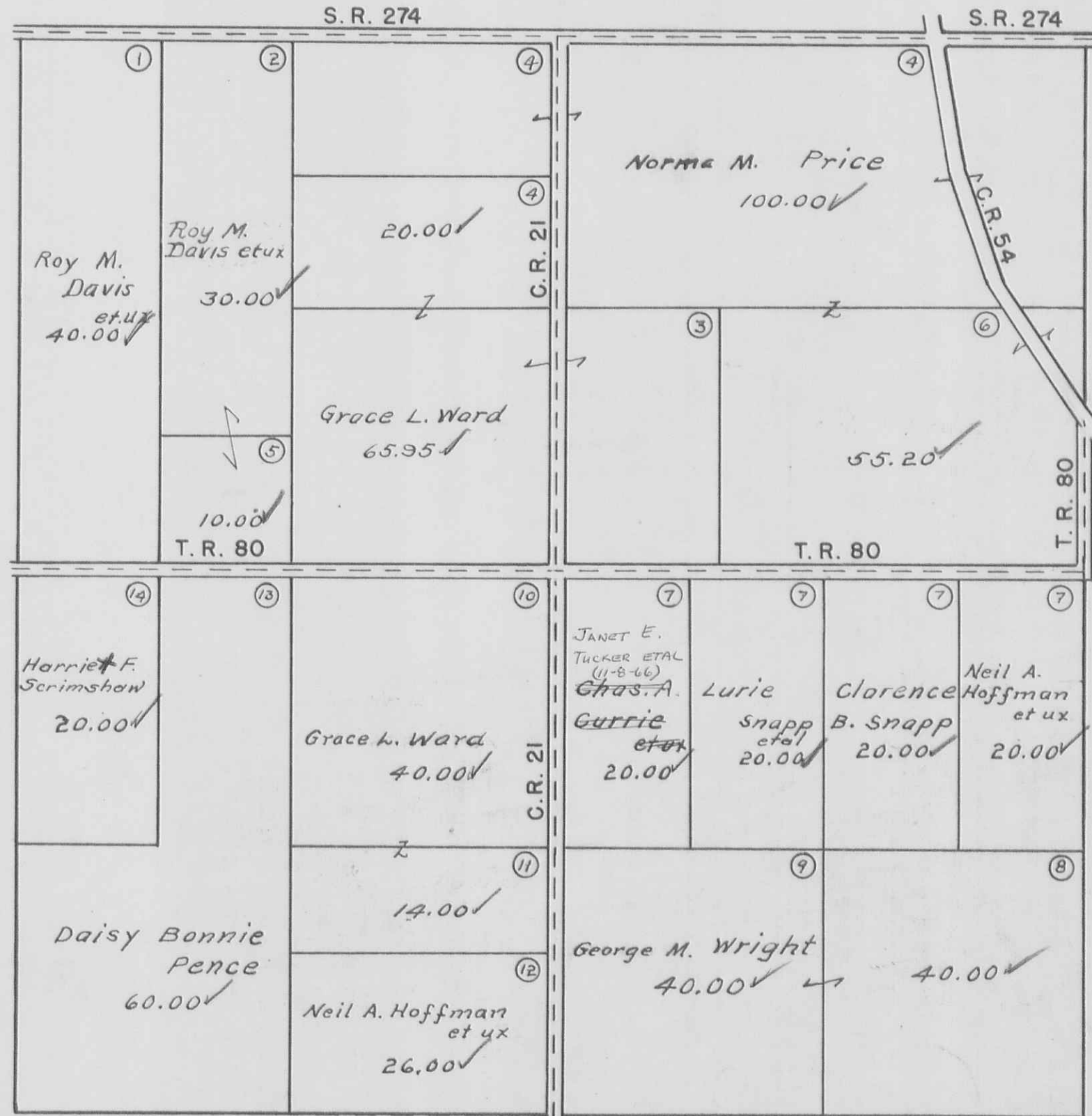

See Page 7

See Page 5

See Page 11



BLOOMFIELD TOWNSHIP

SECTION 13 TOWN 7 S. RANGE 7 E.  
SECTION 18 TOWN 7 S. RANGE 8 E.

SCALE 10 CHAINS TO THE INCH

See Page 1

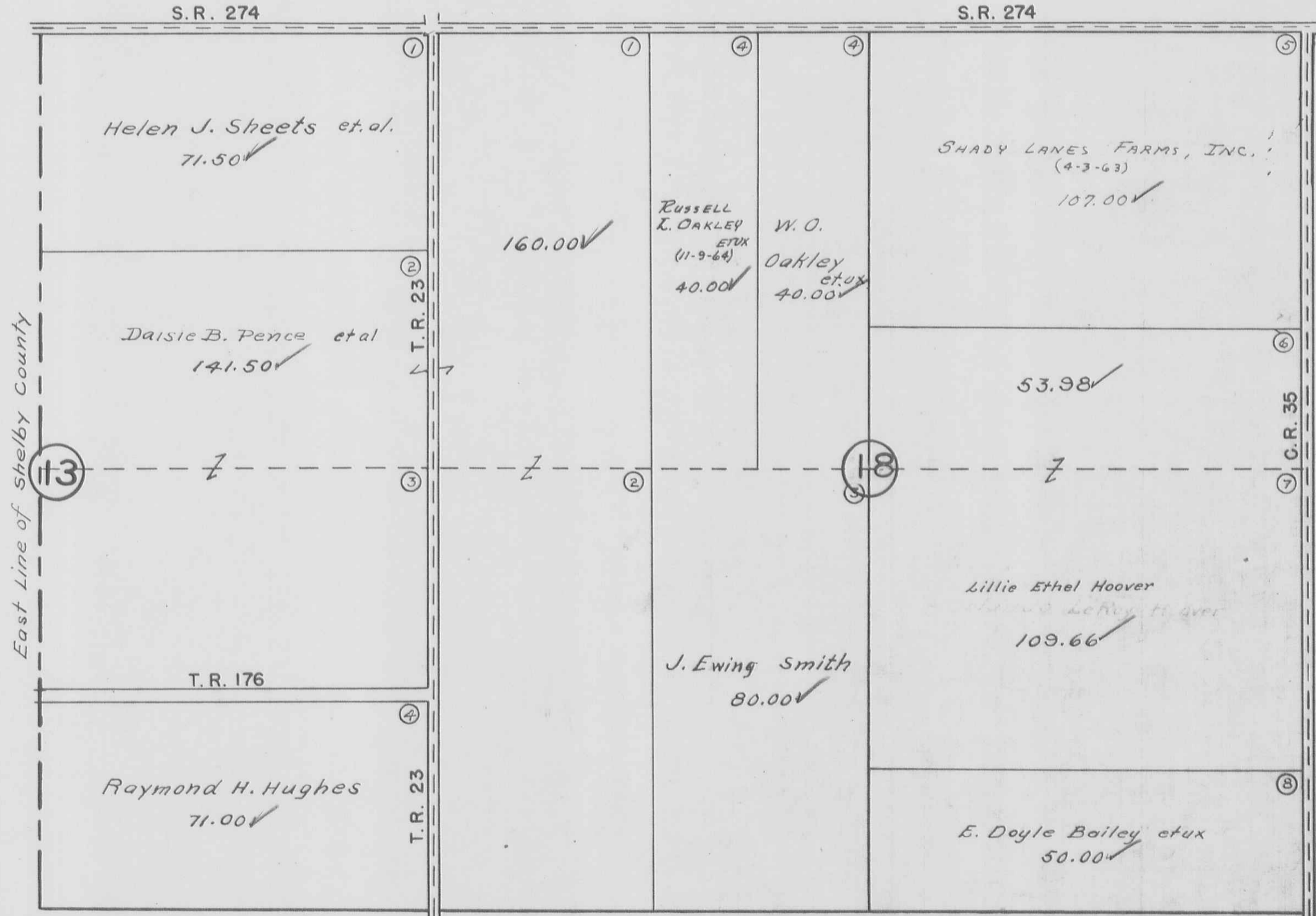

East Line of Shelby County

See Page 7

See Page 9

BLOOMFIELD TOWNSHIP  
 SECTION 19 TOWN 7 S. RANGE 8 E.  
 SECTION 24 TOWN 7 S. RANGE 7 E.

SCALE 10 CHAINS TO THE INCH

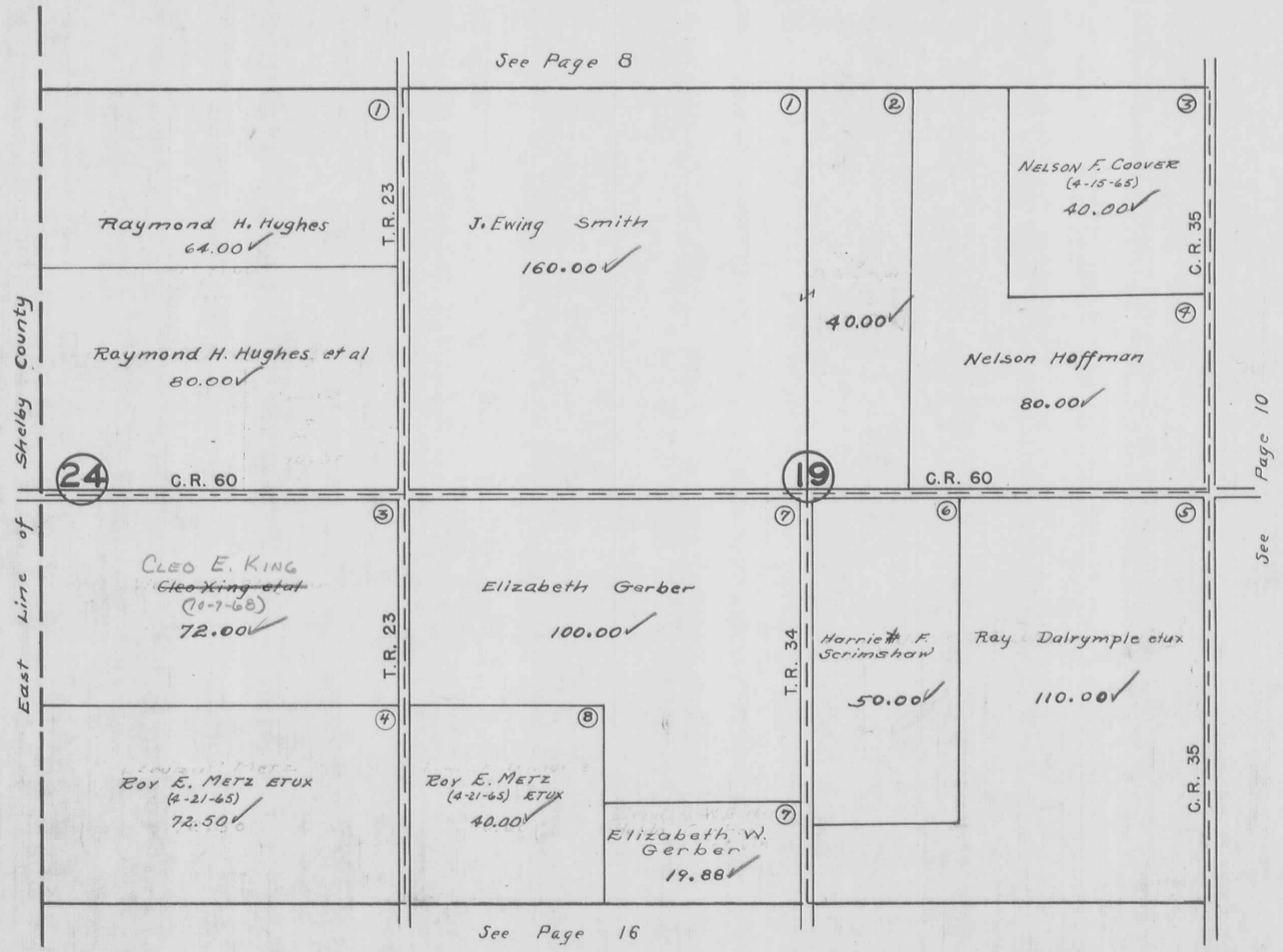

BLOOMFIELD TOWNSHIP  
SECTION 20 TOWN 7 S. RANGE 8 E.

SCALE 10 CHAINS TO THE INCH

see Page 7

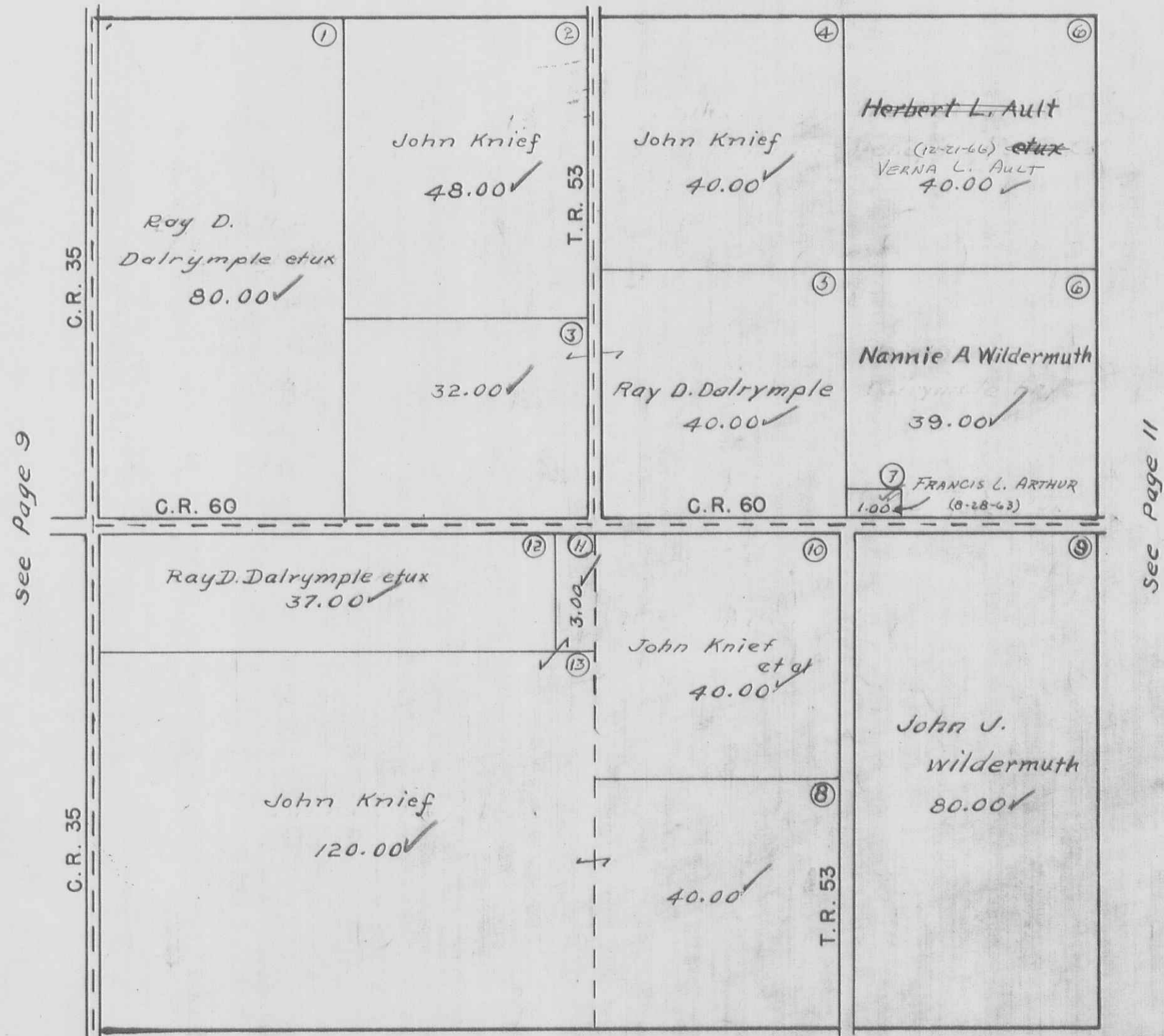

see Page 15

BLOOMFIELD TOWNSHIP  
SECTION 21 TOWN 7 S. RANGE 8 E.

SCALE 10 CHAINS TO THE INCH

See Page 6

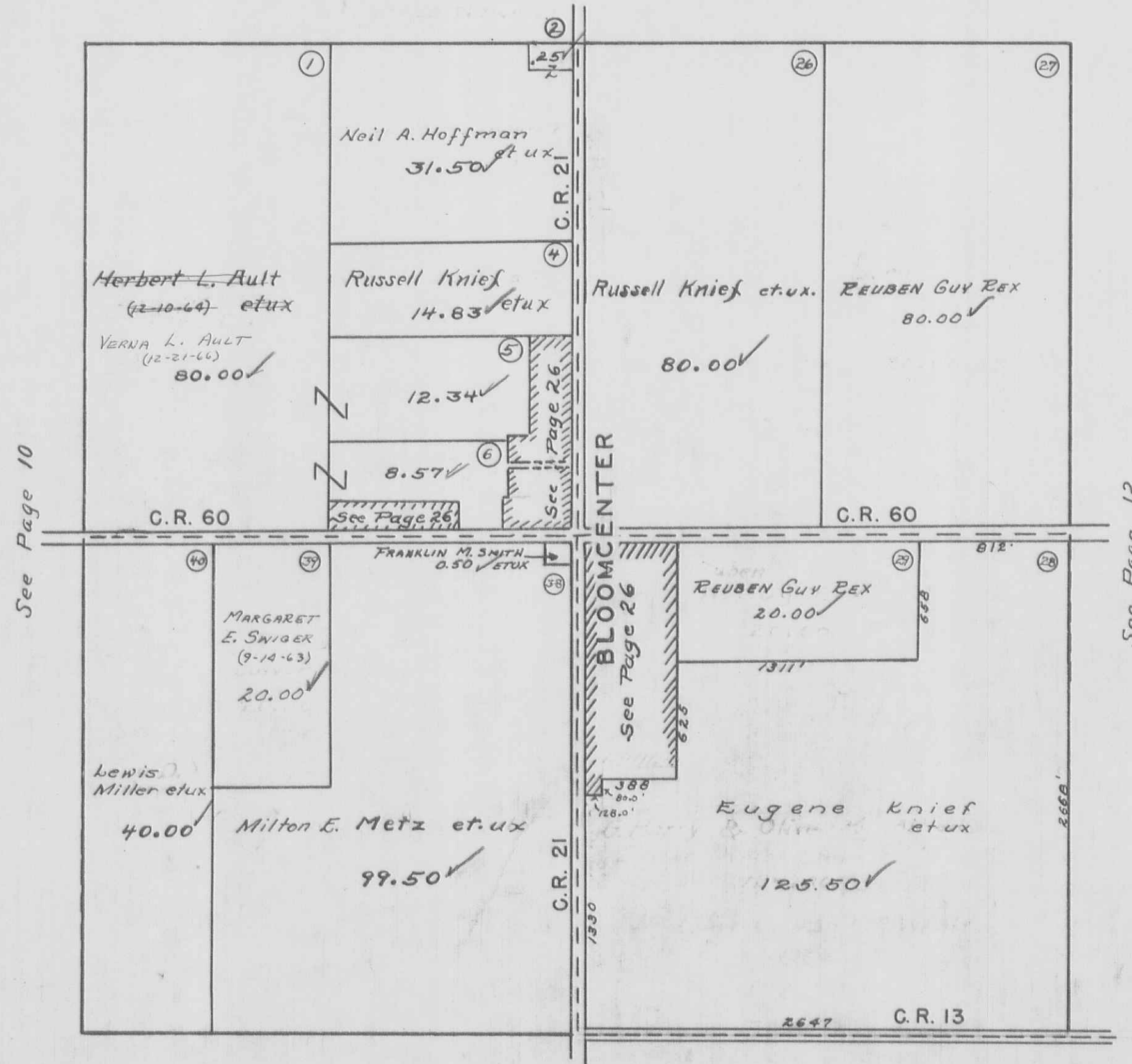

See Page 10

See Page 12

See Page 14



BLOOMFIELD TOWNSHIP  
SECTION 27 TOWN 7 S. RANGE 8 E.

NANCY STEWART SECTION

SCALE 10 CHAINS TO THE INCH

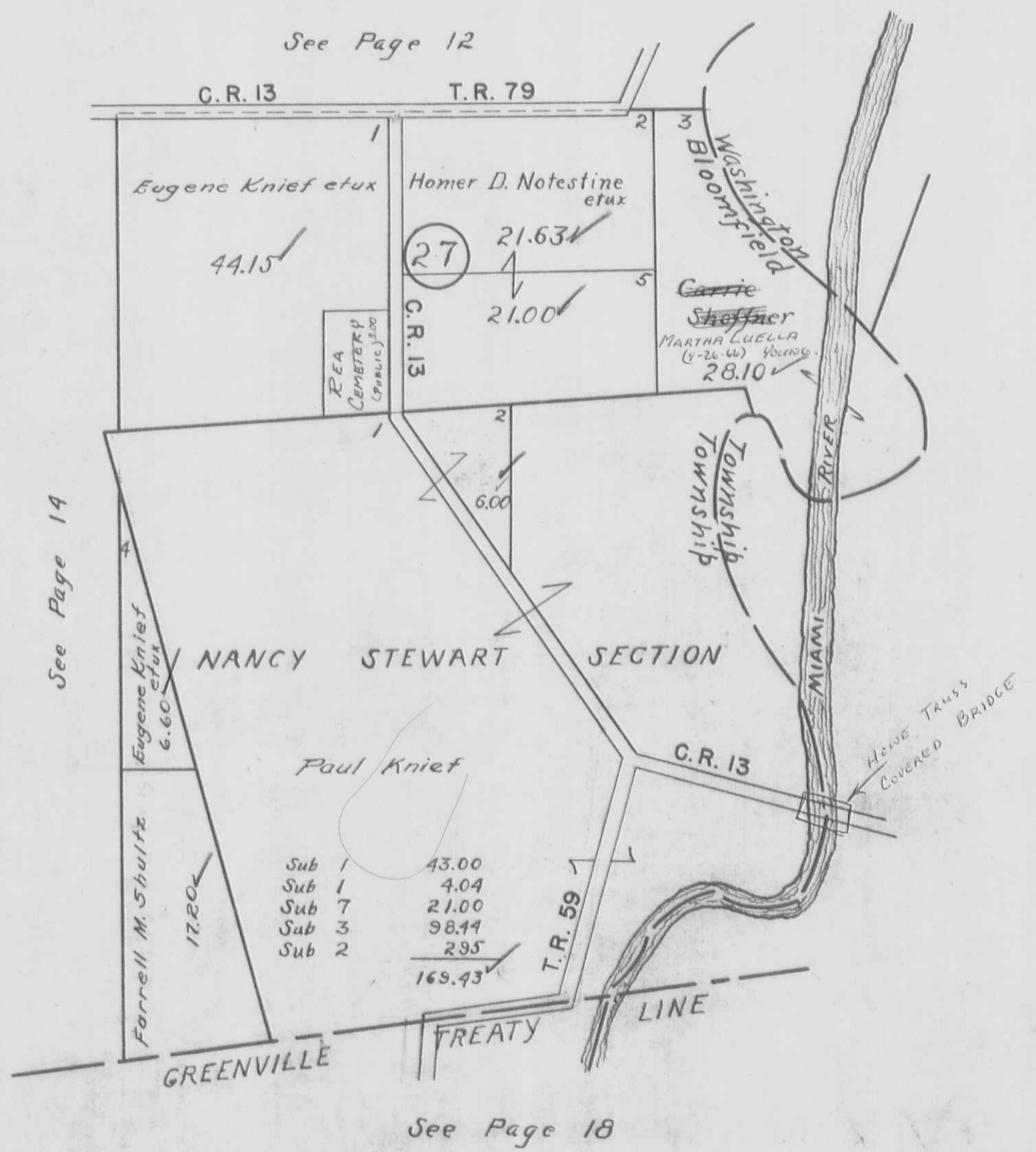



BLOOMFIELD TOWNSHIP  
SECTION 28 TOWN 7 S. RANGE 8 E.

SCALE 10 CHAINS TO THE INCH

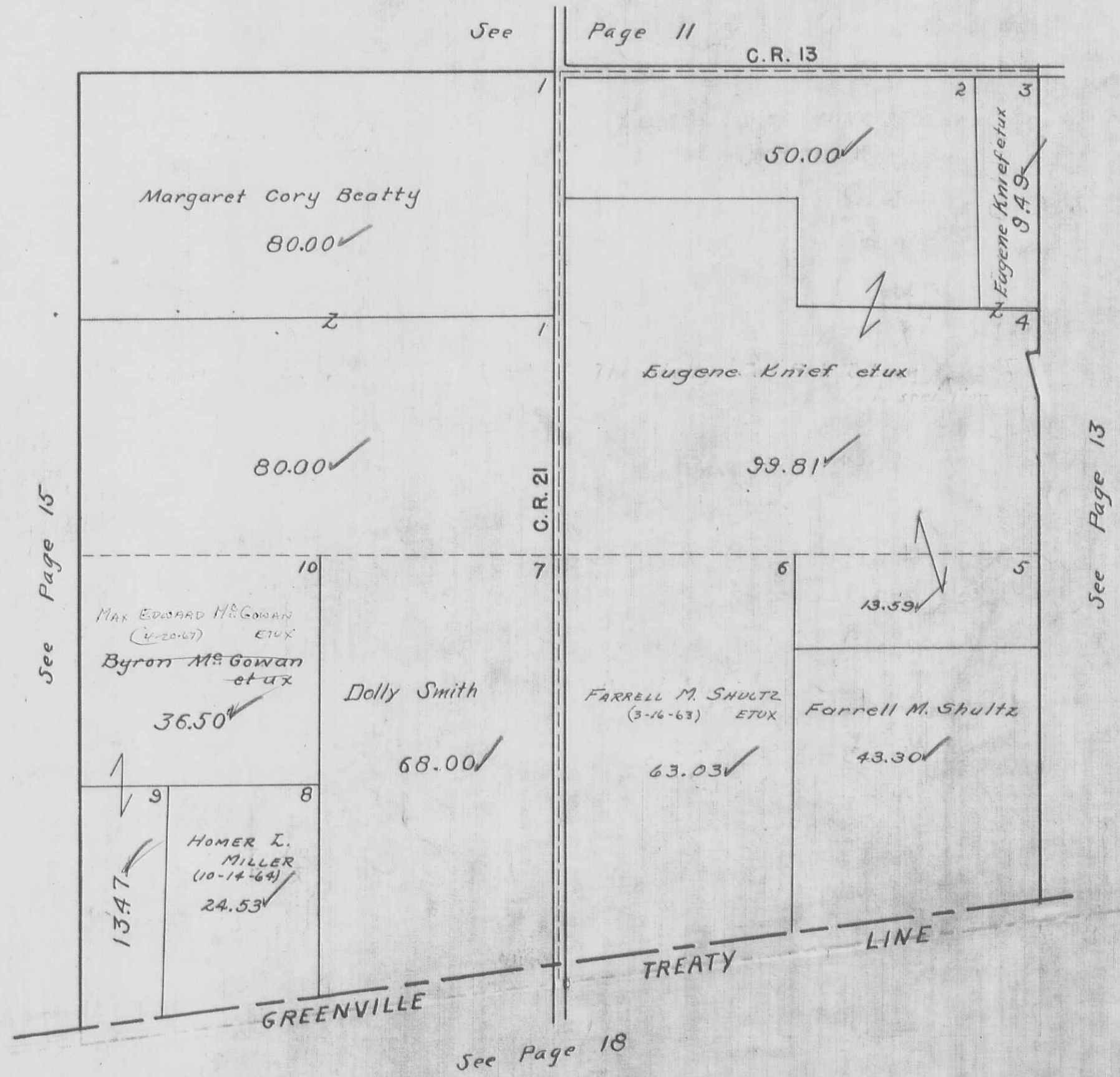

BLOOMFIELD TOWNSHIP

SECTION 29 TOWN 7 S. RANGE 8 E.  
SECTION 32 TOWN 7 S. RANGE 8 E.

SCALE 10 CHAINS TO THE INCH

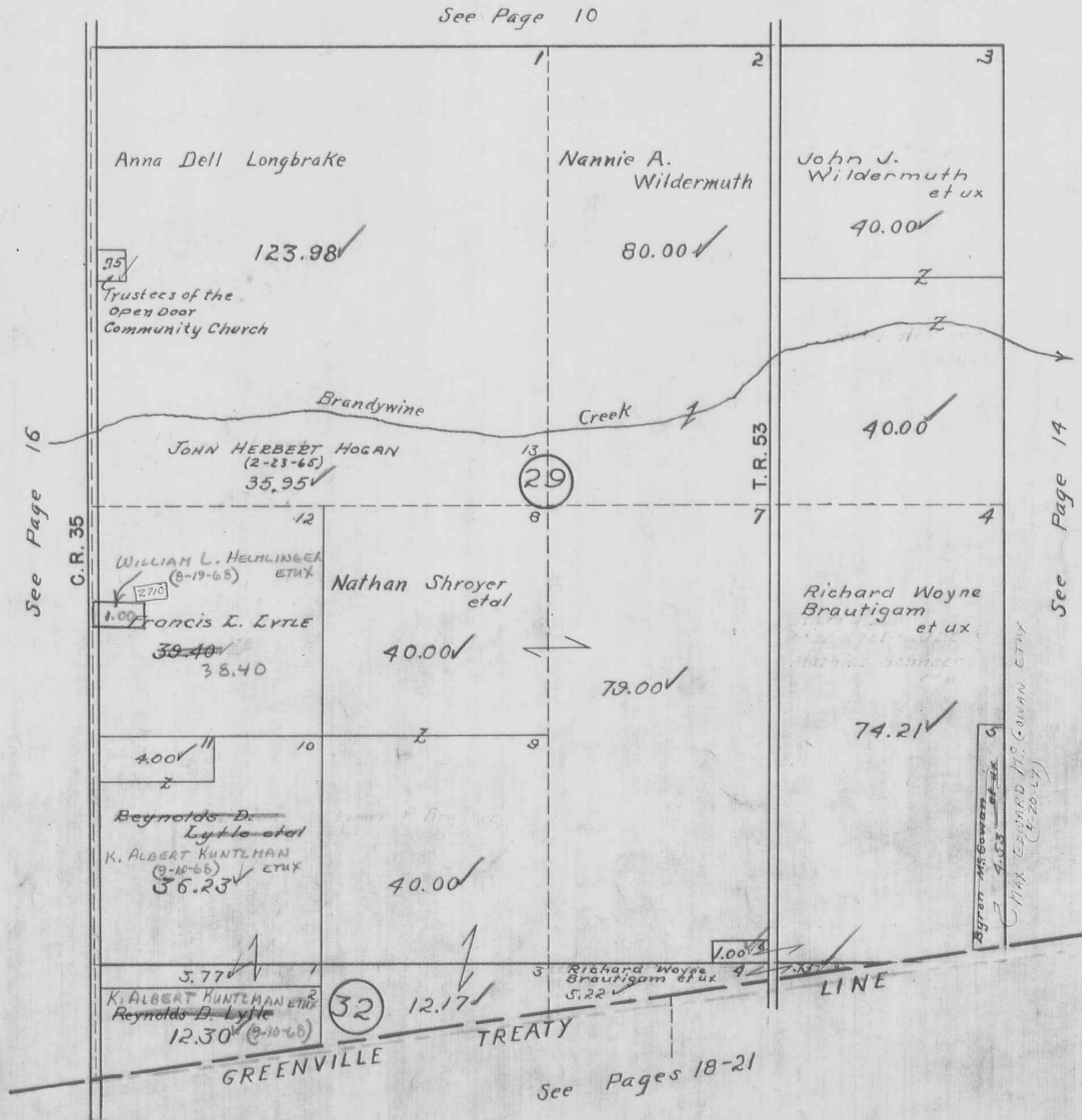

BLOOMFIELD TOWNSHIP

SECTION 25 TOWN 7 S. RANGE 7 E.  
SECTION 30 TOWN 7 S. RANGE 8 E.

SCALE 10 CHAINS TO THE INCH

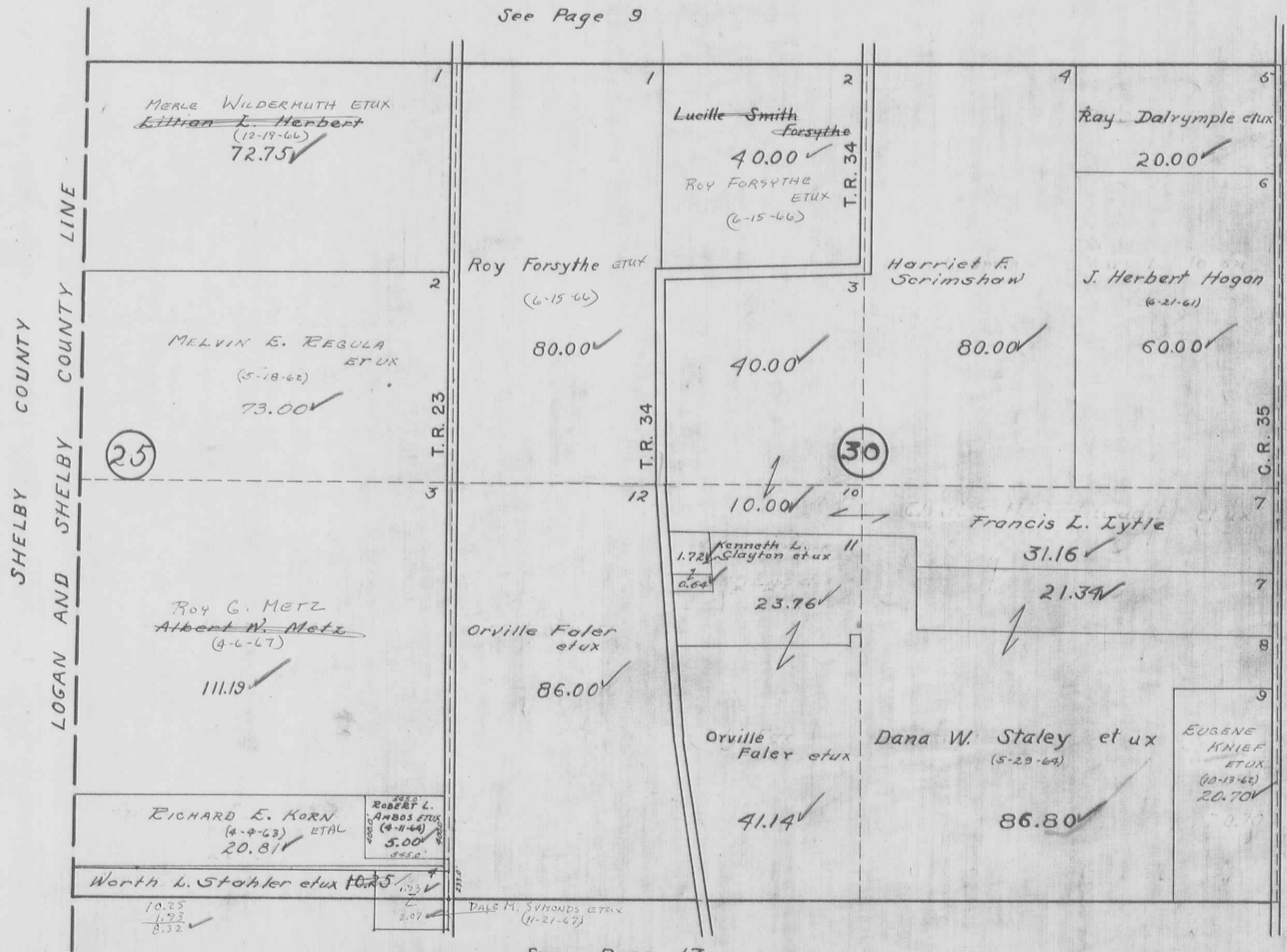

BLOOMFIELD TOWNSHIP  
SECTION 36 TOWN 7 S. RANGE 7 E.  
SECTION 31 TOWN 7 S. RANGE 8 E.

SCALE 10 CHAINS TO THE INCH

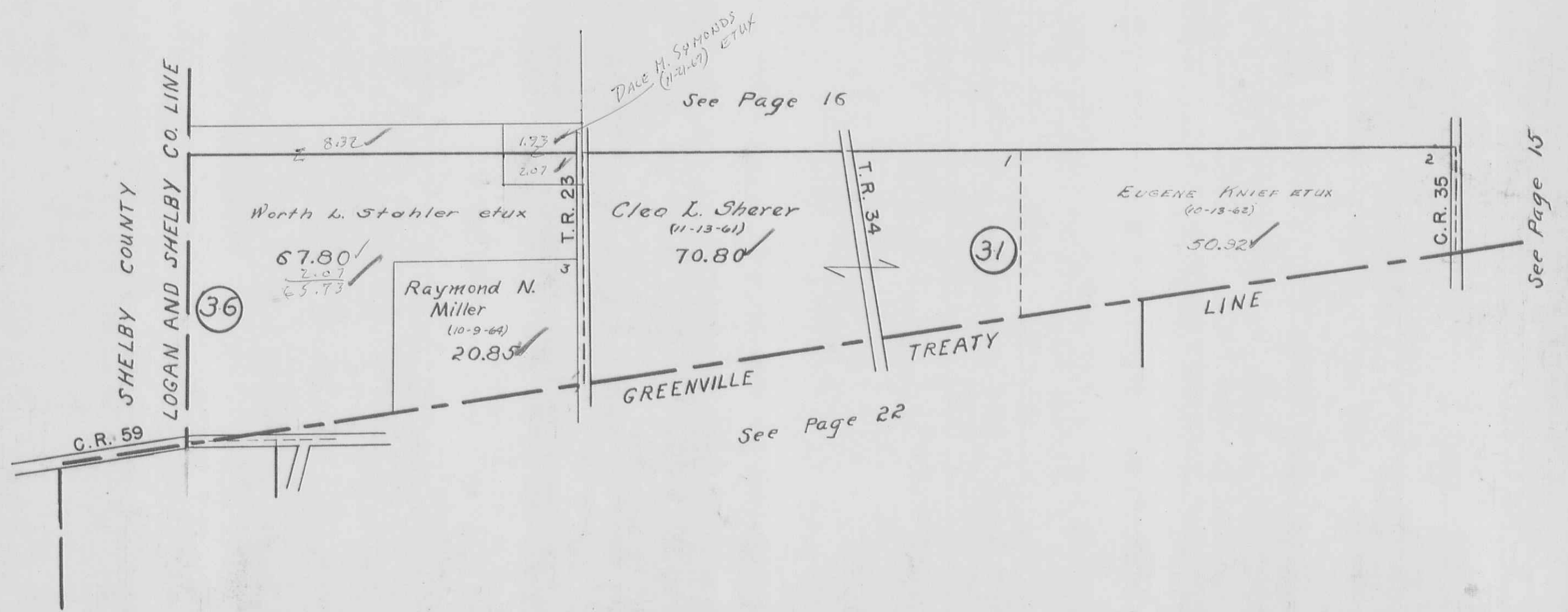

BLOOMFIELD TOWNSHIP  
 SECTION 23 TOWN 2 RANGE 8  
 SECTION 24 TOWN 2 RANGE 8

SCALE 10 CHAINS TO THE INCH

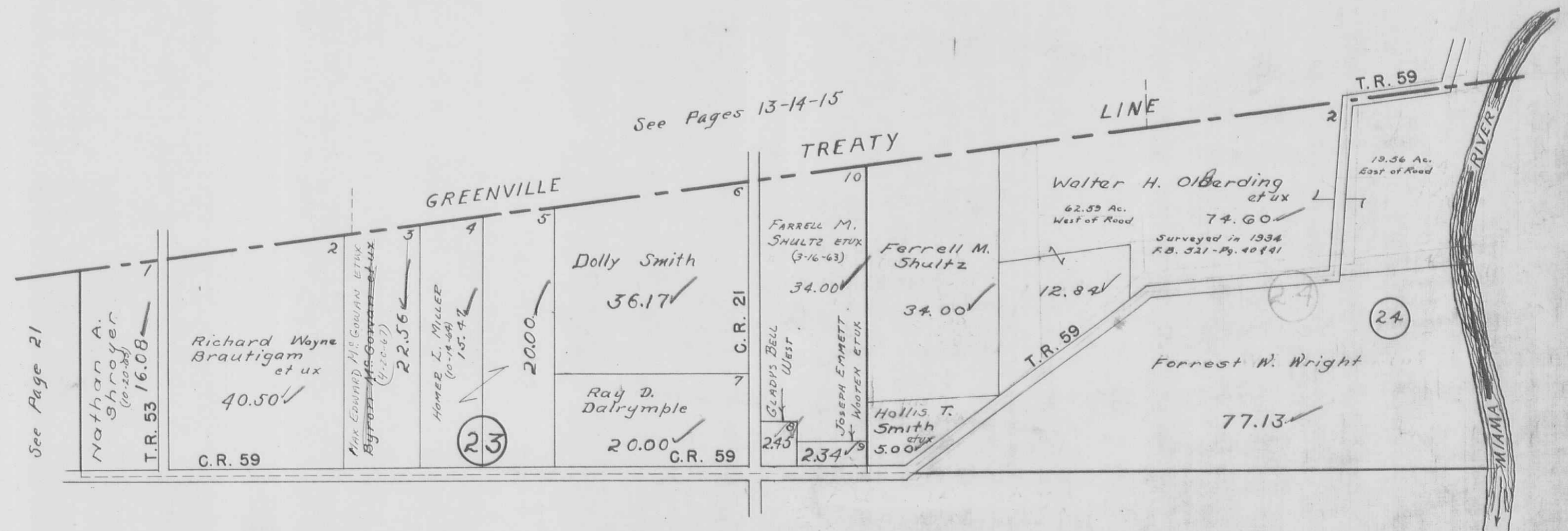

See Pages 19-20

BLOOMFIELD TOWNSHIP  
SECTION 25 TOWN 2 RANGE 8

SCALE 10 CHAINS TO THE INCH

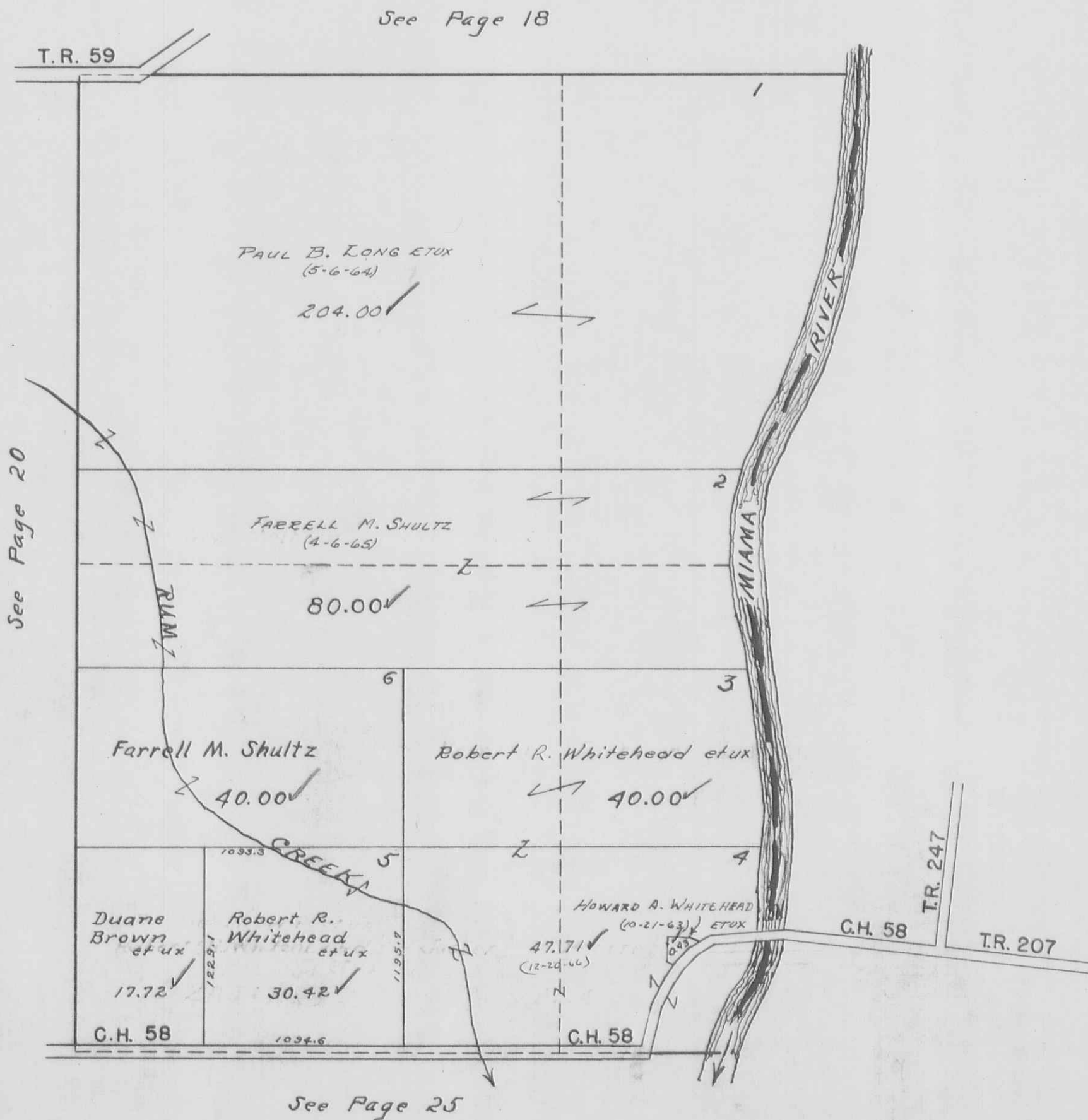

BLOOMFIELD TOWNSHIP  
 SECTION 26 TOWN 2 RANGE 8  
 SCALE 10 CHAINS TO THE INCH

See Page 18

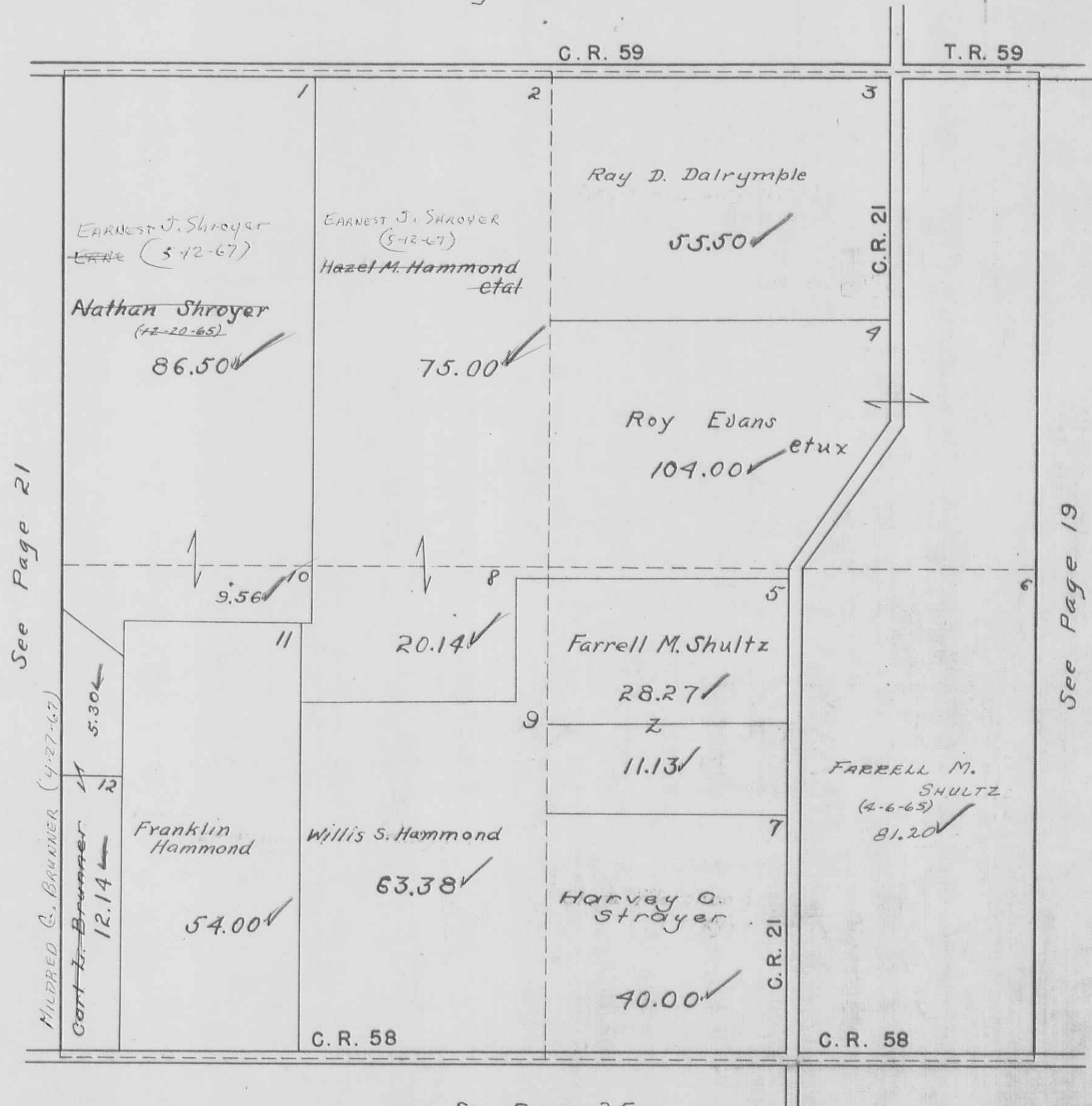

See Page 21

See Page 19

See Page 25

**BLOOMFIELD TOWNSHIP**  
**SECTION 22 TOWN 2 RANGE 8**  
**SECTION 27 TOWN 2 RANGE 8**

SCALE 10 CHAINS TO THE INCH

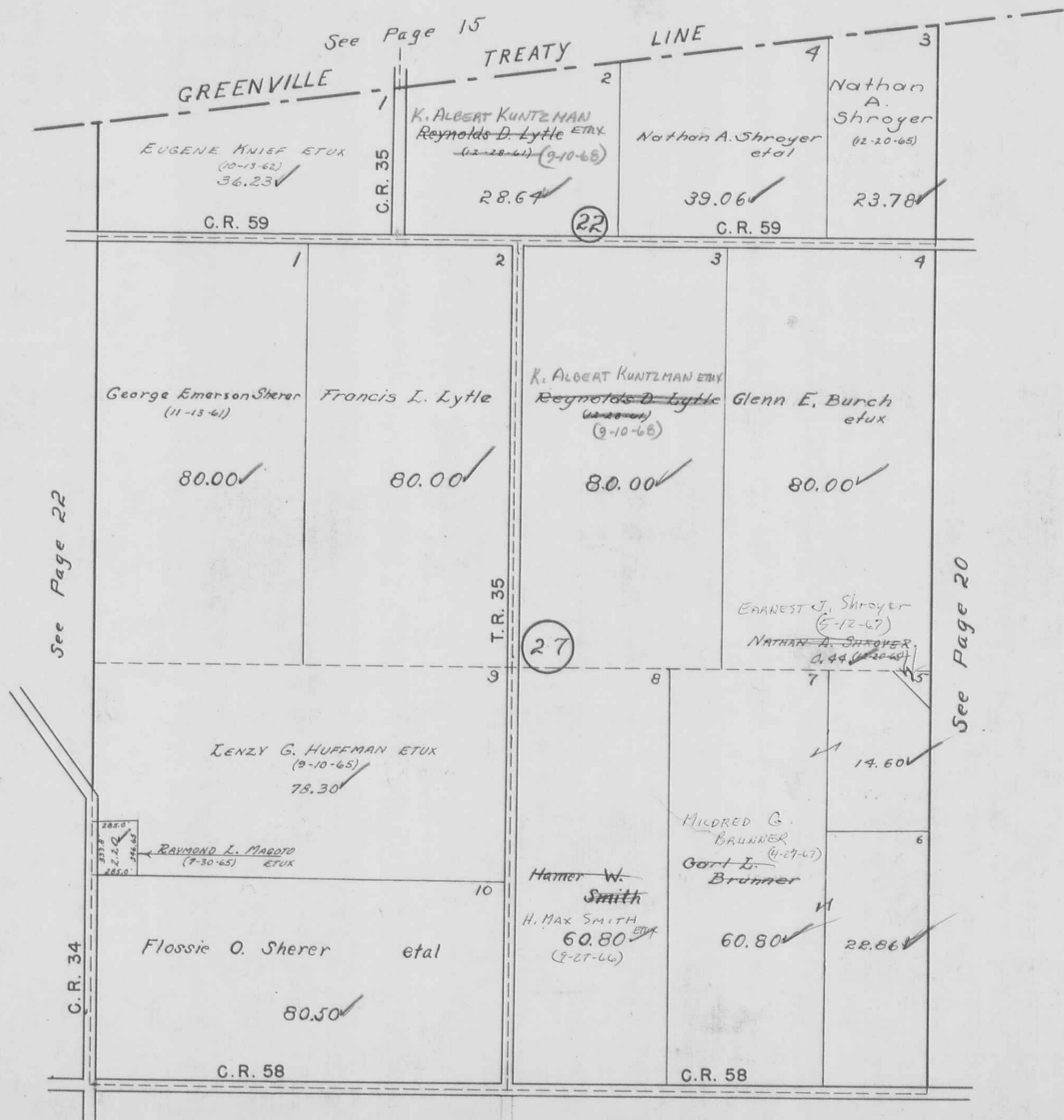



BLOOMFIELD TOWNSHIP

SECTION 28 TOWN 2 RANGE 8  
 SECTION 29 TOWN 2 RANGE 8  
 SECTION 20 TOWN 2 RANGE 8  
 SECTION 21 TOWN 2 RANGE 8

SCALE 10 CHAINS TO THE INCH

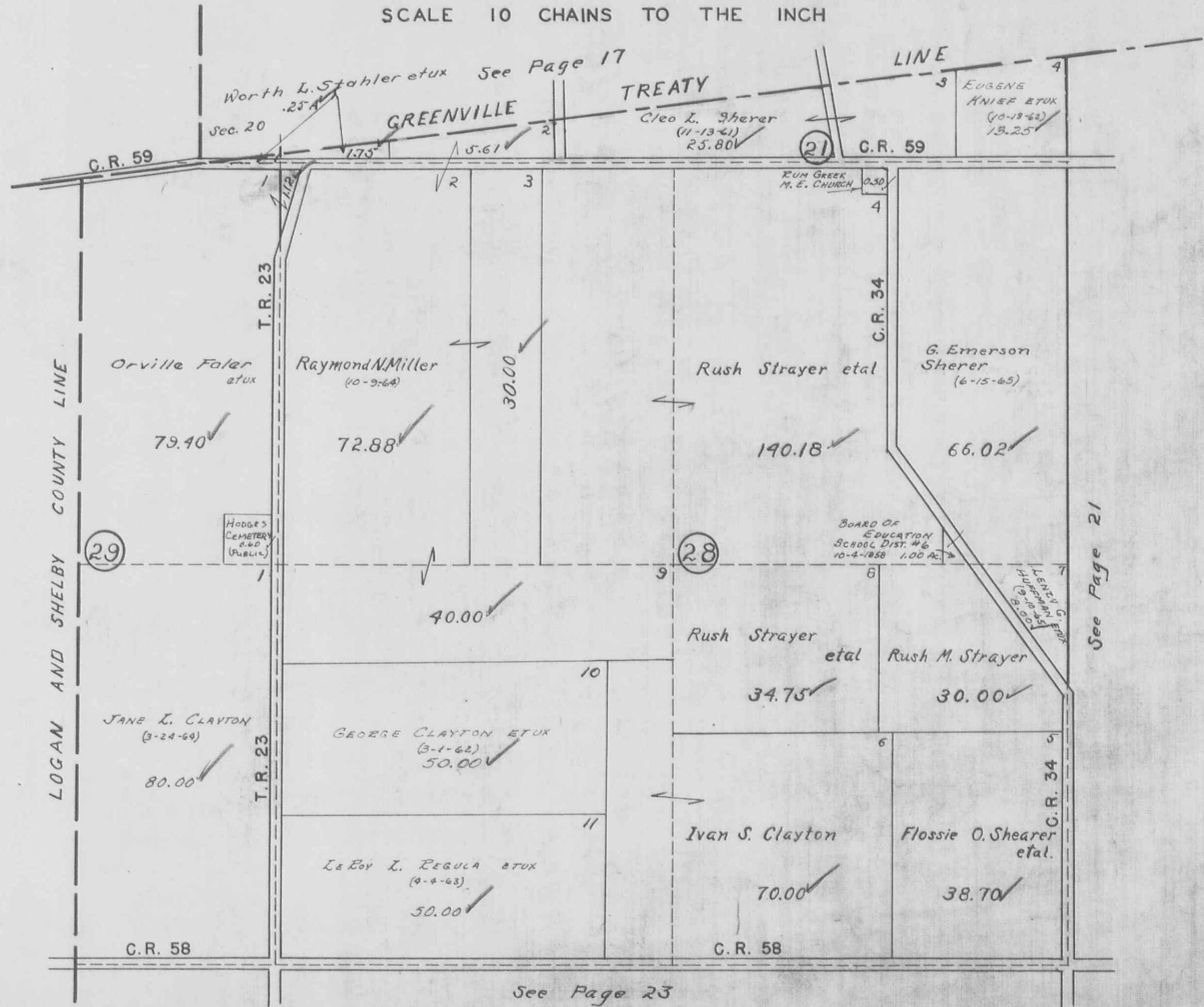

See Page 23

See Page 21

BLOOMFIELD TOWNSHIP  
SECTION 32 TOWN 2 RANGE 8  
SECTION 33 TOWN 2 RANGE 8  
SCALE 10 CHAINS TO THE INCH

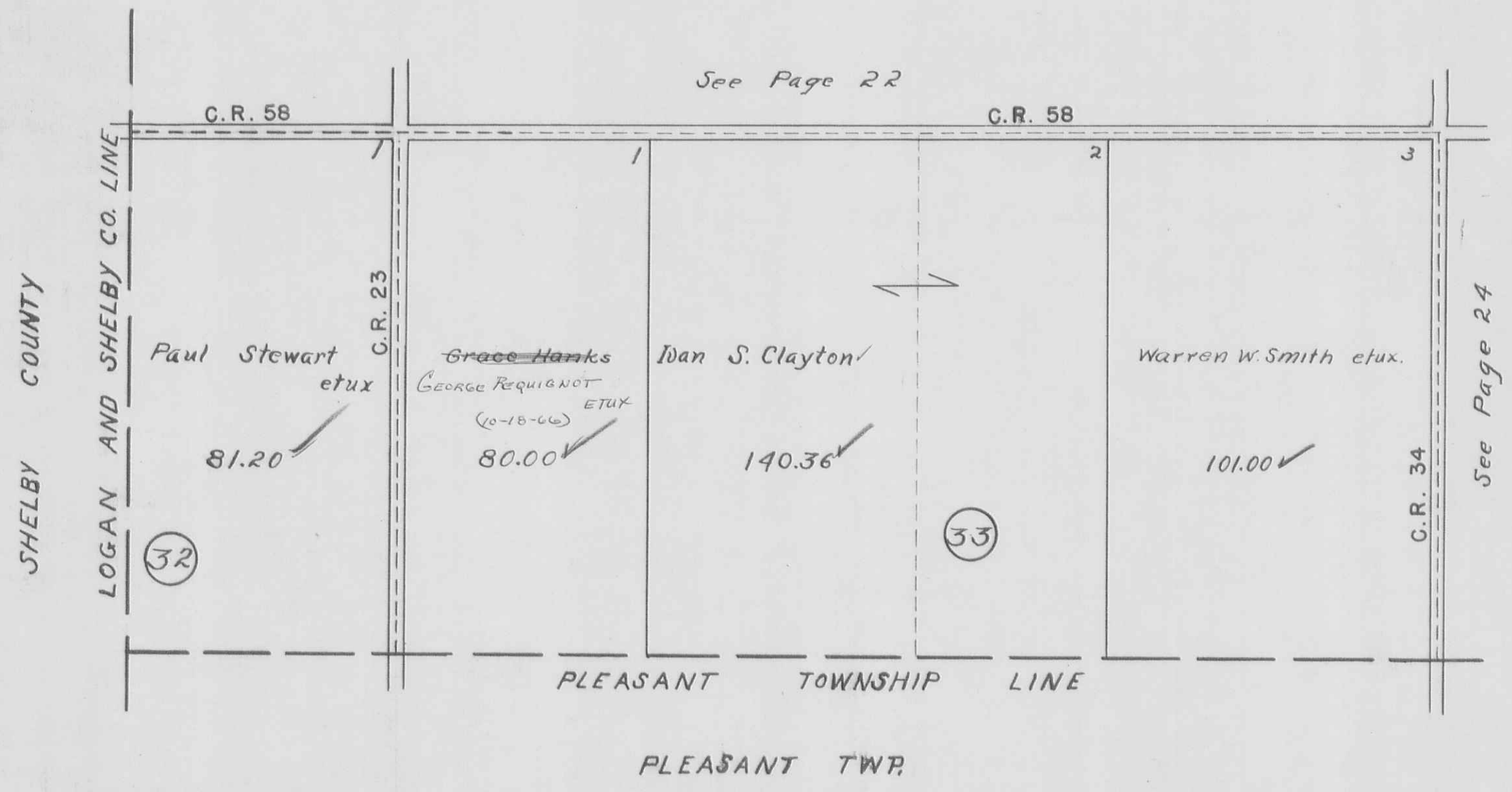

BLOOMFIELD TOWNSHIP  
SECTION 34 TOWN 2 RANGE 8

SCALE 10 CHAINS TO THE INCH

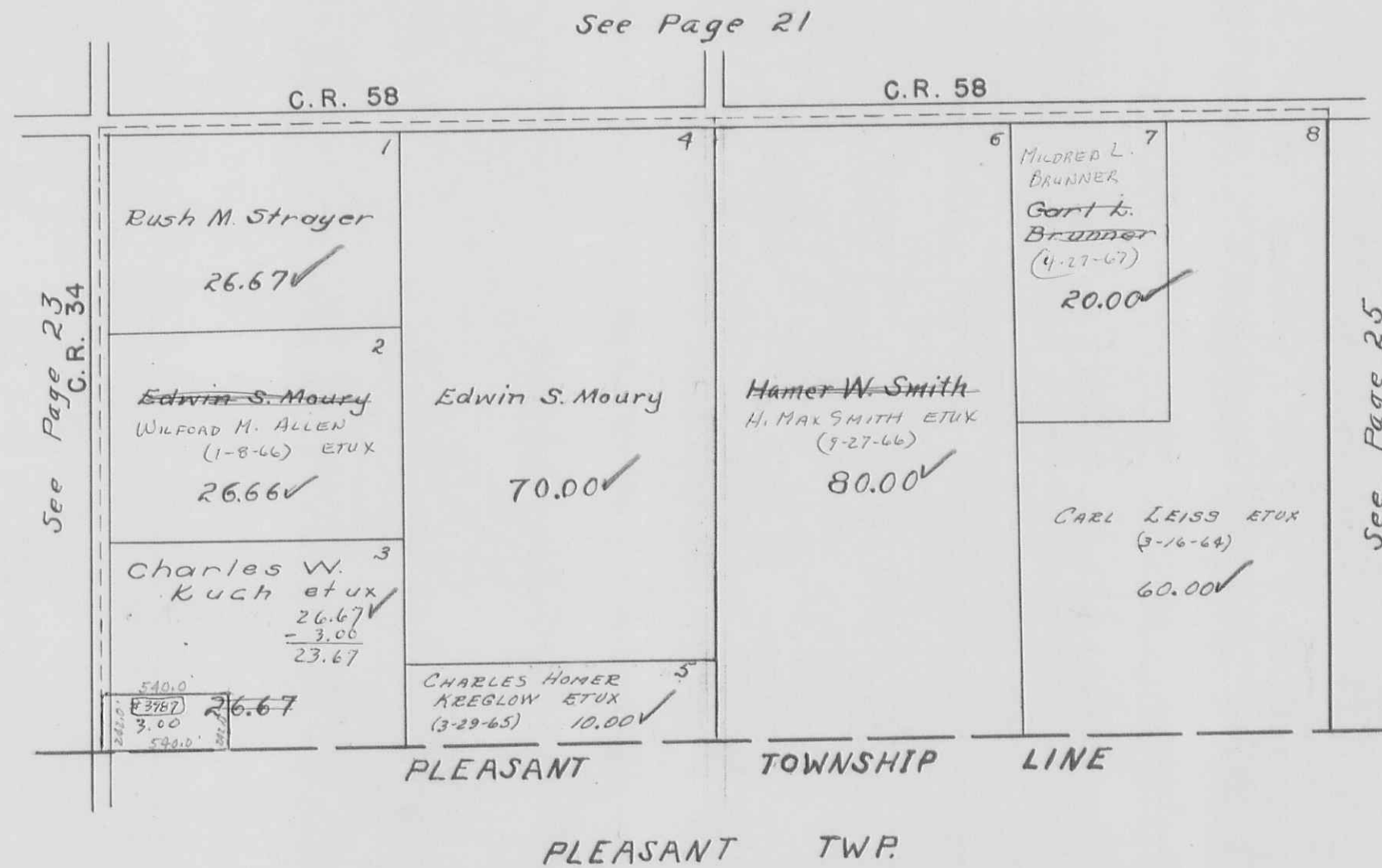

BLOOMFIELD TOWNSHIP  
 SECTION 35 TOWN 2 RANGE 8  
 SECTION 36 TOWN 2 RANGE 8

SCALE 10 CHAINS TO THE INCH

See Pages 19-20

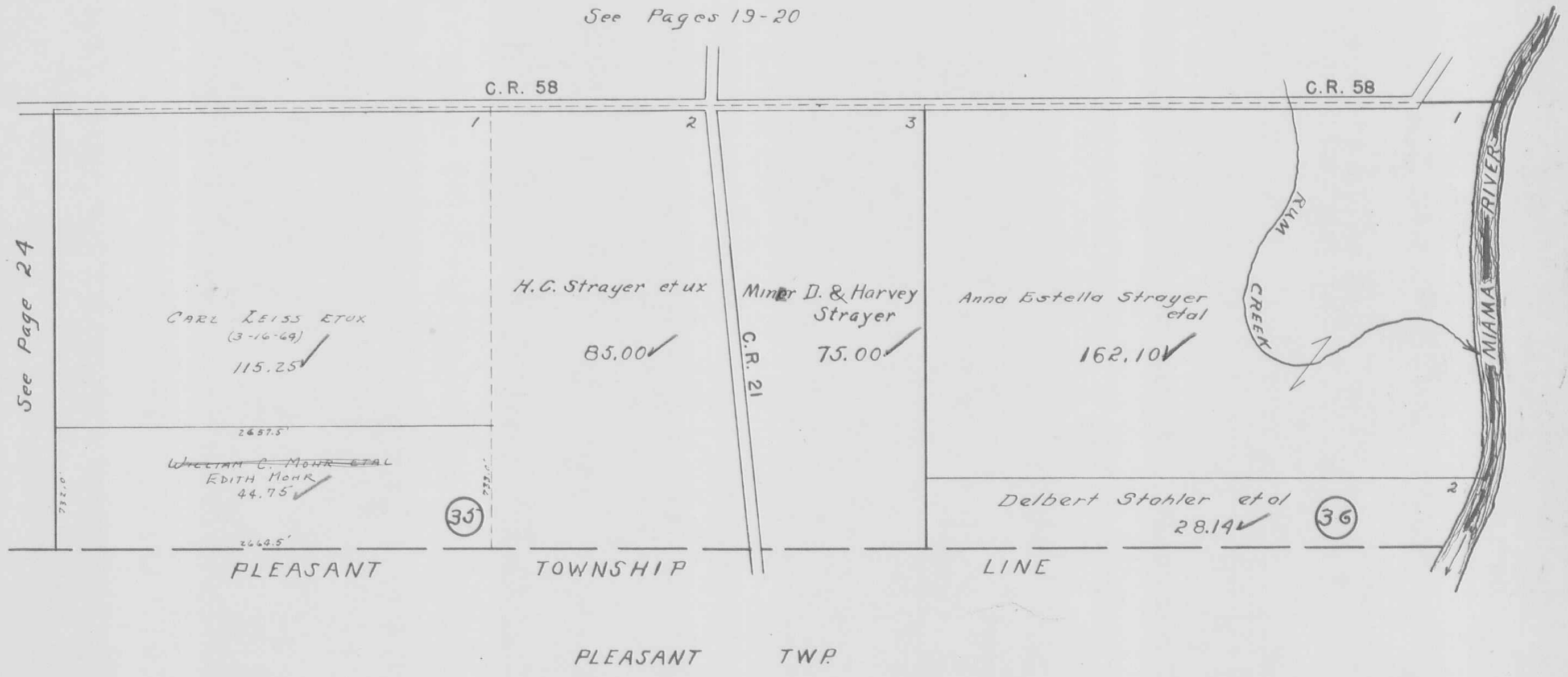

BLOOMCENTER

SCALE 200 FEET TO THE INCH

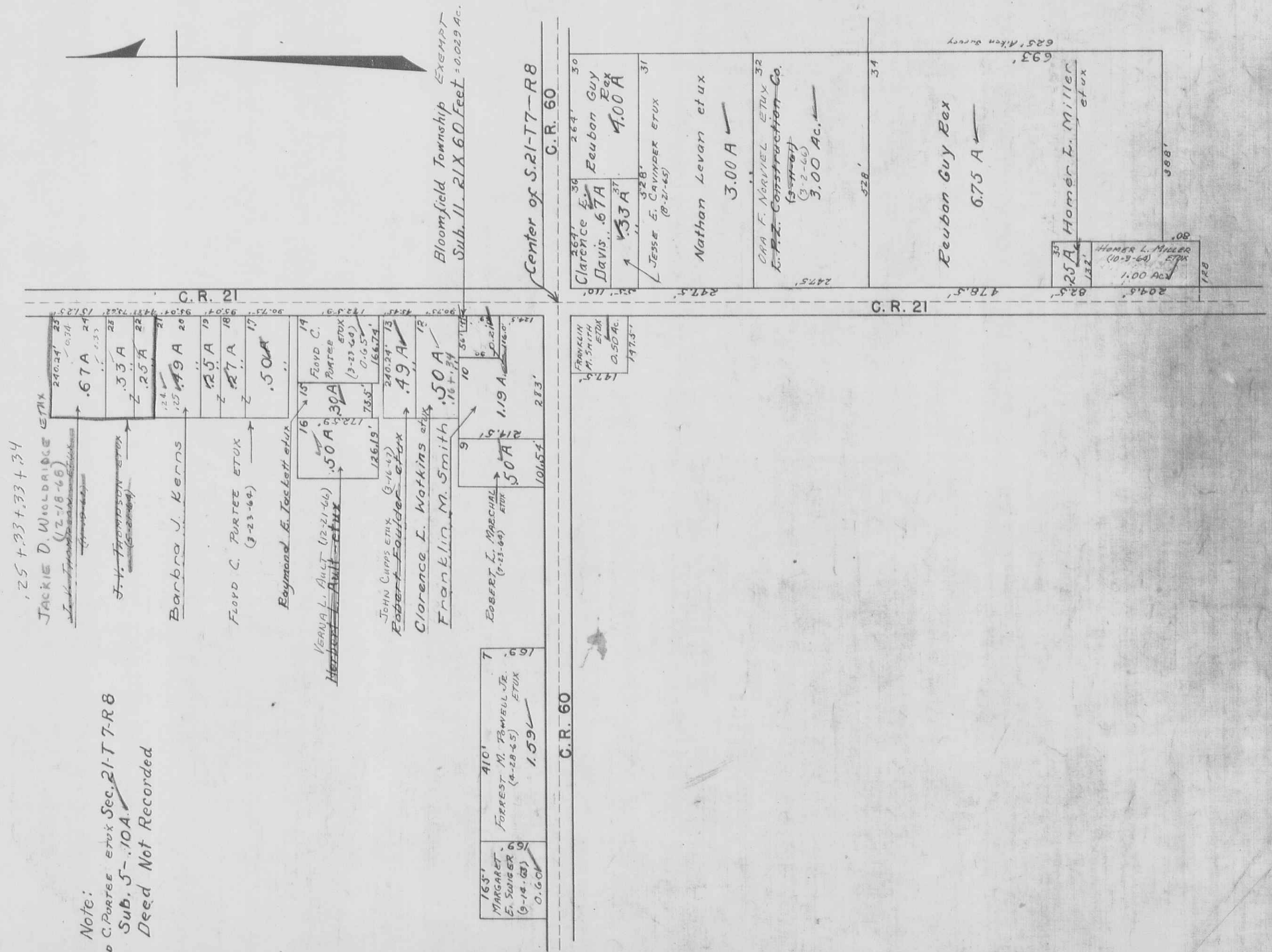

.25 + .23 + .33 + .34

JACKIE D. WOLDRIDGE ETUX  
(12-18-66)

F. V. THOMPSON ETUX  
(5-28-64)

Barbra J. Kerns

FLOYD C. PURTEE ETUX  
(3-23-64)

Raymond E. Teckett etux

~~Kerna L. Ault~~  
Kerna L. Ault (12-21-66)

John Carps ETUX  
Robert Fowler etux (3-16-47)

Clarence L. Watkins etux

Franklin M. Smith

ROBERT L. MARCHAL ETUX  
(7-23-64)

MARGARET E. SWIGER  
(9-14-63) 0.60A

FORREST M. POWELL JR.  
(2-28-65) ETUX 1.59A

Note:  
FLOYD C. PURTEE ETUX Sec. 21-T7-R8  
Sub. 5-10A.  
Deed Not Recorded