

# LOCATION PLAN

## STATE ROUTE 274

### LOGAN COUNTY

#### M<sup>c</sup>ARTHUR & RUSHCREEK TWP.

FED. RD. DIVISION	STATE	PROJECT	1 1
2	OHIO	1958	

LOGAN COUNTY  
LOG. 274-(14.92-16.9) Structures

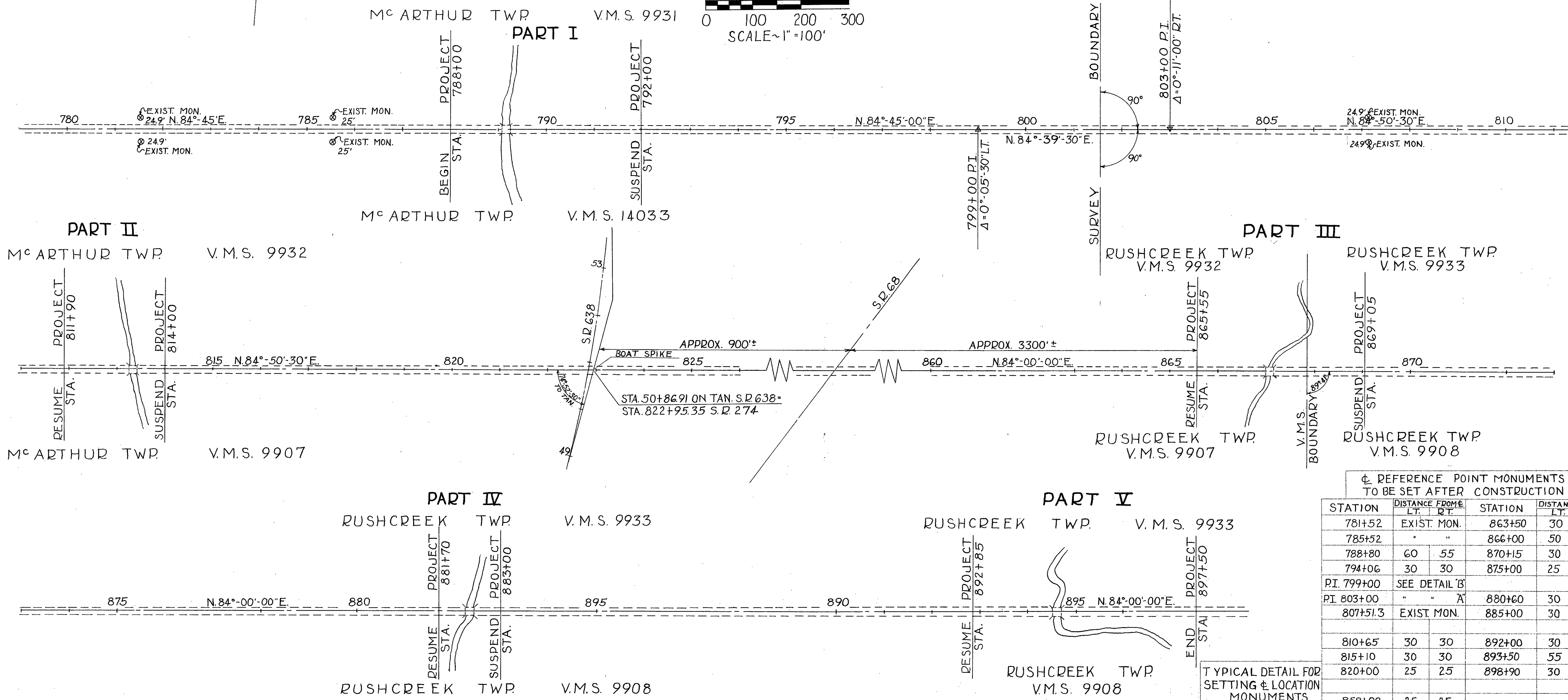
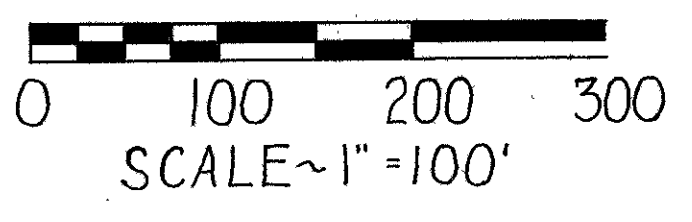

☐ REFERENCE POINT MONUMENTS  
TO BE SET AFTER CONSTRUCTION

STATION	DISTANCE FROM		STATION	DISTANCE FROM	
	LT.	RT.		LT.	RT.
781+52	EXIST. MON.		863+50	30	30
785+52	"	"	866+00	50	50
788+80	60	55	870+15	30	30
794+06	30	30	875+00	25	25
PI. 799+00	SEE DETAIL 'B'				
PI. 803+00	"	"	880+60	30	30
807+51.3	EXIST. MON.		885+00	30	30
810+65	30	30	892+00	30	30
815+10	30	30	893+50	55	45
820+00	25	25	898+90	30	30
858+00	25	25			

TYPICAL DETAIL FOR  
SETTING & LOCATION  
MONUMENTS

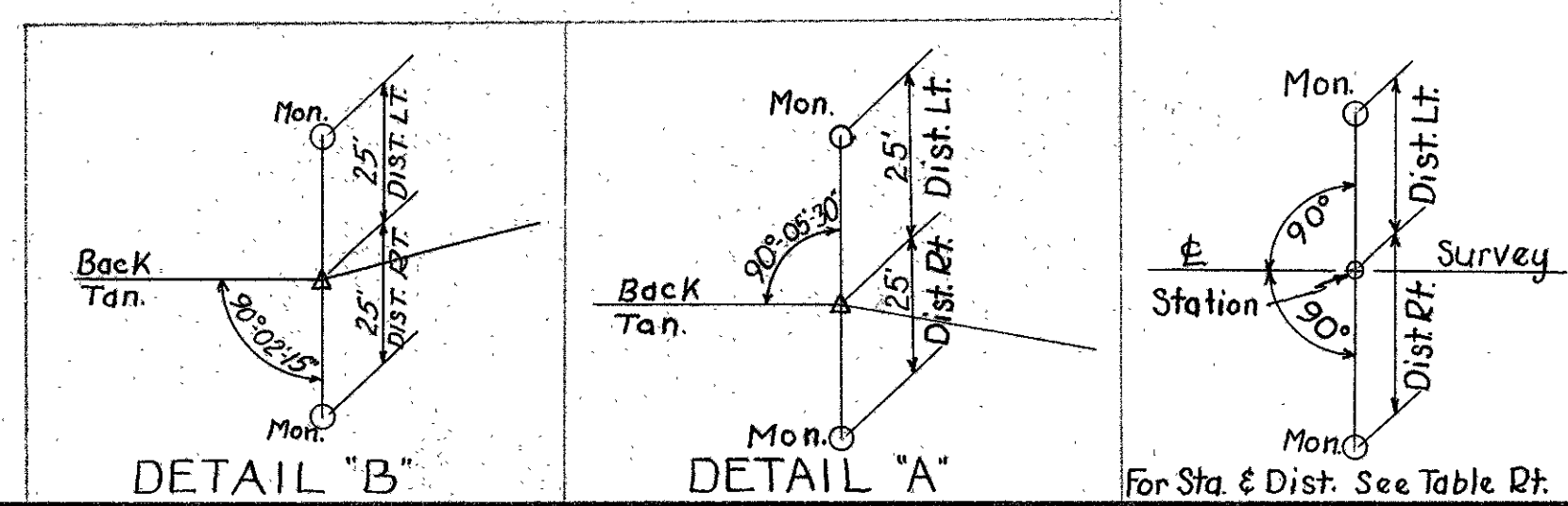

COMPLETED SETTING  
OF MONUMENTS BY: W. DOWNEY

RECORDED DATE 5-6 1958  
VOL. 1  
PAGE 15

APPROVED *For M. Bowen*  
DATE 29 April 1958  
RIGHT-OF-WAY ENGINEER - DIV. N<sup>o</sup> 7  
REGISTERED SURVEYOR N<sup>o</sup> 3128

# LOCATION PLAN

## STATE ROUTE 274

### LOGAN COUNTY

#### M<sup>c</sup>ARTHUR & RUSHCREEK TWP.

FED. RD. DIVISION	STATE	PROJECT	① ①
2	OHIO	1958	

LOGAN COUNTY  
LOG. 274-(14.92-16.9) Structures

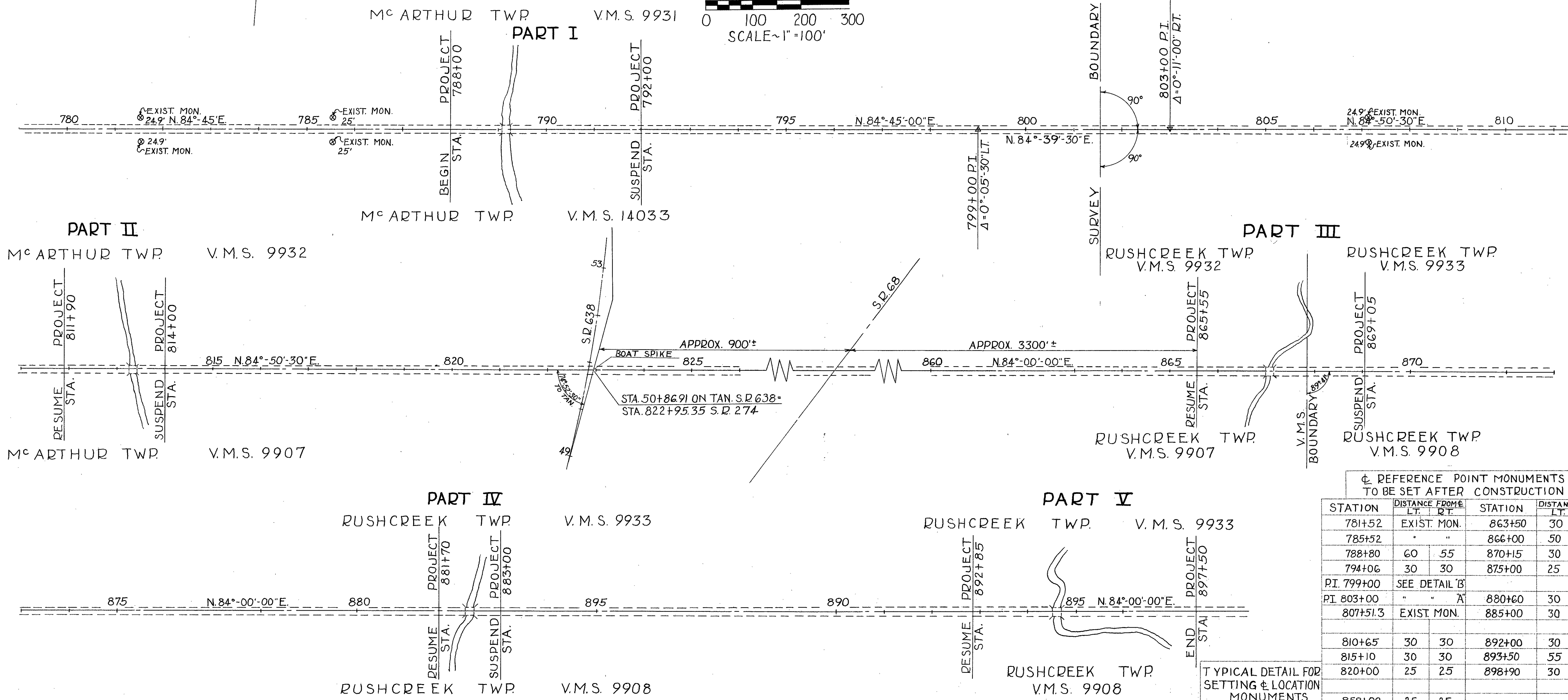
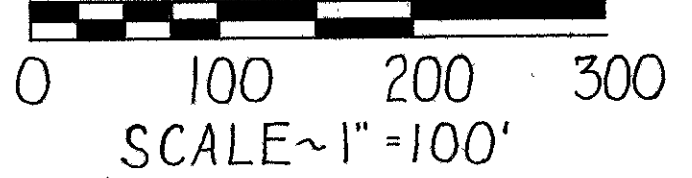
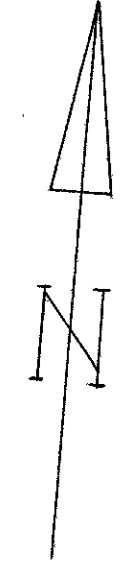

⊕ REFERENCE POINT MONUMENTS  
TO BE SET AFTER CONSTRUCTION

STATION	DISTANCE FROM		STATION	DISTANCE FROM	
	LT.	RT.		LT.	RT.
781+52	EXIST. MON.		863+50	30	30
785+52	"	"	866+00	50	50
788+80	60	55	870+15	30	30
794+06	30	30	875+00	25	25
PI. 799+00	SEE DETAIL 'B'				
PI. 803+00	"	"	880+60	30	30
807+51.3	EXIST. MON.		885+00	30	30
810+65	30	30	892+00	30	30
815+10	30	30	893+50	55	45
820+00	25	25	898+90	30	30
858+00	25	25			

TYPICAL DETAIL FOR  
SETTING & LOCATION  
MONUMENTS

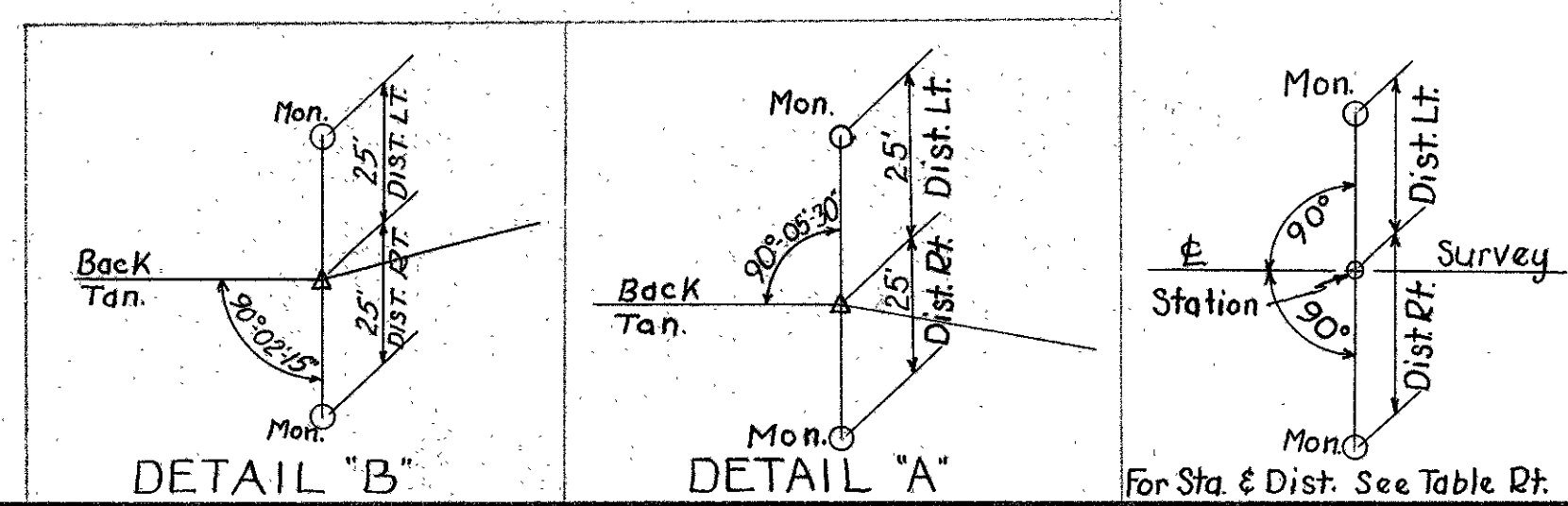

COMPLETED SETTING  
OF MONUMENTS BY: W. DOWNEY

RECORDED  
DATE 5-6 1958  
VOL. 1  
PAGE 15

APPROVED *For M. Bowen*  
DATE 29 April 1958  
RIGHT-OF-WAY ENGINEER - DIV. N<sup>o</sup> 7  
REGISTERED SURVEYOR N<sup>o</sup> 3128



# LOCATION PLAN

## STATE ROUTE 274

### LOGAN COUNTY

#### M<sup>c</sup>ARTHUR & RUSHCREEK TWP.

FED. RD. DIVISION	STATE	PROJECT	1 1
2	OHIO	1958	

LOGAN COUNTY  
LOG. 274-(14.92-16.9) Structures

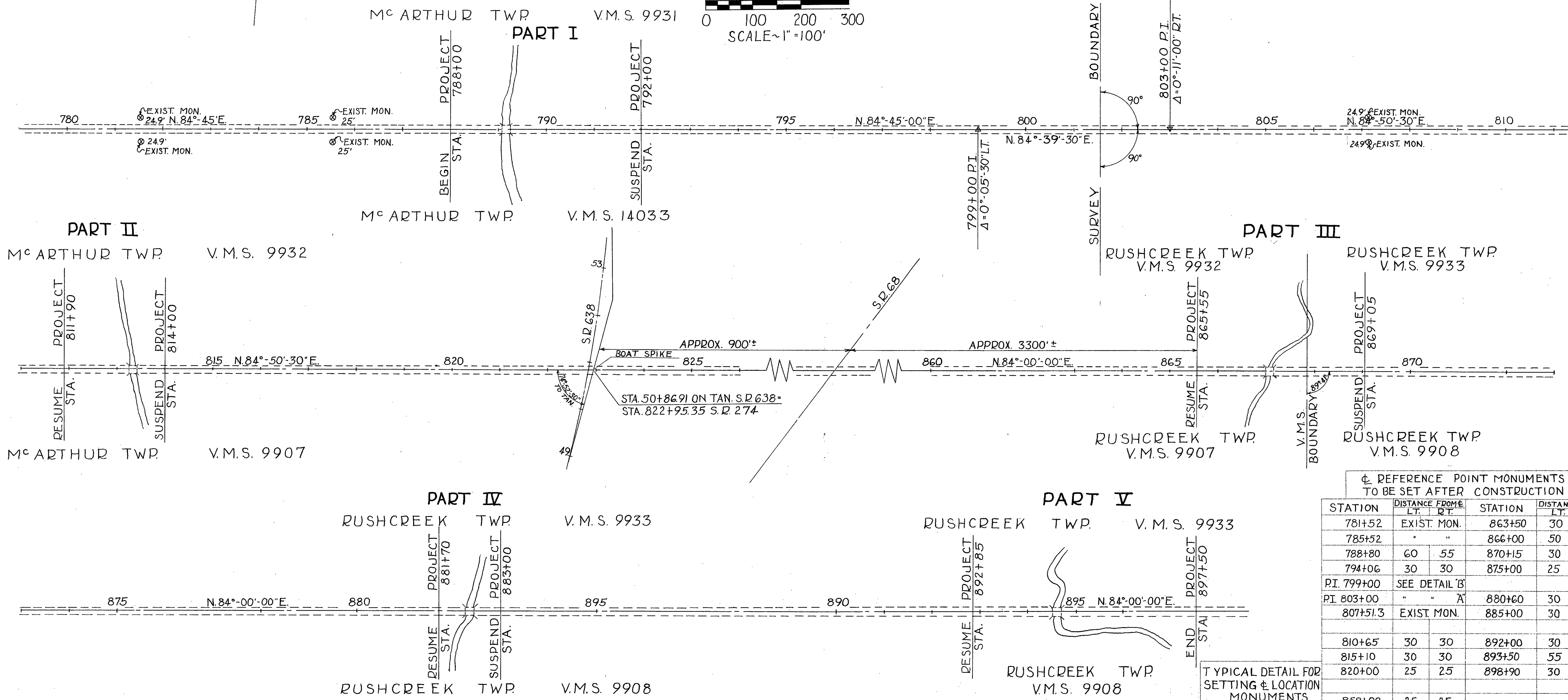
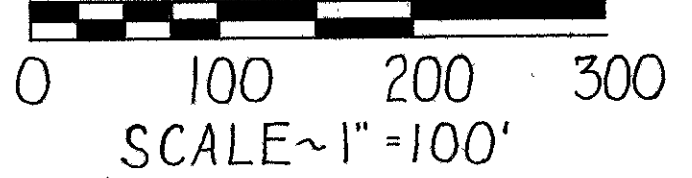
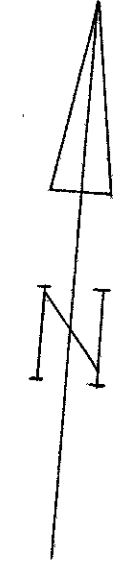

☐ REFERENCE POINT MONUMENTS  
TO BE SET AFTER CONSTRUCTION

STATION	DISTANCE FROM		STATION	DISTANCE FROM	
	LT.	RT.		LT.	RT.
781+52	EXIST. MON.		863+50	30	30
785+52	"	"	866+00	50	50
788+80	60	55	870+15	30	30
794+06	30	30	875+00	25	25
PI. 799+00	SEE DETAIL 'B'				
PI. 803+00	"	"	A	880+60	30 30
807+51.3	EXIST. MON.		885+00	30	30
810+65	30	30	892+00	30	30
815+10	30	30	893+50	55	45
820+00	25	25	898+90	30	30
858+00	25	25			

TYPICAL DETAIL FOR  
SETTING & LOCATION  
MONUMENTS

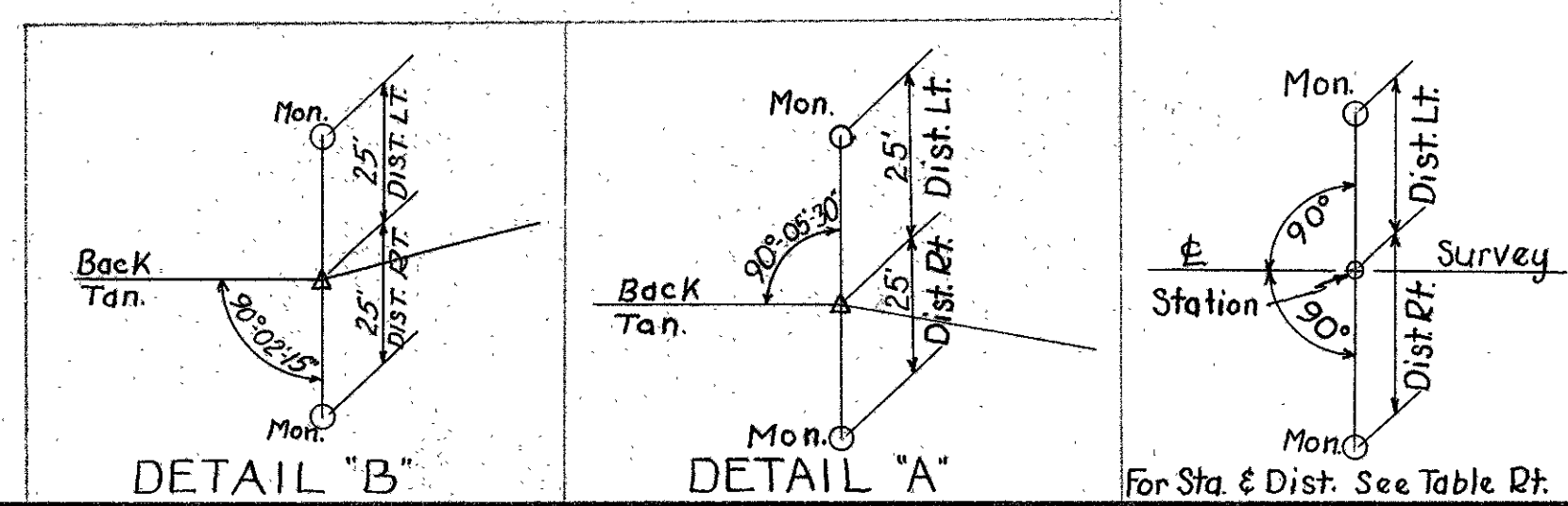

COMPLETED SETTING  
OF MONUMENTS BY: W. DOWNEY

RECORDED  
DATE 5-6 1958  
VOL. 1  
PAGE 15

APPROVED *For. M. Bowen*  
DATE 29 April 1958  
RIGHT-OF-WAY ENGINEER - DIV. N<sup>o</sup> 7  
REGISTERED SURVEYOR N<sup>o</sup> 3128

# LOCATION PLAN

## STATE ROUTE 274

### LOGAN COUNTY

#### M<sup>c</sup>ARTHUR & RUSHCREEK TWP.

FED. RD. DIVISION	STATE	PROJECT	1 1
2	OHIO	1958	

LOGAN COUNTY  
LOG. 274-(14.92-16.9) Structures

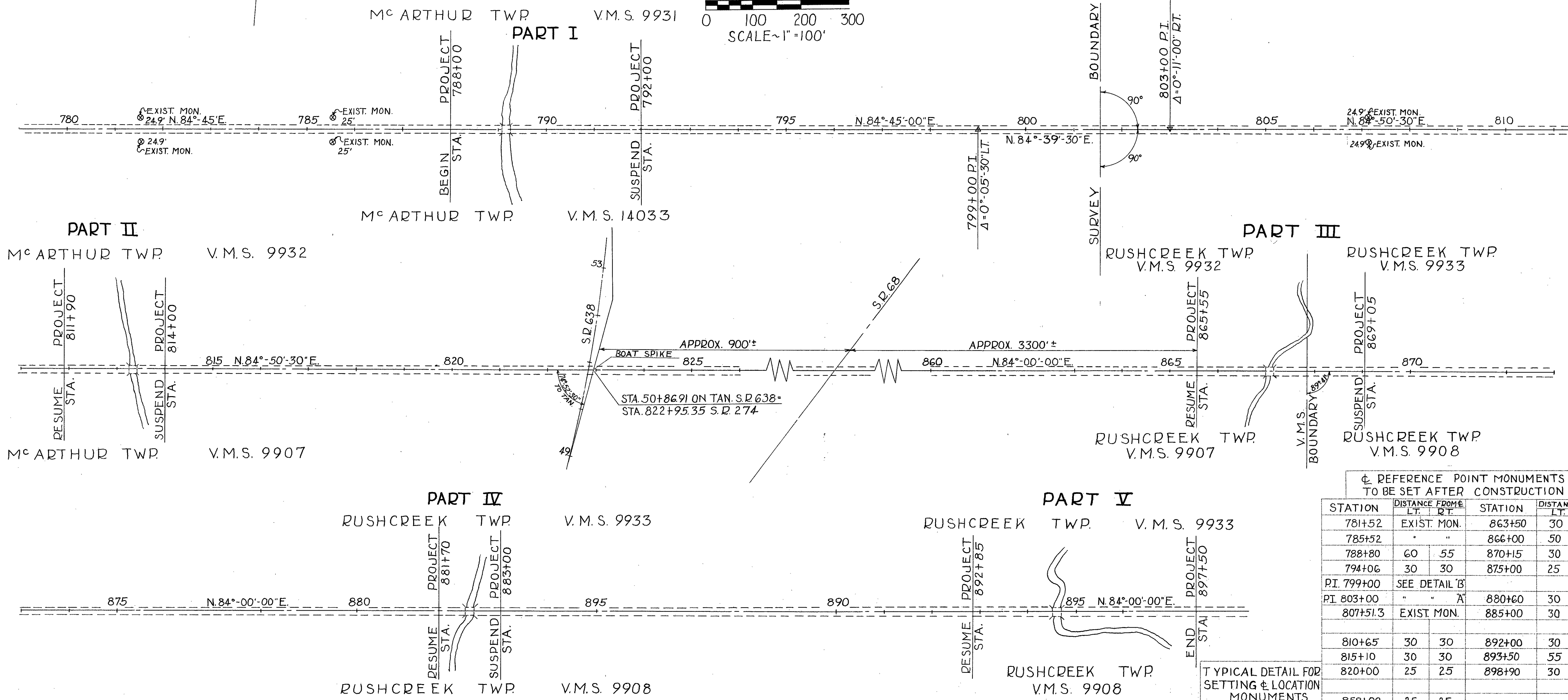
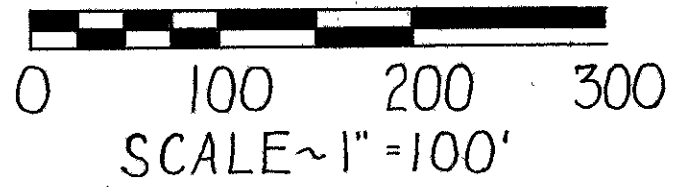
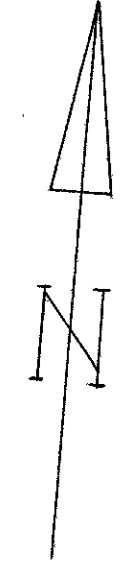

⊕ REFERENCE POINT MONUMENTS  
TO BE SET AFTER CONSTRUCTION

STATION	DISTANCE FROM		STATION	DISTANCE FROM	
	LT.	RT.		LT.	RT.
781+52	EXIST. MON.		863+50	30	30
785+52	"	"	866+00	50	50
788+80	60	55	870+15	30	30
794+06	30	30	875+00	25	25
PI. 799+00	SEE DETAIL 'B'				
PI. 803+00	"	"	880+60	30	30
807+51.3	EXIST. MON.		885+00	30	30
810+65	30	30	892+00	30	30
815+10	30	30	893+50	55	45
820+00	25	25	898+90	30	30
858+00	25	25			

TYPICAL DETAIL FOR  
SETTING & LOCATION  
MONUMENTS

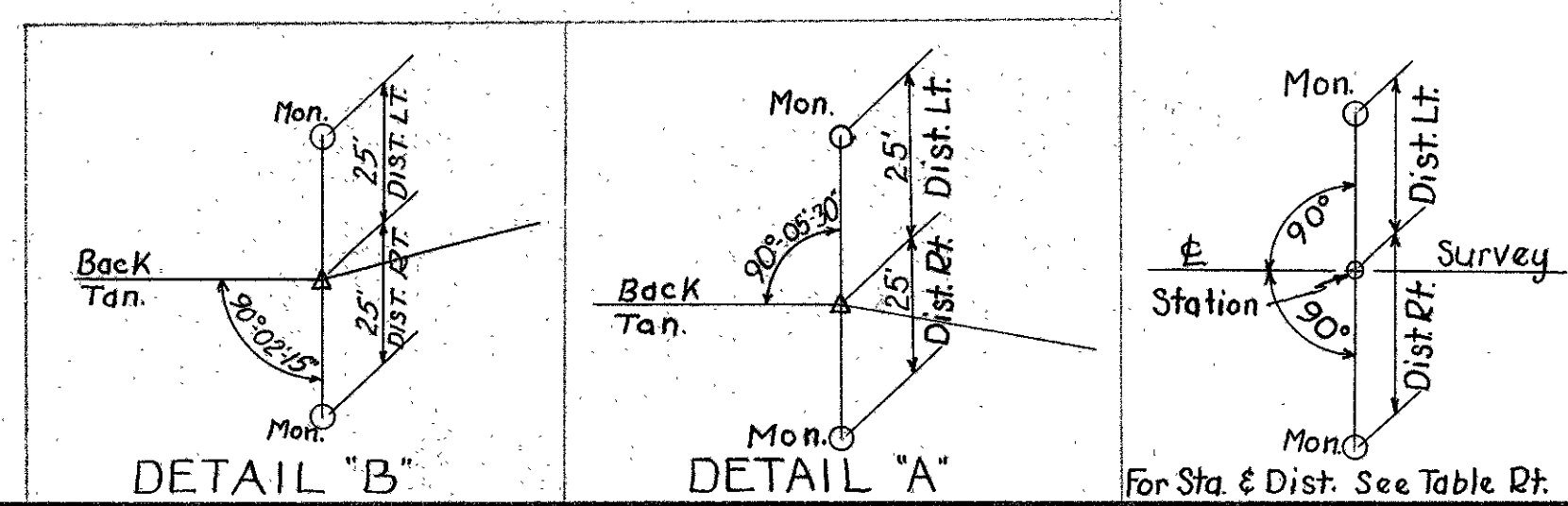

COMPLETED SETTING OF MONUMENTS BY: W. DOWNEY

RECORDED DATE: 5-6 1958  
VOL. 1  
PAGE 15

APPROVED: *For. M. Bowen*  
DATE: 29 April 1958  
RIGHT-OF-WAY ENGINEER - DIV. N<sup>o</sup> 7  
REGISTERED SURVEYOR N<sup>o</sup> 3128



# LOCATION PLAN

## STATE ROUTE 274

### LOGAN COUNTY

#### M<sup>c</sup>ARTHUR & RUSHCREEK TWP.

FED. RD. DIVISION	STATE	PROJECT	① 1
2	OHIO	1958	

LOGAN COUNTY  
LOG. 274-(14.92-16.9) Structures

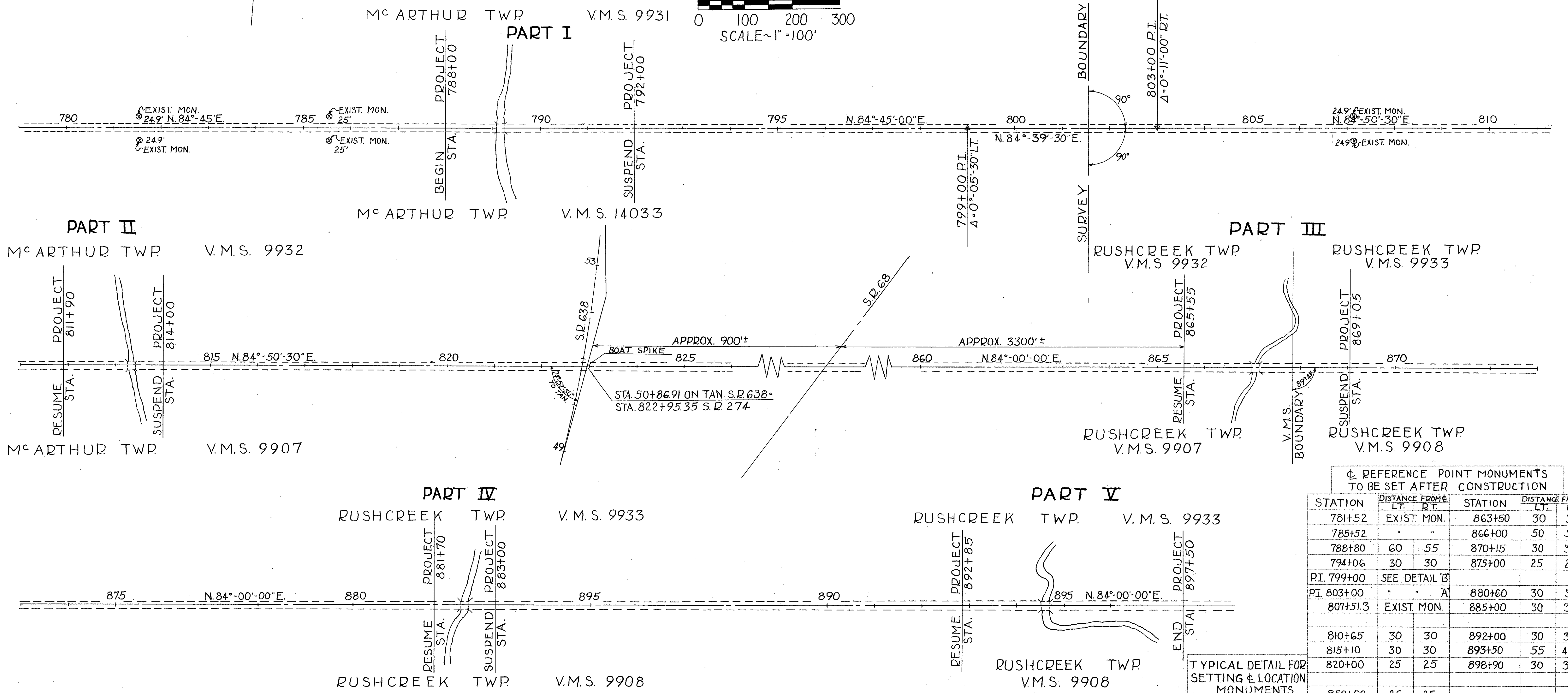
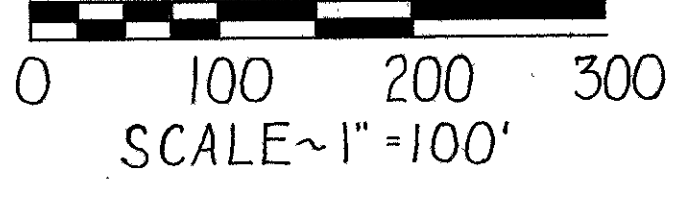
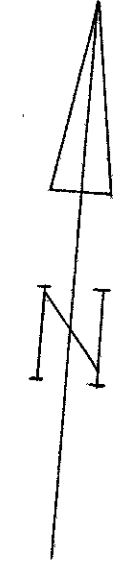

⊕ REFERENCE POINT MONUMENTS TO BE SET AFTER CONSTRUCTION

STATION	DISTANCE FROM		STATION	DISTANCE FROM	
	LT.	RT.		LT.	RT.
781+52		EXIST. MON.	863+50	30	30
785+52		"	866+00	50	50
788+80	60	55	870+15	30	30
794+06	30	30	875+00	25	25
PI. 799+00	SEE DETAIL 'B'				
PI. 803+00		"	880+60	30	30
807+51.3		EXIST. MON.	885+00	30	30
810+65	30	30	892+00	30	30
815+10	30	30	893+50	55	45
820+00	25	25	898+90	30	30
858+00	25	25			

TYPICAL DETAIL FOR SETTING & LOCATION MONUMENTS

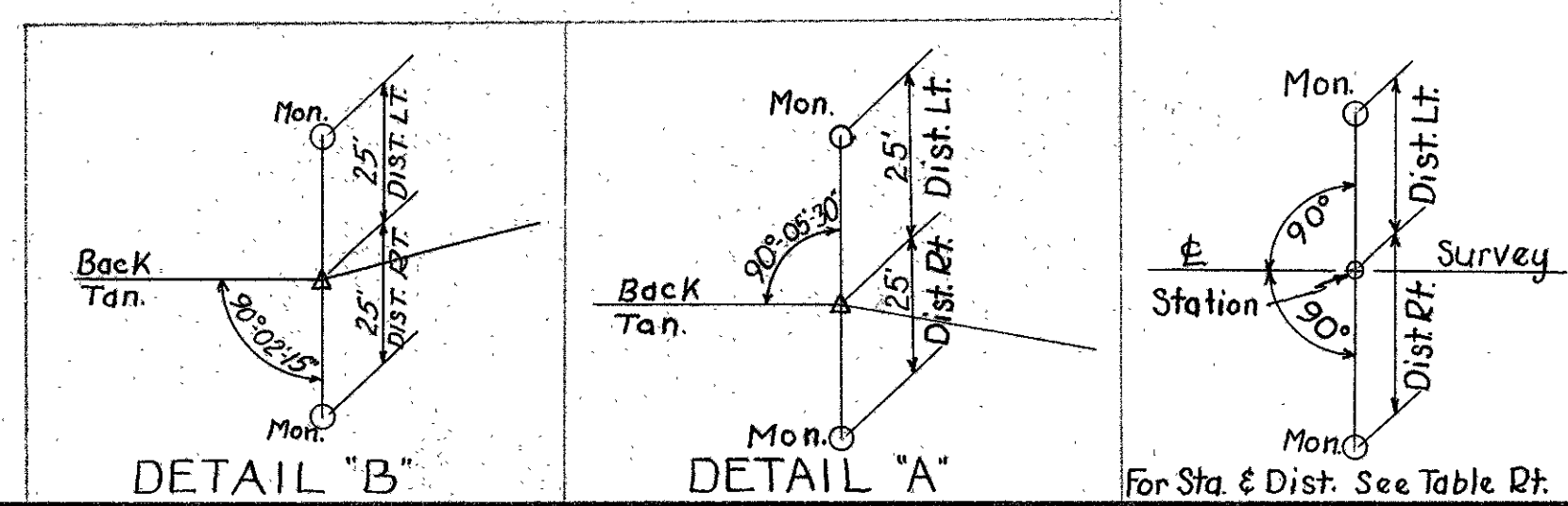

COMPLETED SETTING OF MONUMENTS BY: W. DOWNEY

RECORDED DATE: 5-6 1958  
VOL. 1  
PAGE 15

APPROVED: *Jos. M. Bowen*  
DATE: 29 April 1958  
RIGHT-OF-WAY ENGINEER - DIV. N<sup>o</sup> 7  
REGISTERED SURVEYOR N<sup>o</sup> 3128

# LOCATION PLAN

## STATE ROUTE 274

### LOGAN COUNTY

#### M<sup>c</sup>ARTHUR & RUSHCREEK TWP.

FED. RD. DIVISION	STATE	PROJECT	1 1
2	OHIO	1958	

LOGAN COUNTY  
LOG. 274-(14.92-16.9) Structures

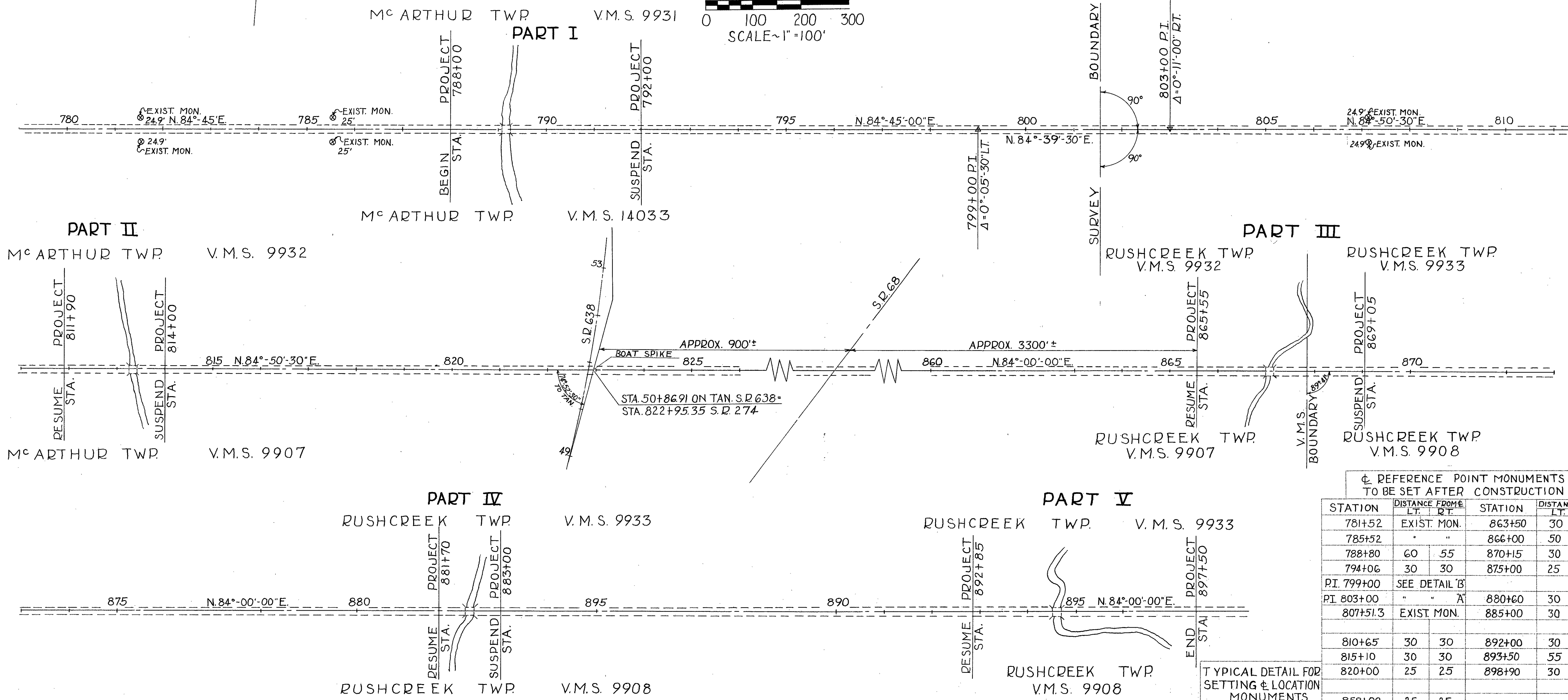
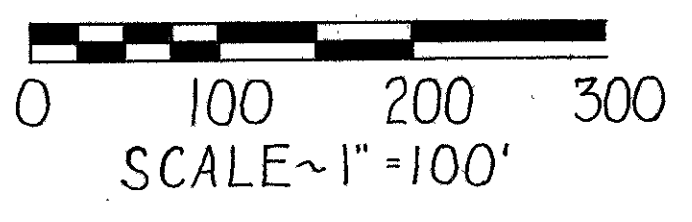

⊕ REFERENCE POINT MONUMENTS  
TO BE SET AFTER CONSTRUCTION

STATION	DISTANCE FROM		STATION	DISTANCE FROM	
	LT.	RT.		LT.	RT.
781+52	EXIST. MON.		863+50	30	30
785+52	"	"	866+00	50	50
788+80	60	55	870+15	30	30
794+06	30	30	875+00	25	25
PI. 799+00	SEE DETAIL 'B'				
PI. 803+00	"	"	880+60	30	30
807+51.3	EXIST. MON.		885+00	30	30
810+65	30	30	892+00	30	30
815+10	30	30	893+50	55	45
820+00	25	25	898+90	30	30
858+00	25	25			

TYPICAL DETAIL FOR  
SETTING & LOCATION  
MONUMENTS

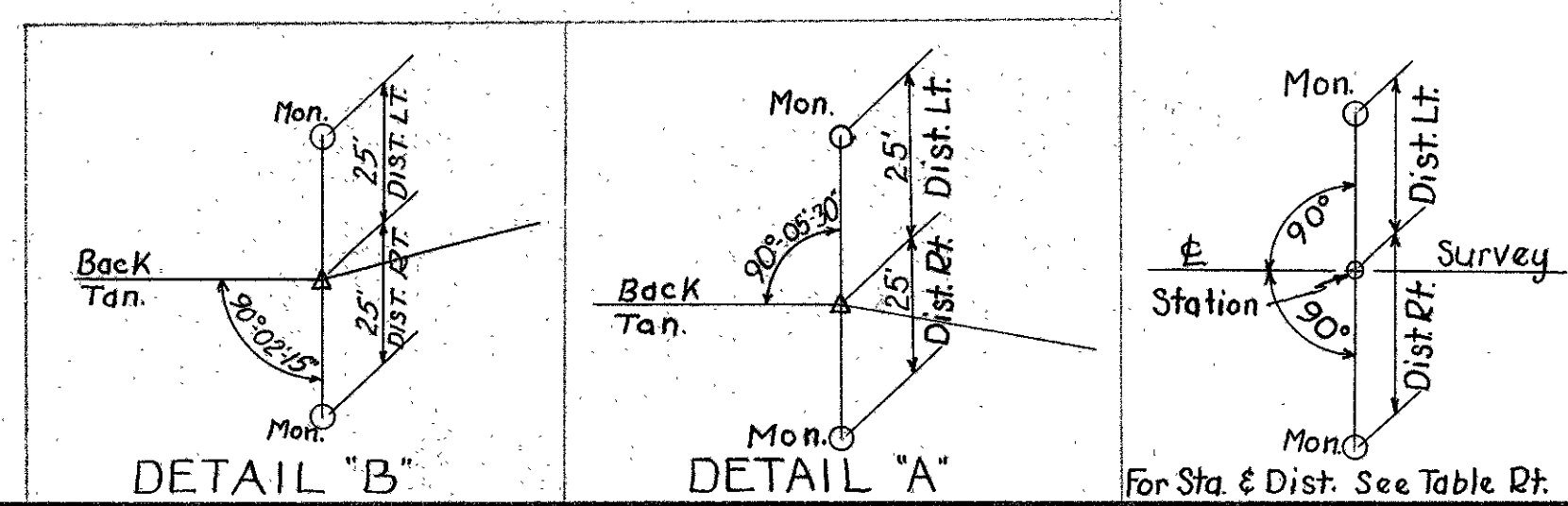

COMPLETED SETTING  
OF MONUMENTS BY: W. DOWNEY

RECORDED DATE 5-6 1958  
VOL. 1  
PAGE 15

APPROVED *For M. Bowen*  
DATE 29 April 1958  
RIGHT-OF-WAY ENGINEER - DIV. N<sup>o</sup> 7  
REGISTERED SURVEYOR N<sup>o</sup> 3128