

STATE OF OHIO
DEPARTMENT OF TRANSPORTATION

FHWA REGION	STATE	PROJECT
5	OHIO	

LOG-292-(2.19)(3.23)
PERRY TOWNSHIP
LOGAN COUNTY

R/W ONLY | LOG. 292-2.19/3.23

CONVENTIONAL SIGNS

LIMITED ACCESS	LA
PROPOSED R/W	R/W
VIRGINIA MILITARY SURVEY LINE	
PROPOSED EASEMENT	
CENTER LINE	
EXISTING R/W	
PROPERTY LINE	P/L
CORPORATION LINE	
EXISTING FENCE	
PROPOSED FENCE	
WATER LINE	W
GAS LINE	G
UNDERGROUND TELEPHONE	T
RAILROADS	
EXISTING RETAINING WALL	
PAVED SHOULDERS	
EXISTING SEWER	
PROPOSED SEWER	
EXISTING GUARD RAIL	
PROPOSED GUARD RAIL	

VALVES	⊗ TREES AND STUMPS	⊗
EXISTING MANHOLES	○ TREES AND STUMPS TO BE REMOVED	⊗
PROPOSED MANHOLES	● TELEPHONE OR TELEGRAPH POLE	⊗
MANHOLES ADJUSTED TO GRADE	○ LIGHT POLE	⊗
MANHOLES REMOVED OR ABANDONED	⊗ POWER POLE	⊗
EXISTING INLETS OR CATCH BASINS	⊗ WATER HYDRANT	⊗
PROPOSED INLET OR CATCH BASIN		
CATCH BASINS ADJUSTED TO GRADE		
CATCH BASINS REMOVED OR ABAND.		

INDEX OF SHEETS

PROJECT SURVEY PLAT	1
PROPERTY MAP	2
RIGHT OF WAY AND SUMMARY SHEET	3

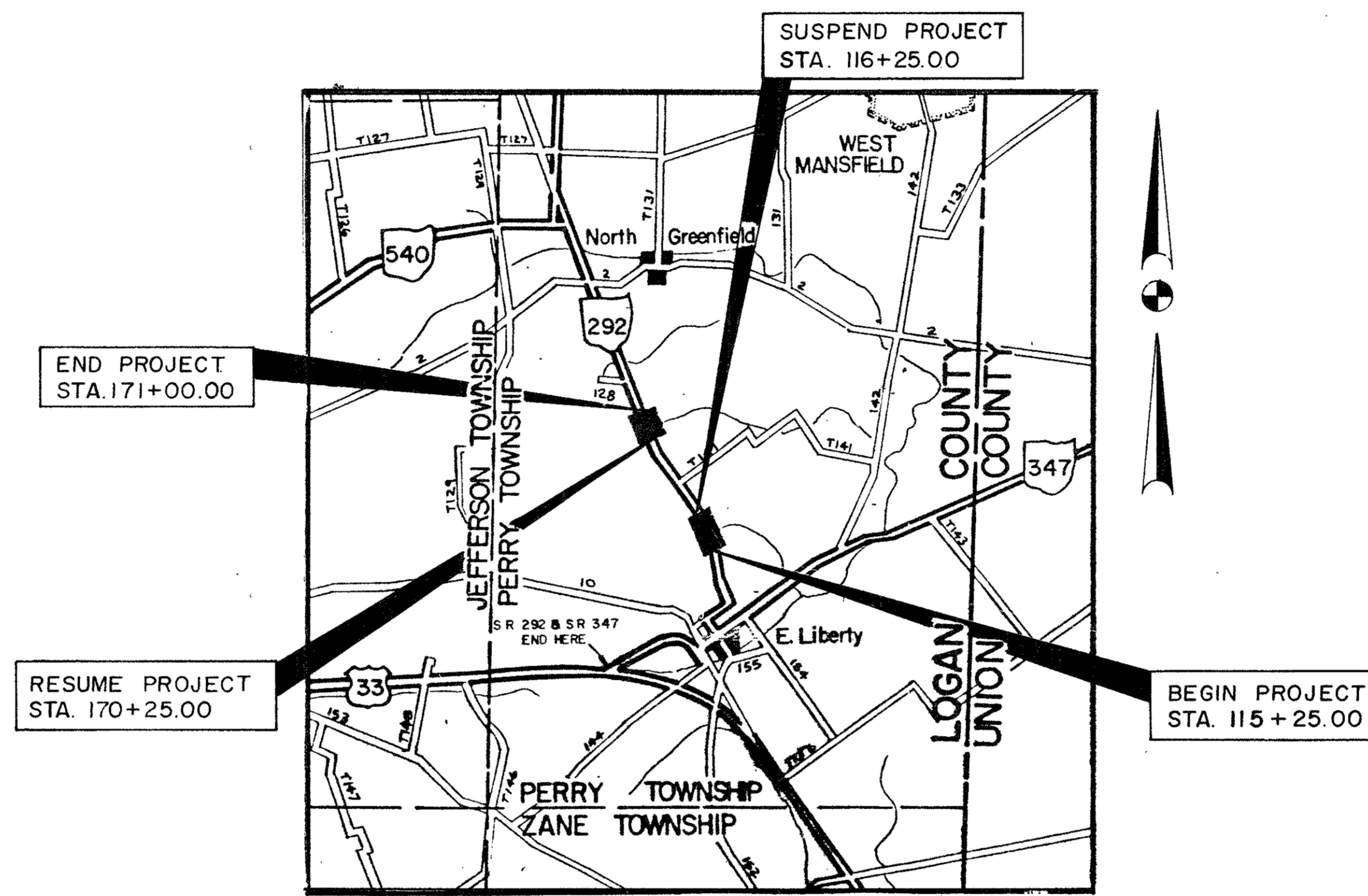

U.S. ROUTE	
STATE ROUTE	
OTHER ROADS	
PORTION TO BE IMPROVED	

1989 SPECIFICATIONS
THE STANDARD SPECIFICATIONS OF THE STATE OF OHIO, DEPARTMENT OF TRANSPORTATION, INCLUDING CHANGES AND SUPPLEMENTAL SPECIFICATIONS LISTED IN THE PROPOSAL, SHALL GOVERN THIS IMPROVEMENT.

I HEREBY APPROVE THESE PLANS AND DECLARE THAT THE MAKING OF THIS IMPROVEMENT WILL REQUIRE THE CLOSING TO TRAFFIC OF THE HIGHWAY AND THAT DETOURS WILL BE PROVIDED AS INDICATED ON THE PLANS.

STATE JOB NO. 07799(0)
P.I.D. NO. 5923

ACQUIRING AGENCY
THE RIGHT OF WAY FOR THIS IMPROVEMENT WILL BE PROVIDED BY THE STATE OF OHIO.

FOR THE STATE OF OHIO

APPROVED _____
DATE _____ ASSISTANT DEPUTY DIRECTOR FOR REAL ESTATE ADMINISTRATION
APPROVED _____
DATE _____ DIRECTOR, DEPARTMENT OF TRANSPORTATION

FILE NO.	PROJECT LOG-292-2.19/3.23
DATE OF LETTING	CONTRACT NO.

PLANS PREPARED BY
UNITED CONSULTANTS & ASSOCIATES
ENGINEERS, ARCHITECTS & LAND SURVEYORS
1187 E. BROAD STREET
COLUMBUS, OHIO 43205

DEPARTMENT OF TRANSPORTATION
FEDERAL HIGHWAY ADMINISTRATION
APPROVED
DIVISION ADMINISTRATOR DATE

STATE OF OHIO
DEPARTMENT OF TRANSPORTATION

PROJECT SURVEY PLAT
LOG-292-(2.19)(3.23)
PERRY TOWNSHIP, LOGAN COUNTY
PART I-VMS NOS. 4655, 4689, 4810
PART 2-VMS NOS. 5091, 12103, 13432, 13529

F.H.W.A. REGION	STATE	PROJECT
5	OH:O	

23
25

LOGAN COUNTY
LOG-292-(2.19)(3.23)

1
3

STATE JOB NO. 07799(O)
P.I.D. NO. 5923

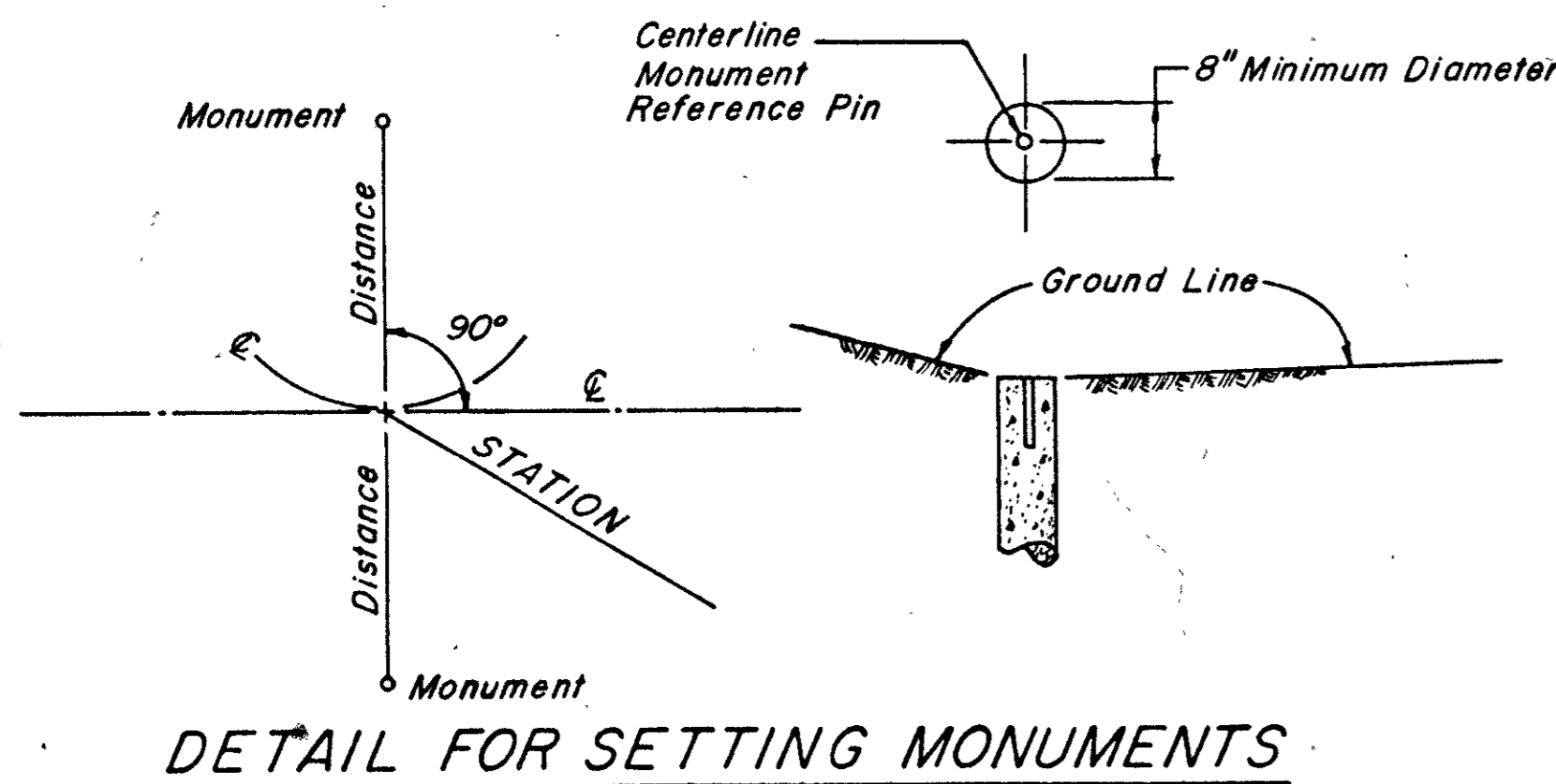
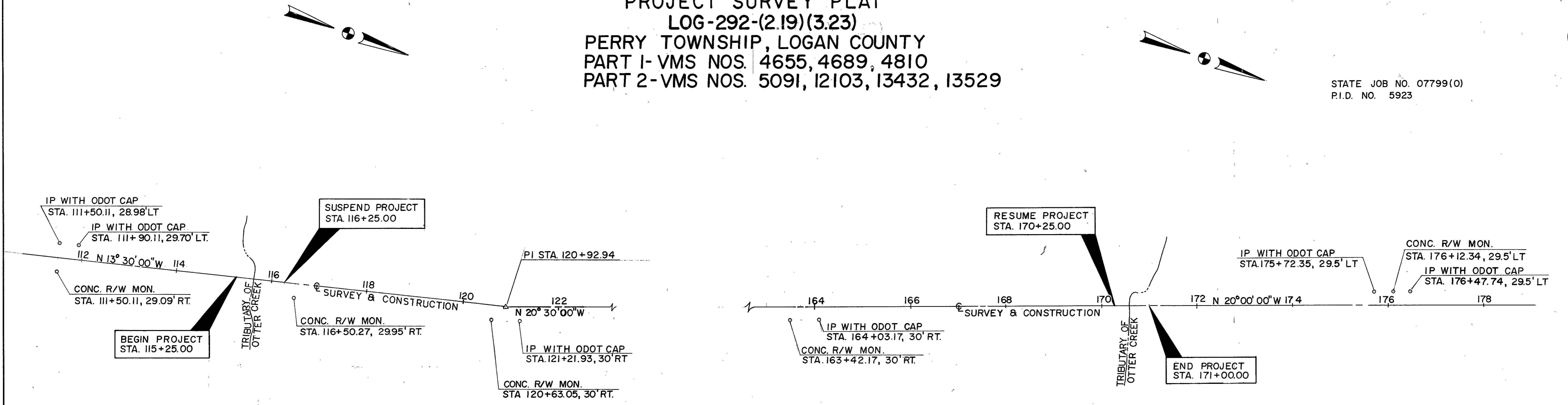

REFERENCE MONUMENTS TO BE SET AFTER CONSTRUCTION

PART 1 STATION	DIST. FR. C		PART 2 STATION	DIST. FR. C	
	LT.	RT.		LT.	RT.
115+00.00	19'	19'	170+00.00	19'	19'
116+00.00	19'	19'	171+00.00	19'	19'

I hereby certify that this plat is a true delineation of a survey made for the Ohio Department of Transportation in 198 by United Consultants and Associates.

Richard D. Marang Date
Ohio Registered Surveyor N° 5882

DEPUTY DISTRICT DIRECTOR _____ DATE _____

Received _____
Date _____
Book _____ Page _____
By _____
COUNTY RECORDER

