

Surveyed for Ephraim Ralph 651 acres of land on part of a Military Warrant No. 4096 on the waters of Cherokee-manus run; beginning at an ash, beech and red oak, northeast corner to Joseph Hites survey No. 9884 and Northwest corner to Doctor Luns survey No. 9885 thence N. 12. W. 392 poles to a hickory beech, black ash, and three hornbeams thence S. 78. W. 265 poles to a hickory and two red oaks northeast corner to Thomas Pearsons survey No. 9906, thence with his line S. 12. E. 392 poles to a double Ironwood southeast corner to said

Pearsons survey; thence with a line of Hites survey N. 77° 20' E 265 poles to the beginning.

Levi D. Sharp
 Hilkiah Roxbrog & C. C.
 Wilson S. Thompson M. R.

Samuel Forrer D. S.
 January 10th 1820
 March 16th 1821

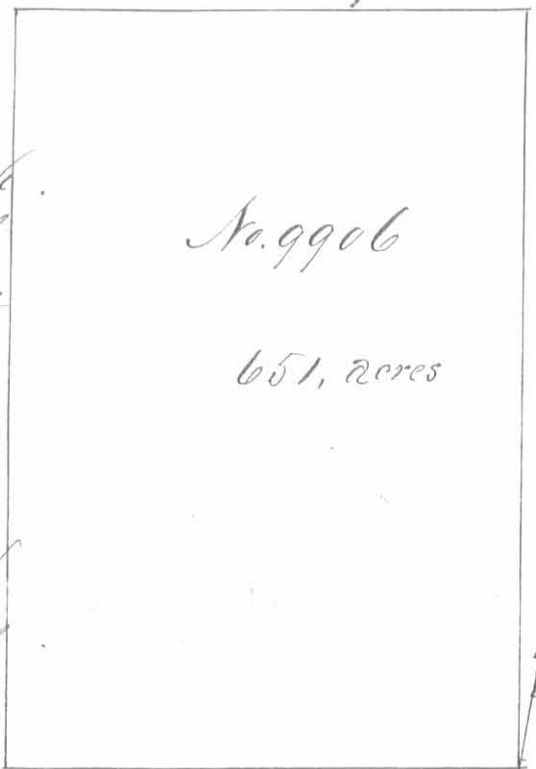

Surveyed for Thomas Pearson 333 acres of land on a Military Warrant No. 5448 on the waters of big Miami Beginning at a white oak and ash southeast corner of Simon Sommers survey No. 9905 northeast corner to Mark Hardins survey No. 9883 and Northwest corner to Joseph Hites survey No. 9884; thence with Hites line N. 77° 20' E 135 poles to a double Ironwood thence N. 12. W. 395 poles to a hickory and two red oaks; thence S. 78. W. 135 poles to a hickory and sugar tree northeast corner to Sommers said survey; thence with his line S. 12 E. 395 poles crossing a branch at 126 poles to the beginning.

Levi D. Sharp
 Hilkiah Roxbrog & C. C.
 Wilson S. Thompson M. R.

Samuel Forrer D. S.
 January 10th 1820
 March 16th 1821

No. 9971
150, acres

Surveyed for Nathaniel Beale 150 acres of land on part of a military warrant No 5835 on the waters of Big Koyami; beginning at a buck eye and ash northeast corner to Michael Bowyers survey No. 9950 and northwest corner to Bowyers survey No. 9951, thence N. 12 N. 140^o 2 poles to two beeches thence S. 78. W. 171 to an elm and buckeye in a line of Temple and others survey No 9971, thence with said line S. 12. E. 140^o poles to a beech, elm and buckeye, southeast corner to said Temple and others survey, in the line of Bowyers survey No. 9950; thence with said line N. 78 E. 178 poles to the beginning.

Luci O Sharp
Michael Redrag B & C
William L Thompson Mkr.

Samuel Ferrer D.S.
March 2nd 1820
March 15th 1821

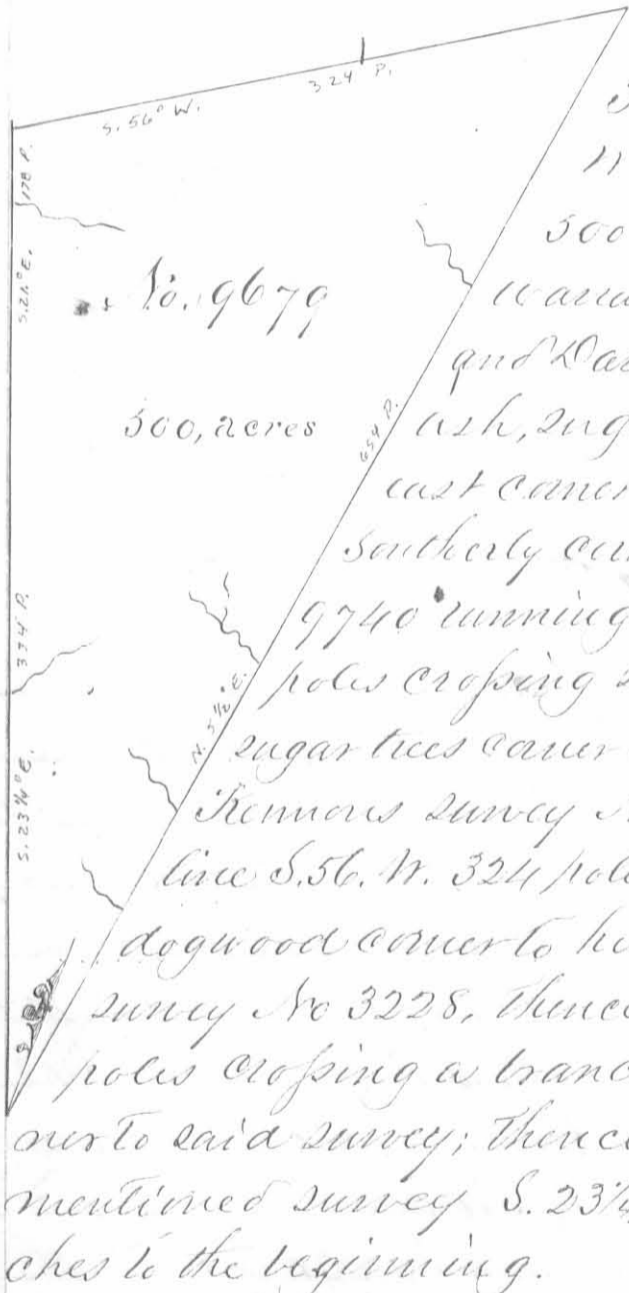

Surveyed for Joseph and Benjamin M Sadd and Thomas Towell 300 acres of land on part of a military warrant No. 5850 on the waters of Head river and Darlys Creek; Beginning at a blue ash, sugar tree and two dead mulberries, southeast corner to Augustine S Smiths survey No 3230 southerly corner to Walter Duns survey No. 9657, 9740 running with said Duns line N. 51^o E. 654 poles crossing several branches to a red oak and two sugar trees corner to his survey in the line of Richard Kennons survey No. 4570; thence with said Kennons line S. 56. W. 324 poles to three sugar trees, a lynn and dogwood corner to his survey in the line of said Smiths survey No 3228, thence with said Smiths line S. 21. E. 178 poles crossing a branch to two sugar trees, southeast corner to said survey; thence with the line of said Smiths first mentioned survey S. 23 1/4 E. 334 poles crossing several branches to the beginning.

William Sharp
Joshua Crain B & C.
Samuel Sharp Mkr.

James Galloway junr D.S.
November 20th 1819
July 25th 1820

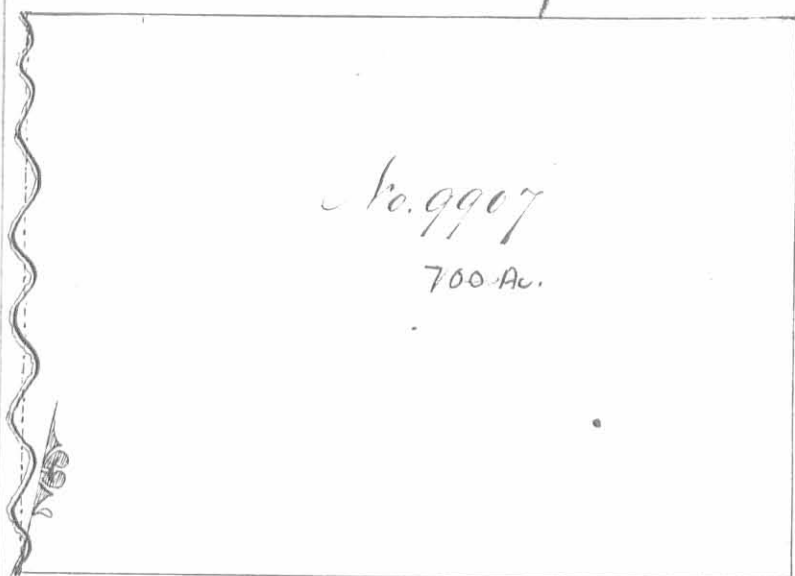

No. 9907

700 Ac.

Surveyed for Thomas Bourne,
700 acres of land on part of
a military Warrant No 64
on the waters of Big Miami
Beginning at an ash beech
and red oak, south east cor-
ner to Ephraim Ralphs sur-
vey No. 9906 and Northwest
corner to Walter Duns Survey
No 9905; Thence with Duns

line N. 77 $^{\circ}$ E. 400 poles to three burr oaks and a beech on the
North side of a swamp, northeast corner to said Duns survey,
thence N. 12 W. 278 poles to a stake, thence S. 78 W. 400 poles to
a stake in Ralphs line; thence with his line S. 12 E. 283 poles
with the course of a branch to the beginning.

Levi D. Sharp
Mikiah Rosbag & Co
Wilson S. Thompson M.k.r.

Samuel Ferrer D.S.

January 10. 1820

December 8. 1820

Surveyed for Thomas Bourne
272 acres of land on part of a
Military warrant No 64 on
the waters of big Miami; be-
ginning at a hickory, beech

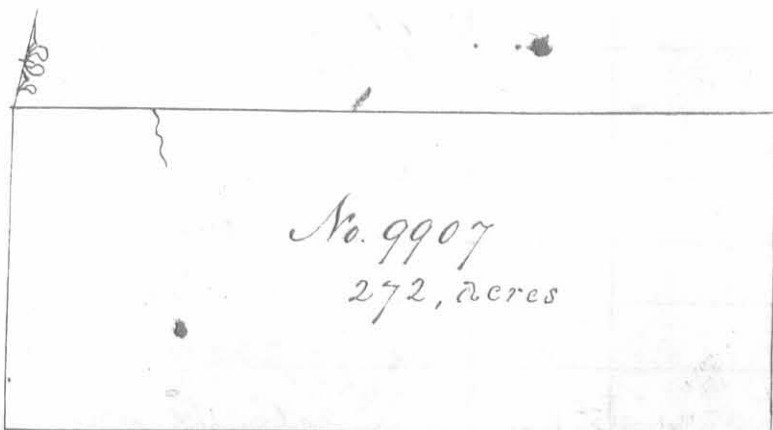

No. 9907

272, acres

black ash and three horn beams Northeast corner to Ephraim Ralphs
survey No 9906; thence with his line S. 12 E. 109 poles to a stake
northwest corner to said Bournes survey No 9907 for 700 acres
thence with his line N. 78 E. 400 poles to a stake in a line of
Whiswell Barretts survey No. 9908 and Northeast corner to
said Bournes survey; thence with Barretts line N. 12 W. 109 poles
to a sugar tree hickory, hornbeam and two beeches southeast
corner to Henry Measies survey No. 9932, thence with his line
S. 78 W. 400 poles crossing a branch at 330 poles to the beginning

Levi D. Sharp
Mikiah Rosbag & Co
Wilson S. Thompson M.k.r.

Samuel Ferrer D.S.

January 10th 1820

December 8. 1820

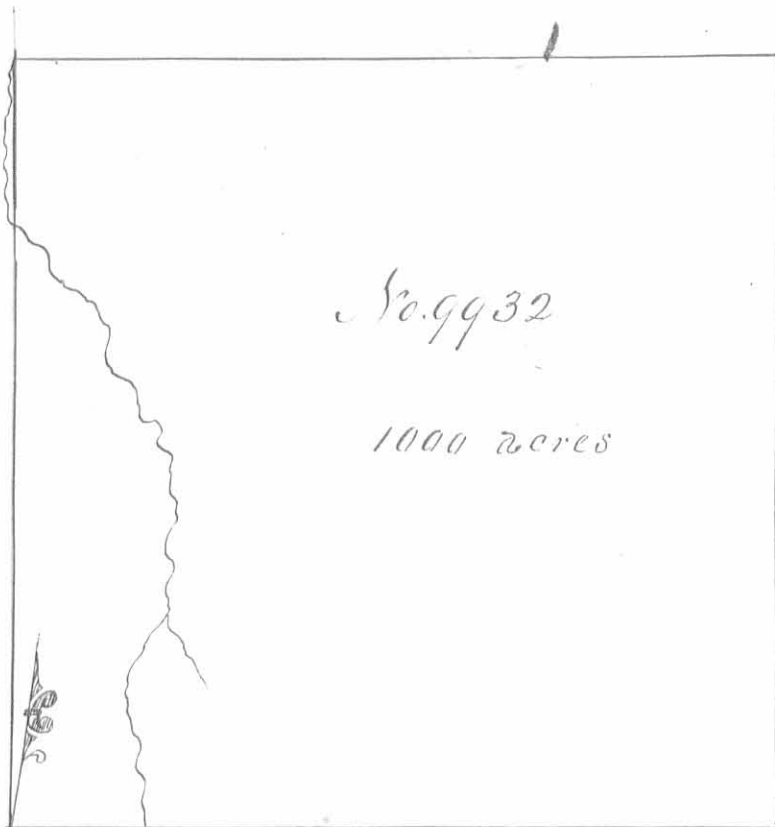

Surveyed for Henry Meaple
1000 acres of land on seven Military Warrants and part of two others; No. 5094. 5199. 4069. 5203
5204. 5208. 5364. 78 acres on 5207
and 22 acres on 5372 on the waters of Big Miami; beginning at a hickory, ash, beech and horn beam southeast corner to James Taylors survey No 9931 and northwest corner to Thomas Bennes survey No 9907, thence with his line N. 78. E. 400 poles

crossing a branch at 70 poles to two beeches a sugar tree and horn beam, thence N. 12 W. 400 poles to a red oak and beech; thence S. 78. W. 400 poles to three elms on the bank of a branch thence S. 12. E. 400 poles crossing the branch at 90 poles to the beginning.

Levi D. Sharp
Milkiah Rosbrag 3. C.C.
Wilson L. Thompson M.R.

Samuel Ferrer D.S.
January 18th 1820
December 7th 1820

Surveyed for James Barton
500 acres of land in part of a
Military Warrant. No 6653
on the waters of Big Miami:

Beginning at three beeches
southeast corner of James and
William Taylors survey No 9954 and northeast corner to
Wallaces survey No 9934 thence N 78 E. 400 poles crossing
Sandusky road to two beeches; thence N. 12. W. 200 poles crossing
a branch at 126 poles to a stake, thence S 78 W 200
poles crossing two branches to a stake in a line of said Tay-
lors survey, thence with said line S 12 E 200 poles crossing
a branch at 20 poles to the beginning.

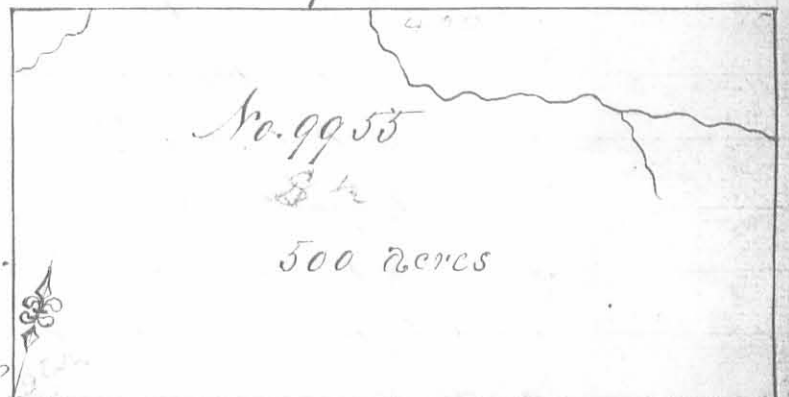

Levi D. Sharp
Milkiah Rosbrag 3. C.C.
Wilson L. Thompson M.R.

Samuel Ferrer D.S.
February 28th 1820
December 8th 1820

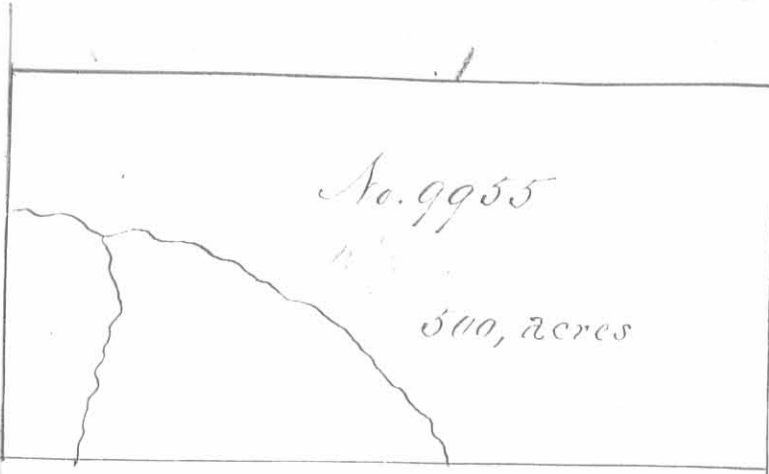

Surveyed for James Barton 500 acres of land on part of a Military War-rant No. 6053 on the waters of Big Miami; beginning at three beeches Northeast corner of James and William Taylors survey No 9954, thence N. 78. E. 400 poles to a hickory

beech and sugar tree, thence S. 12. E. 200 poles to a stake northeast corner to said Bartons survey No 9955; thence S. 78 W 400 poles to a stake northwest corner to said survey in a line of said Taylors survey; thence with said line S. 12. E. 200 poles crossing a branch at 130 poles to the beginning.

Levi D. Sharp
 Hilkeah Rosebrog & Co.
 Wilson S. Thompson M.k.r.

Samuel Forrer D.S.
 February 28. 1820
 December 8th 1820

Surveyed for George Clark a part 1000 acres of land on part of a Military No 5382 on big Miami and Cherokee mans run: Beginning at a Burr oak and beech northeast corner of Walter Duns Entry No. 9925, 1200 poles W from the intersection of Roberts line with the Greenville Treaty line; thence N. 78 E. 400 poles crossing the run at 203 at 214 and at 236 poles to a bur oak and elm northeast corner to Nathan Reeves

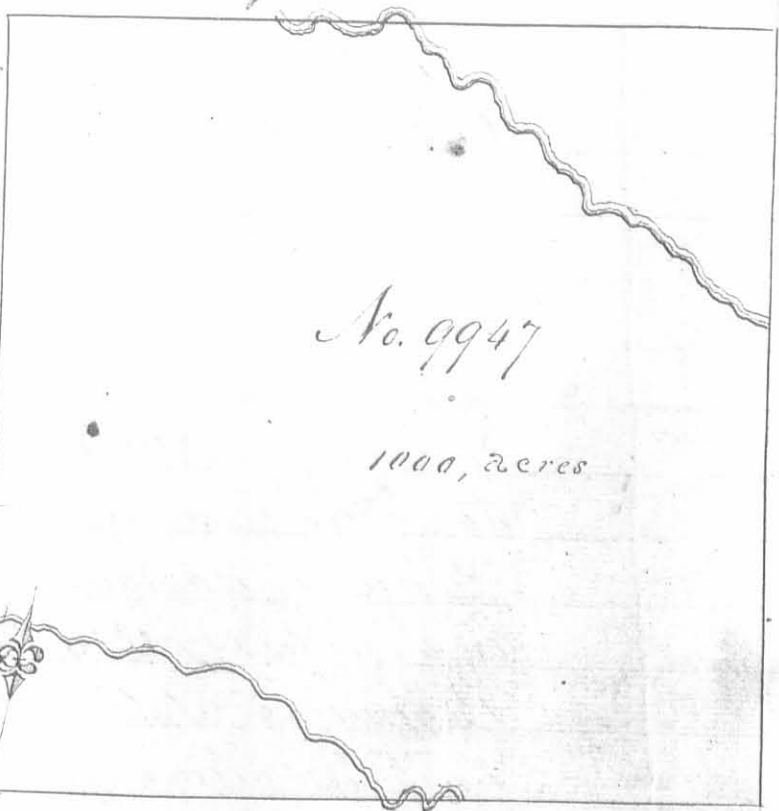

Survey No 9927; thence N. 12. W. 400 poles crossing the Miami at 248 poles to two buckeyes and two sugar trees; thence S 78 W 400 poles crossing the Miami at 190 poles and several times afterwards, leaving it at 256 poles to an iron wood and two beeches on the south side of Miami; thence S. 12. E. 400 poles crossing the run at 214 poles to the beginning.

Levi D. Sharp
 Hilkeah Rosebrog & Co
 Wilson S. Thompson M.k.r.

Samuel Forrer D.S.
 January 26. 1820
 December 8th 1820

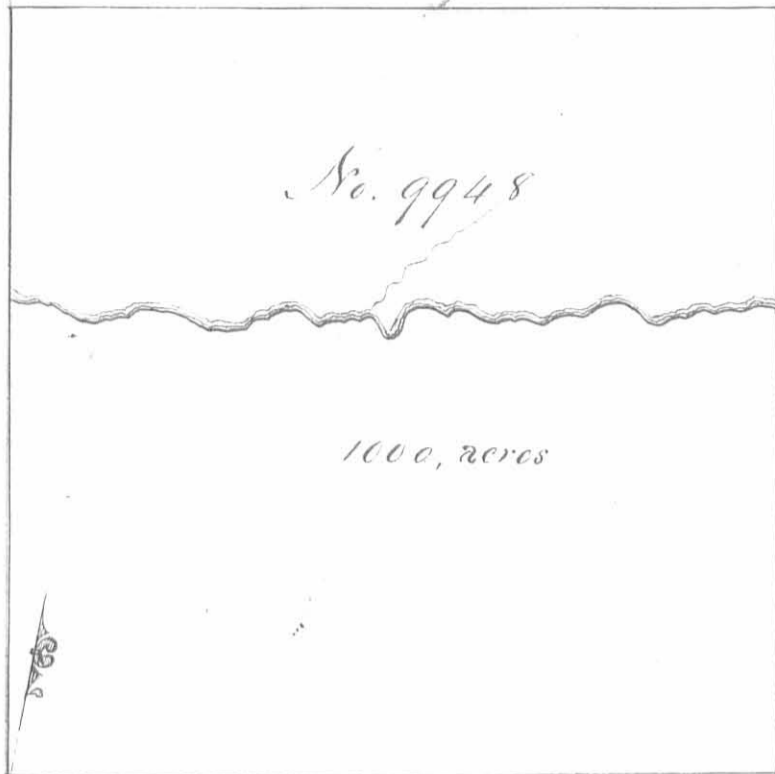

Surveyed for George Clark 1000 acres of land on part of two Military warrants, 278 acres on No 5382 and 722 acres on No. 5514 on the waters of Big Miami; beginning at a bur oak and elm southeast corner of said Clarks survey No. 9947, thence N. 78 E. 400 poles to four elms north west corner to Robert Meaus entry No. 9929, thence N. 12. W. 400 poles crossing main branch of Miami to three beeches

thence S. 78. W. 400 poles to two sugar trees and two beeches at northeast corner to Clark and others survey; thence with said line S. 12 E. 400 poles crossing the branch at 152 poles to the beginning.

Levi D Sharp
 Wilkiah Roxbrog J. C. C.
 Wilson L Thompson M. L. R.

Samuel Ferrer D. S.
 January 27th 1820
 December 8th 1820

Surveyed for George Clark, Thomas Miller ap^{pe} and the Representatives of Thomas Christie 600 acres of land on part of three Military warrants; Clark 175 acres on No 5513 Miller 200 acres on No. 3538 and Christie 225 acres on No. 6044 on the waters of Big Miami; beginning at a sugar tree, hickory hawbeam and two beeches southeast corner of Henry Meapies survey No 9932 and Northwest corner to Churchill Parrill survey No. 9908; thence with Parrill's line N. 78 E. 240 poles to a stake; thence N. 12. W. 400 poles crossing a branch to a stake; thence S. 78 W. 240 poles to a red oak and beech north east corner to Meapies said survey; thence with his line S. 12 E. 400 poles crossing a branch to the beginning.

Levi D Sharp
 Wilkiah Roxbrog J. C. C.
 Wilson L Thompson M. L. R.

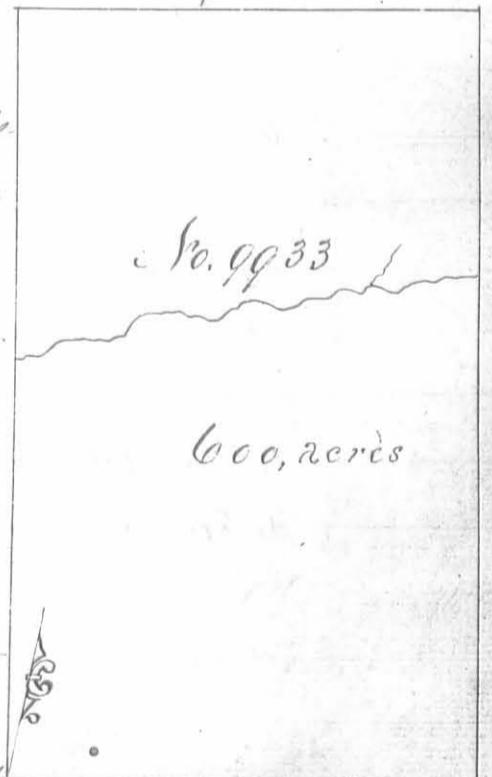

Samuel Ferrer D. S.
 January 19th 1820
 December 9th 1820

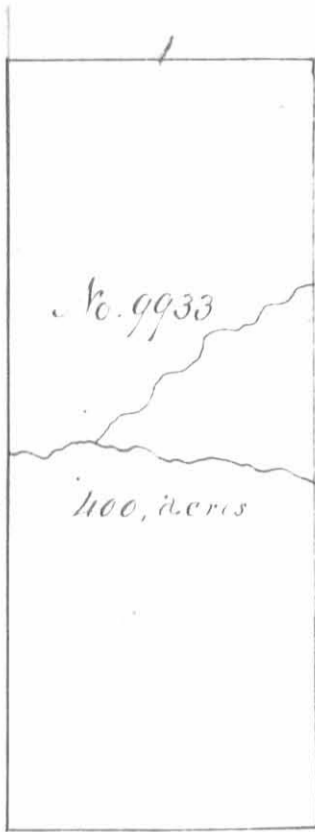

Surveyed for the Representatives of Thomas Christie 100 acres of land or part of a Military Warrant No 6044 on the waters of Big Miami: Beginning at a red oak, elm and sugar tree Northeast corner to Chiswell Parrells survey No 9908 and Northwest corner to Saylor and others survey No 9909, thence N. 12. W. 100 poles crossing a drain at 184 and a branch at 202 poles to three beeches; thence S. 78 W 100 poles to a stake northeast corner to Clark, and others survey No 9933 for 600 acres; thence with their line S. 12. E. 400 poles crossing the branch to a stake south east corner to said survey in a line of Chiswell Parrells survey No. 9908; thence with said line N. 78 E 100 poles to the beginning.

Levi D. Sharp
 Wilkiah Rosebrag C. C.
 Wilson S. Thompson Mkr.

Samuel Ferrer D.S.
 January 29th 1820
 December 9th 1820

Surveyed for Thomas Keller 200 acres of land or part of a Military Warrant No 3838 on the waters of the big Miami Beginning at a stake in the line of Chiswell Parrells survey No 9908, Southwest corner to the representatives of Thomas Christies survey No 9933; thence with Christies line N 12 W. 100 poles crossing a branch to a stake Northwest corner to said survey; thence S. 78 W 80 poles to a stake Northeast corner to Clark and Christies survey No. 9933 Thence with their line S. 12. E 400 poles crossing a branch to a stake southeast corner to said survey in Parrells said survey; thence N. 78 E 80 poles to the beginning

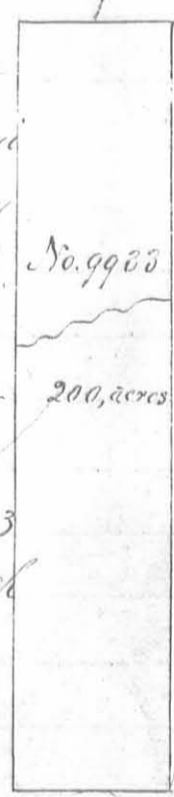

Levi D. Sharp
 Wilkiah Rosebrag C. C.
 William S. Thompson Mkr.

Sam. Ferrer D.S.
 December 28th 1822
 January 28th 1823

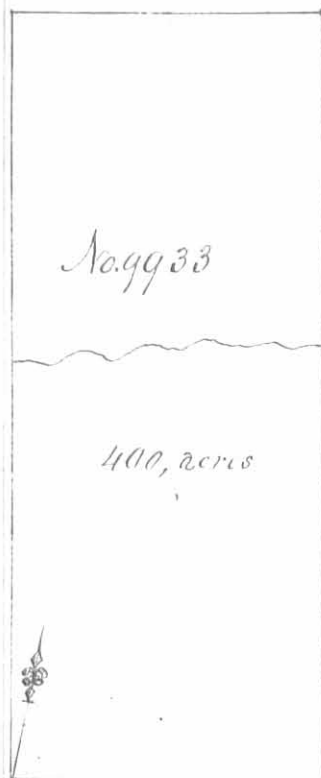

Surveyed for George Clark Esq^r and the Representatives of Thomas Christie 400 acres of land on part of two Military Warrants, Clark 175 acres on No 5513 and Christie 225 acres on No 6044 on the waters of Big Miami: Beginning at a Sugar Tree, hickory, hain beam and two beeches Southeast corner to Henry Hoopier Survey No. 9932 and Northwest corner to Chiswell Barrells Survey No. 9908; thence with Barrells line N. 78 E. 160 poles to a stake, thence N. 12. W 400 poles crossing a branch to a stake; thence S. 78 W. 160 poles to a red oak and beech northeast corner to said Hoopier said Survey; thence with his line S. 12 E. 400 poles crossing a branch to the beginning.

Livi D Sharp
 Wilkiah Roxbrag B. C. C.
 Wilson S Thompson Mkr.

Saml Forrer D. S.
 December 28th 1822
 January 28th 1823

Surveyed for the representatives of Willoughby Tibbs, John Tibbs and Mark Vanderwall 959 acres of land on part of three Military Warrants; the representatives of Tibbs 370 acres on No. 5404, John Tibbs 500 acres on No. 4946 and Vanderwall 89 acres on No. 139 on the waters of Bokes Creek: Beginning at a beech and two sugar trees Southeast corner to James Taylors survey No 9914 and Northwest corner to Karsdale and others survey No. 9893; Thence with the line of survey No. 9893 N. 78 E. 400 poles, crossing a branch at 358 poles to an ash sugar tree and cypress northeast corner to said survey; thence N. 12 W. 383 poles to a Hoopie ash and spanish oak; thence S. 78. W. 400 to a beech and two sugar trees north east corner to Taylors said survey; thence with his line S. 12. E. 383 poles to the beginning.

Livi D Sharp
 Wilkiah Roxbrag B
 Wilson S Thompson Mkr.

Samuel Forrer D. S.
 January 14th 1820
 March 9th 1821

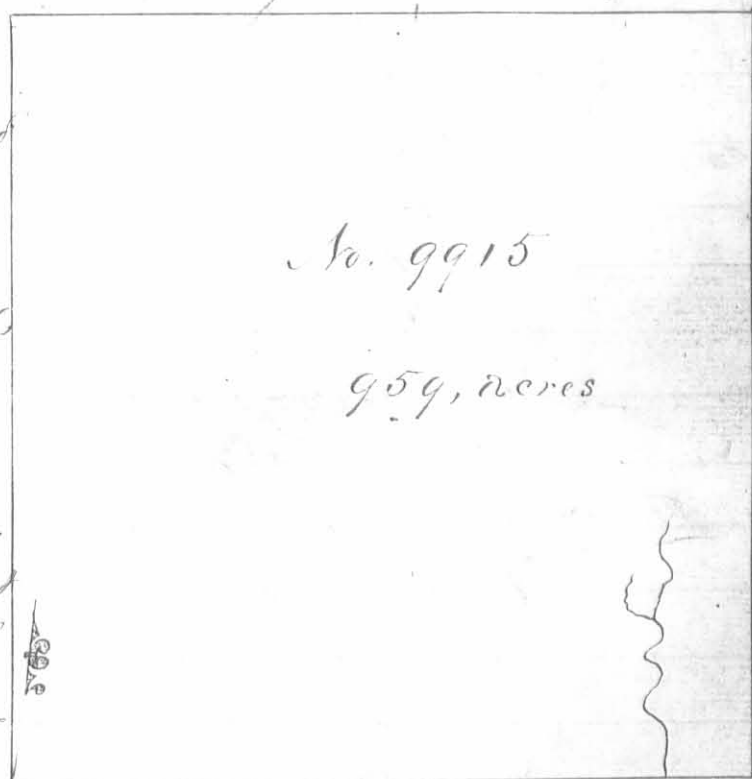

Surveyed for Walter Dumas 502 acres of land on part of nine Military warrants, 200 acres on No 5885 64 acres on No. 5749, 8 acres on No 6124, 80 acres on No 5887. 11 acres on No. 5963, 13 acres on No 6062 6 acres on No 5765 72 acres on No 5916, and 48 acres on No 6173 on the waters of Mad River: Beginning at two white oaks, southwesterly corner to Holland Stancys survey No 3222 and Northwesterly corner to said Stancys survey No 3224 Thence with the line of survey No 3222 N. 21. W. 320 poles to a black oak and hickory Northwesterly corner to survey No 3222, thence S. 69. W. 68 poles crossing a spring branch at 34 poles to a white oak and red oak the most southerly corner to said Duns survey No. 9592, 9618 & 10075, thence N 86. or 45 poles to two hickories and a white oak corner to Duns said survey in the line of Anthony Singletons survey No. 4943, thence with said line S. 20. E. 198 poles crossing a branch at 97 poles to two white oaks and a black walnut easterly corner to Singletons said survey; thence with another of his lines S. 70. W. 190 poles to three black oaks from one root his south easterly corner in the line of Samuel Finleys survey No. 4193 & 4525; thence with said line S. 20 E 133 poles to a black oak and hickory in said line a Northerly corner to Zadock Wackers survey No 6516 thence N 70 E. 100 poles to a hickory the most northerly corner to Wackers said survey; thence S. 20. E. 182 poles crossing a small branch at 123 poles to a stake in the line of Thomas Worthingtons survey No 4479 and easterly corner to Wackers said survey; thence with Worthington line N. 70 E 80 poles, crossing the prairie branch at 20 poles to a stake in said line, thence N. 21 W. 121 poles crossing the prairie branch to two black oaks thence N. 69 E 127 poles crossing the prairie branch at 40 poles to three hickories in the line of said Stancys survey No. 3224 thence with said line N. 21. W. 54 poles to the beginning.

Causly Pope

Jr. at 3 O.C.

Aaron Hunt M.K.R.

Thomas J. Matthews D.S.

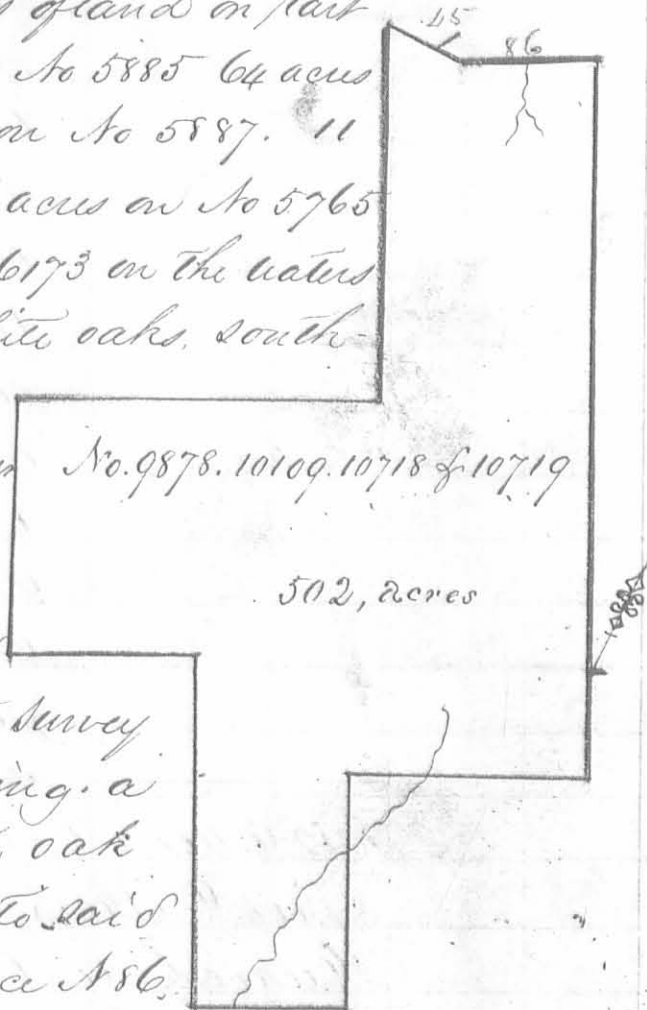
July 2nd 1821July 21st 1821

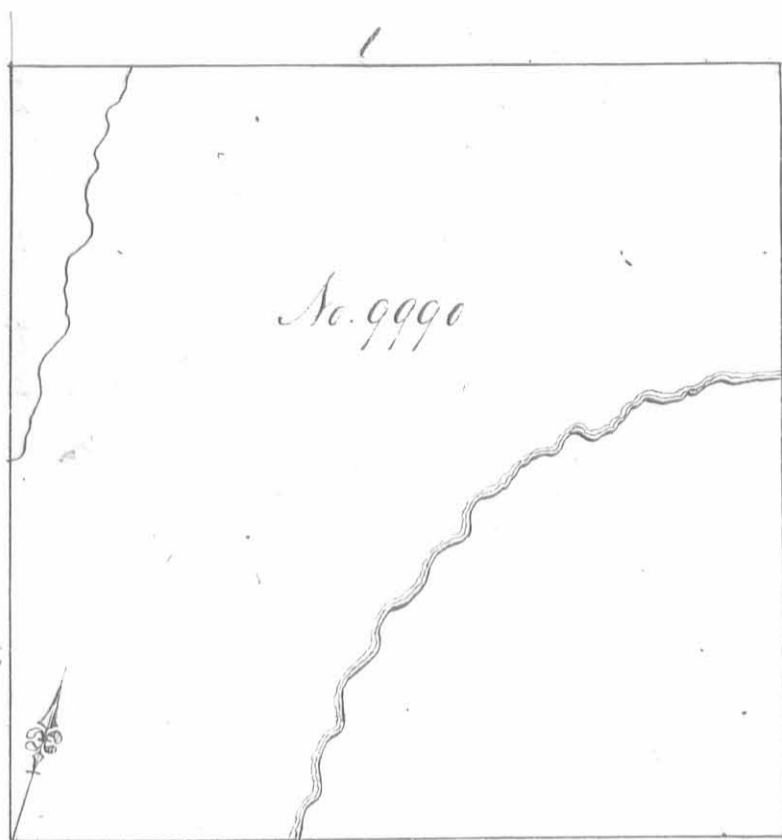

Surveyed for Ephraim Raepke
1000 acres of land on part of a
Military Warrant No 4906 on
the waters of the Big Miami:
Beginning at a small ash and
two beeches southeast corner of
Thomas Overton Survey No. 9989
thence N. 78 E. 400 poles crossing
the main branch of Miami at
144 poles to a beech sugar tree
and dogwood northeast corner
of Robert McCaus Survey No
9973, thence N. 12 W. 400 poles

crossing the branch at 240 poles to an elm and two live oaks
thence S. 78 W. 400 poles crossing a branch at 342 poles to two
beeches, thence S. 12 E. 400 poles with the line of said Overton
survey to the beginning.

Levi D Sharp
Nehemiah Roselrag J. C. C.
Nelson S Thompson M. A. S.

Samuel Forrer D. S.
March 9th 1820
July 21st 1820

Surveyed for Oliver Barrett, 481 acres of land
on part of a military warrant No. 2257 on the
waters of Big Miami and Rush Creek; beginning
at three live oaks and a beech southeast corner
to Thomas Borne's survey No. 9907 and northeast
corner to Walter Duns survey No 9885, thence
with a line of Entry No 9886 N. 77 $\frac{1}{2}$ E. 199 $\frac{1}{2}$
poles to a stake; thence N. 12 W. 385 poles
crossing a small branch to a stake; thence
S. 78 W 199 $\frac{1}{2}$ poles to a haw beam, sugar tree
hickory and two beeches, northeast corner
to said Borne's survey; thence with his
line S. 12 E. 387 poles crossing a branch to the beginning.

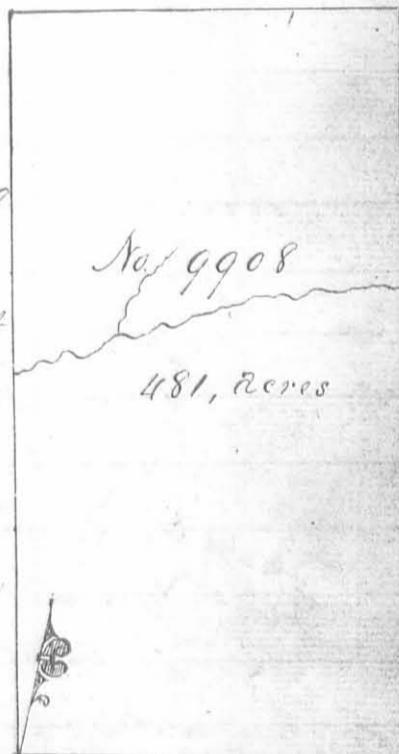

Levi D Sharp
Nehemiah Roselrag J. C. C.
Nelson S Thompson M. A. S.

Samuel Forrer D. S.
January 10th 1820
December 12th 1820

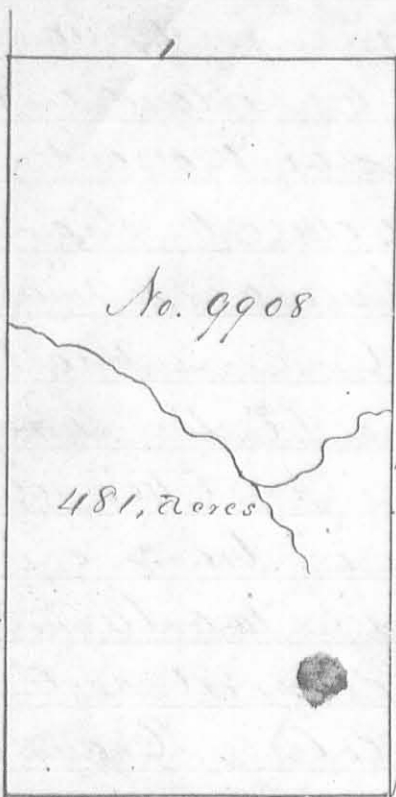

Surveyed for Oliver Barrett 481 acres of land on part of a military warrant No 2257 on the waters of big Miami and Rush Creek: Beginning at a blue ash and beech northwest corner of Hite and others survey No. 9887; thence N 12 W. 383 poles to a red oak elm and sugar tree; thence S. 78 W. 200 1/2 poles to a stake northeast corner to said Barretts and others survey No. 9908; thence with his line S 12 E. 383 poles crossing a small branch to a stake southeast corner to Barretts said survey in a line of Entry No 9886, thence with said line N. 77 W. E. 200 1/2 poles to the beginning.

Levi D Sharp 3
 Hezekiah Rosbrag 3 C.O.
 Wilson L Thompson Mkr.

Samuel Forrer D.S.
 January 10th 1820
 December 12th 1820

Surveyed for Charles Lewis 1000 acres of land on part of a military warrant No. 4688 on the waters of Big Miami; beginning at a sugar tree and hickory southeast corner of Robert Means survey No 9928 and Northwest corner to Simon Sommers survey No. 9905; thence with Sommers line S 78 E 400 poles to a hickory and sugar tree northeast corner to survey No. 9905; thence N. 12 W.

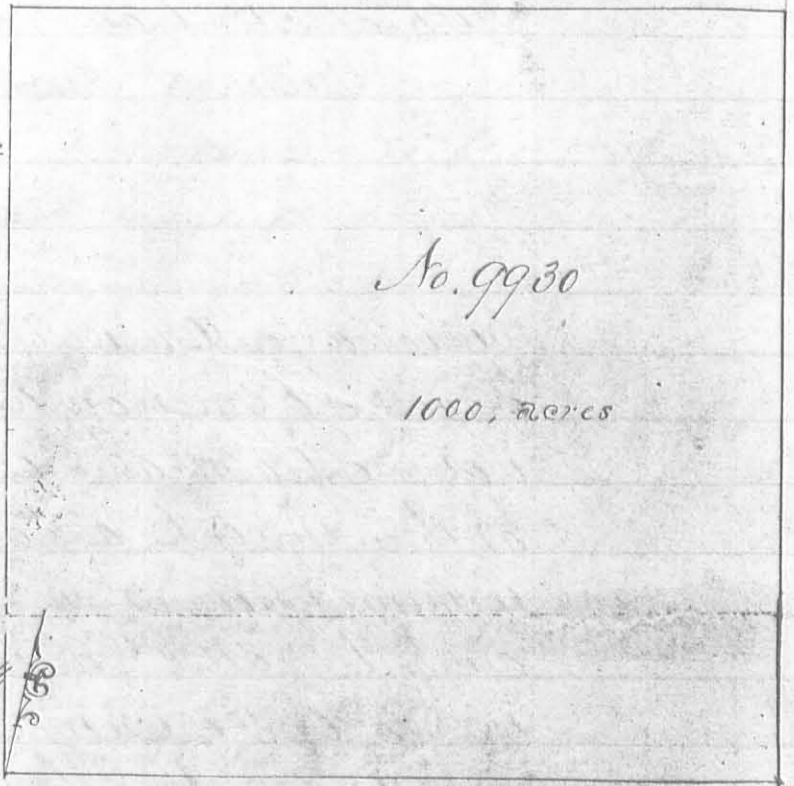

400 poles to an elm and three dogwoods; thence S. 78 W. 400 poles to a stake in a field northeast corner to said Means survey No 9930, thence with his line S 12 E. 400 poles crossing a branch at 138 and one at 372 poles to the beginning.

Levi D Sharp 3
 Hezekiah Rosbrag 3 C.O.
 Wilson L Thompson Mkr.

Samuel Forrer D.S.
 January 18th 1820
 December 11th 1820

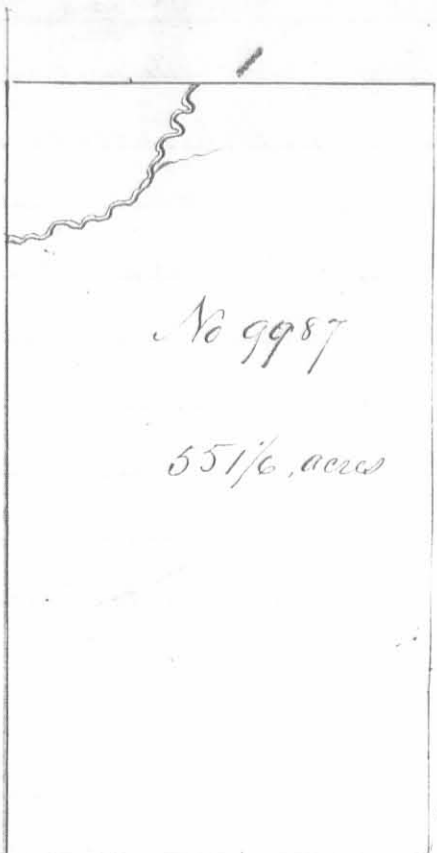

No 9987

55 1/2 acres

Surveyed for James Taylor a^{sr} and William Robinson and James Morrison a^{sr} 55 1/2 acres of land on part of two military warrants, Taylor and Robinson 44 7/8 acres on No 5330 and Morrison 10 6/8 acres on No 5343 on the waters of Big Miami; beginning at two beech. Northeast corner to the representatives of Robert Youngs survey No 9970; thence with said Youngs line S. 78 N. 221 poles to a hickory and Elm Southeast corner to William Robinsons survey No 9987; thence with his line N 12 W 100 poles crossing a drain at 112 and North fork of Miami at 316 poles to two iron woods and a beech northeast corner to said Robinsons survey; thence N. 78 E. 221 poles crossing the fork at 100 poles to a beech; thence S. 12 E. 400 poles to the beginning.

Levi D. Sharp
 Wilkiah Rosebag
 Wilson L. Thompson M.k.r.

Samuel Forrer D.S.
 May 7th 1820
 March 9th 1821

Surveyed for Thomas Overton 1000 acres of land on part of a military warrant No. 44 on the waters of Big Miami: Beginning at an Elm and hickberry Southeast corner of the representatives of Nathaniel Burwell and others survey No 9988 thence N. 78 E 400 poles crossing Snice's Trail at 250 poles to a small ash and two beeches, thence North 12 W 400 poles crossing a branch at 200 poles to two beeches; thence S. 78. W 400 poles to three beeches; thence S 12 E 400 poles to the beginning.



No. 9989

1000, acres

Levi D. Sharp
 Wilkiah Rosebag
 Wilson L. Thompson M.k.r.

Saml Forrer D.S.
 March 9th 1820
 July 21st 1820

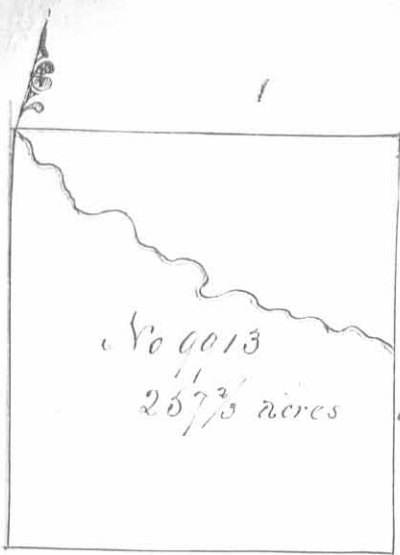

Surveyed for John Swan and James Taylor of 257 3/4 acres of land on part of a military warrant No 5451 on Boker creek; beginning at a buckeye bar oak, ash and hickory in the bank of the creek, north east corner to Nicholas Saliaferro's survey No 9912, thence S. 78 E. 200 poles to two beeches; thence S 12 E. 213 poles crossing the creek to a bar oak and lynn; thence S. 78 W. 200 poles to two buckeyes and two small beeches northeast corner to John Piodds survey No 9913 in Saliaferro's line; thence with said line S. 12 W. 213 poles to the beginning.

Levi D. Sharp
 Heilrich Rosebraag } C.C.
 Wilson S. Thompson M.K.R.

Samuel Ferrer G.S.
 January 12th 1820
 March 12th 1821

Surveyed for John Swan and James Taylor of 257 3/4 acres of land on part of a military warrant No 5451 on Boker creek; beginning at a hickory and two beeches northeast corner of Willis and others survey No 9913; thence S. 12 W. 213 poles to a buckeye and two ashes on the west edge of a small pond; thence S. 78 W. 200 poles to two beeches northeast corner to said Swan and Taylor's other survey No 9913, thence with their line S. 12 E. 213 poles to a bar oak and lynn southeast corner of said survey; thence with Willis and others line S. 78 E. 200 poles crossing Boker creek at 46 poles to the beginning.



Levi D. Sharp
 Heilrich Rosebraag } C.C.
 Wilson S. Thompson M.K.R.

Samuel Ferrer G.S.
 January 12th 1820
 March 12th 1821

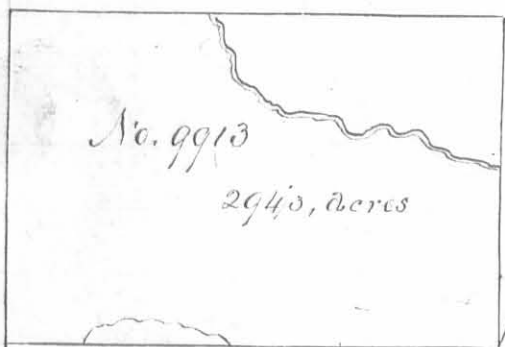

Surveyed for the representatives of John Willis, George Manning and John Piodd 294 1/2 acres of land in the following military warrants; Willis 144 1/2 acres on part of No 5464, Manning 50 acres on part of No 545 and Piodd 100 acres on part of No 5555 on Boker creek; beginning at an ash cherry tree and box elder in the bank of a branch northeast corner to James Taylor's survey No 9892; thence N. 12 W. 170 poles crossing Boker creek at 84 poles to a hickory and two beeches; thence S. 78 W. 259 poles crossing the creek at 154 poles to three small beeches; thence S. 12 E. 170 poles to a beech and three lynn in the north line of William Roberts and others survey No 9891, thence with said line S. 78 E. 259 poles to the beginning.

Levi D. Sharp
 Heilrich Rosebraag } C.C.
 Wilson S. Thompson M.K.R.

Samuel Ferrer G.S.
 January 12th 1820
 March 12th 1821

No. 9913
106, acres

Surveyed for John Paddy 100 acres of land on part of a military warrant No 5555 on the waters of Boker Creek; beginning at three beeches southeast corner to Nicholas Galiferro's survey No. 9912 and northwest corner to William Roberts and other survey No 9881, thence with their line S. 75. E. 94 poles to a beech and cypress; thence S. 12. W. 170 poles to an iron wood and two small beeches; thence S. 75 N. 94 poles to a turkey and two small beeches in said Galiferro's line; thence with said line S. 12. E. 170 poles to the beginning.

Levi D. Sharp
Milkiak Roselrag & Co.
Wilson L. Thompson Mkr.

Samuel Ferrer D.S.
January 12th 1820
March 13th 1821

Surveyed for George Manning 50 acres of land on part of a military warrant No. 5145 on the waters of Boker Creek; beginning at a beech and cypress southeast corner to John Paddy's survey No 9913 in the north line of William Roberts and other survey No. 9891. 94 poles from the northwest corner of said survey; thence with said line S. 75 E. 47 poles to a beech and three cypresses southwest corner to Will's Manning and Paddy's survey No. 9913; thence with their line S. 12 N. 170 poles to three small beeches in a line of Swan and Taylor's survey No 9915; thence with their line S. 78 W. 47 poles to an iron wood and two small beeches northeast corner to John Paddy's said survey; thence with said line S. 12. E. 170 poles to the beginning.

No. 9913
50, acres

Levi D. Sharp
Milkiak Roselrag & Co.
Wilson L. Thompson Mkr.

Samuel Ferrer D.S.
January 12th 1820
March 13th 1821

No. 9893
472, acres

Surveyed for Maria and John C. Rowdell heirs, and James Taylor 472 acres of land on part of a military warrant No 5146 on the waters of Boker Creek; beginning at a cypress and two beeches southeast corner of James Taylor's survey No 9892 in the boundary line; thence with said line S. 75. E. 189 poles to three small iron woods; thence S. 12. W. 400 poles crossing Boker creek to a sugar tree and two beeches; thence S. 78 W. 189 poles to a beech and two sugar trees, northeast corner to said Taylor's survey; thence S. 12. W. 400 poles crossing the creek at 166 poles to the beginning.

Levi D. Sharp
Milkiak Roselrag & Co.
Wilson L. Thompson Mkr.

Samuel Ferrer D.S.
January 6th 1820
March 13th 1821

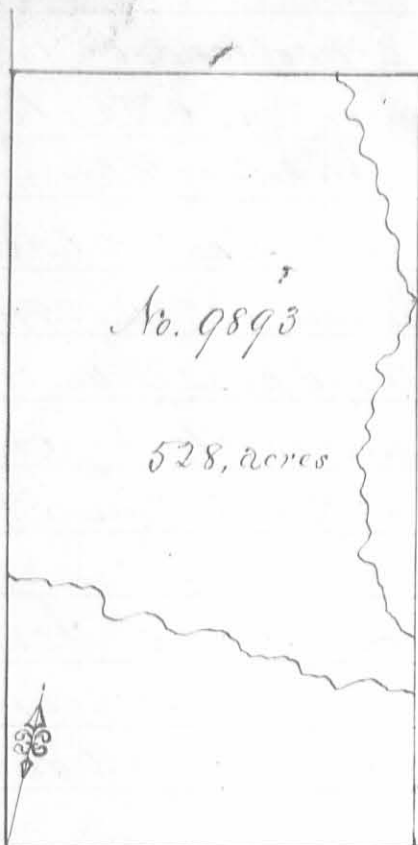

No. 9893

528, acres

Surveyed for Maria and John C. Rawsdale
 heirs, and James Taylor ap^a and Charles Scott
 528 acres of land on part of two Military Warrants
 Rawsdale and Taylor 472 acres on No 5426
 and Scott 56 acres on No. 5436 on the waters of
 Bokes Creek; beginning at three small ironwoods
 southeast corner to Rawsdale and Taylors
 survey No 9893, in the boundary line; thence
 N. 78 E. 211 poles to a sugar tree and beech;
 thence N. 12. W. 400 poles crossing Bokes Creek
 at 84 and a branch at 120 poles to an ash and
 sugar tree and cypress; thence S. 78. W. 211 poles
 crossing a branch at 42 poles to a sugar tree
 and two beeches northeast corner to Rawsdale and Taylors said
 survey; thence with their line S 12 E. 400 poles crossing the creek
 to the beginning.

Levi D. Sharp
 Hezekiah Rosebrog & Co.
 Wilson S. Thompson M.k.r.

Samuel Ferrer D.S.
 January 6th 1820
 March 13th 1821

Surveyed for James Taylor ap^a
 1000 acres of land on part of a Mil-
 itary Warrant No 5434 on the
 waters of Bokes Creek: Begin-
 ning at an ash hickory and
 two beeches in the Greenville treaty
 line southeast corner to William
 Roberts and others survey No 9891
 thence with said treaty line N 78
 E. 400 poles to a cypress and beech
 thence N. 12. W. 400 poles crossing
 a branch at 334 poles to a beech
 and two sugar trees, thence S 78 W. 400 poles crossing the branch
 to an ash, cherry tree and box elder on the bank of a branch;
 thence S 12 W. 400 poles to the beginning.

Levi D. Sharp
 Hezekiah Rosebrog & Co.
 Wilson S. Thompson M.k.r.

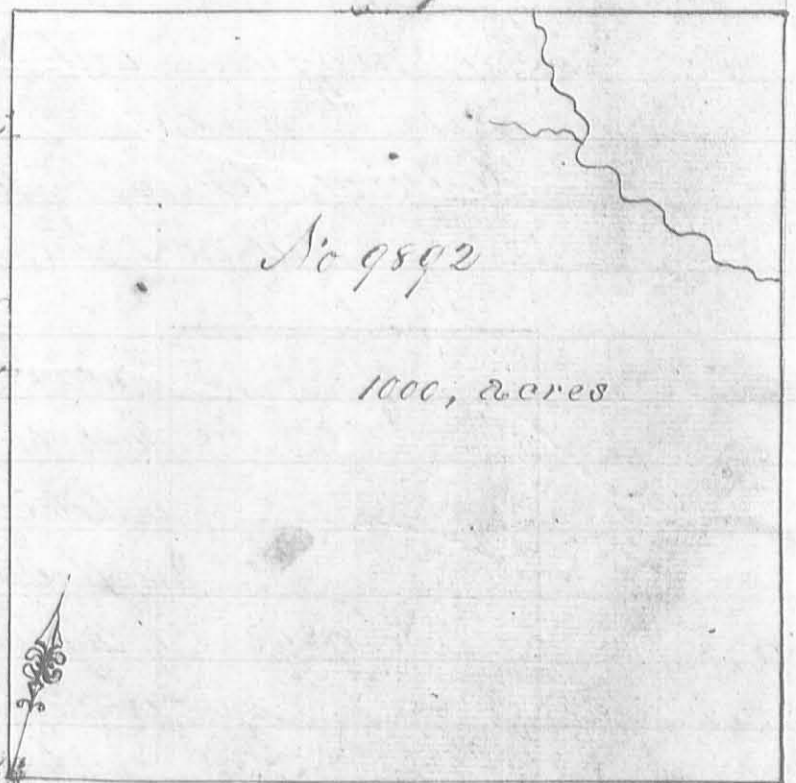

No 9892

1000, acres

Samuel Ferrer D.S.
 January 5th 1820
 March 14th 1821

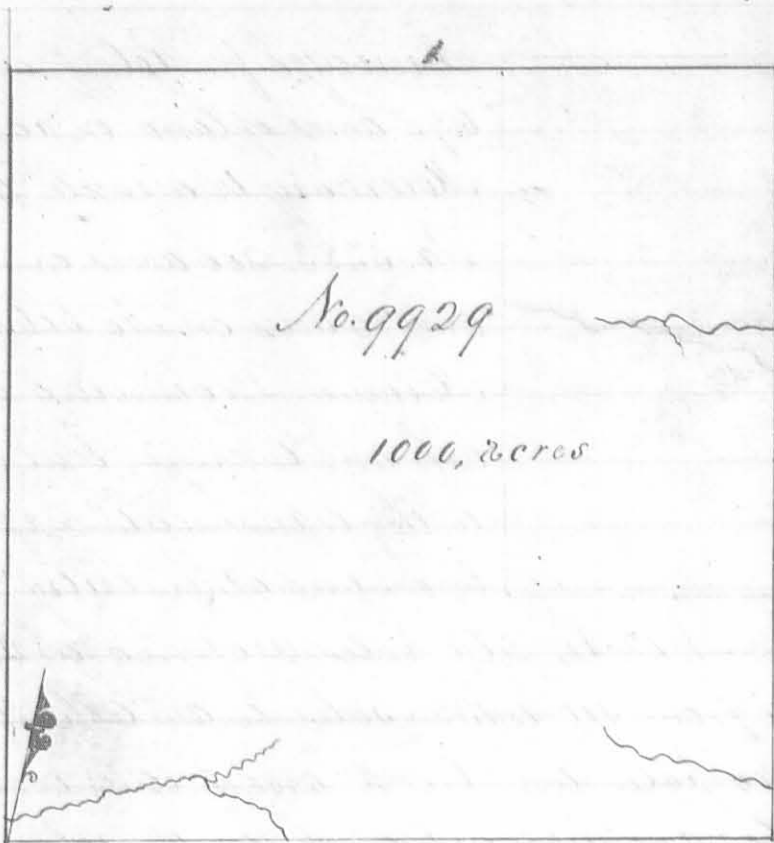

No. 9929

1000 acres

Surveyed for Robert Means of
1000 acres of land on part of a mili-
tary Warrant No. 5351 on the wa-
ters of Big Miami: Beginning at
a black ash, hickory and elm
northwest corner to Robert Gam-
bles survey No 9904, thence
with his line N. 75 E. 400 poles
crossing a branch at 140 poles
and Bulls road at 274 poles
to a hickory and sugar tree
thence N. 12 W. 400 poles cross-
ing a small branch at 22

and one at 262 poles to a white oak and black oak both
dead in Robert Armstrong's field; thence S 75 N. 400 poles crossing
a prairie from 22 to 316 poles and a swamp from 316 to 356 poles
to four elms, thence S. 12. E. 400 poles crossing the prairie from 106
to 336 and a small branch at 338 poles to the beginning.

George Henry ³James Henry ³ C.C.

Benjamin McCulloch M.k.r.

Thomas F. McArthur D.S.

January 15th 1821March 30th 1821

Surveyed for Robert Means of
1000 acres of land on part of a
Military Warrant No. 5351 on
the waters of Scioto: Beginning
at two sugar tree, hickory and
beech, Northeast corner to James
Burtens survey No. 9955 and
southeast corner to Francis Meiers
survey No. 9976, thence N. 12. W.
400 poles crossing a small branch
at 48 and one at 81 poles to three
beeches and a sugar tree, thence
N. 75. E. 400 poles crossing a drain
at 136 and a Sandusky road at 240 poles to a bar oak, beech and
small elm ash; thence S. 12 E. 400 poles crossing a branch at 346 poles to two beeches
thence S. 78. W. 400 poles crossing the Sandusky road at 230 a branch at 302 one at 314 and
at 348 poles to the beginning.

James Henry

Thomas H. Kellogg ³ C.C.

James C. Donalson M.k.r.

Thomas F. McArthur D.S.

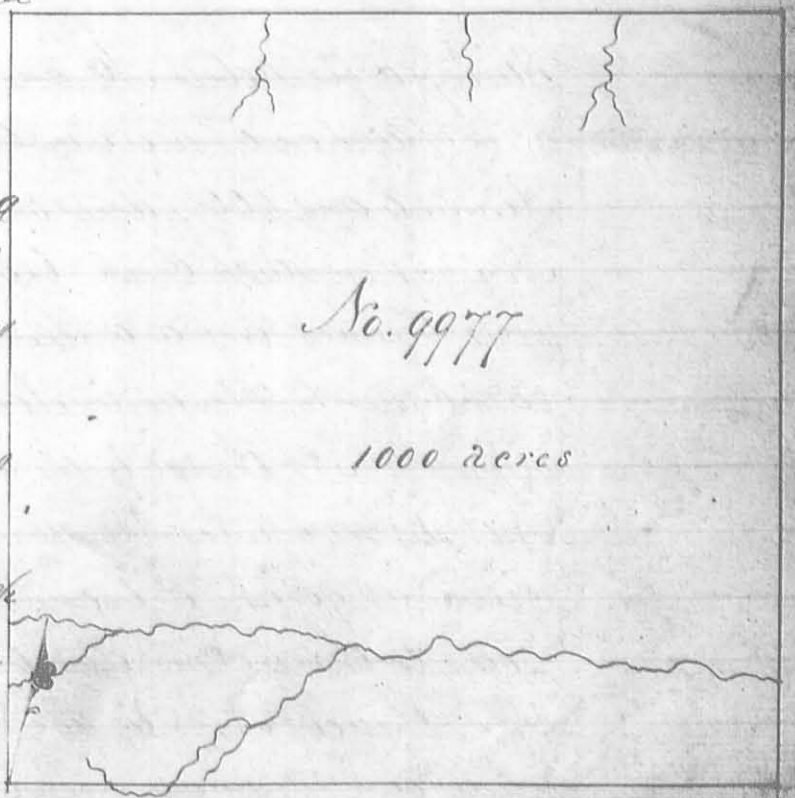
January 22nd 1821March 30th 1821

No. 9977

1000 acres

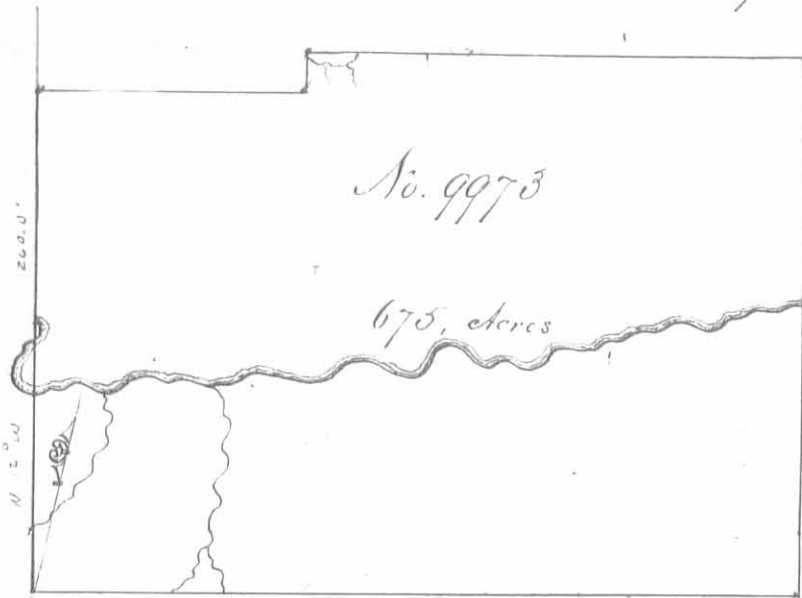

Surveyed for Robert Means of
675 acres of land on part of three
Military Warrants, 400 acres on
No. 5383, 200 acres on No 5184
and 75 acres on No 5169 on Big
Miami: Beginning at a beech
ash and buckeye southeast corner
to the representation of John Gil-
lison and others entry No 9972;

thence with their line N 12 W, 260 poles crossing a small branch
at 36 and the Miami from 110 to 132 poles to an ash sugar tree and
oak; thence N. 78. E. 140 poles to a beech and small iron wood;
thence N. 12 W. 16 poles crossing a branch at 12 poles to an ash
and elm in a swamp; thence N. 78 E. 260 poles crossing a branch
at 21 a beaver pond at 24 to 30 poles to a hickory, buckeye and two
beeches; thence S. 12. E. 276 poles crossing the Miami at 126 poles to
two beeches and a sugar tree; thence S. 78. W. 400 poles crossing the
middle fork of Miami at 290 and a spring branch at 310 poles to
the beginning.

George Henry $\frac{2}{3}$
James Henry $\frac{3}{3}$ C.C.
Benjamin McCulloch M.k.r.

Thomas J. McArthur D.S.
January 15th 1821
March 30th 1821.

Surveyed for Robert Means of 1000
acres of land on a Military Warrant
No. 5359 and 66 $\frac{2}{3}$ acres on part of
No. 5351 on Rush Creek; beginning at
four beeches and a white ash south
east corner to Alexander Parkers sur-
vey No 9958; thence with his line
N. 12. W. 400 poles crossing Rush
Creek at 90 and a branch at 222
poles to three elms and two buck-
eyes; thence N. 78. E. 400 poles to a
white oak a small beech, iron wood
and sugar tree; thence S. 12. E. 400
poles crossing the Creek at 150 a branch at 296 and one at 387 poles to a
red oak small sugar tree and small beech; thence S. 78. W. 400 poles crossing a branch
at 10 poles to the beginning.



James Henry $\frac{2}{3}$
Thomas A. Kellogg $\frac{3}{3}$ C.C.
James E. Donaldson M.k.r.

Thomas J. McArthur D.S.
February 2nd 1821
March 30th 1821

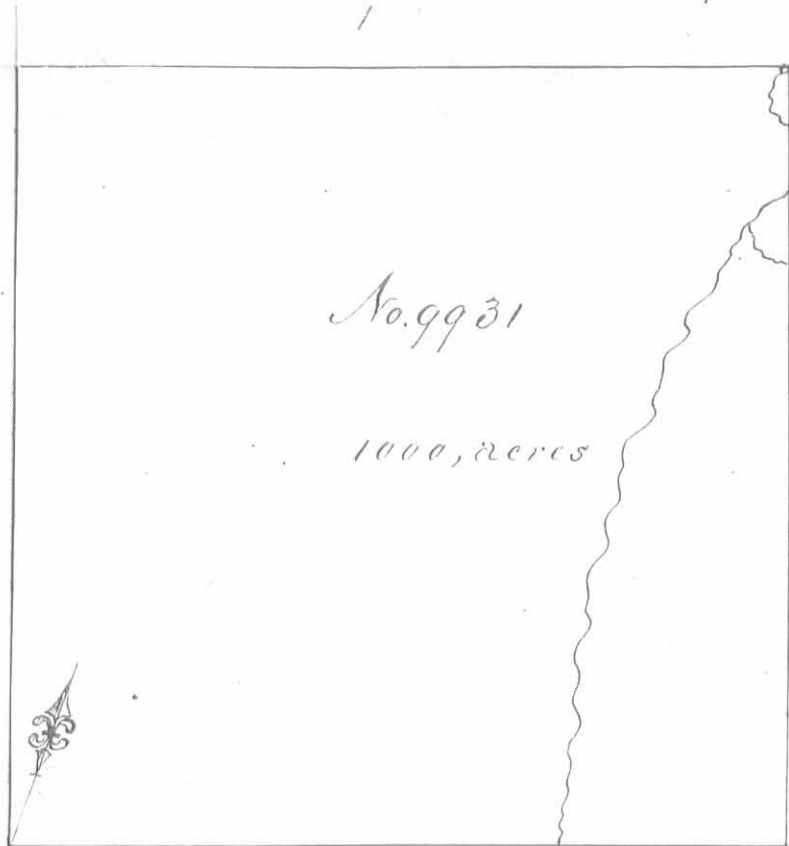

No. 9931

1000, acres

Surveyed for James Taylor Cap^{tn}
 1000 acres of land on the following
 Military warrants 888²/₃ acres
 on No. 5392. 100 acres on No. 5376
 and 11¹/₃ acres on part of No. 5372
 on the waters of big Miami;
 beginning at a hickory and su-
 gar tree southeast corner to Charles
 Lewis survey No. 9930 and north
 west corner to Pierce and Kephth
 survey No. 9906, thence with a
 line of No. 9906 N. 78. E. 400 poles
 crossing a branch at 316 to a

hickory, beech, ash and hawbeam; thence N. 12. W. 400 poles crossing
 a branch at 310 poles to three elms on the bank of a said branch
 thence S. 78. W. 400 poles to an elm and three dogwoods northeast
 corner to Lewis said survey; thence with said line S. 12. E. 400 poles
 to the beginning.

Heikiah Roxbrag
 Levi D. Sharp - C.C.
 Wilson S. Thompson M.k.r.

Saml Forrer D.S.
 January 18th 1820

Surveyed for Hubbard Myatt Execu-
 tor 280 acres of land on two Military
 warrants No. 6262 and 6265 on
 the waters of Rush Creek; beginning
 at a red oak, elm and sugar tree southeast corner to George Clark's
 survey No. 9933; thence with a line of Taylor and others survey
 No. 9909 N. 78. E. 395 poles to a sugar tree; thence N. 12. E. 1134 poles
 to a sugar tree and iron wood; thence S. 78. W. 395 poles cross-
 ing a branch of big Miami at 267 at 335 poles to a red oak
 beech and sugar tree; thence S. 12. E. 1134 poles to the begin-
 ning.

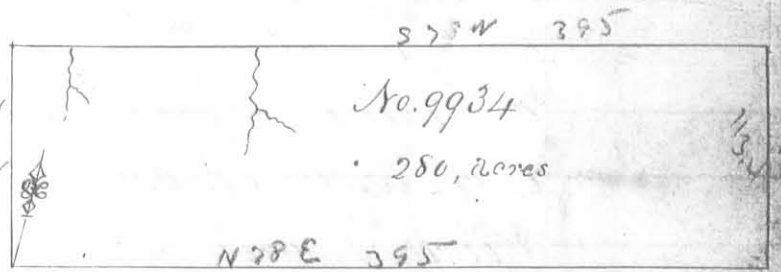

No. 9934

280, acres

Levi D. Sharp
 Heikiah Roxbrag - C.C.
 Wilson S. Thompson M.k.r.

Samuel Forrer D.S.
 January 20th 1820
 January 27th 1821

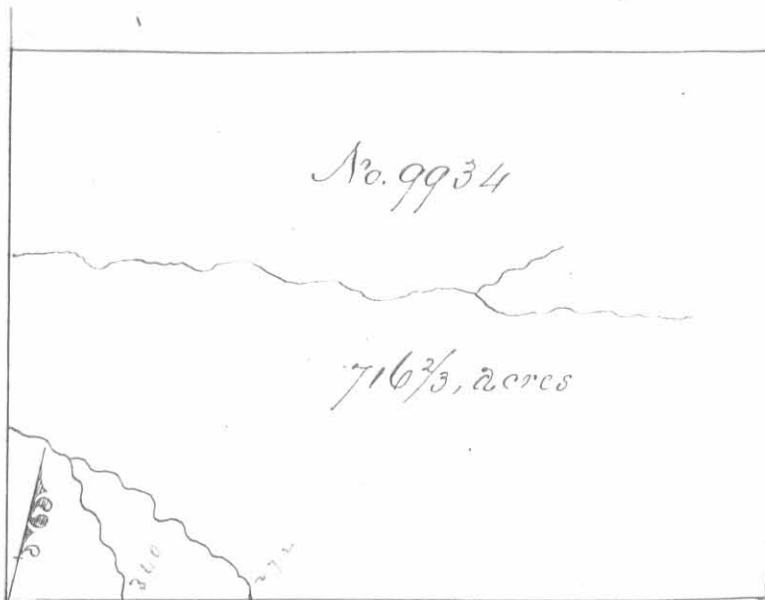

Surveyed for the representatives of David Wallace 716 $\frac{2}{3}$ acres of land on part of a military warrant No 5888 on the waters of Rush Creek and big Miami; beginning at a red oak tree and sugar tree north west corner to Hubbard Wyatt's survey No. 9934 in the line of George Clark's survey No 9933, thence

with said line N. 12. W. 286.6 poles to three beeches north east corner of said survey, thence N. 78. E 400 poles to three beeches; thence S. 12 E 286.6 poles to a beech, lynn and sugar tree north west corner to Wyatt's survey No 9934, thence with his line S. 78. W. 400 poles crossing a branch of Miami at 272. and one at 340 poles to the beginning.

Levi D Sharp

Milkiak Rosebrag & C. G.

Wilson S Thompson M. k. r

Samuel Forrer D. S.

January 20th 1820

January 27th 1821

Surveyed for Michael Bowyer 1000 acres of land on part of a military warrant No 3224 on the waters of the Big Miami: Beginning at a stake in a field near Solomons town southeast corner to said Bowyers survey No. 9949 and Northeast corner to Charles Lewis survey No. 9930; thence with Lewis line N. 78. E. 400 poles to an elm and three dogwoods; thence N. 12 W. 400 poles, crossing a large branch at 202 poles to a buckeye and ash; thence S. 78 W. 400 poles crossing the branch at 286 poles to two hickories north east corner to Bowyer said survey; thence with his line S. 12. E. 400 poles to the beginning.

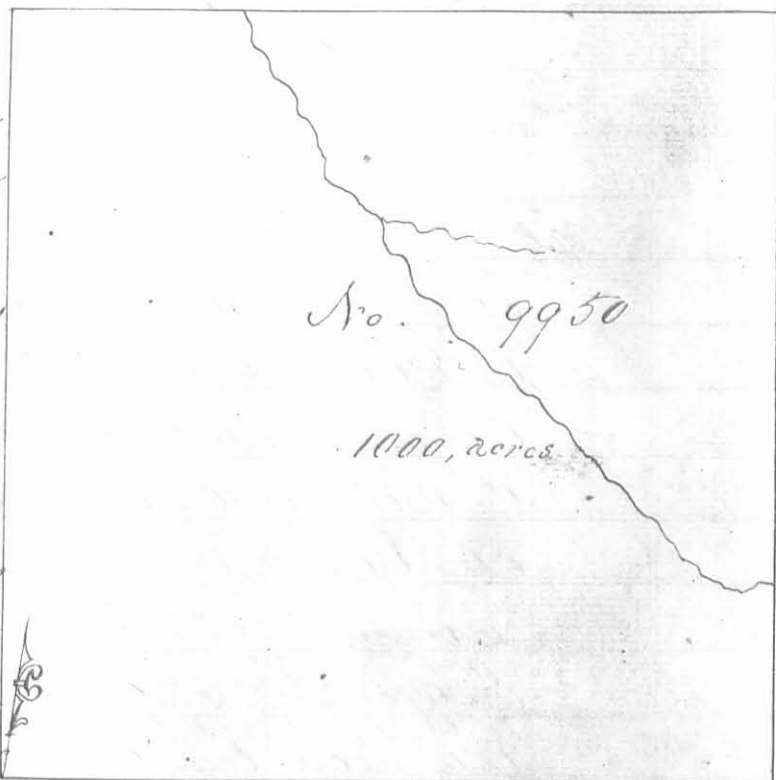

Levi D Sharp

Milkiak Rosebrag & M. k. r.

Wilson S Thompson M. k. r

Samuel Forrer D. S.

January 29th 1820

November 30th 1820

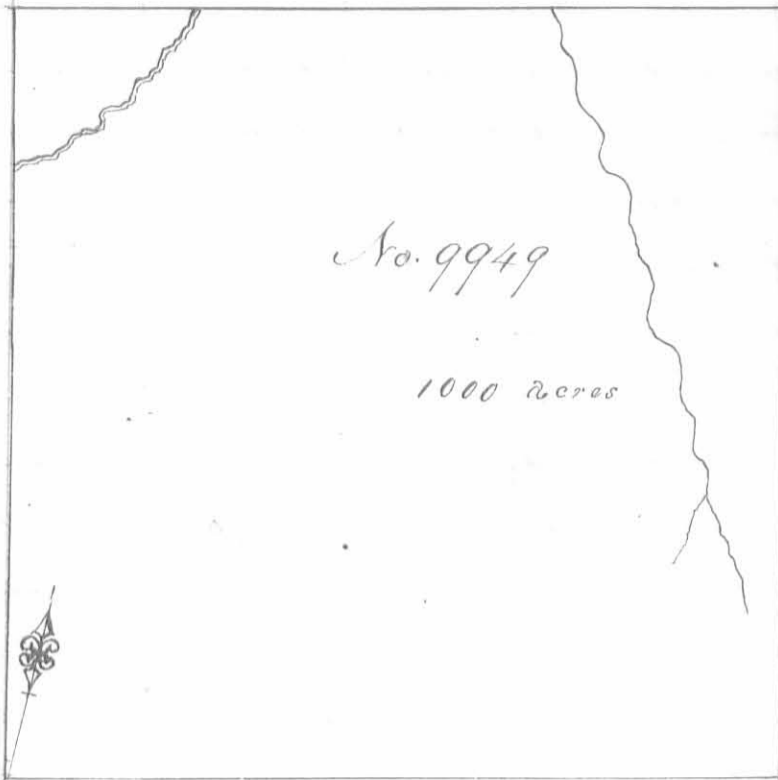

Surveyed for Michael Boyer
1000 acres of land on part of a
Military Warrant No 3224 on
the big Miami: Beginning at
four elms southeast corner of
George Clarke's survey No. 9948
and North west corner to Robert
Means survey No 9929; thence
with Means line N. 78. E 400
poles to a stake in a field; thence
N 12 W 400 poles to two hickories
thence S. 78. W. 400 poles crossing
a branch at 118 poles and the

big Miami at 362 poles to three beeches; thence with Clarke
line S. 12. E. 400 poles crossing the big Miami to the beginning.

Levi D. Sharp

Wilhelm Rosebrag ³ C. C.

Wilson S. Thompson M. L. R.

Samuel Forrer D. S.

January 28th 1820

November 30. 1820

Surveyed for Michael Boyer
1000 acres of land on part of a
Military Warrant No 3224
on the waters of big Miami;
beginning at an elm and three
dogwoods; southeast corner
of said Boyer's survey No 9950
thence with a line of James
Taylor's survey No 9931 N. 78 E
400 poles to three elms on the
bank of a large branch; thence
N. 12. W. 400 poles to a beech
and two buckeyes, thence S. 78. W. 400 poles to an ash and buck-
eye northeast corner to Survey No 9950, thence with a line of said
survey S. 12. E. 400 poles crossing said branch at 198 poles to the
beginning.



Levi D. Sharp

Wilhelm Rosebrag ³ C. C.

Wilson S. Thompson M. L. R.

Samuel Forrer D. S.

July 29. 1820

November 30. 1820

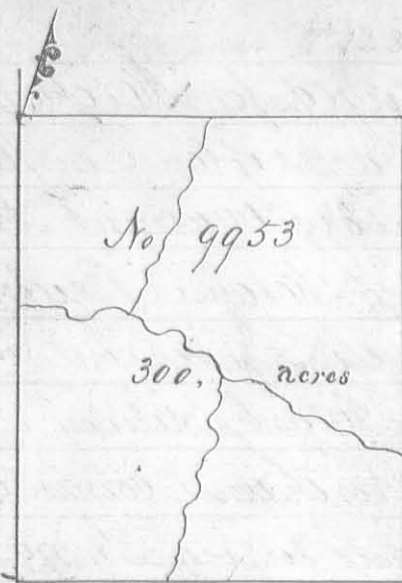

Surveyed for James Fitzpatrick 300 acres of land on part of a Military warrant No 2658 on the waters of Big Miami; beginning at two beeches and a sugar tree at the Northeast corner of Robert Means entry No 9952; thence with his line S. 12 E. 240 poles crossing the middle fork at 96 poles to two beeches corner to Robert Vances 700 acre survey; thence with Vances line N. 78 E. 200 poles crossing a branch to a stake, thence with another of Vances lines N. 12 W 200 poles crossing a branch to two beeches; thence S. 78. W. 200 poles crossing a branch at 100 poles to the beginning.

George Henry 3
James Henry 3 C.O.
Benjamin McCulloch M.R.

Thomas S. McArthur D.S.
January 14th 1821

Surveyed for Robert Vance 700 acres of land on part of a Military warrant No. 850 on the waters of Big Miami: Beginning at a red oak and beech southeast corner to Robert Means entry No 9952, thence N. 78 E 400 poles crossing a bushy prairie at from 200 to 220 poles crossing a branch at 296 and one at 312 poles to three beeches; thence N. 12 W. 400 poles crossing a branch at 156 and one at 374 poles to four beeches and a sugar tree; thence S. 78. W 200 poles crossing a small branch

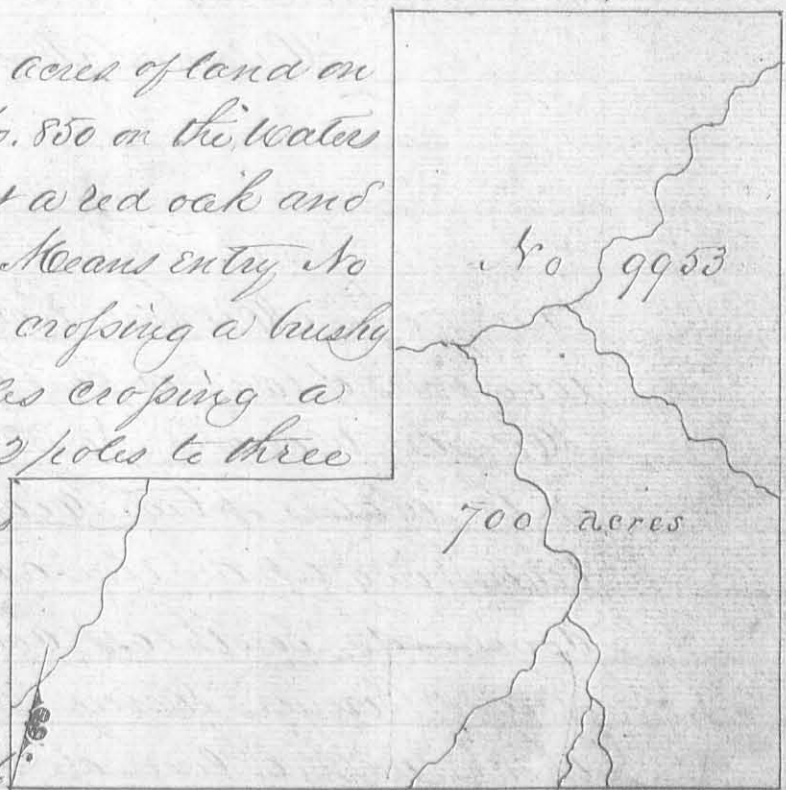

at 24 poles to two beeches corner to James Fitzpatrick 300 acres survey thence with his line S. 12 E 240 poles crossing a small branch to a stake; thence S. 78. W. 200 poles crossing a branch to two beeches; thence S. 12. E. 200 poles crossing a branch at 122 poles to the beginning.

George Henry 3
James Henry 3 C.O.
Benjamin McCulloch M.R.

Thomas S. McArthur D.S.
January 16th 1821
March 28th 1821

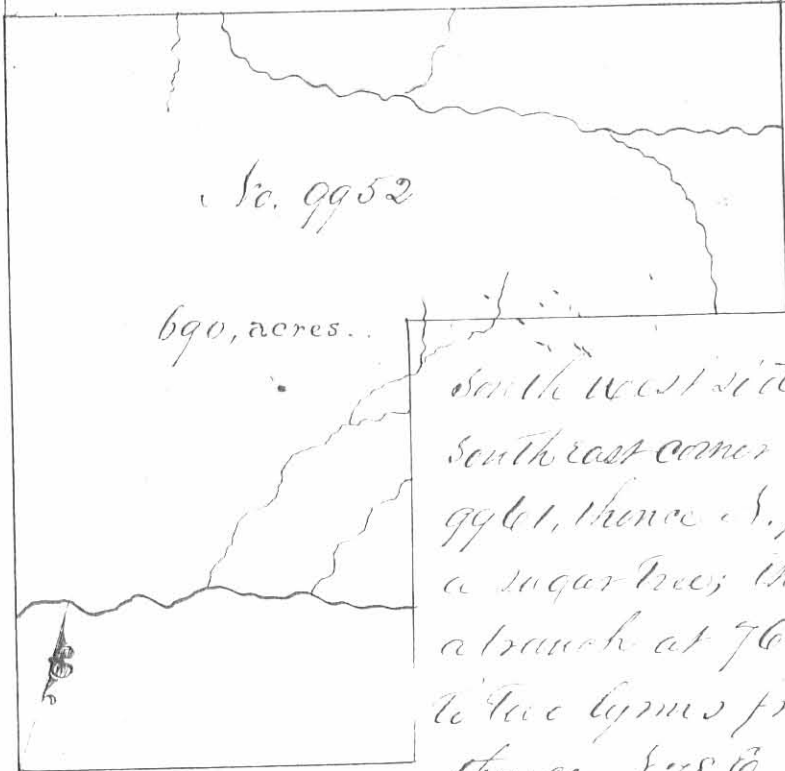

Surveyed for Robert Means
 ap^u 690 acres of land on a military
 warrant No 5221 and part of No
 5226 on the waters of Big Miami
 Beginning at three elms corner

the northeast side and two on
 the southwest side of the south fork of the Miami
 southeast corner of Michael Boyers survey No.
 9961, thence S. 78. E. 200 poles to two beeches and
 a sugar tree; thence S. 12. W. 230 poles crossing
 a branch at 76 one at 144 and one at 180 poles
 to two lymms from one root and two beeches
 thence S. 78. E. 200 poles crossing a branch at
 6 one at 46 and one at 104 poles to a beech and iron woods; thence
 S. 12. W. 165 poles crossing a large branch at 60 poles to two beeches
 and a sugar tree; thence S. 78. W. 400 poles crossing a small branch
 at 172 a large branch at 290 and a branch at 310 poles to a
 beech ash and buckeye; thence S. 12. E. 395 poles crossing a branch
 at 326 poles to the beginning.

John McCoy
 Samuel Sepler S. G. C.
 J. W. Milgus M. S. R.

Thos S. McArthur D. S.
 June 12th 1821
 July 20th 1821

Surveyed for Robert Means ap^u 287 2/3 acres of land on
 part of a military warrant No. 5101 on the waters of
 the Big Miami; beginning at two beeches and a sugar
 tree southeast corner to said Means survey No. 9952 of
 690 acres in the line of Henry Hoopies survey No.
 9982; thence with said line S. 78. E. 200 poles to a
 red oak and beech northeast corner to Hoopies said survey; thence
 S. 12. W. 230 poles crossing a branch at 34 poles to a beech and iron
 wood corner to Means said survey; thence with his line S. 78. W. 200
 poles crossing a branch at 38 one at 156 and one at 194 poles to two
 lymms from one root and two beeches; thence with another of his
 lines S. 12. E. 230 poles crossing a branch at 50 and one at 154 poles
 to the beginning.

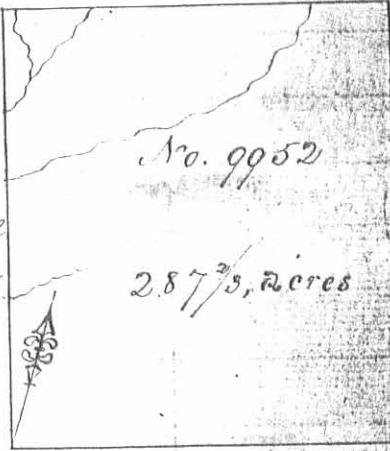

John McCoy
 Samuel Sepler S. G. C.
 John W. Milgus M. S. R.

Thomas S. McArthur D. S.
 June 12th 1821
 July 20th 1821

No. 9985
 361 acres
 255 1/2

Surveyed for the representatives of Nathaniel Burdell 361 acres of land on part of a Military Warrant No 3348 on the waters of Big Miami; beginning at two beeches south east corner to James Taylor and others survey No. 9987 and Northwest corner to Snruple and others survey No. 9971; thence with their line N. 75.8 E. 255 1/2 poles to an ash and elm on

the bank of a small branch; thence S. 12 N. 226 poles to an ash and two beeches; thence S. 78. N. 255 1/2 poles to three beeches in a line of survey No. 9987; thence with said line S. 12 E. 226 poles to the beginning.

Levi D. Sharp
 Hilkiak Rosbag } C.C.
 Wilson S. Thompson M.R.
 Samuel Forer D.S.
 March 9th 1820
 March 15th 1821

Surveyed for the representatives of Nathaniel Burdell 361 acres of land on part of a Military Warrant No. 3348 on the waters of Big Miami; beginning at an ash and one beechery north east corner of Snruple and others survey No. 9971; thence S. 12 N. 400 poles to three beeches; thence S. 78. N. 144 1/2 poles to two beeches. Southeast corner of Ache Beales survey No. 9988; thence with his line and the line of said Burdell's survey S. 12 E. 400 poles to an ash and elm, southeast corner to Burdell's said survey; thence with a line of survey No. 9971, S. 78. E. 144 1/2 poles to the beginning.

No. 9985
 361 acres

Levi D. Sharp
 Hilkiak Rosbag } C.C.
 Wilson S. Thompson M.R.
 Samuel Forer D.S.
 March 7th 1820
 March 15th 1821

No. 9988 & 9997
 352 1/3 acres

Surveyed for Ache Beales 352 1/3 acres of land on part of a Military Warrant No 3348 on the waters of Big Miami; beginning at three beeches northwest corner to Nathaniel Burdell's survey No. 9988 in the line of Taylor and Carver's survey No. 9987; thence with said line N. 12 N. 220 1/2 poles passing the north east corner of survey No. 9987 at 174 poles to three beeches; thence S. 78. E. 255 1/2 poles to a small beech; thence S. 12. E. 220 poles to an ash and two beeches northeast corner to Burdell's said survey; thence with his line S. 78 N. 255 1/2 poles to the beginning.

Levi D. Sharp
 Hilkiak Rosbag } C.C.
 Wilson S. Thompson M.R.
 Samuel Forer D.S.
 March 9th 1820
 June 27th 1821

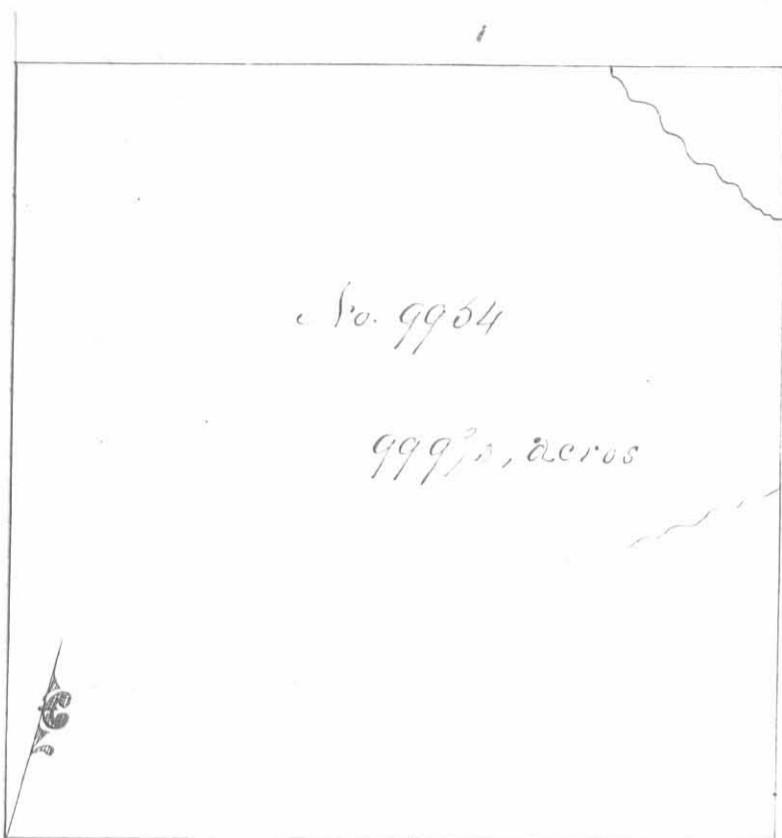

Surveyed for James Taylor and William Taylor 999²/₃ acres of land on part of a military warrant and part of one James 111 acres part of No. 5440 and William 888²/₃ acres on No. 5453 on the waters of Big Miami's beginning at three beeches south east corner to Robert Vance and others survey No. 9953 and north west corner to Wallace and others survey No. 9934; thence with their line N. 78. E. 400 poles

to three beeches; thence N. 12 W. 400 poles crossing a branch at 180 and one at 330 poles to three beeches; thence S. 78 W. 400 poles crossing a branch at 92 poles to a sugar tree and three beeches north east corner to said Vance and others survey; thence with their line S. 12 E. 400 poles to the beginning.

Levi D. Sharp
 Hilkiak Rosebrag & Co.
 Wilson S. Thompson M.k.r.

Samuel Forrer D.S.
 January 31st 1820
 March 14th 1821

Surveyed for James Wright 1000 acres of land on part of a military warrant No. 2740 on the waters of Scioto; beginning at two beeches south east corner of James Buntons survey No. 9955 and North west corner to Dun and Harrisons entry No. 9955, thence N. 78 E. 400 poles to two ashes and an Elm; thence N. 12 W. 400 poles to two beeches; thence S. 78 W. 400 poles to a hickory, beech and sugar tree northeast corner to Buntons said survey; thence with his line S. 12, E. 400 poles to the beginning.

Levi D. Sharp
 Hilkiak Rosebrag & Co.
 Wilson S. Thompson M.k.r.

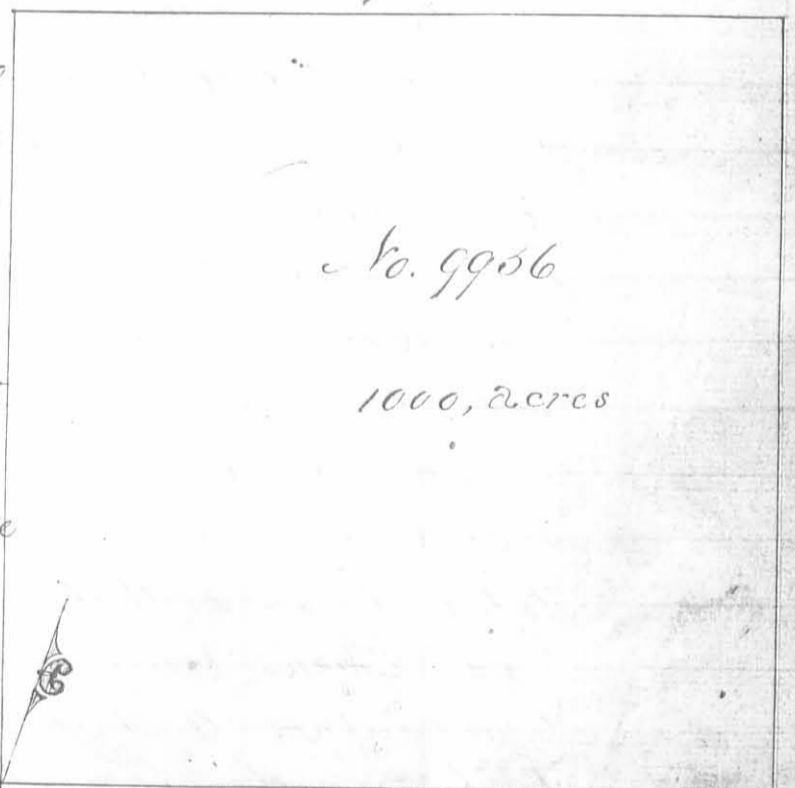

No. 9956
 1000, acres

Samuel Forrer D.S.
 January 30th 1820
 July 28th 1820

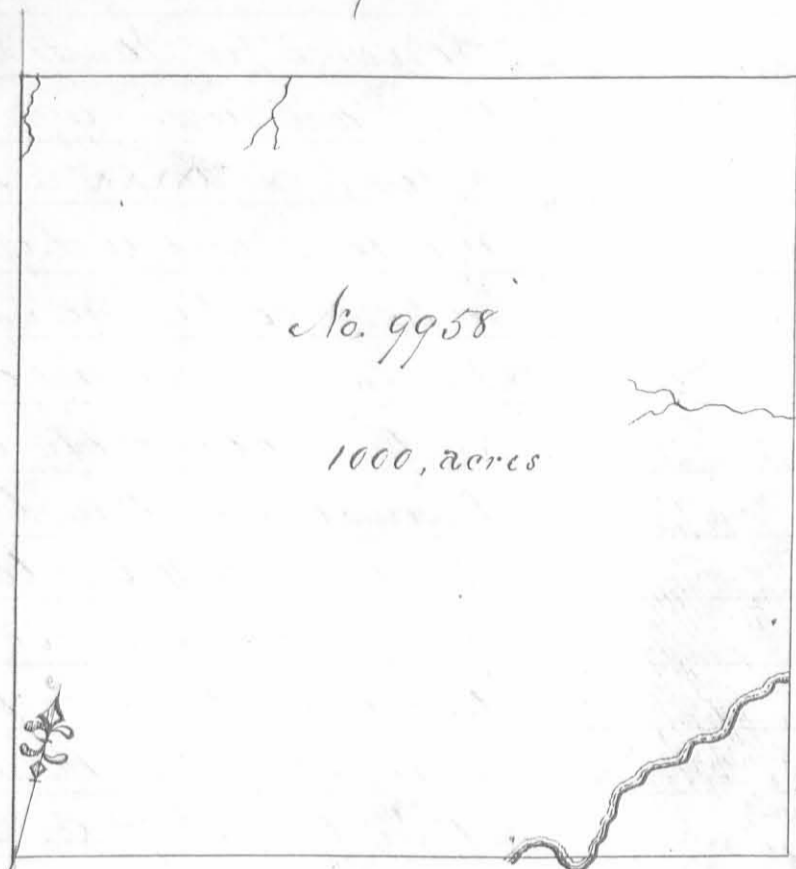

No. 9958

1000, acres

Surveyed for Alexander Parker
his 1000 acres of land on part of a
Military Warrant No. 735 on Rush
Creek: Beginning at two beeches
and a sugar tree North east corner
to Rowland Madisons survey No.
9938; thence N. 12. W. 400 poles
crossing several small branches
to a stake; thence N. 78 E. 400
poles crossing a small branch
at 8 and one at 144 poles to two
buckeyes; thence S. 12 E. 400 poles
crossing a branch at 178 and Rush

Creek at 310 poles to four beeches and a white oak, thence S 78 W. 400
poles crossing the creek at 101 at 118 and at 142 poles to the beginning.

Simon Hager

Abraham Hager

Huer Chapman M. h.

Thomas J. McArthur D. S.

January 26th 1821March 30th 1821

Surveyed for the Representatives of
Francis Taylor and James Taylor
ap^{pr} 1000 acres of land on the following
Military Warrants; Rept of Fr. Tay-
lor 888²/₃ acres on No. 5445, James
Taylor 100 acres on No. 5276 and 71¹/₂
acres on No. 5372 in the forks of
Big Miami: Beginning at two
sugar trees and a buckeye South
east corner to Jones and others survey
No. 9968; thence N. 78 E. 400 poles
to three beeches north east corner to
George Clarks survey No. 9948; thence N. 12. W. 400 poles to a hickory
lynn and sugar tree; thence S. 78 W. 400 poles to two sugar trees and two
buckeyes north east corner to Jones and others survey; thence S. 12 E. 400
poles to the beginning.

Levi D. Sharp

Milkiak Rosebrag

Wilson S. Thompson M. h. r.

No. 9969

1000, acres



Saml Forrer D. S.

March 1st 1820July 21st 1820