

Surveyed for William St Bernard  
 1600 acres of land in five Military  
 Warrants No. 6187. 6188. 6189.  
 6195 and 400 acres on part of 6194  
 on Cherokee mans run, a branch  
 of big Miami; beginning at a  
 bur oak, hickory, red elm and red  
 oak northeast corner to the repre-  
 sentatives of Michael Rudolphs  
 survey No. 9902 and southeast  
 corner to Nathan Reers survey  
 No 9927; thence with Rudolphs  
 line S. 12 E. 400 poles crossing the  
 run at 87 poles to a bur oak and  
 small elm their southeast corner  
 and northwest corner to Hubbard  
 Wyatts survey No 9551; thence  
 with Wyatts line N 75 E 400 poles  
 crossing the run at 230 poles to  
 three hickories northeast corner

to said survey and southwest corner to Robert Gambles survey No.  
 9904 of 725 acres, thence N. 12. W. 640 poles crossing a branch at  
~~112 a drain at 346 a small branch at 74 and at 112 a drain at~~  
 346 a small branch at 372 passing Gambles northwest corner  
 at 400 and with a line of Robert Means survey No. 9929 entered  
 a large prairie at 460 poles to a stake in the prairie in said  
 Means line; thence S. 78. W 400 poles leaving the prairie at 45  
 poles to a white oak in the line of Nathan Reers said survey  
 thence with said line S 12 E 240 poles to the beginning.

George Henry 3  
 James Henry 3 6.6  
 David Chapman M. k. r

Saml Forrer D. S  
 January 15<sup>th</sup> 1822  
 August 13<sup>th</sup> 1822

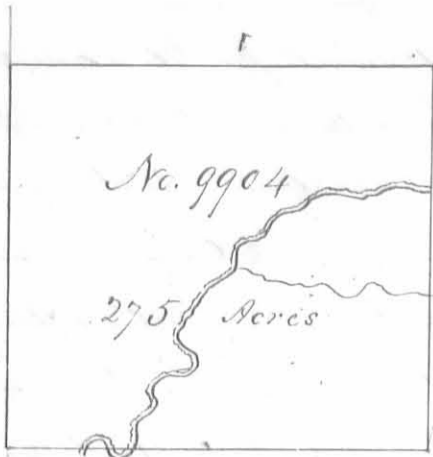

Surveyed for Robert Gamble 275 acres of land on part of a Military Warrant No 1494 on the North fork of Cherokee mans run; beginning at five beeches Northeast corner to McArthur and Hites Survey No 10307 and Northwest corner to Mark Hardins Survey No 9853; thence with McArthur and Hites survey S. 78 N 220 poles crossing the run at 158 at 165 and at 170 poles to two hickories; thence N. 12. W 200 poles crossing Mills road at 144 poles to two white oaks and a hickory; thence N. 78 E. 220 poles crossing the road at 34 poles to a dogwood, hickory and ironwood; thence S 12 E 200 poles crossing the run at 166 and a branch at 118 poles to the beginning.

John McCoy 3  
 James Saylor 3 66  
 John B. Migus M.k.r.

Thomas S. McArthur D.S.  
 June 10<sup>th</sup> 1821.  
 July 20. 1821.

Surveyed for Robert Gamble 725 acres of land on part of a Military Warrant No 1494 on the waters of the big Miami; beginning at three hickories at the east corner to Hubbard & Myatt's Survey No 9881 South east corner of William H Beards entry No 9903, thence with a line of said entry N 12 W 400 poles crossing a branch at 74 and at 112 a drain at 346 and one at 372 poles to an Elm, black ash and hickory; thence N 78 E 400 poles crossing a drain at 140 and Halls road at 274 poles a hickory and sugar tree, thence S 12 E. 200 poles crossing the head of a drain at 28 poles, to a dogwood hickory and ironwood thence S 78 W. 220 poles crossing the road at 156 poles to two white oaks and a hickory; thence S. 12. E. 200 poles crossing the road at 56 poles to two hickories; thence S 78 W 180 poles crossing the road at 56 poles to the beginning.

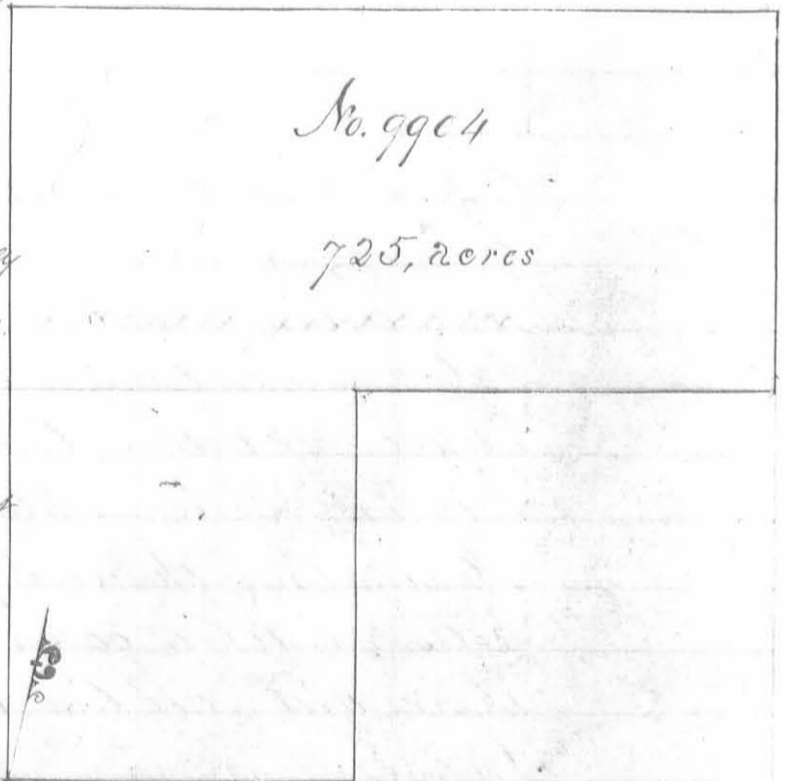

John McCoy 3  
 Saml Saylor 3 66  
 John B. Migus M.k.r.

Thos. S. McArthur D.S.  
 June 10<sup>th</sup> 1821  
 July 20<sup>th</sup> 1821

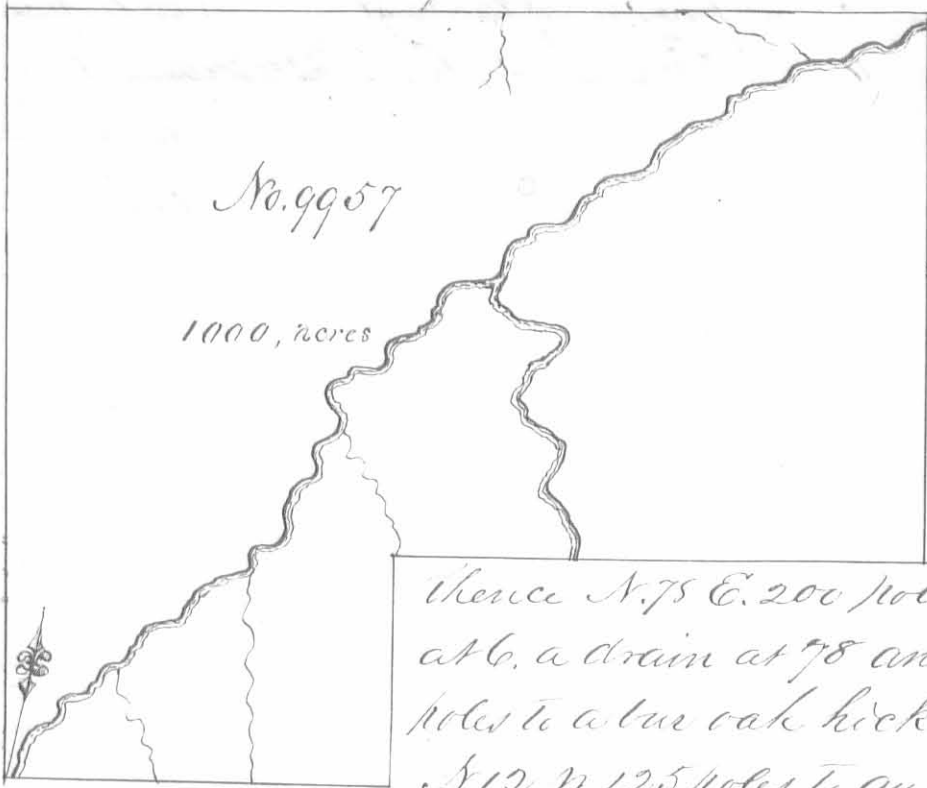

Surveyed for Philip Stewart  
1000 acres of land part of a  
military warrant No. 2338  
on the waters of Scioto: begin-  
ning at a small buckeye  
and two bur oaks 320 poles  
N. 78. E from the northeast  
corner of Abraham Kirk-  
patrick's survey No 1006

thence N. 75 E. 200 poles crossing a small creek  
at 6, a drain at 78 and a small branch at 131  
poles to a bur oak hickory and ash sapling, thence  
N. 12. N 125 poles to an ash and two lymns, thence  
N. 78 E, 280 poles crossing a drain at three and a large branch  
at 98 poles to a large sugar tree; thence N. 12 N. 282 poles crossing  
the creek at 272 poles to a large elm hickory and sugar tree; thence  
S. 78. N. 480 poles crossing a branch at 110 and a drain at 218 poles  
to two beeches, thence S. 12. E, 407 poles to the beginning.

Simon Hager 3  
Abraham Hager 3 C.C.  
David Chapman M.R.

Thos S. Arthur D.S.  
July 15<sup>th</sup> 1821  
July 24<sup>th</sup> 1821

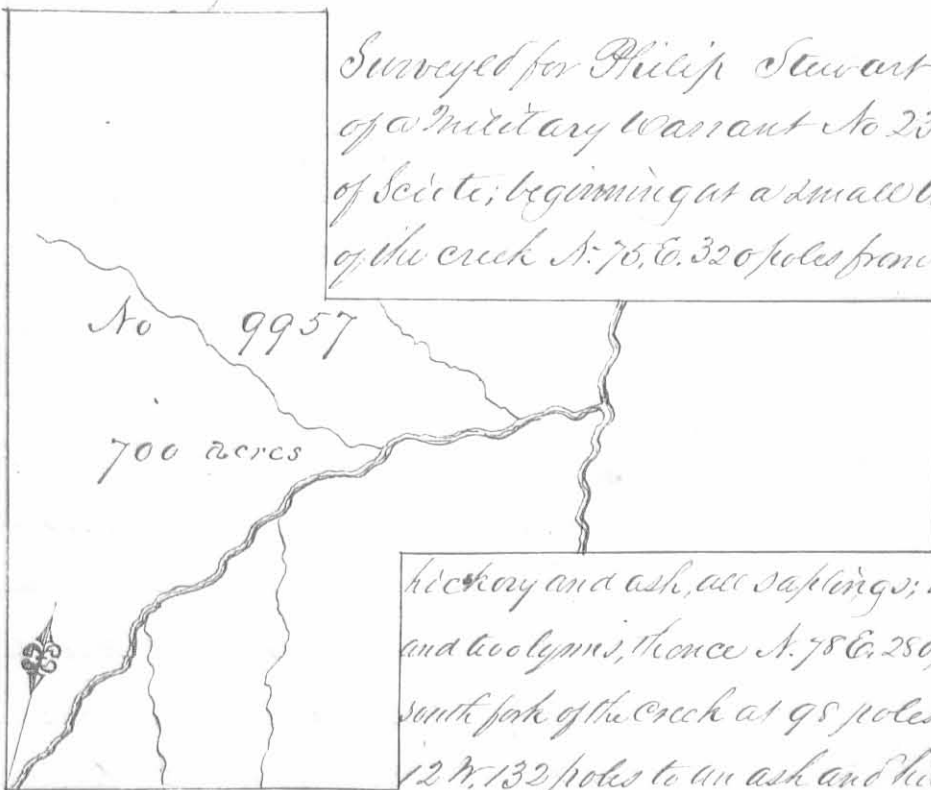

Surveyed for Philip Stewart 700 acres of land on part  
of a military warrant No 2338 on Mud Cat Creek a branch  
of Scioto; beginning at a small buckeye and bur oak on the bank  
of the creek N. 75. E. 320 poles from the northeast corner of Abraham

Kirkpatrick's survey No 1006, thence  
N. 78 E. 200 poles crossing the creek  
at 6, a drain at 78 and a small  
branch at 131 poles to a bur oak

hickory and ash, all saplings; thence N. 12. N. 125 poles to an ash  
and two lymns, thence N. 78 E. 280 poles crossing a drain at 13 and the  
south fork of the creek at 98 poles to a large sugar tree, thence N  
12 N. 132 poles to an ash and hickory; thence S. 78 N. 320 poles

crossing the creek at 163 and a drain at 286 poles to a lynn, sugar tree  
and cherry tree; thence N. 12. N. 150 poles to three beeches, thence S 78 N.  
160 poles to two beeches; thence S. 12. E, 407 poles to the beginning.

Hiram Perkins 3  
Theodore McDonald 3 C.C.  
David Chapman M.R.

Thomas S. Arthur D.S.  
June 7<sup>th</sup> 1822  
April 12<sup>th</sup> 1823



Surveyed for Simon Somers 250 acres of land on part of a Military Warrant No 6198 on the waters of big Miami; beginning at a hickory, red oak and sugar tree southeast corner to said Somers survey No 9905 for 500 acres in the line of Mark Hardins survey No. 9883; thence with his line N. 77<sup>1</sup>/<sub>2</sub> E 200 poles to a white oak and ash northeast corner to said Hardins survey and northwest corner to Joseph Heits survey No 9884 thence N 12 W, 200 poles to a beech and sugar tree; thence S 77<sup>1</sup>/<sub>2</sub> E 200 poles to two small sugar trees; thence S. 12. E. 200 poles crossing a branch at 70 poles to the beginning.

Levi D Sharp 3  
 Melkiah Rosbrag 3 66  
 Wilson S Thompson M.k.r.

Samuel Forer D.S  
 January 10<sup>th</sup> 1820  
 March 15<sup>th</sup> 1821

Surveyed for Simon Somers 500 acres of land on part of a Military Warrant No 3585 on the waters of big Miami; beginning at four beeches southeast corner to Robert Gaubles survey No 9904, thence with Mark Hardins line N. 77<sup>1</sup>/<sub>2</sub> E 200 poles to a hickory red oak and sugar tree; thence N 12 W 400 poles crossing a branch at 194 and one at 240 poles to two black oaks, a sugar tree, and hickory; thence S. 78. W. 200 poles to a sugar tree and hickory northeast corner to said Gauble survey; thence with his line S. 12. E 400 poles to the beginning.

Levi D Sharp 3  
 Melkiah Rosbrag 3 66  
 Wilson S Thompson M.k.r.

Samuel Forer D.S  
 January 10<sup>th</sup> 1820  
 March 15<sup>th</sup> 1821

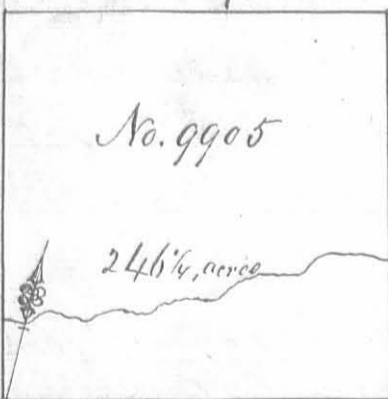
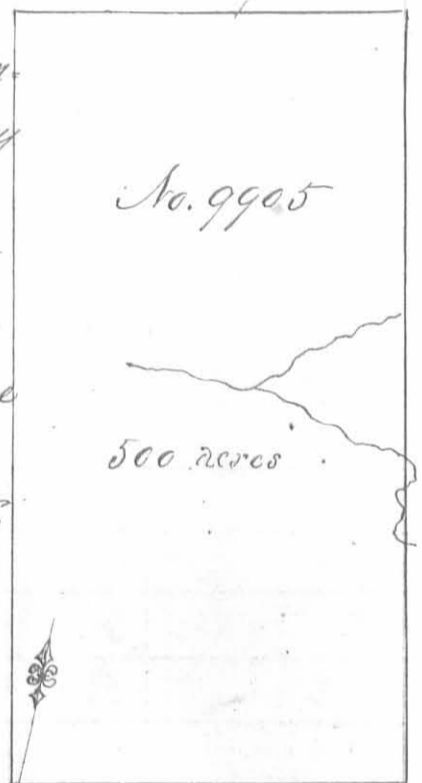

Surveyed for Simon Somers 246<sup>1</sup>/<sub>4</sub> acres of land on part of a Military Warrant No. 6198 on the waters of big Miami; beginning at two small sugar trees Northwest corner to said Somers survey No 9905 for 250 acres in a line of said Somers survey No 9905 for 500 acres; thence N 77<sup>1</sup>/<sub>2</sub> E 20 poles to two beeches and a sugar tree northeast corner to survey of 250 acres; thence N 12 W 196 poles crossing a branch at 70 poles to a hickory and sugar tree; thence S. 78 W. 200 poles to a sugar tree hickory and two black oaks northeast corner to said Somers 500 acre survey; thence with said line S 12 E. 198 poles to the beginning.

Levi D Sharp 3  
 Melkiah Rosbrag 3 66  
 Wilson S Thompson M.k.r.

Samuel Forer D.S  
 January 10<sup>th</sup> 1820  
 March 15<sup>th</sup> 1821

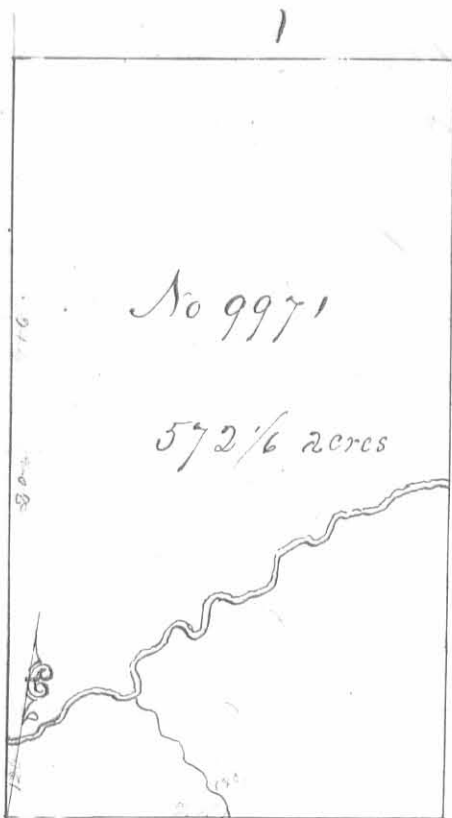

Surveyed for the Representatives of Benjamin Temple, Nathaniel Beale and the representatives of John Crittenden 572  $\frac{1}{6}$  acres of land on the following Military Warrants; Temples Representatives 277  $\frac{5}{6}$  acres on part of No 5417, Beale 100 acres on No. 5834 and 50 acres on part of No 5835 and Crittendens Representatives 144  $\frac{1}{3}$  acres on part of No. 5859 on the waters of Big Miami; beginning at two hickories southeast corner to the Representatives of Robert Youngs survey No 9970; thence N. 78. E 229 poles crossing a branch at 120 poles to a beech elm and buckeye; thence N. 12. W 400 poles crossing Big Miami to a buckeye; thence S. 78. W. 229 poles to two beeches, thence S. 12. E. 400 poles crossing the river at 358 poles to the beginning.

Levi D Sharp  
 Hilkiak Rosebag 3 C. C.  
 Wilson S Thompson M.k.s.

Samuel Forrer D.S.  
 March 2<sup>nd</sup> 1820  
 March 15<sup>th</sup> 1821

Surveyed for the Representatives of Benjamin Temple 277  $\frac{5}{6}$  acres of land on part of a Military Warrant No 5417 on the waters of Big Miami. Beginning at two beeches northeast corner to Nathaniel Beales survey No 9971. 140  $\frac{1}{2}$  poles from the northeast corner of Michael Bangers survey No. 9950, thence N. 12. W. 259  $\frac{1}{2}$  poles crossing the main branch of big miami at 109 poles to an elm, ash and hackberry, thence S. 87 W 171 poles to a buckeye northeast corner to Temple and others survey No. 9971, thence with their line S. 12 E. 259  $\frac{1}{2}$  poles to an elm and buckeye northwest corner to said Beales survey; thence N. 78 E 171 poles to the beginning.

Levi D Sharp  
 Hilkiak Rosebag 3 C. C.  
 Wilson S Thompson M.k.s.

Samuel Forrer D.S.  
 March 2<sup>nd</sup> 1820  
 March 5<sup>th</sup> 1821

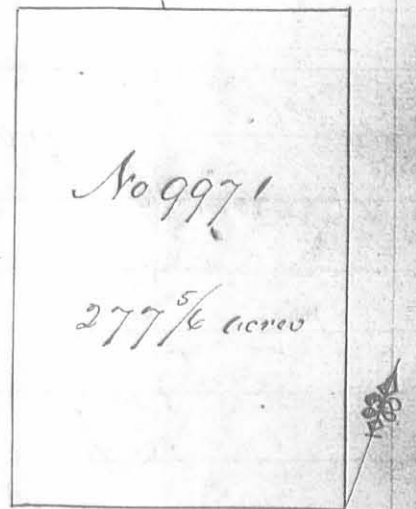

Surveyed for Ephraim Ralph 651 acres  
of land on part of a Military Warrant  
No. 4096 on the waters of Cherokee-  
mans run; beginning at an ash, beech  
and red oak, northeast corner to Joseph  
Hites survey No. 9884 and Northwest  
corner to Doctor Luns survey No. 9885  
thence N. 12. W. 392 poles to a hickory  
beech, black ash, and three hornbeams  
thence S. 78. W. 265 poles to a hickory and  
two red oaks northeast corner to Thomas  
Pearsons survey No. 9906, thence with  
his line S. 12. E. 392 poles to a double  
ironwood southeast corner to said

Pearsons survey; thence with a line of Hites survey N. 77° 20' E  
265 poles to the beginning.

Levi D. Sharp  
Hilkiiah Roxbrog & C. C.  
Wilson S. Thompson M. R.

Samuel Forrer D. S.  
January 10<sup>th</sup> 1820  
March 16<sup>th</sup> 1821

No. 9906  
333, acres

Surveyed for Thomas Pearson 333 acres of land on a Mil-  
itary Warrant No. 5448 on the waters of big Miami  
Beginning at a white oak and ash southeast corner  
of Simon Sommers survey No. 9905 northeast corner  
to Mark Hardins survey No. 9883 and northwest  
corner to Joseph Hites survey No. 9884; thence with  
Hites line N. 77° 20' E 135 poles to a double ironwood  
thence N. 12. W. 395 poles to a hickory and two red  
oaks; thence S. 78. W. 135 poles to a hickory and  
sugar tree northeast corner to Sommers said sur-  
vey; thence with his line S. 12 E. 395 poles cross-  
ing a branch at 126 poles to the beginning.

Levi D. Sharp  
Hilkiiah Roxbrog & C. C.  
Wilson S. Thompson M. R.

Samuel Forrer D. S.  
January 10<sup>th</sup> 1820  
March 16<sup>th</sup> 1821

No. 9971  
150, acres

Surveyed for Nathaniel Beale 150 acres of land on part of a military warrant No 5835 on the waters of Big Koyami; beginning at a buck eye and ash northeast corner to Michael Bowyers survey No. 9950 and northwest corner to Bowyers survey No. 9951, thence N. 42 N. 140 1/2 poles to two beeches thence S. 78. W. 171 to an elm and buckeye in a line of Temple and others survey No 9971, thence with said line S. 12. E. 140 1/2 poles to a beech, elm and buckeye, southeast corner to said Temple and others survey, in the line of Bowyers survey No. 9950; thence with said line N. 78 E. 178 poles to the beginning.

Luci O Sharp  
Michael Redrag B & C  
William L Thompson Mkr.

Samuel Ferrer D.S.  
March 2<sup>nd</sup> 1820  
March 15<sup>th</sup> 1821

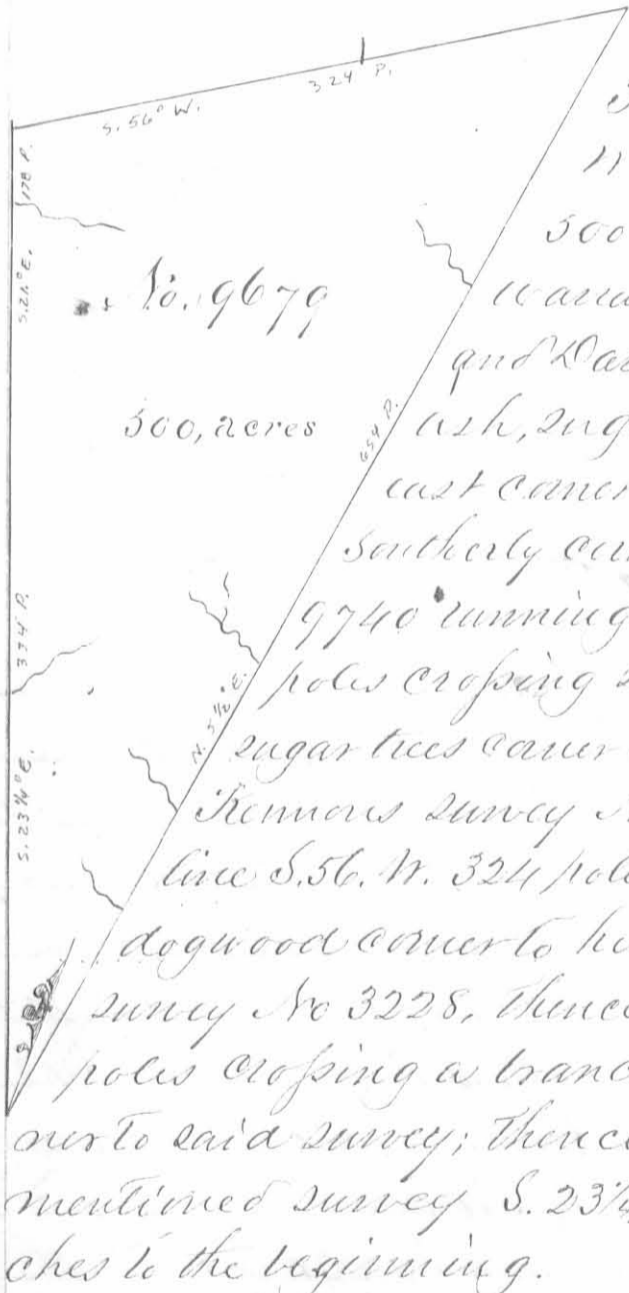

Surveyed for Joseph and Benjamin M Sadd and Thomas Towell 300 acres of land on part of a military warrant No. 5850 on the waters of Head river and Darlys Creek; Beginning at a blue ash, sugar tree and two dead mulberries, southeast corner to Augustine S Smiths survey No 3230 southerly corner to Walter Duns survey No. 9657 & 9740 running with said Duns line N. 51 1/2 E. 654 poles crossing several branches to a red oak and two sugar trees corner to his survey in the line of Richard Kennons survey No. 4570; thence with said Kennons line S. 56. W. 324 poles to three sugar trees, a lynn and dogwood corner to his survey in the line of said Smiths survey No 3228, thence with said Smiths line S. 21. E. 178 poles crossing a branch to two sugar trees, southeast corner to said survey; thence with the line of said Smiths first mentioned survey S. 23 1/4 E. 334 poles crossing several branches to the beginning.

William Sharp  
Joshua Crain B & C.  
Samuel Sharp Mkr.

James Galloway junr D.S.  
November 20<sup>th</sup> 1819  
July 25<sup>th</sup> 1820

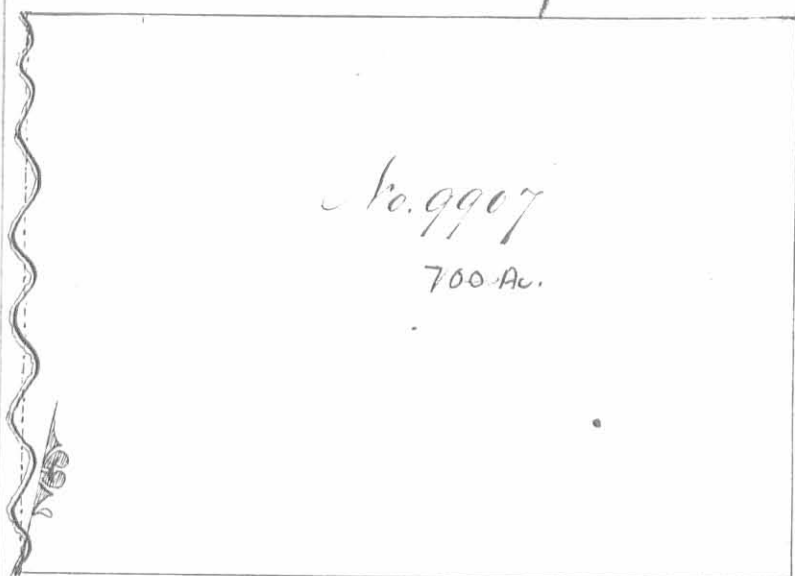

No. 9907

700 Ac.

Surveyed for Thomas Bourne,  
700 acres of land on part of  
a military Warrant No 64  
on the waters of Big Miami  
Beginning at an ash beech  
and red oak, south east cor-  
ner to Ephraim Ralphs sur-  
vey No. 9906 and Northwest  
corner to Walter Duns Survey  
No 9905; Thence with Duns

line N. 77 $^{\circ}$  E. 400 poles to three burr oaks and a beech on the  
North side of a swamp, northeast corner to said Duns survey,  
thence N. 12 W. 278 poles to a stake, thence S. 78 W. 400 poles to  
a stake in Ralphs line; thence with his line S. 12 E. 283 poles  
with the course of a branch to the beginning.

Levi D. Sharp  
Hezekiah Rosbrag & Co  
Wilson S. Thompson M.k.r.

Samuel Ferrer D.S.

January 10. 1820

December 8. 1820

Surveyed for Thomas Bourne  
272 acres of land on part of a  
Military warrant No 64 on  
the waters of big Miami; be-  
ginning at a hickory, beech

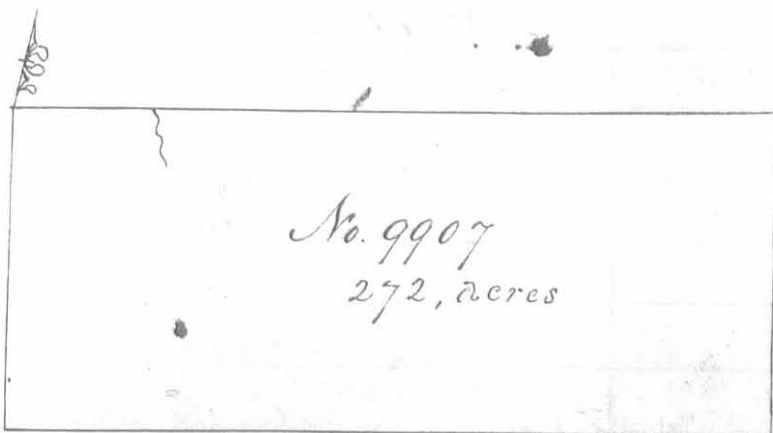

No. 9907

272, acres

black ash and three horn beams Northeast corner to Ephraim Ralphs  
survey No 9906; thence with his line S. 12 E. 109 poles to a stake  
northwest corner to said Bourne's survey No 9907 for 700 acres  
thence with his line N. 78 E. 400 poles to a stake in a line of  
Whiswell Barretts survey No. 9908 and Northeast corner to  
said Bourne's survey; thence with Barretts line N. 12 W. 109 poles  
to a sugar tree hickory, horn beam and two beeches southeast  
corner to Henry Measies survey No. 9932, thence with his line  
S. 78 W. 400 poles crossing a branch at 330 poles to the beginning

Levi D. Sharp  
Hezekiah Rosbrag & Co  
Wilson S. Thompson M.k.r.

Samuel Ferrer D.S.

January 10<sup>th</sup> 1820

December 8. 1820



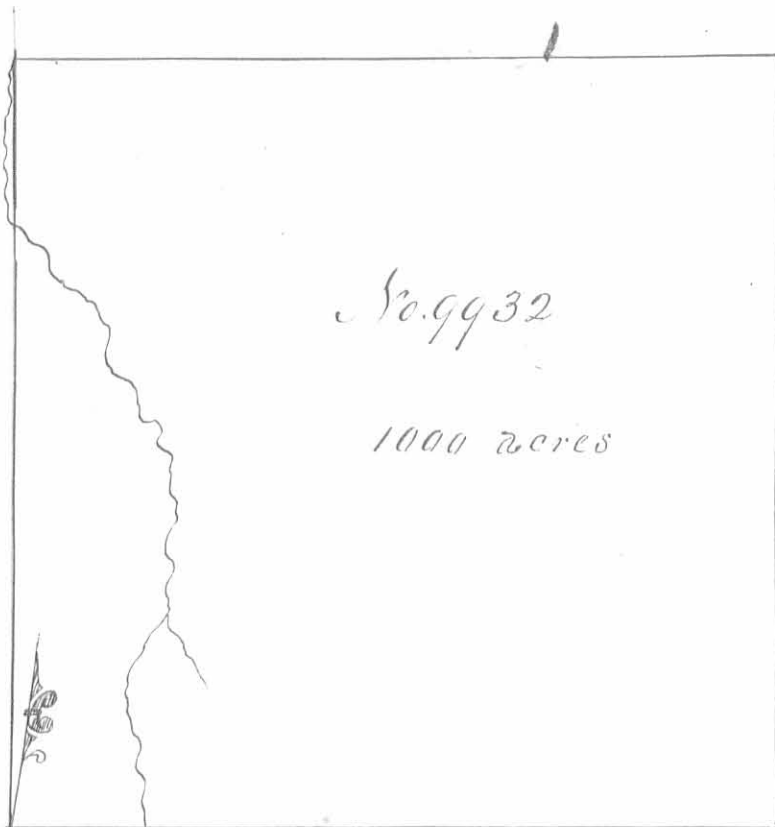

Surveyed for Henry Meaple  
1000 acres of land on seven Military Warrants and part of two others; No. 5094. 5199. 4069. 5203 5204. 5208. 5364. 78 acres on 5207 and 22 acres on 5372 on the waters of Big Miami; beginning at a hickory, ash, beech and horn beam southeast corner to James Taylors survey No 9931 and northwest corner to Thomas Bennes survey No 9907, thence with his line N. 78. E. 400 poles

crossing a branch at 70 poles to two beeches a sugar tree and horn beam, thence N. 12 W. 400 poles to a red oak and beech; thence S. 78. W. 400 poles to three elms on the bank of a branch thence S. 12. E. 400 poles crossing the branch at 90 poles to the beginning.

Levi D. Sharp  
Milkiah Rosbrag 3. C.C.  
Wilson L. Thompson M.R.

Samuel Ferrer D.S.  
January 18<sup>th</sup> 1820  
December 7<sup>th</sup> 1820

Surveyed for James Barton  
500 acres of land in part of a  
Military Warrant. No 6653  
on the waters of Big Miami:

Beginning at three beeches  
southeast corner of James and  
William Taylors survey No 9954 and for the east corner to  
Wallaces survey No 9934 thence N 78 E. 400 poles crossing  
Sandusky road to two beeches; thence N. 12. W. 200 poles cross-  
ing a branch at 126 poles to a stake, thence S 78 W 200  
poles crossing two branches to a stake in a line of said Tay-  
lors survey, thence with said line S 12 E 200 poles crossing  
a branch at 20 poles to the beginning.

Levi D. Sharp  
Milkiah Rosbrag 3 C.C.  
Wilson L. Thompson M.R.

Samuel Ferrer D.S.  
February 28<sup>th</sup> 1820  
December 8<sup>th</sup> 1820

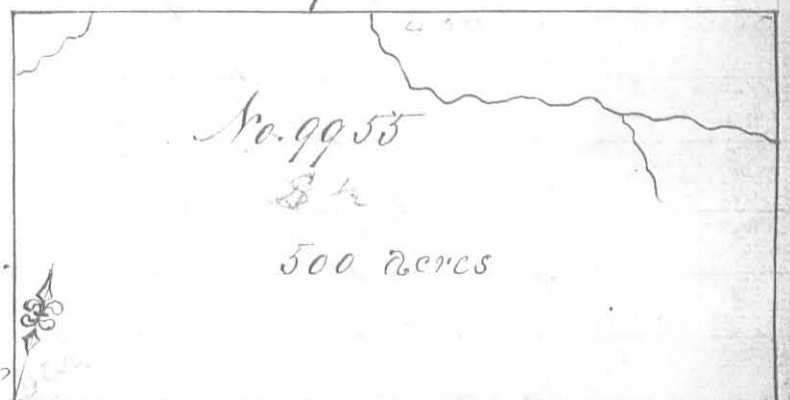

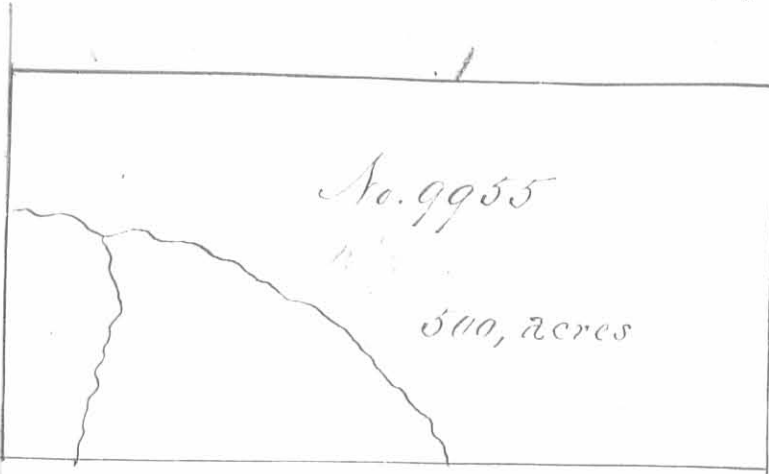

Surveyed for James Barton 500 acres of land on part of a Military War-rant No. 6053 on the waters of Big Miami; beginning at three beeches Northeast corner of James and William Taylors survey No 9954, thence N. 78. E. 400 poles to a hickory

beech and sugar tree, thence S. 12. E. 200 poles to a stake northeast corner to said Bartons survey No 9955; thence S. 78 W 400 poles to a stake northwest corner to said survey in a line of said Taylors survey; thence with said line S. 12. E. 200 poles crossing a branch at 130 poles to the beginning.

Levi D. Sharp  
 Hilkeah Rosebrog & Co.  
 Wilson S. Thompson M.k.r.

Samuel Forrer D.S.  
 February 28. 1820  
 December 8<sup>th</sup> 1820

Surveyed for George Clark a part 1000 acres of land on part of a Military No 5382 on big Miami and Cherokee mans run: Beginning at a Burr oak and beech northeast corner of Walter Duns Entry No. 9925, 1200 poles W from the intersection of Roberts line with the Greenville Treaty line; thence N. 78 E. 400 poles crossing the run at 203 at 214 and at 236 poles to a bur oak and elm northeast corner to Nathan Reeves

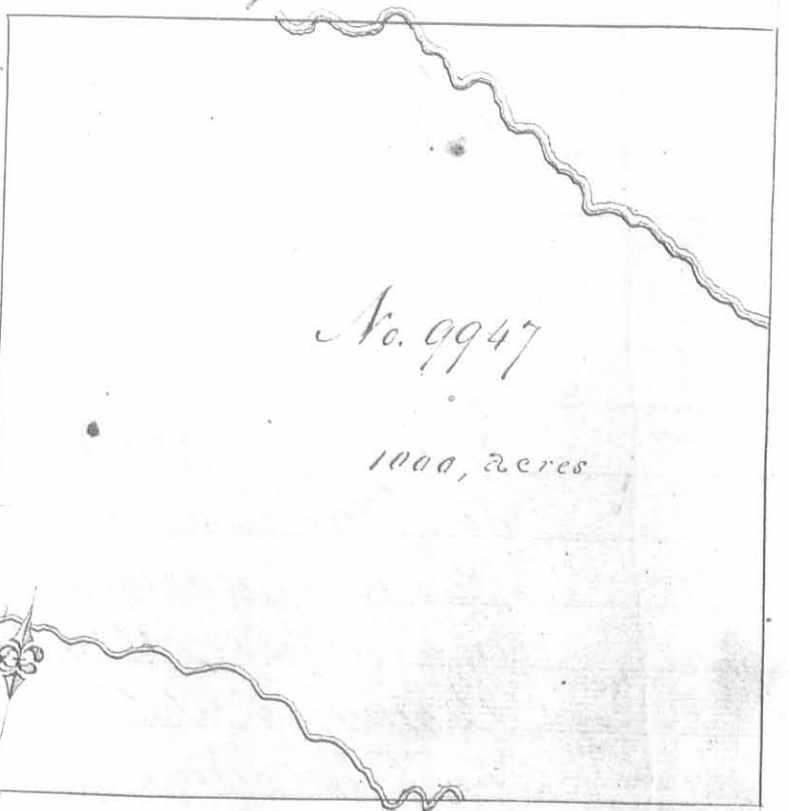

Survey No 9927; thence N. 12. W. 400 poles crossing the Miami at 248 poles to two buckeyes and two sugar trees; thence S 78 W 400 poles crossing the Miami at 190 poles and several times afterwards, leaving it at 256 poles to an iron wood and two beeches on the south side of Miami; thence S. 12. E. 400 poles crossing the run at 214 poles to the beginning.

Levi D. Sharp  
 Hilkeah Rosebrog & Co  
 Wilson S. Thompson M.k.r.

Samuel Forrer D.S.  
 January 26. 1820  
 December 8<sup>th</sup> 1820