

Fisher Survey  
Columbus<sup>2nd</sup> & Hayes St.

see Knight Cambell survey Bond 479 Page 54  
same letters used in sketch.

Found A<sup>2nd</sup> C,  
Found J.

Measured C to B 48' Set Iron  
" C to M 60' Temporary Point  
" M to L 48' Set Iron  
" A to K 60' Set 2x2 Hub.

Measured A to B 157.2

Jolin Deed calls for 48 feet  
set Hubs 48 1/2' S. of C<sup>2nd</sup> & M. This  
was in error 6". Set Irons as  
shown at L<sup>2nd</sup> & B. 48' from C<sup>2nd</sup> & M

Measured North from A<sup>2nd</sup> & K  
165 feet To show Mr Fisher his  
deed distance. Set 2x2 Hubs.

Mr Fisher staked 157.2 was  
line as shown to him when

May - 14 - 1930  
Wright 20  
Bill Wright.

1194

INDEXED ON MAP

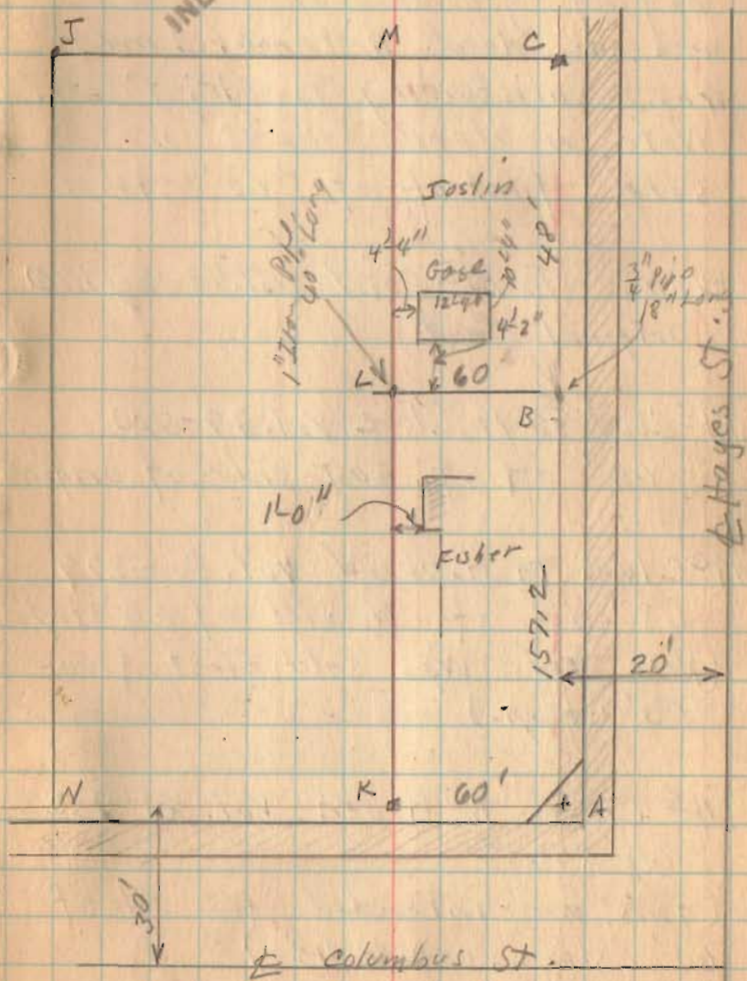

(over)

Fisher Survey (continued)

buying ground and error  
was in deed distance. Limit  
was satisfactory to M<sup>r</sup>. Fisher.  
Note in deeds the 48' was  
sold first off of 60' strip.

Wells To M<sup>r</sup> Coid Vol. 48 Page 170  
(original tract)

M<sup>r</sup> Coid To McClure Vol. 79-510  
60' off of East side of original

McClure To Hubbard Vol. 80-279  
48' off of N. end of 60' strip  
(Note this was sold first from  
60' strip.)

M<sup>r</sup> Coid To Huben Vol. 81-150  
60 X 165  
(This was intended for all of  
60' strip except 48')

5-14-30

71

Huben Vol. 117-282  
60 X 165

M<sup>r</sup> Adams To Schroeder  
Vol. 117-282  
60 X 165

Huben To M<sup>r</sup> Adams 117-282  
60 X 165

Schroeder To Fisher Vol. 122-60  
60 X 165

Morris To Joslin Vol. 130-357  
48 X 60

Hubbard To Hubbard Vol. 89-581  
48 X 60

M<sup>r</sup> Coid To Yarnold 115-243  
all except 60' off of E. Side.

(194)  
INDEXED ON MAP

2"x2" Hub  
with tack

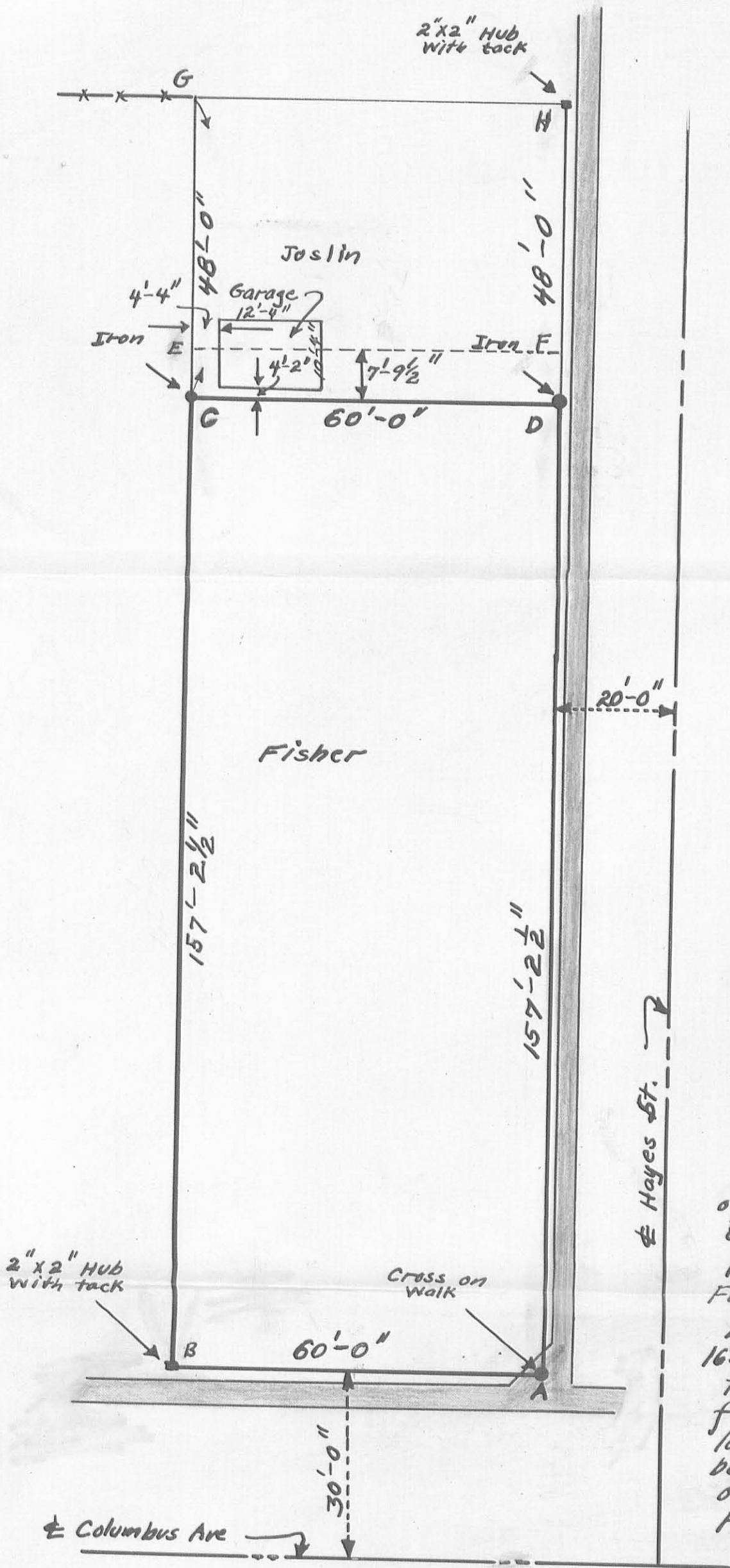

CD = 157'-2 1/2"  
EF = 60'-0"  
GH = 60'-0"  
BC = 157'-2 1/2"  
AD = 157'-2 1/2"

AB	60'-0"
CD	60'-0"
EF	60'-0"
GH	60'-0"
BC	157'-2 1/2"
AD	157'-2 1/2"
CE	7'-9 1/2"
DF	7'-9 1/2"
AF	165'-0"
BE	165'-0"
CG	48'-0"
DH	48'-0"



Survey Notes Logan County  
Surveyor's Book 493 Page 70.  
Surveyed May. 14, 1930.  
F. F. Knight C.E.

60' Sold Mc Coid To Mc Clure  
Deed Vol. 79 Page 510  
Mc Clure To Hubbard 48'  
off of N. end. Deed Vol.  
80 Page 279  
Mc Clure To Huben (Now  
Fisher) 60 x 165 Vol. 81 Page 150  
Line EF as shown is  
165 feet from AB. Note  
the 48 feet was sold  
first. The remaining  
land was described as  
being 165 feet which is  
only 157'-2 1/2" as shown.  
Fisher lot ABCD.

F. F. Knight

FISHER SURVEY  
BELLEFONTAINE OHIO  
1930

1194 1P  
INDEXED ON MAP

REC'D 8-14-01 SURV OK

# Lee Surveying and Mapping Co., Inc.

Land Surveys • Topography • Subdivisions • Construction Layout



117 N. Madriver St.  
Bellefontaine OH 43311

Phone: (937) 593-7335  
Fax: (937) 593-7444

## CULP 0.395 ACRE

Lying in Virginia Military Survey 4990, City of Bellefontaine, Lake Township, Logan County, Ohio.

Being all of the Patrick S. Culp and Ann M. Denny 0.34 acre tract as deeded and described in Official Record 331, Page 954 of the Logan County Records of Deeds and being more particularly described as follows:

Beginning at a 5/8 inch iron rod found at the intersection of the north right-of-way of Columbus Avenue (60 feet wide) and the west right-of-way of Hayes Street (40 feet wide), on the southeast corner of the Donald E. Armstrong 0.22 acre tract (Vol. 336, Pg. 625).

THENCE, with the north right-of-way of Columbus Avenue and the south line of the said 0.22 acre tract, N 86°-00'-46" W, a distance of 60.00 feet to a "X" in concrete set at the TRUE POINT OF BEGINNING.

THENCE, with the north right-of-way of Columbus Avenue, N 86°-00'-46" W, a distance of 83.90 feet to a 5/8 inch iron rod found.

THENCE, with the east lines of the Grant K. Varian 0.41 acre tract (O.R. 112, Pg. 374, Tract III) and the Grant K. Varian 0.33 acre tract (O.R. 112, Pg. 374, Tract I), N 4°-00'-00" E, a distance of 205.19 feet to a 5/8 inch iron rod found.

THENCE, with the south line of the Harold E. Smart, Jr. original 0.085 acre tract (Vol. 376, Pg. 890, Tract III), S 86°-01'-20" E, a distance of 83.90 feet to a 1-1/4 inch square iron bar found.

THENCE, with the west lines of the Harold E. Smart, Jr. original 0.66 acre tract and original 0.05 acre tract (Vol. 376, Pg. 890, Tract II and Tract I), and the aforesaid 0.22 acre tract, S 4°-00'-00" W, a distance of 205.20 feet to the point of beginning.

Containing 0.395 acre.

The basis for bearings is the north right-of-way of Columbus Avenue, being N 86°-00'-46" W, and all other bearings are from angles and distances measured in a field survey by Lee Surveying and Mapping Co., Inc. on August 10, 2001.

Description prepared by:

Jeffrey J. Lee  
Professional Surveyor 6359  
August 13, 2001



ORIGINAL STAMP IN GREEN

L-3209

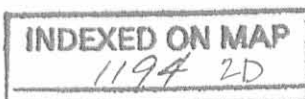

RECD 8-14-01 8M OK

2 WORKING DAYS



**BEFORE YOU DIG**



CALL TOLL FREE **800-362-2764**

OHIO UTILITIES PROTECTION SERVICE.

**LEGEND**

- 5/8 INCH IRON ROD FOUND
- ⊗ "X" IN CONCRETE SET
- 1-1/4 INCH SQUARE IRON BAR FOUND

S C A L E  
30

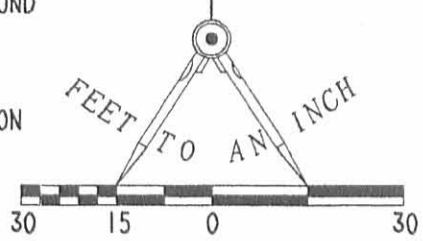

INDEXED ON MAP  
1194 2P

RETRACEMENT SURVEY OF THE  
PATRICK S. CULP AND  
ANN M. DENNY 0.34 ACRE TRACT  
OFFICIAL RECORD 331, PAGE 954  
VIRGINIA MILITARY SURVEY 4990  
CITY OF BELLEFONTAINE  
LAKE TOWNSHIP  
LOGAN COUNTY, OHIO



ORIGINAL STAMP IN GREEN

SURVEYED BY:  
  
JEFFREY I. LEE  
PROFESSIONAL SURVEYOR 6359  
AUGUST 10, 2001

COPYRIGHT 2001 BY:  
**LEE SURVEYING & MAPPING CO., INC.**  
117 North Madriver Street  
BELLEFONTAINE, OHIO 43311  
(937) 593-7335

D 402 PATCULP

L-3209-4