

Plat of Powell's Gift Addition To Bellefontaine Ohio and being Part of the N.E. and S.E. Quarter of Fractional Section No. 35 Town No. 4, Range 14 M.R.S.

Surveyor's Certificate I the undersigned Surveyor do hereby Certify that the annexed Plat is a correct representation of Powell's 5th Addition to Bellefontaine Ohio as surveyed and laid out by me on the 7th to 11th days of March A.D. 1892, and that the following is a true and accurate description of the same, Main Street bears Magnetic N. 6.00 E. Detroit and Henry Streets are Parallel to it, Williams St. and Powell Avenue are at right angle to it except on Powell Avenue from Detroit to Main where the South side of the Avenue bears South from a right angle and the North side forms a continuous line from Main West to terminus. One half of Henry Street 30 feet wide Detroit is continued 60 feet wide, Williams Street is continued 60 feet wide to intersect Elm St. as monumented in the Gardner Addition, Powell Avenue is continued 50 feet wide to Powell's West line, and widened on the North line from Detroit to Main Street in order to straighten the line, All Alleys are Parallel with or at right angles to M Street. All distances on the 5th Addition marked in feet and hundredths, on the abutting Property in same order as found on the records of same All intersections of Streets, and street lines with Property lines marked with stone Monuments as shown by the circles on the annexed Plat. The angles which all marked lines make with each other is marked on the annexed Plat at the point of intersection. Intermediate distances marked on with black ink, complete distances from center to center marked on with brown or red ink Lots 1533, 1544, 1546, 1547, 1548, and 1549 have already been conveyed as fractions of land and are as given on the annexed Plat.

I hereby subscribe my name this Eleventh day of April A.D. 1892. Hilbur A. Ginn Surveyor
Dedication The Henry Powell, Mary Powell, and Rachel Powell Proprietors do hereby certify that the annexed Plat is a correct representation of Powell's 5th Addition to the Village of Bellefontaine O. as surveyed, platted and laid out for us by Surveyor Hilbur A. Ginn in March A.D. 1892. Said Addition is located as set forth in the Surveyor's Certificate and as shown on the annexed Plat and consists of Fifty six Lots of the sizes as given on the annexed Plat and numbered consecutively from 1510 to 1565 inclusive Together with the Streets and alleys as shown on the Plat. The length and width of all Streets and Alleys given and represented in this dedication are as represented by the figures marking the same on the lines thereof, and as described in the Surveyor's Certificate. The Streets and Alleys contained in the above described addition and as represented on the annexed Plat

We hereby dedicate to the public use forever to be held and used for the purposes as set forth and to be in force and effect from the date of Adoption of this Plat by the Council for the incorporation of Bellefontaine O. For Testimony whereof we have hereunto affixed our signatures this 12th day of April A.D. 1892.

Signed and acknowledged }
 in presence of us }
 Hilbur A. Ginn }
 H. L. Nelson }
 Proprietors }
 Henry Powell }
 Mary Powell }
 Rachel H. Powell }
 (Seal) (Seal) (Seal)

Notarization State of Ohio, Logan County, O. Be it remembered that on this 12th day of April A.D. 1892 before me a Notary Public in and for said County personally came Henry Powell, Mary Powell and Rachel Powell, The Proprietors of the above described addition and acknowledged the signing and sealing of the same to be their voluntary act and deed for the uses and purposes therein set forth For Testimony whereof I have hereunto subscribed my name and affixed my official seal on the day and date above mentioned
 H. L. Nelson
 Notary Public
 Logan Co. Ohio

Adoption The annexed Plat was inspected, approved and accepted as an addition to Bellefontaine Ohio on resolution passed by the Village Council at a regular meeting held April 26th 1892
 A. L. Smith, Clerk. A. L. Strick, Mayor

Conveyed from the following Lands 6⁵⁷/₁₀₀ acres in name of Peter S. Powell outside Bellefontaine Corporation and in Sec. No 35, Town 4 Range 14 M.R.S. and the following lands in said Section within the limits of said Village to wit: 8⁸⁴/₁₀₀ Acres in the name of Peter S. Powell, 2²²/₁₀₀ Acres in the name of Mary E. Powell, 1¹³/₁₀₀ Acres in name of Missouri Myers, 1¹⁵/₁₀₀ Acres in name of H. Kaetzmann, 1¹²/₁₀₀ in name of A. S. Clark, 1¹²/₁₀₀ in name of A. L. Smith & 1¹²/₁₀₀ in name of A. Vaughan
 Done at my office this April 27th A.D. 1892
 Christie Williams Auditor Logan Co. Ohio

Recorded for Record April 27th 1892 at 2 O'clock P.M.
 Recorded April 29th 1892
 William Stough Recorder
 INDEXED ON MAP
 1456 ID

PLAT

OF

POWELL'S FIFTH ADDITION.

TO

BELLEFONTAINE, OHIO.
1892.

Elam Bookwalter.

WRIGHT, SCARFF & MILLER.

I.S. Gardner's Addition, No. 8.

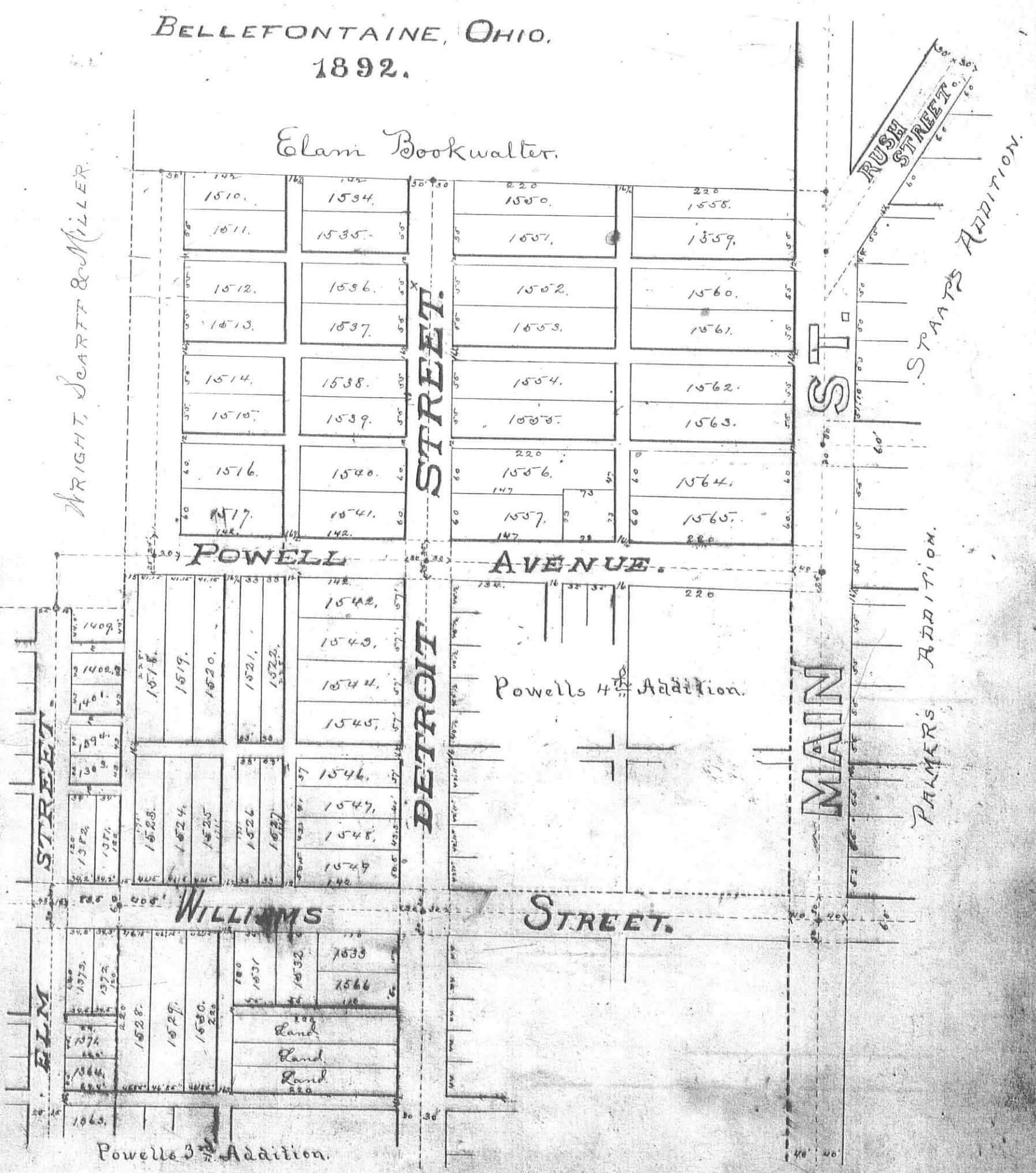

INDEXED ON MAP
1450