

Lot 1698 to Virginia St.

Stanton & Park

M. 36" Oak Dr. E. 32.60—

10" Lyrus S.W. 25.80

Maple 8" S.W. 55.85

cut on Stanton from Main

⊙ curd Point to Glen ⊙

Park = 506.5 feet exact meas.

Park St. + High

Hyd. S.E. sloping measure 15'

8" Maple S.W. 29.40

Electric Light Pole N.W. 20.1'

Stake ⊙ Park St + High Ave

East N. 54.30'

Stanton and Stanley on
Campbell St.

Iron bar

Ohio St. 50 feet wide

Ohio of Stanton

Iron bar

Bluishade tree 1" dia S.E. 24'

Elm shade tree 1" dia N.E. 34.8'

High to Stanton on Ohio

358.6'

1786

High Ave.

Stake at Park and
East High

Mod. M.

Electric light pole N.E. 23.4'

N.W. cur. Howard house S.E. 42.35'

High & Stanley

Iron bar

Double history N.W. 48.7'

Stake west " 44.0'

High & Virginia

Iron bar 20' S of N. line

High & Ohio

Iron bar W line Ohio

20' S. of ~~line~~ N. line

Old iron bar N line Ohio

St. + center High Ave.

N.E. + 2 story frame. Box

plum tree 8" S 66 1/2 W. 143.2'

Cherry tree 8" dia S. 4 W. 48.5'

Apple tree 12" dia S. 54 1/2 E.

67.9'

Stake stake S. 9 1/4 E. 25'

See page 96

CAMPBELL'S ADDITION

High (East) of Green
 iron bar 6" below surface
 W. Oak 22" dia. 367' E
 11.3.2'. N.E. Cor. foundation
 1 1/2 story frame house
 S. 21 3/4 W. 66.7 feet.

Stanton Street
 Plat dit: Campbell to
 Virginia 275'-9"

Plat dit: Virginia to
 Ohio 486'

150
16
119' 1"
11
285' 1"
26
311' 1"

FB C.M. RICHEY 1

1964

CAMPBELL'S ADDITION

4/28 1912
 H. Murphy ch. 1/2 da.

Dragest at 0 High of Green
 No M"

Found 0 High on Park Meas. N.
 S. 4.33 for 0 E. High

Found iron bar at 0 High of
 Stanley w. by double Richey
 and stake 44 ft. west.

Found iron bar 0 Ohio
 and High.

Angle in High St. 21'-10"
 West of iron bar at 0
 Stanley of High

Found M" 0 park
 Stanton

Found iron bar 0 Stanton
 and Ohio

Found iron bar 0 Stanley &
 Stanton.

Found old stake ats. w. W
 Lot 1689

Meas. W. 291 feet Green 0
 Stanton of Stanley on Stanton
 for W. line Lot 1689
 Produced Volume 1689 S. to
 N. line E. High

Campbell's Add.

267 feet = dist. on N. Line
High to W. line 1701 from
W. line Stanley St. or S. E.
Corner 1705

$$267 - 16 = 251 + 5 = 50.20$$

63 - 8"
64 - 0"
59 - 2 3/8"
177 - 10 3/8"

lots 1698 to 1705 inclusive
50.2 front

Set & stakes for lots

1698 to 1710

and 1689 to Virginia St.

22 lots

Time

Searching records 1.00

Field 4/23 1/2 da 2.50

" 4/24 1 da 5.00

Cash pd. Thos. Huls ch. 1.25

" pd. H. Murphy ch.

Cr. by 30 stakes @ 25¢ .75

FB C.M. RICHEY 11706

Marion Survey

Forest Cory Survey

1902

J. C. Warden

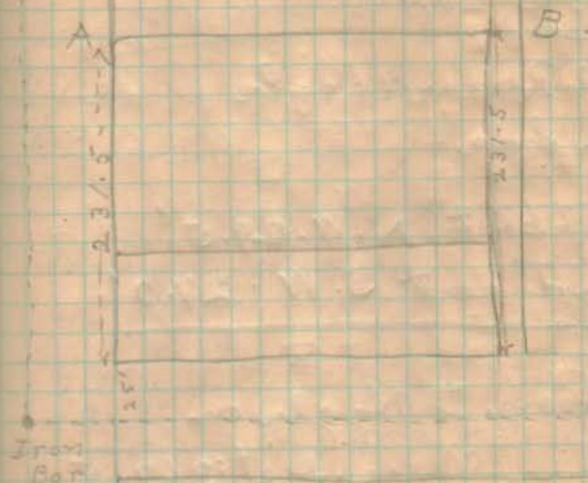

Line A.B. original
dipping back between
Stanton & Palmer

Description of Corners:

Marion & High Iron bars
Wit: S. E. + corner of stone
wall 39.8', Banquet 35.1'

Marion & Williams
Iron Bar Wit: Hydrant N. E.
32.2' N. E. Cor. E. coping arch
cubical 46.33'
N. W. Cor. W. coping arch. 48.25'
over

1422