

Sept-22-1943

Dailey
Dyert
Burket
Knief

Conc. Pavement

Drilled $\frac{3}{4}$ " hole -
Countersunk brass marker in
conc. pavement - cemented - $\frac{1}{4}$ " below
surface

This Mon Removed by City when
they placed storm sewer on
E of Lake Ave.

(S-34)
 $\frac{1}{4}$ S-34
S-33

Silver Lake Pile at NYC-RR

22

N

SEC. 34-4-14

SE < NW Q

SE-Q

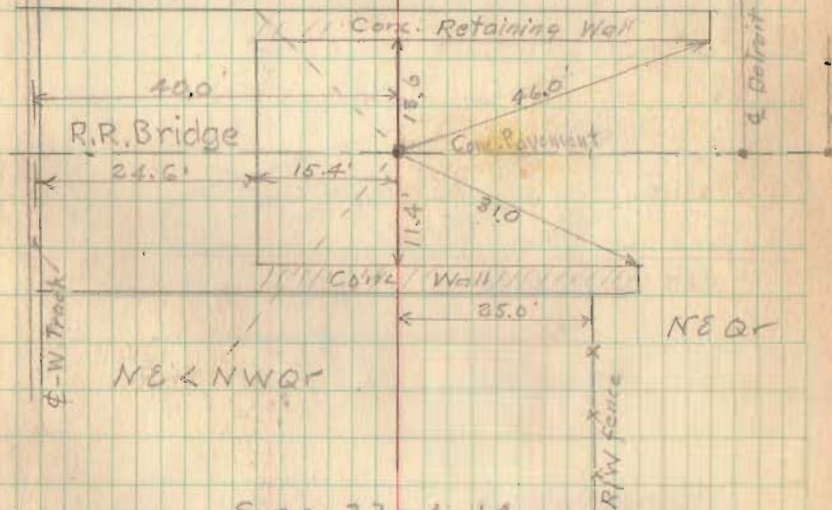

SEC. 33-4-14

2636

INDEXED ON MAP