

Received 7-26-91
OKed 7-29 91 JLB ge+✓

LESLIE H. GEESLIN
REGISTERED SURVEYOR NO. 5248
P. O. BOX 274
RUSHSVLVANIA, OHIO 43347

TELEPHONE: (513) 468-2793

EASEMENT

The following described real estate situated in the State of Ohio, County of Logan, Township of Lake, being part of Lot 4103 in Brookwood Addition No. 2 to the City of Bellefontaine and more particularly described as follows:

Commencing at the northeast corner of Lot 4103 in the west line of Hillcrest Drive.

Thence with the north line of said Lot 4103 S. 89° 50' 05" W. 28.00 feet to the place of BEGINNING.

Thence S. 00° 09' 55" E. 4.00 feet to a point.

Thence S. 87° 10' 49" W. 43.40 feet to a point.

Thence N. 00° 09' 55" W. 6.01 feet to a point in the north line of Lot 4103 .

Thence with said north line N. 89° 50' 05" E. 43.35 feet to the place of beginning.

Bearings are based on an assumed bearing (S. 89° 50' 05" W.) in this field survey.



Leslie H. Geeslin
LESLIE H. GEESLIN
RUSHSVLVANIA, OH
(513) 468-2793

INDEXED ON MAP
3425 2D

E. BROWN AVE

LOT 4104

LOT 4103

LOT 4102



INDEXED ON MAP
3425 2P

EASEMENT SURVEY ON LOT 4103
IN BROOKWOOD ADDITION #2 LAKE
TOWNSHIP, LOGAN COUNTY, CITY
OF BELLEFONTAINE, OHIO.

JULY 25, 1991
SCALE: 1"=20'

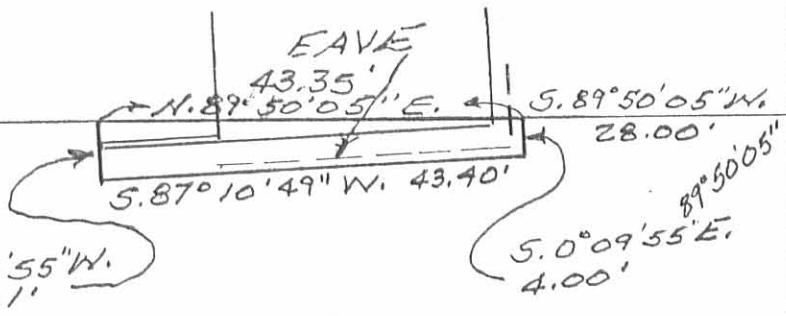

Leslie H. Geeslin
LESLIE H. GEESLIN
RUSHsylvania, OHIO
PH 513-468-2793

90.0' TO
1" IRON PIPE
FOUND
89.75'
HILLCREST DRIVE (50')
5/8" IRON BAR FD

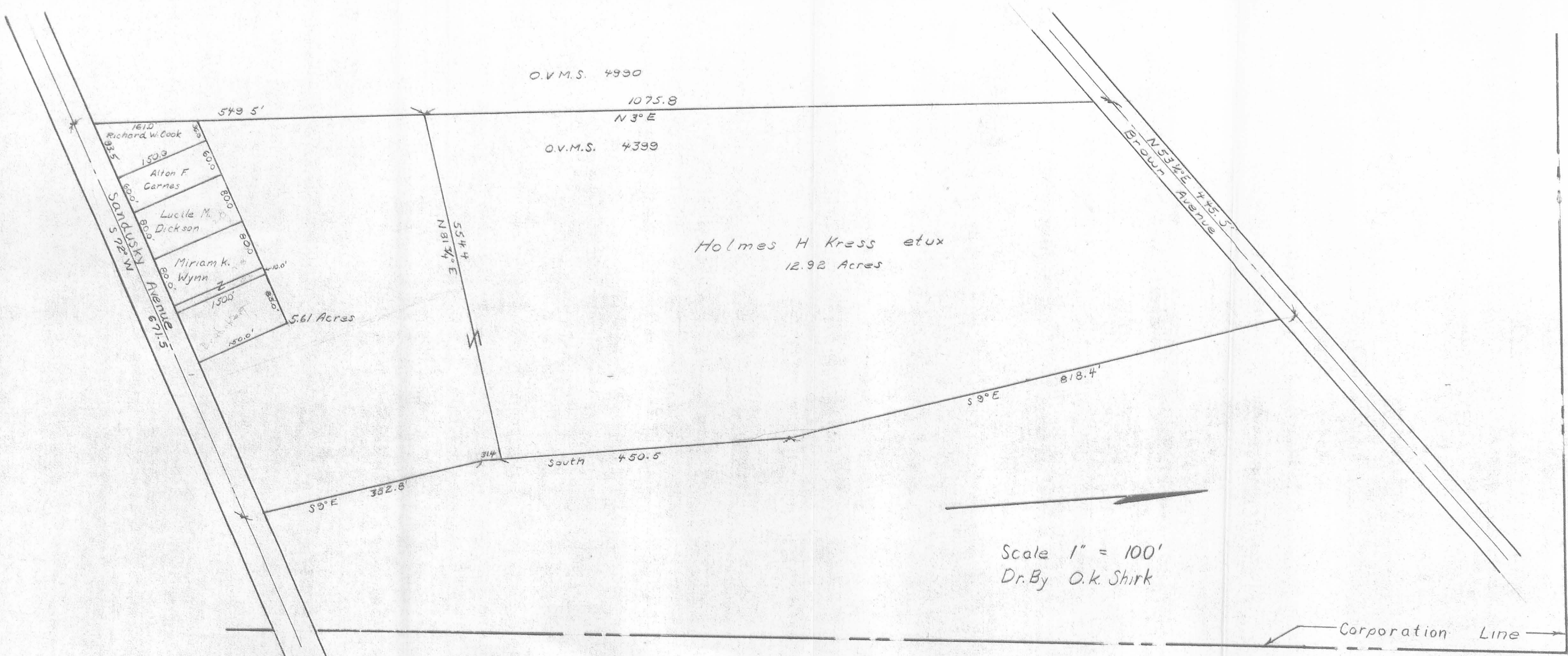

Scale 1" = 100'
 Dr. By O.K. Shirk

3425 3P

Note:
 This drawing was
 made from deed descriptions.

LEGEND

- 1" PIPE FOUND
- ⊕ RAILROAD SPIKE SET
- 5/8" I. ROD SET

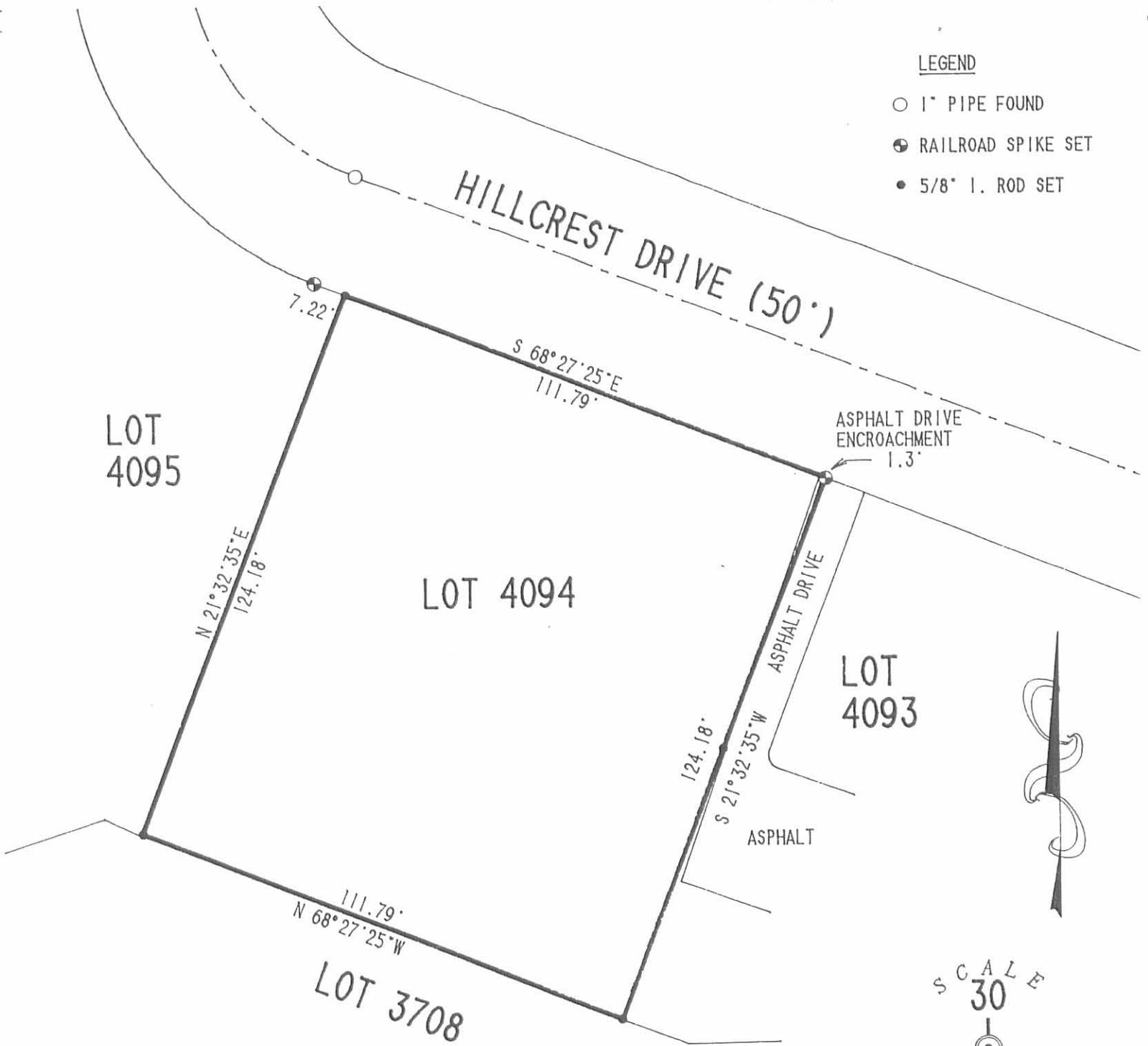

RETRACEMENT SURVEY OF
 LOT 4094
 CITY OF BELLEFONTAINE
 LAKE TOWNSHIP
 LOGAN COUNTY, OHIO



ORIGINAL STAMP IN GREEN

SURVEYED BY:

Jeffrey L. Lee
 JEFFREY L. LEE
 PROFESSIONAL SURVEYOR 6359
 JANUARY 28, 1992

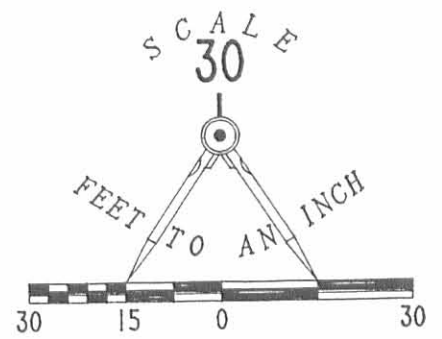

INDEXED ON MAP
 342549

LEE SURVEYING & MAPPING CO.
 143 East Columbus Avenue
 BELLEFONTAINE, OHIO 43311
 (513) 593-7335
 DISK 63 GLENNON L 1925-4

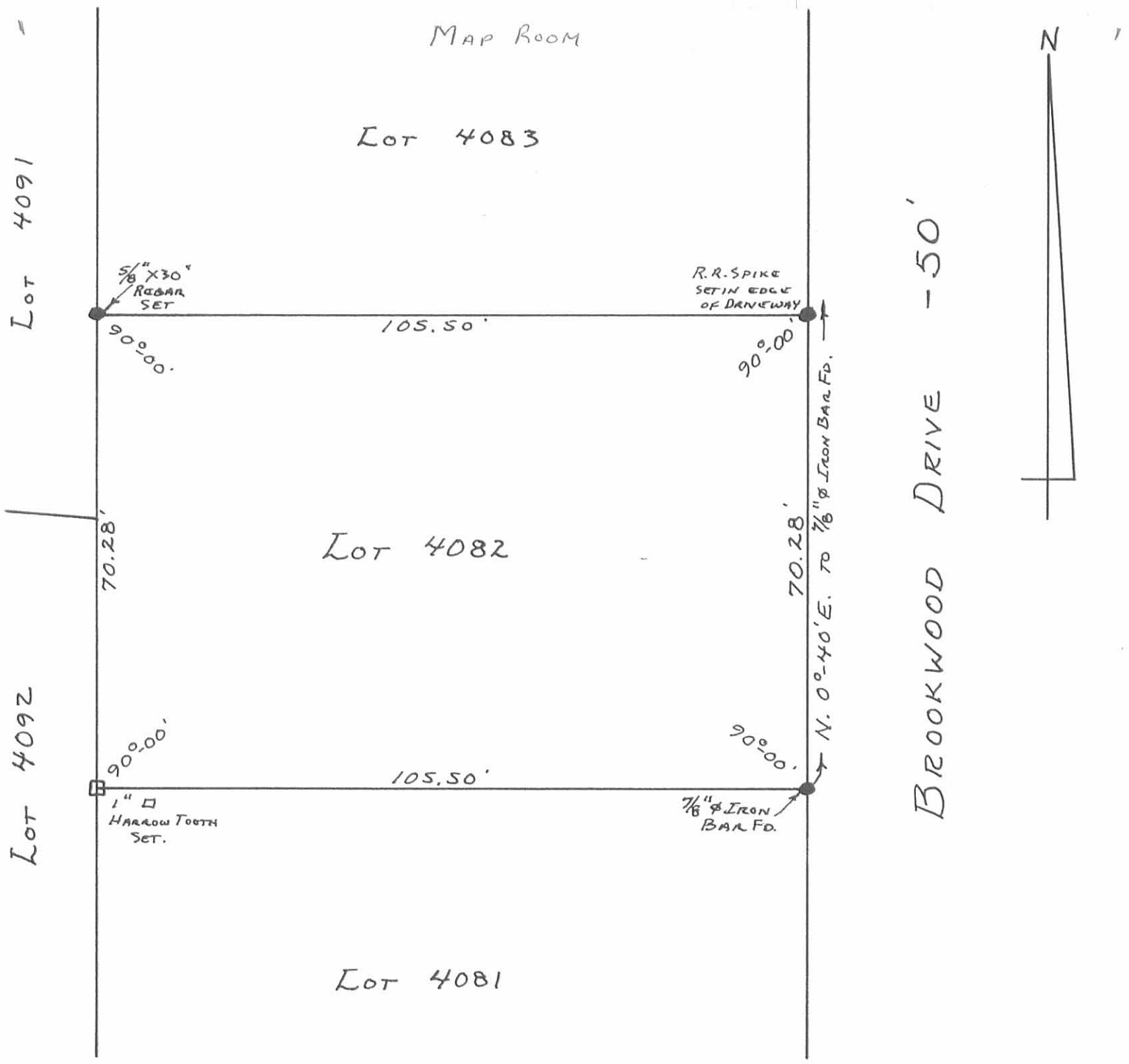

MAP ROOM

Lot 4083

Lot 4082

Lot 4081

BROOKWOOD DRIVE - 50'



INDEXED ON MAP
3425 5P

Daniel E. Gilbert
 DANIEL E. GILBERT, P.S.
 REG. SUR. NO. 5402
 400 N. PARK ST.
 BELLEFONTAINE, OHIO
 43311



J. F. PATRICK SURVEY
 Lot No. 4082
 Brookwood Add. No. 2
 CITY OF BELLEFONTAINE
 LAKE TOWNSHIP
 LOGAN COUNTY, OHIO
 JULY 26, 1988

SCALE: 1"=20'

088-051

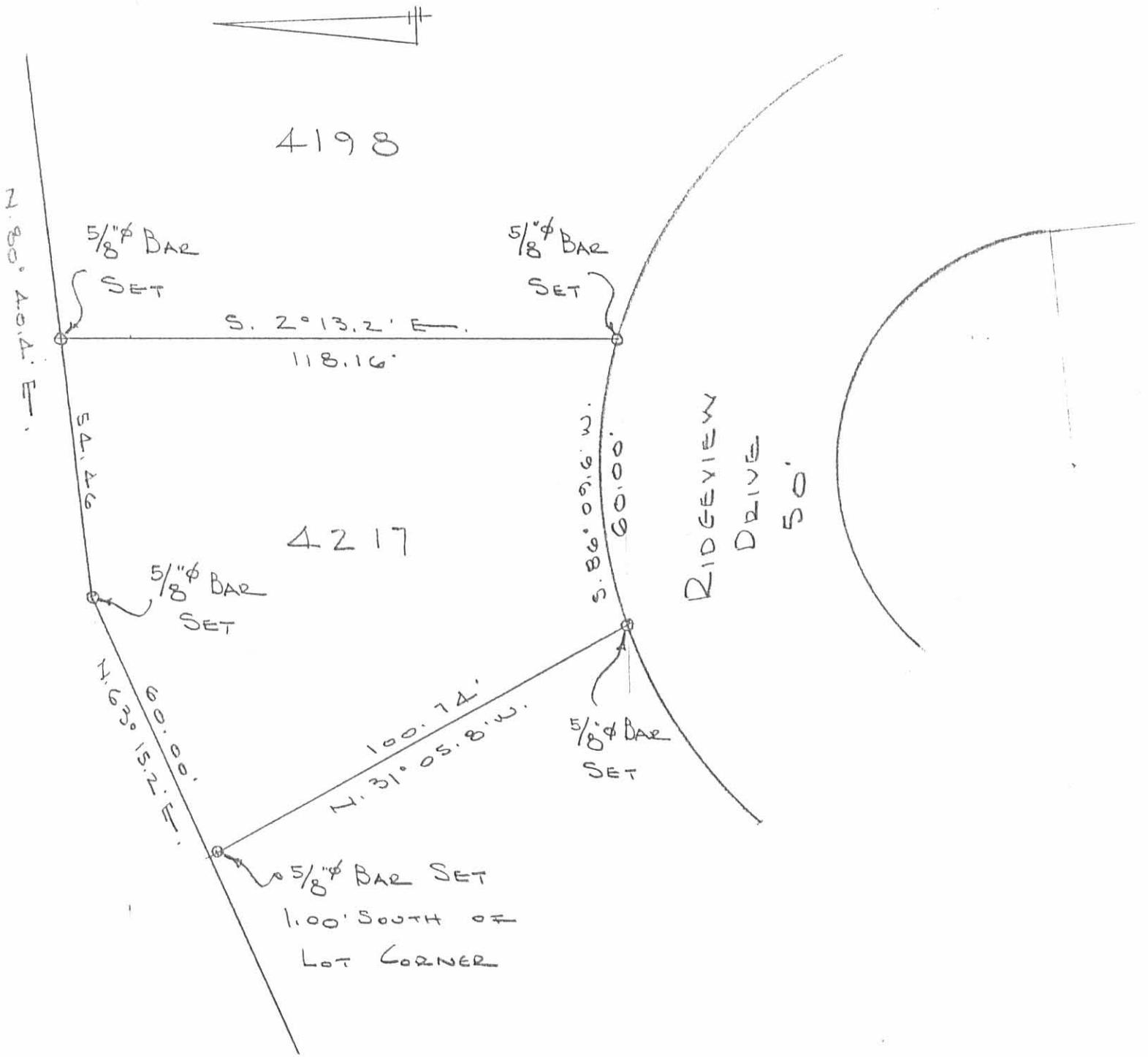

SURVEY OF
 LOT No. 4217
 BELLEFONTAINE, OHIO
 JUNE 26, 1982
 SCALE 1" = 30'

INDEXED ON MAP
 3425 6P

DAN L. DODSON
 REG. SURVEYOR 4270
 BELLEFONTAINE, O.

Received 7-19-91
OK JLB 7-22-91

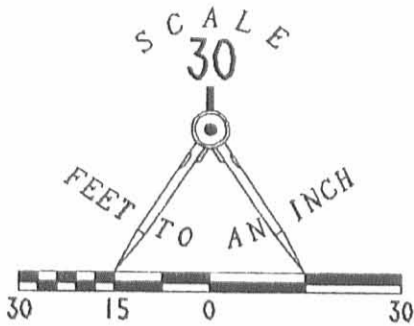

- LEGEND**
- ⊙ 1" PIPE FOUND
 - 3/4" PIPE FOUND
 - 5/8" I. ROD FOUND
 - PK NAIL SET IN CONCRETE
 - 5/8" I. ROD SET
 - ⊕ RAILROAD SPIKE SET

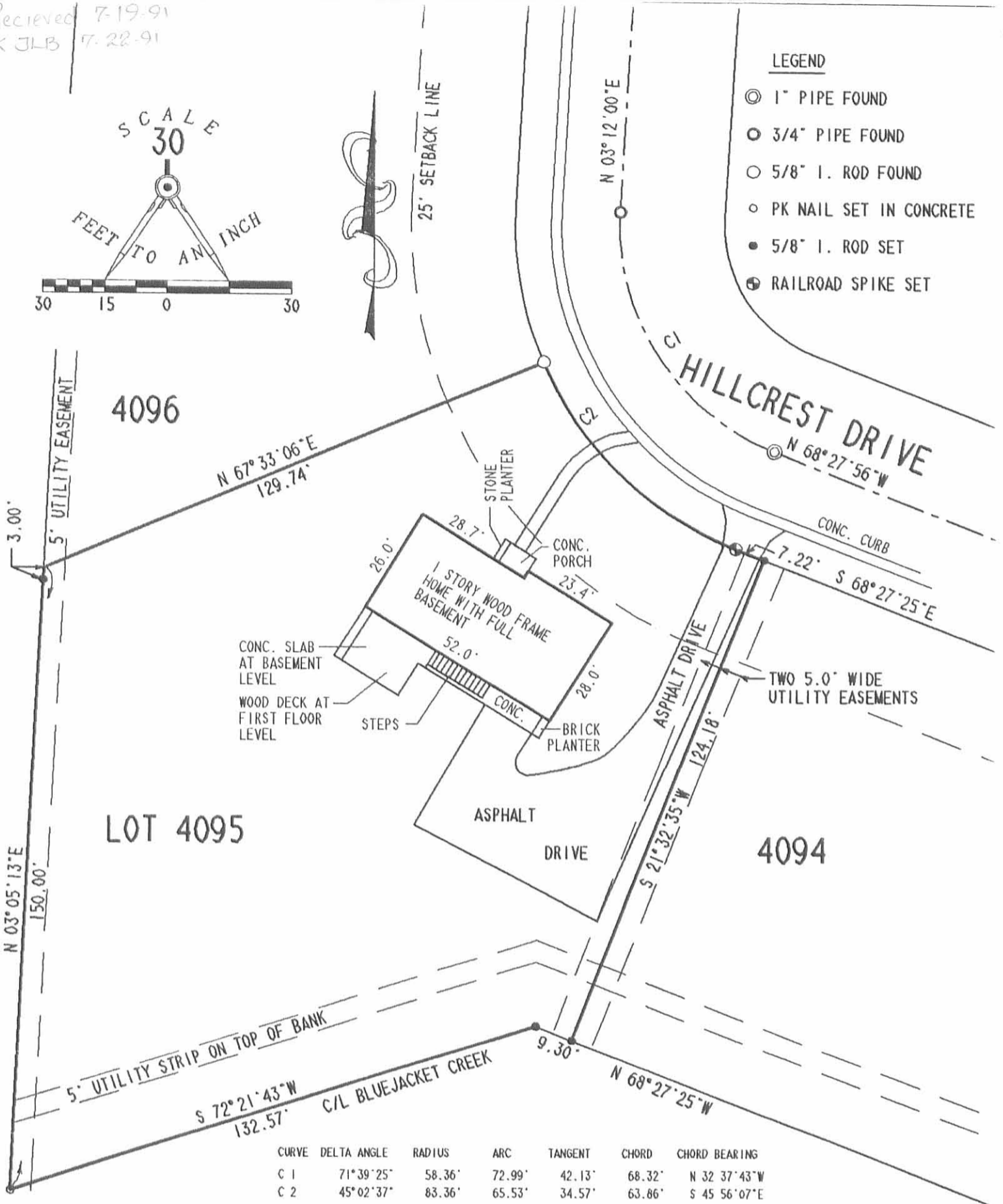

CURVE	DELTA ANGLE	RADIUS	ARC	TANGENT	CHORD	CHORD BEARING
C 1	71°39'25"	58.36'	72.99'	42.13'	68.32'	N 32°37'43"W
C 2	45°02'37"	83.36'	65.53'	34.57'	63.86'	S 45°56'07"E

LOT 4095 OF THE BROOKWOOD ADDITION NO. 2 TO THE CITY OF BELLEFONTAINE
V.M.S. 4399. LAKE TOWNSHIP. LOGAN COUNTY, OHIO.

THE PREMISES SHOWN HEREON ARE IN FLOOD ZONE "C" (AREA OF MINIMAL FLOODING)
PER THE NATIONAL FLOOD INSURANCE ZONE MAP 390340 0001C DATED JULY 16, 1984.

I HEREBY STATE TO OHIO BAR TITLE INSURANCE COMPANY AND FARMERS BANKING COMPANY
THAT THERE ARE NO ENCROACHMENTS FROM NOR UPON THE SUBJECT PREMISES AND THAT
THE FOREGOING MORTGAGE LOCATION SURVEY WAS PREPARED FROM ACTUAL FIELD
MEASUREMENTS IN ACCORDANCE WITH CHAPTER 4733-38, OHIO ADMINISTRATIVE CODE.
AND IS ALSO, A BOUNDARY SURVEY PURSUANT TO CHAPTER 4733-37 OF SAID CODE.



Jeffrey I. Lee
JEFFREY I. LEE
PROFESSIONAL SURVEYOR 6359
JULY 10, 1001

INDEXED ON MAP
3425 7P

LEE SURVEYING & MAPPING CO.
143 East Columbus Avenue
BELLEFONTAINE, OHIO 43311
(513) 593-7335

ORIGINAL STAMP IN GREEN

DISK 48 EDSWARTZ L 1025-4

1951

DESCRIPTION OF BROOKWOOD ADDITION
BELLEFONTAINE, OHIO

The following described real estate situated in the city of Bellefontaine, Township of Lake, County of Logan, State of Ohio and being a part of Virginia Military Survey 4399 and more particularly described as follows:

Commencing at an iron pin at the intersection of Linden Street and State Highway No. 235 (Sandusky Ave.) Thence with the center of said state highway N. 75°-16' E. 1098.2 feet to a point.

Thence N. 14°-44' W. 30.0 feet to a point, said point being the beginning point of this description. Thence continuing N. 14°-44' W. 150.0 feet to an iron; Thence S. 75°-16' W. 351.0 feet to ~~a fence post in~~ the west line of the above mentioned O.V.M.S.; Thence with said survey line N. 5°-42' E. 462.4 feet to a stake in the center of Blue Jacket Creek. Thence with center of said creek the following two courses N. 75°-00' E. 132.9 feet to a stake and S. 66°-22' E. 136.3 feet to a stake; Thence S. 14°-44' E. 499.2 feet to an iron pin; Thence S. 75°-16' W. 50.0 feet to the place of beginning. Containing 3.22 acres more or less.

INDEXED ON MAP
3425 8D

APPROVED

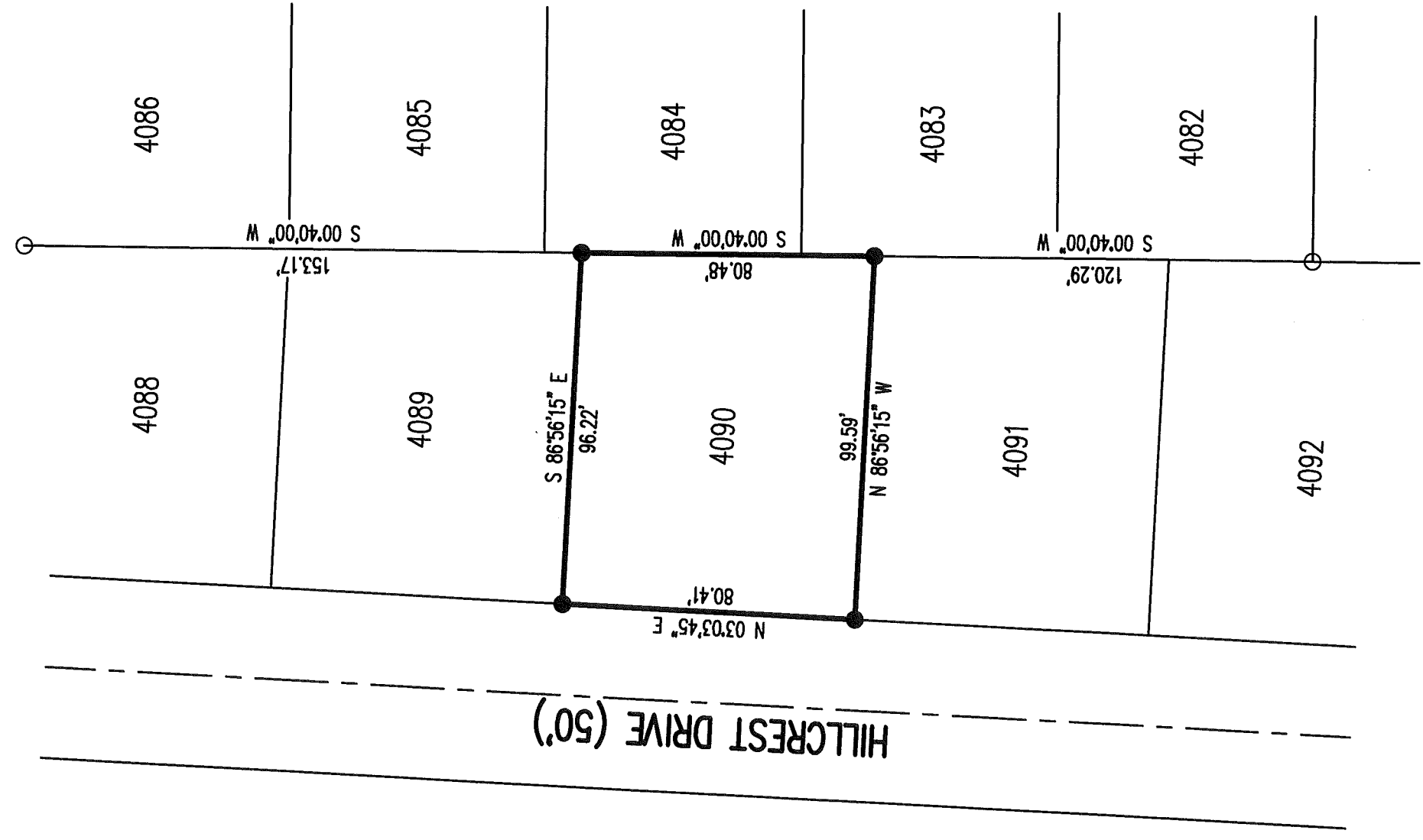
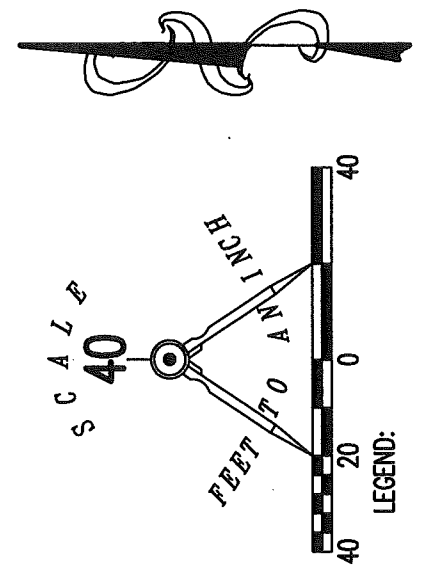

RETRACEMENT SURVEY OF THE
 SUSAN REAMES
 LOT 4090
 BROOKWOOD ADDITION NO. 2
 PLAT CABINET A, SLIDE 375
 OFFICIAL RECORD 1268, PAGE 449
 CITY OF BELLEFONTAINE
 LAKE TOWNSHIP
 LOGAN COUNTY, OHIO

SURVEYED BY:

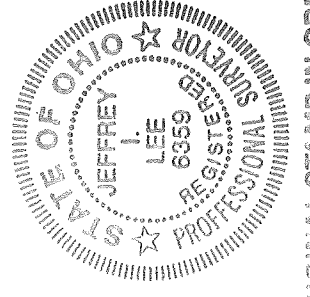

THIS SURVEY WAS PREPARED IN THE ABSENCE OF
 A COMPLETE AND ACCURATE TITLE SEARCH AND
 DOES NOT GUARANTEE TITLE.



2 WORKING DAYS
BEFORE YOU DIG
 CALL TOLL FREE **800-362-2764**
 OHIO UTILITIES PROTECTI ON SERVICE.

JEFFREY L. LEE
 PROFESSIONAL SURVEYOR 6359
 SEPTEMBER 5, 2017

COPYRIGHT 2017 BY:
LEE SURVEYING & MAPPING CO., INC.
 117 North Madriver Street
 BELLEFONTAINE, OHIO 43311
 (937) 593-7335
 WWW.LSMINC.US
 surveys@lsminc.us

ORIGINAL STAMP IN GREEN

INDEXED ON MAP
 2425 9

KSS D0817 62910817 L-6291-3

5-6-19



APPROVED

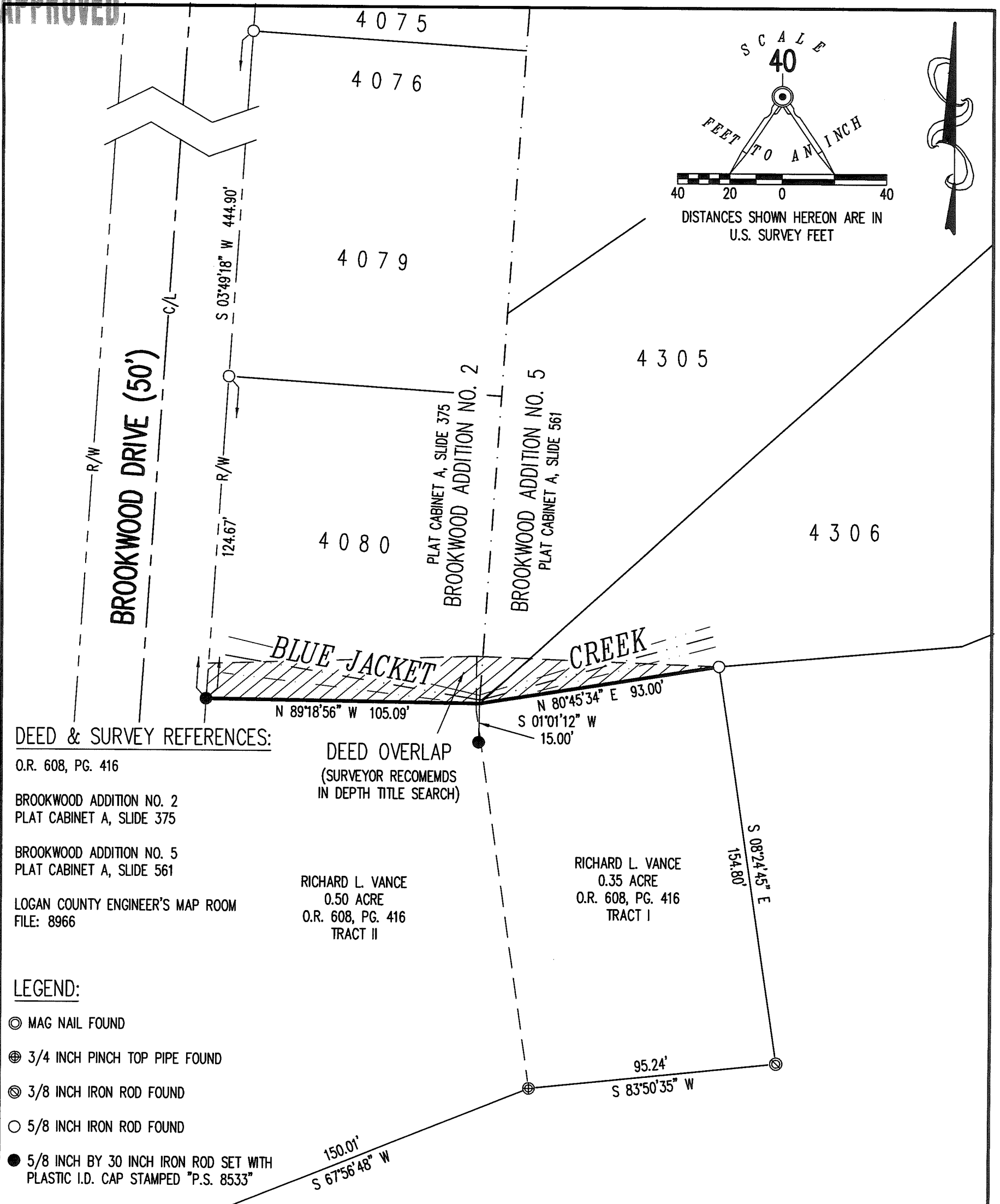

DEED & SURVEY REFERENCES:

- O.R. 608, PG. 416
- BROOKWOOD ADDITION NO. 2
PLAT CABINET A, SLIDE 375
- BROOKWOOD ADDITION NO. 5
PLAT CABINET A, SLIDE 561
- LOGAN COUNTY ENGINEER'S MAP ROOM
FILE: 8966

LEGEND:

- ⊙ MAG NAIL FOUND
- ⊕ 3/4 INCH PINCH TOP PIPE FOUND
- ⊗ 3/8 INCH IRON ROD FOUND
- 5/8 INCH IRON ROD FOUND
- 5/8 INCH BY 30 INCH IRON ROD SET WITH PLASTIC I.D. CAP STAMPED "P.S. 8533"
- R/W = RIGHT-OF-WAY
- C/L = CENTER-LINE

BASIS FOR BEARINGS:

BEARINGS AND DISTANCES, SHOWN HEREON, ARE DERIVED FROM GPS OBSERVATIONS BASED ON GRID NORTH, OHIO STATE PLANE COORDINATE SYSTEM, NORTH ZONE, NAD83 (2011, EPOCH 2010), WITH THE EASTERLY RIGHT-OF-WAY OF BROOKWOOD DRIVE HAVING A BEARING OF S 03°49'18" W.

THIS SURVEY WAS PREPARED IN THE ABSENCE OF A COMPLETE AND ACCURATE TITLE SEARCH AND DOES NOT GUARANTEE TITLE.

RETRACEMENT SURVEY OF THE
SOUTHERLY LINES OF
LOT 4080 OF
BROOKWOOD ADDITION NO. 2
PLAT CABINET A, SLIDE 375
AND LOT 4306 OF
BROOKWOOD ADDITION NO. 5
PLAT CABINET A, SLIDE 561
VIRGINIA MILITARY SURVEY 4399
CITY OF BELLEFONTAINE
LAKE TOWNSHIP
LOGAN COUNTY, OHIO

SURVEYED BY:

D. Neer
DANIEL A. NEER
PROFESSIONAL SURVEYOR NO. 8533
APRIL 25, 2019

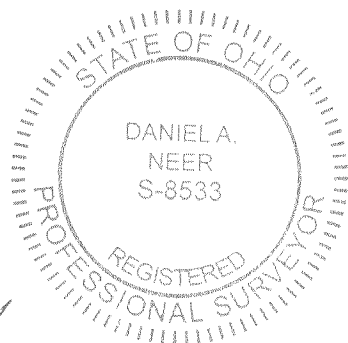

COPYRIGHT 2019 BY:
LEE SURVEYING & MAPPING CO.
117 North Madriver Street
BELLEFONTAINE, OHIO 43311
(937) 593-7335
WWW.LEE-SURVEYING.COM
surveys@lee-surveying.com
KSS D0319 65070319 L-6507-3

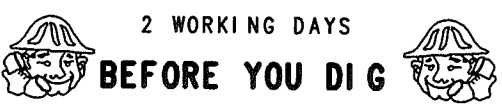

CALL TOLL FREE 800-362-2764
OHIO UTILITIES PROTECTION SERVICE

INDEXED ON MAP
3425