

202  
 N<sup>o</sup> 244  
 (8328)

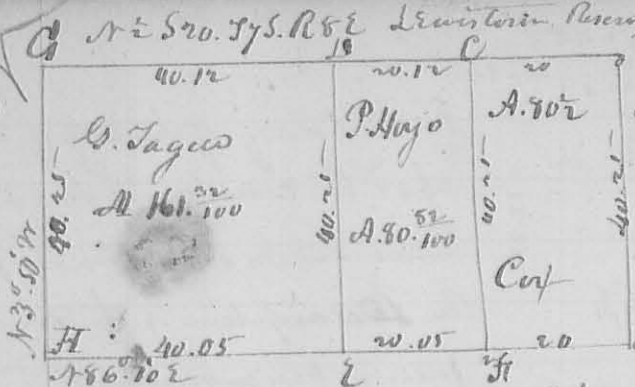

The lines of this survey bear from south running north thus: N 33° 50' W and at right angles N 86° 10' W. Corners of survey, at a gr. corner on East line of feet B. N. 6 corner of the feet. C. Bur. oak 10 l<sup>o</sup>

56 l<sup>o</sup> E 24 links Lynn 10 l<sup>o</sup> N 88° 13 links. 22 gr. corner. E Hickory 22 185° 34 links Beach 10 l<sup>o</sup> N 40° 17 links, at a Beach 20 l<sup>o</sup> N 30° 23 links and Beach 18 l<sup>o</sup> S 57° 26 links. The lengths of the lines, and quantity of acc. marked on the lines, and tot.

H. Kiger Geo. Driesbach ch. man. June 17<sup>th</sup> 1834  
 L. Hopkins depy. Sur.

N<sup>o</sup> 245. Represents part of  
 S 17. 620 to wit. 9<sup>th</sup> N E gr. 500  
 E to S W. of same and north pt of  
 S 17. 575 R 7 E. & R 8 E.

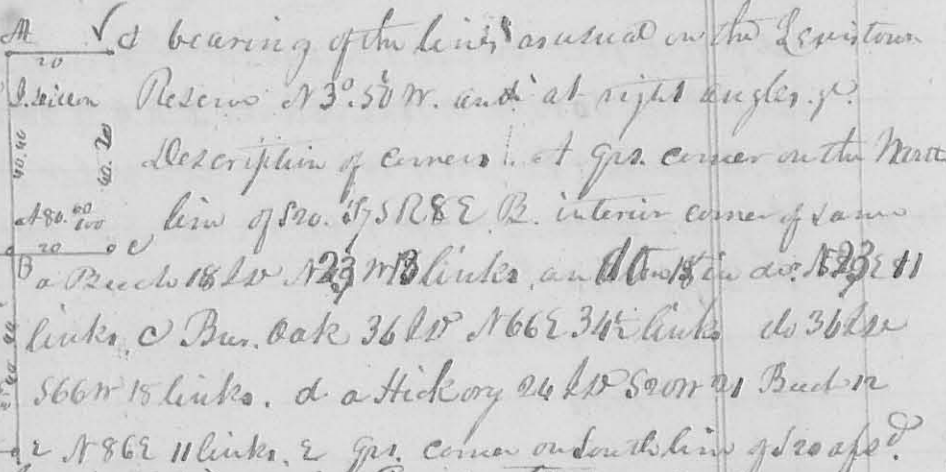

bearing of the lines as used on the Lewis town Reserv. N 3° 50' W. and at right angles. Description of corners: at gr. corner on the North line of S 17. 575 R 8 E. B. interior corner of same a Beach 18 l<sup>o</sup> N 23° 18 links, and a Beach 11 links. C. Bur. oak 36 l<sup>o</sup> N 66° 34 links do 36 l<sup>o</sup> S 66° 15 links. d. a Hickory 24 l<sup>o</sup> S 90° 21 Beach 12 N 86° 11 links, 2 gr. corner on South line of scope. E. a Beach 10 l<sup>o</sup> N 88° 26 links, a Beach 10 l<sup>o</sup> S 88° 26 links, at a Bur. oak 12 l<sup>o</sup> S 10° 12 links, and a Sand 8 l<sup>o</sup> N 15° 38 links, at a Beach 10 l<sup>o</sup> N 49° 16 links, below 3 l<sup>o</sup> S 89° 8 links, at a Beach 22 l<sup>o</sup> S 12° 18 links, Ash 30 l<sup>o</sup> N 12° 15 links, R. Ash 18 l<sup>o</sup> S 22° 32. Sand 6 l<sup>o</sup> N 33° 41 links Surveyed June 17<sup>th</sup> 1834

H. Kiger Geo. Driesbach ch. carrier  
 L. Hopkins depy. Sur.

N<sup>o</sup> 246  
 E to S E gr. and  
 W to S W gr. of  
 S 32° 33 S 75  
 Rye.



this plat represents a survey on Lewis town Reserv. Corner as usual, the distance is marked on the lines of the feet. Corners as follows: a Beach 12 l<sup>o</sup> N 88° 12. Bur. oak 12 l<sup>o</sup> S 22° 19 links b. Lynn 22 l<sup>o</sup> N 11° 34 links. Beach 20. S 11° 43 links. c. Hickory 24 - 15 l<sup>o</sup> 15 l<sup>o</sup> S 65° 22. 22 gr. corner between S 32° 33 & 23 & Beach 15 l<sup>o</sup> S 92° 31 links do 16 l<sup>o</sup> S 62° 40 links. d. all 6 l<sup>o</sup> N 62° 11. Beach 22. 56 l<sup>o</sup> 25 links -

A. Gardner W. Fisher ch. man  
 June 24. 1834  
 L. Hopkins depy. Sur.