

Aug 1835

Corner stake standing in the center of the creek, thence down the creek with its meanders as follows S30 1/2 E 11.50 S22 1/2 E 8.50 N66 E 9.40

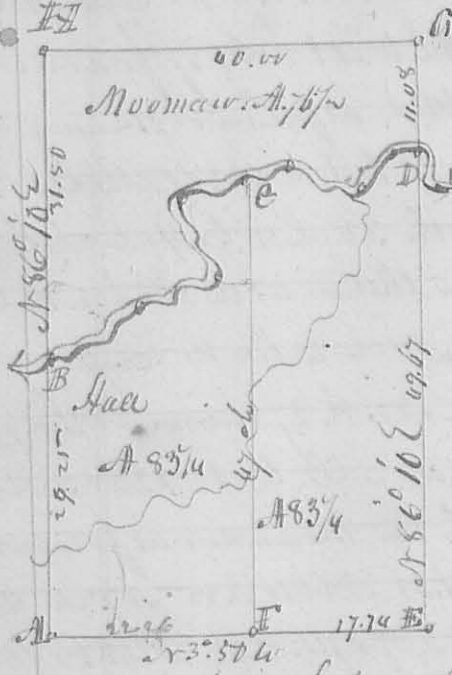

g. 40 S18 E 12.30 S15 W 7.50 S37 E 5.00
 S47 W 2.50 to a stake in the south line of the lot see letter D thence with said line S86.10 W 49.67 ch to the SW corner of the section, thence N3 1/2 W 40 chains to the beginning, containing 166 1/2 acres - divided by the right line C F into two equal parts as follows. Beginning at H in the west line of the section 17.74 from the SW corner at a Post 15 1/2 S 54 E 7 Links, Red 8 1/2 N 12 E 42 1/2 Links thence N 86 10 E, crossing a small branch several times 47 ch. to a stake on the river bank.

Comers

Description of corners. At pt. corner B, forked willow & ash above described. E. Sect. corner II. Corner of Moomaw land. Red Elm 36 1/2 N 25 W 17 1/2 Links, Ironwood 6 1/2 S 50 W 36 Links. C. Post 18 S 13 E 30 Links. Sugar tree 17 1/2 S 8 Links.

Aug 1. 1835

Dan Hopkins S. P. C.

N^o 285

8353

Surveyed for R. Patterson Fifty acres of Land being part of the NW 1/4 of tract S27 3/4 R 14 W R 1 as follows beginning at the SW corner of the sect. thence N 7 1/2 E 40 chains to a Black Oak 22 1/2 N 36 W 42 Links, White Oak Grub 2 1/2 S 11 E 39 L. thence S 89 1/2 E 12 ch. 30 Links to a Black Oak 27 1/2 N 33 E 24 Links, a Black Oak Grub 2 1/2 S 69 1/2 W 36 Links, thence 1/2 W 40 chains to a stake in a prairie in the south line of the section, thence N 89 1/2 W 12 ch. 50 Links to the beginning. Containing 50 acres.

Aug. 1835

Dan Hopkins S. P. C.

N^o 286

8354

Surveyed off the NW 1/4 of S 18 T 5. N R 2, beginning at the SE corner of said quarter a White Oak 15 1/2 N 36 W 12 1/2 Links, W. O 8 1/2 S 11 E 5 Links, thence S 86.10 W 6 ch. 50 to a White Oak 15 1/2 N 20 W 29 Links. Hickory 8 1/2 N 61 E 34 Links, thence N 3 1/2 W 30 ch 7 1/2 to Red Oak 15 1/2 N 7 1/2 E 22. W. O. 12 1/2 N 14 W 15 Links, thence N 86.10 E 6 ch. 30 L to a W. O. 16 1/2 N 56 E 4 Links. Hickory 22 1/2

Oct- 1835

S 71 W 18 L. thence S 3 1/2 E 30.76 to beginning. Containing 90 acres. D. Hopkins S. P. C.