

Bridge No 142-6.65

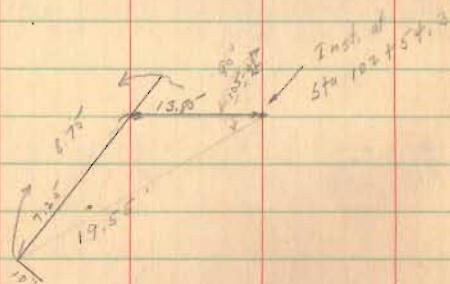

Oct. 11, 1940

E. K. Core

G. W. Wilgus

M. E. Jones

26

R/W Mon. spike Sta 107+00
↓
E/W Mon

slope sta. 103+00
103+00
Dart 102+75
102+75.2 End of Floor



INDEXED ON MAP

4914

102+54.3 - End of floor

slope Sta 102+00

101+09

Drive

100+90

R/W Mon. ↓ R/W Mon

Slope Sta 100+00