

SURVEY OF LOT 121
 DEGRAFF, OHIO
 JULY 11, 1963
 SCALE 1"=30'

DESCRIPTION:

Being the south half of
 lot 121 of Humphreys Add.
 to the Village of DeGraff.

REFERENCE:

HUMPHREYS ADDITION
 PLAT BOOK A
 VOL. 2
 PAGE 84

Dan L. Dodson

Dan L. Dodson
 Registered Surveyor 4270
 Bellefontaine, Ohio

ON PLAT BOOK
 3-21-64
 D.E.G.

IP
 365!

INDEXED ON MAP

S 1/2 Lot 121
DEGRAFF

660
99.2

759.2

.11
2000

9
10

759.25 .00012

19000
7592

14080

.0012 / FT

66.08

66
.0012

132
06

.0792

Fence
X X X
OL

7/11/63

Dadson
Gross

18

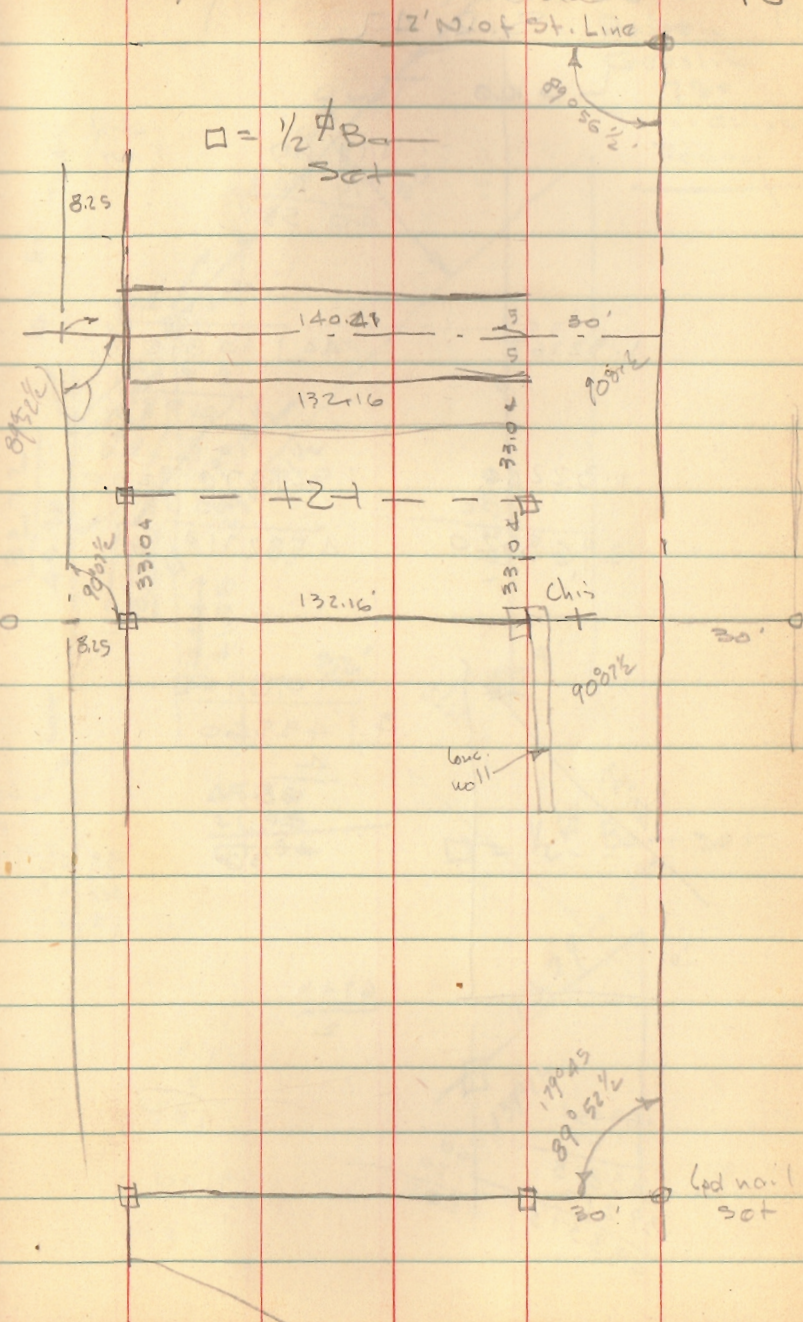

INDEXED ON MAP
3651