

Survey for Jesse E. Murphy et ux Attn De Graff Township 1 Page

Ruben Foulk et ux
to

Vol. 115 Page 333

Sec. 7 T. 2 R. 14

Jesse E. Murphy et ux

Date 1915

Surv. _____

Thence

Begin at the N. W. corner of land now owned by the heirs of Jacob Shawman.

in a westerly direction on the south line of Pleasant St. about 118 feet

to the N. W. corner of land owned by Wm. H. Speer

in a southerly direction about 174 feet to the N. W. corner of L. A. Askegast land.

in an easterly direction about 100 feet

in a northerly direction about 135 feet to the beginning.

.44 acre

INDEXED ON MAP
6032 10D-1

Survey for Jose & Murphy, De Graff

Township

Page

2

Ruben Houck et ux

to

Vol. 112 Page 550

Sec. 7 T. 2 R. 14

Jose & Murphy et ux

Date 1912

Surv. _____

Thence

Being Pt of Trac. Sec. 7

Begin at the N. W. corner now owned
by Jacob Shawver heirs.

in a westerly direction on said
line of land owned by Murphy Mrs.
87 feet to a stake in said line.

in a southerly direction 194 feet
until it strikes the north line of
lot owned by Mrs. Creamer ^{lot} to a stake
in said line.

along said Mrs. Creamer lot (North line)
East and along North line of lot
owned by Watson Heirs East until
it strikes Shawver heirs west

INDEXED ON MAP

6032 100-2

west line 91 feet to a stake ^{to the place} whence
it strikes said Shavers line
— along the said Shaver west
line in a northerly direction
148 feet to the corner the place of
beginning containing $\frac{1}{4}$ of an
acre more or less

INDEXED ON MAP
6032 100-3

Survey for Jesse E. Murphy, Deysaff Township Page 3

Isaac L. Norton to Reuben Foulk
Vol. 70 Page 595 Sec. 7 T. 2 R. 14
Date 1887 Surv. _____

Thence

Pt. 4th Sec. 7

Same as Page 2

INDEXED ON MAP
603210D-4

Survey for Jesse Murphy, De Graff Township Page 4

Martina M. Glassford
to

Vol. 76 Page 174

Sec. 7 T. 2 R. 14

Reuben W. French

Date 1890

Surv. _____

Thence

Begin at N.W. corner of lot of land owned
by W. M. Gaylor

— in an easterly direction 54 feet 6 inches
($54\frac{1}{2}$) on N. line of Gaylor to a stake

— northwesterly 194 feet to a point
in Murphy's heirs line to a stake

— N. W. on said Murphy's S. line
until it strikes the N. E. corner
of land owned by Wm. Krissinger
(the corner being in the Murphy
Heirs line)

— southwesterly along the line 225
feet to the corner the place of begin
containing about $\frac{1}{6}$ of an acre
more or less (Over)

INDEXED ON MAP
6032 10D-5

Survey for Jesse Murphy et al, Debraff

Township

Page

5

Jacob Shaver

Vol.

67 Page 325

Sec.

7

T.

2

R.

14

to
Isaac L. Norton

Date

1884

Surv.

Thence

Begin at the N. W. corner of lot of land owned by F. M. Galer

- in an easterly direction 39 feet (39) on the north line of Galer to a stake

- N. westerly 201 feet (201) to a point in Murphys heirs South line

- N. W. on said Murphys South line 39 feet to the northeast corner of land owned by Wm. Krisinger

- S. easterly 225 feet to beginning containing $\frac{1}{6}$ of an acre more or less also following Pt Trac. Sec. 7

Begin at the N. W. corner of lot once owned by Geo. Wolfe

INDEXED ON MAP

6032.107-6

- Thence in a westerly direction on S. line of lands owned by Murphys Heirs 197 feet to a stake in said line
- in a southerly direction 202 feet until it strikes the north line of Ft. M. Galers lot to a stake in said line.
- along said Galers north line east and along said Smiths N. line east until it strikes Geo. Wolfs west line 106 feet to a stake at the point where it strikes said Geo. Wolfs line
- along said Geo. Wolfs west line in a northerly direction 147 feet to the corner place of beginning containing about $\frac{1}{4}$ acre more or less

INDEXED ON MAP
603210D-37

Jacob Shaver
to
Isaac L. Norton

Vol. 67 Page 325 Sec. 7 T. I R. 14

Date 1884 Surv. _____

Thence Same description as Page 5

Alex. Ruble }
to } vol. 66
Jacob Shaver } P 456 1884

Same as Page 5

Jacob Shaver } vol. 62 $\frac{1}{6}$ acre
to } P. 384

Alex Ruble }

Isaac L. Norton } vol 62
to } Page 383 $\frac{1}{4}$ acre

Alex Ruble }

These two same as Page 5

Emily A. Norton } vol 61
to } Page 423 $\frac{1}{4}$ acre

Isaac L. Norton } Same as above

INDEXED ON MAP
603210DB

59 230

Survey for

DeGraff

Township

Page

7

Abraham R. Walker

to

Vol. 59 Page 230

Sec. 7 T. 2 R. 14

Emily A. Norton

Date 1879

Surv.

Thence

Begin at N. W. corner of lot owned by
Geo. Wolfe— west on south line of Murphys heirs
159 feet to corner of lot of land owned by
Wm. Kinsinger— South 288 feet on Kinsingers line to N. side
of Joseph H. Ganniss lot of land
R. E. 34 feet.— S. on Ganniss line to alley north of
Sam'l Princes land 105 feet— N. E. with said alley 111 feet to
Geo. Wolfe's west line— N. with Wolfe's west line 314 feet
to begin containing $1\frac{1}{6}$ acresINDEXED ON MAP
403210D9

Survey for

Detsraff

Township

Page

8

Emily Norton

to

Sam'l Smith

Vol. 59 Page 606

Sec. 7 T. 2 R. 14

Date 1880

Surv.

Thence

Begin at S.E. corner of a lot a piece of land now owned by F. M. Isaler (that said Isaler bought of said Norton) Running thence in an easterly direction $32\frac{1}{2}$ feet to a stake.

— in a northerly direction and parallel with said F. M. Isalers east line 149 feet to a stake

— in a westerly direction and parallel with the first or south line $32\frac{1}{2}$ feet to a stake the north east corner of said F. M. Isalers lot

— in a southerly direction and

INDEXED ON MAP
6032 105-10

along the east line of said
Galters lot 149 feet to the
beginning

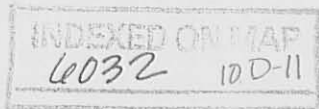

Survey for

DeGraff Township

Page

9

Emily A. Norton

to

H. M. Galer

Vol. 60 Page 481

Sec. 7

T. 2

R. 14

Date 1879

Surv.

Thence

Begin at the S. E. Corner of lot of land
owned by Joseph H. Cavin

E. 74 feet.

N. 168 feet

W. 108

S 64 feet

E 34 feet

S 104 feet to beginning

$\frac{3}{8}$ acre more or less

INDEXED ON MAP

6032-10D-12

Survey for

DeGraff

Township

Page

10

Emily Norton

to

Vol. 61 Page 423

Sec. 5 T. 2 R. 14

Isaac L. Norton

Date May 1881

Surv.

Thence

Begin at N. W. $\frac{1}{4}$ of lot owned by Geo. Wolfe
in a westerly direction on S. line
of lands of Murfley bears 117 feet
to a stake in said line.

- in a southerly direction 202 feet
until it strikes the north line
of F. M. Galers lot to a stake in
said line.

- along said F. M. Galers north line
east and along Sam'l Smith's
north line east until it strikes
Geo. Wolfes west line 106 feet to a
stake at the point where it strikes
said Geo. Wolfes line

403210D-13

- along the said Geo. Wolfes west line in
a northerly direction 147 feet to the
corner, the beginning
containing about $\frac{1}{4}$ acre more
or less

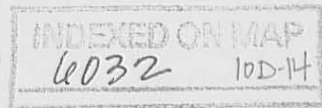

Survey for

DeGraff

Township

Page

10 1/2

Isaac L. Norton

to

Vol.

61

Page

425

Sec.

7

T.

2

R.

14

Emily A. Norton

Date

May 26 1881

Surv.

Thence

Beginning at the N. W. corner of a lot of land owned by F. M. Galer

- easterly 39 feet on the north line of Galer to a stake

- N. westerly 201 feet to a point in Murphys heirs south line

- N. W. on said Murphys south line 39 feet to the N. E. corner of land owned by Wm. Kinsinger

- S. easterly 225 feet to place of beginning containing 1/6 acre more or less

INDEXED ON MAP

6032 10D-15

Survey for

De Graff

Township

Page

11

A. R. Walber

to

Wm Kuevinger

Vol. 57

Page

95

Sec. 7

T. 2

R. 14

Date

1878

Surv.

Thence

Begin 66 feet N. W. of N. E. corner of Humphreys
Addition

with the N. W. side of Kabe St. thence
N 28° 50' W. 50⁰⁵ ch. to N. E. L Islehurst
lot No. 8

with said west line N. 8 W. 222
feet along Humphreys S. line more or
less

S 28° 50' W. 213¹/₂ ft to corner 66 ft.

N. W. of corner N. E. of Humphreys Add.

S. 61° 10' W. to begin N. W. side Kabe St.

INDEXED ON MAP

6032 10D-10

Survey for

Selgraff

Township

Page

12

A. R. Walker

to

Wm. Kussinger

Vol. 64 Page 585

Sec. 7 T. 2 R. 14

Date 1883

Surv.

Thence

Correction Deed.

Begin at in the E. line of lot 7 (1.889)
of Gilchrist's Add. see Vol 35 P 300

and 66 feet from the S. E. corner of said
lot and 66 feet north of the north line
of Humphreys Add.

— with the east line of Lot 7 and 8 of
Humphreys Add. N. $28^{\circ} 50'$ W. 340 feet
or (5.15 ch) to the N. E. cor. of lot 8

— with the N. line of land as originally
purchased by said Walker S. $88^{\circ} 40'$ E
222 $\frac{1}{2}$ ft. to a point 192 feet at rt angles
from the east line of said lot 8

— parallel with the first line S $28^{\circ} 50'$ E

 INDEXED ON MAP
6032 100-17

213½ ft to a point 66 feet north of the
north line of said H — add. if
extended East

— S 61° 10' W 192 feet to begin.
1.22 acre.

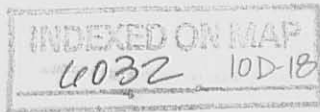

Survey for

Deerhoff

Township

Page

13

Wm. Kinsinger et al

to

Vol. 93 Page 400

Sec. 7 T. 2 R. 14

Wm. B. Kinsinger

Date 1900

Surv.

Thence

Same Descript. as P. 12

Except following:

Except that part that was condemned
by village for street

INDEXED ON MAP

6032 10D-19

Survey for _____

_____ Township

Page

14

Wm. B. Kinsinger
to
Ellen B. Morgan

Vol. 95 Page 364

Sec. 7 T. 2 R. 14

Date 1901

Surv. _____

Thence

Same as Page 13

Jacob F. Morgan et al
to
Lewis Burk

105-146

1907

Same as Page 13

INDEXED ON MAP
6032-100-20

Survey for _____

_____ Township

Page

to _____

Vol. _____ Page _____

Sec. _____ T. _____ R. _____

Date _____

Surv. _____

Thence

Grantor	Grantee	Vol	P.	Date	
✓ Reuben W Foulkety	Lewis Burk	104	620	1906	S.W.
John T. Burke et al	Mary E. Burk	110	557	1911	Q.C.
✓ Mary E. Burk	John H. West et al	111	314	1911	S.W.
✓ John H. West et ux	John H. Speer et al	114	138	1913	S.W.

Street

87

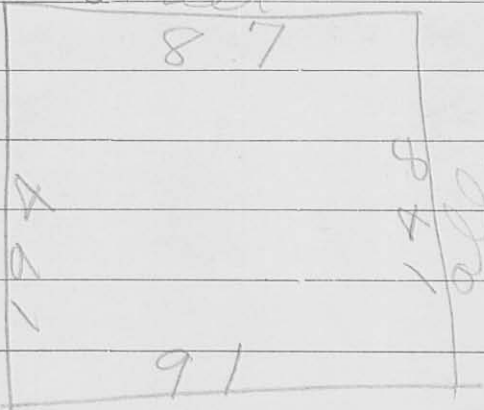

INDEXED ON MAP

6032 100-21

DELONG SURVEY
DEGRAFF, OHIO

48' width fits occupation OK

NOTE Statement in Deed 324 pg 141
intended width to be 40'

2.00 N
1.95 S.

D-K @ 647.90'

OUTLOT LINE @ 584.0

647.9	52
584.0	60
63.9	112
	63.9
	48.1

INDEXED ON MAP
6032

Dolson
Artis

4/27/71 74
60°

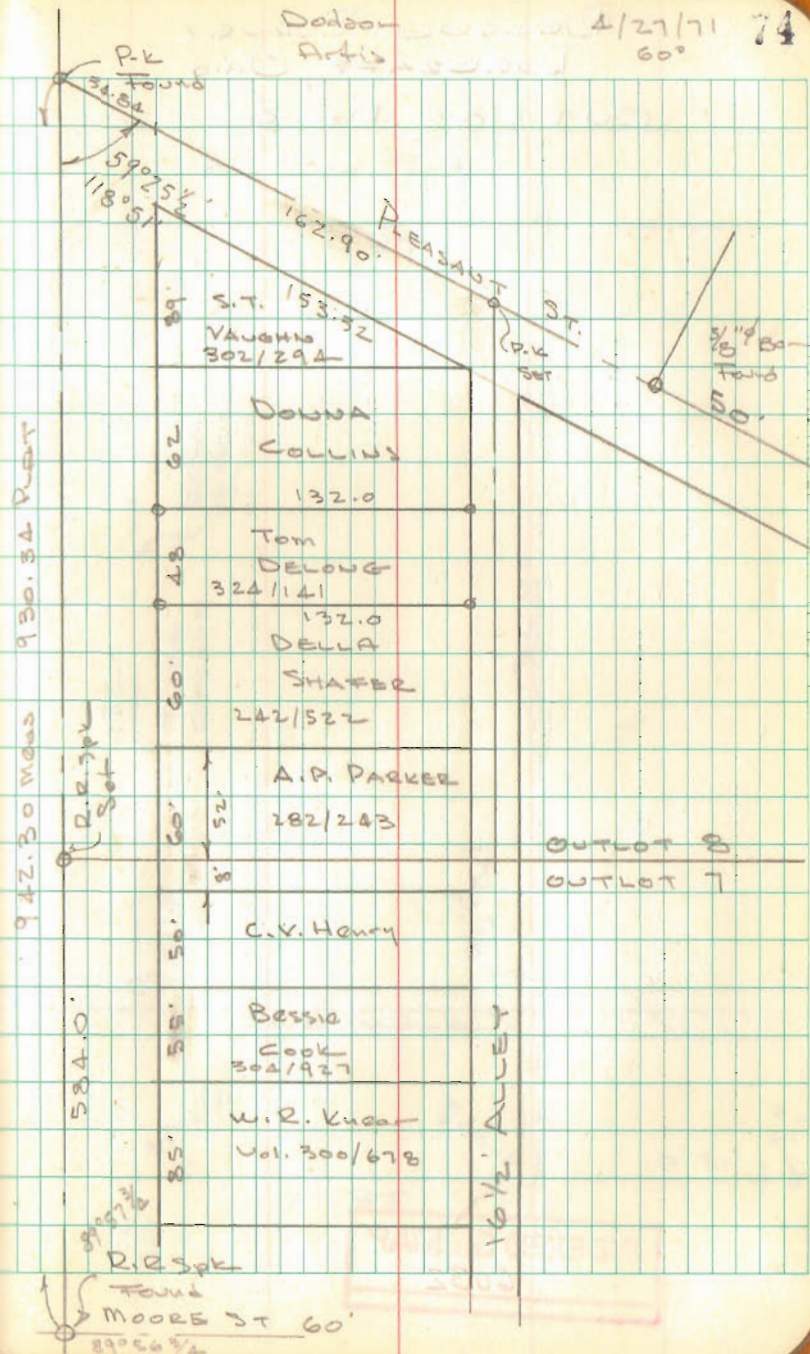

DELONG SURVEY
 DEGRAFF, OHIO
 OUT LOT No. 8

INDEXED ON MAP
 6032

4/27/71

75

