

Lurvey or
549

8513

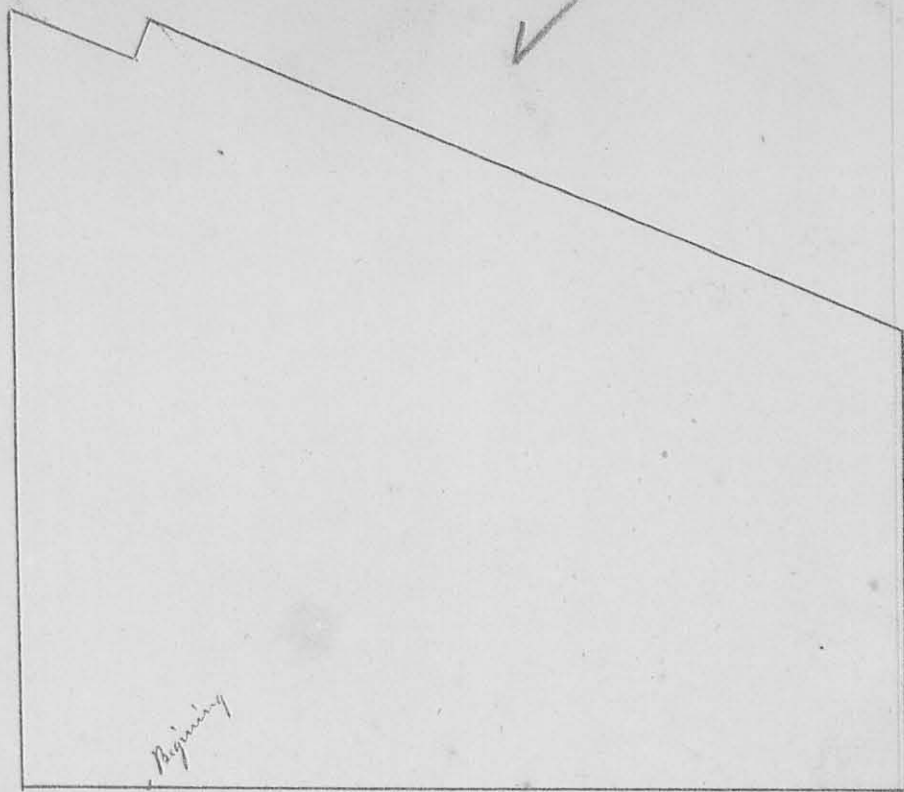

Surveyed November 10th 1845 for Georg Seaman the following lot of land being part of sections 7, town 2, Range 15 Mrs, & Section 8 Beginning at the South West Corner of Section Seven & run East 161.6 poles to a stone then North 96 poles to a stake in the North Side of the Lewis Town road then with the North Side of said road N 66 1/2 W 170 poles to a stone S 32 1/2 E 82 links from Joseph Yaurines Barn then S 21 W 8.8 poles to a stone then N 66 1/2 W 29.4 poles to a stake in Spring Branch then South 153.5 poles to a stake (white oak 20 1/2, S 28 W 27 links & white oak 18 1/2 N 35 E 18 links) then East 26 poles to the Beginning containing 155 Acres
 A. Harrison
 C. L. Geo. O