

Hare - Furlong Survey Jefferson Township Feb. 1963 0.12 Acre

The following described land in Jefferson Township, Logan County, Ohio and being in V.M.S. 842

Beginning at a point in the east line of V.M.S. 3325 in the center of County Road Number 127 and also in the center of County Road Number 129 said point being the S.W. corner of V.M.S. 842. Thence with the west side of V.M.S. 842 and with the center line of County Road Number 127 N. 5 - 34 W. 719.40 feet for the true beginning point of this survey. The last described line passing an iron over a stone at an angle in said Road Number 127 at 674.00 feet.

Thence again with the west side of V.M.S. 842 and with the east side of Richard Furlong's 10.70 acre tract N. 5 - 34 W. 317.60 feet to a post.

Thence N. 84 - 26 E. 16.50 feet to a point in the west side of Frank Armstrong's 25.00 acre tract.

Thence with the west side of said Armstrong 25.00 acre tract S. 5 - 34 E. 317.60 feet.

Thence S. 84 - 26 W. 16.50 feet to the place of beginning.

The above described contains 0.12 of one acre. The 0.12 of one acre being the south part of a 0.22 of one acre now in the name of Ralph Powell.

cc  
Logan County Engineer



3527 1D-1

INDEXED ON MAP

Hare - Madriver Girl Scouts Survey Feb. 1963 Jefferson Township 0.10 Acre

The following described land in Jefferson Township, Logan County, Ohio and being in V.M.S. 842

Beginning at a point in the east line of V.M.S. 3325 in the center of county Road Number 127 and also in the center of County Road Number 129 said point being the S.W. corner of V.M.S. 842. Thence with the west side of V.M.S. 842 and with the center line of ~~V.M.S.~~ County Road Number 127 N. 5 - 34 W. 1037.00 feet to a post at the N.E. corner of Richard Furlong's 10.70 acre tract. Said post being the true beginning point of this survey. The last described line passing an iron over a stone at an angle in said Road Number 127 at 674.00 feet.

Thence again with the west side of V.M.S. 842 <sup>and</sup> with the east side of Madriver Valley Girl Scouts 36.30 acre tract N. 5 - 34 W. 312.00 feet to a post.

Thence N. 84 - 26 E. 16.50 feet.

Thence S. 5 - 34 E. 312.00 feet.

Thence S. 84 - 26 W. 16.50 feet to the place of beginning.

The above described tract contains 0.10 of one acre <sup>The 0.10 of one acre tract</sup> being the north part of a 0.22 of one acre tract <sup>now in the name of Ralph Powell.</sup>

cc  
Logan County Engineer.



3527 ID-2

HARE - FURLONG

&

HARE - GIRL SCOUTS

SURVEYS

FEBRUARY - 1963

BY F.F. WRIGHT

SCALE 1" = 50'

MADRIVER VALLEY GIRL SCOUT  
COUNCIL, INC.

39.00 Ac.

V.M.S. 3325

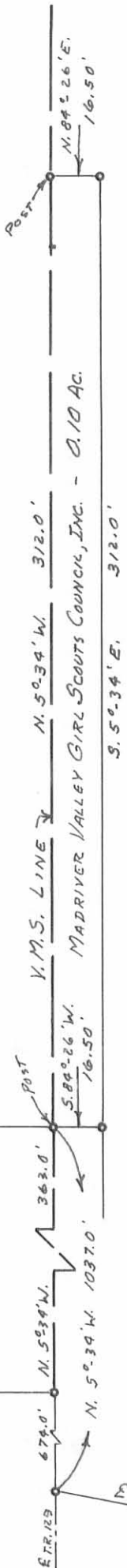

V.M.S. LINE  
MADRIVER VALLEY GIRL SCOUTS COUNCIL, INC. - 0.10 AC.

3.5° 34' E. 312.0'

V.M.S. 842

FRANK ARMSTRONG  
17.70 AC.

RICHARD B. FURLONG  
ETUX  
10.70 Ac.

E.T.R. 127

E.T.R. 127

RICHARD B. FURLONG ETUX  
10.70 AC.

V.M.S. 3325

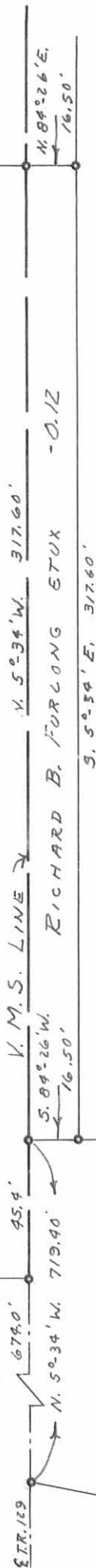

V.M.S. LINE  
RICHARD B. FURLONG ETUX - 0.12

3.5° 34' E. 317.60'

V.M.S. 842

FRANK ARMSTRONG  
17.70 AC.

BESSIE  
CRONKLETON  
10.76 Ac.

E.T.R. 129

E.T.R. 127

3527 IP

INDEX TO MAP

DRAWN BY D.E.G.