

(120)
Long Alex^r 3
No 147 3

9th mo. (Sept) 8th 1830 Survey No 147
Surveyed 3/4 acres for Alexander Long

(825)

Beginning at a stake and three beeches in the west line of James Calderwood's survey No 3137 N.W. corner to Alexander Long's land as per deed from L. Child-
-liant; thence with the original, and established line of said survey N 15^h E 18.8 poles to a red oak two ironwoods and maple; thence S 74^h E ^{410 poles} with a line run by A. L. Hunt in 1817, crossing Sandusky Street in Zanesfield at 205 poles, Mad river at 286 poles, to a stake in the east line of the original survey and in J. Dickinson's field; thence with said line S 15^h W 8.2 poles to a stake, beech and dogwood N.E. corner to A. Long and S. E. corner to E. Zane thence with the line between said Long and Zane (S 75^h W crossing Mad river and the street in Zanesfield) 410 poles to the beginning containing 3/4 acre part of said survey

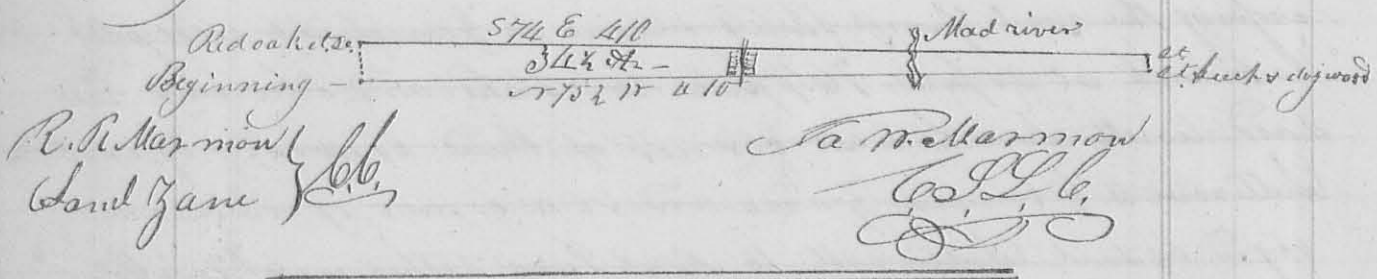

Jane Eleanor 3
No 148 3

9th mo. (Sept) 9th 1830 Survey No 148

(825)

Surveyed 196²/₃ acres for Eleanor Zane
Beginning at a stake, beech and dogwood in the east line of James Calderwood's survey No 3137 N.E. corner to Alex^r Long's land and S.E. corner to E. Zane's. Thence with said line N 15^h E, (crossing the road from Zanesfield to Gor-
-woods mill at 60 poles, 76.7 poles to a beech on the bank of a steep hollow thence N 75^h W, crossing Mad river at 120 poles, the road from Zanesfield to Sandusky at 218 poles,) 410 poles to a beech
Small hickory and elm & 3 beeches
196²/₃ ac.
Beech
Beginning

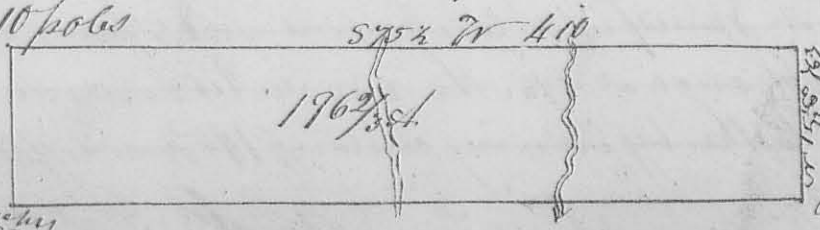

in the east line of the original survey, the N.W. corner to
 Eb. Zane's and S.W. corner to Isaac Zane's land; - thence
 with said line S 15 1/2 W 76.7 poles to 2 beeches N.W. corner to
 Alex. Long's land; - thence with the line between S. Long
 and E. Zane S 75 1/2 E 410 poles (crossing Sandusky Street in
 Zanesfield at 205 poles, Mad river at 286 poles) to beginning
 containing 196 2/3 acres part of Calderwood's said Survey
 no 3137

R. A. Marmou }
 David Marmou } 66

Ja. W. Marmou
 C. S. L. C.

Jane Elizabeth Zane }
 no 149 }
 9th mo, Sept, 9th 1830

Survey no 149

Surveyed 38 acres for Ebenezer Zane

(8250)

Beginning at a large beech small buckeye and elm in the
 west line of James Calderwood's Survey no 3137. N.W. corner to E.
 Zane's land South West corner to Isaac Zane's land thence with said
 line N 15 1/2 E 18.8 poles to a stake 2 beeches and three sugar trees; thence
 with an old line run by A. L. Hunt S 71 1/2 E 257 poles (crossing the road
 from Zanesfield to Sandusky) to a stake in John Bishop's orchard;
 thence S 65 E 26 poles to a stone corner to Bishop, thence with Bishop
 - op's line ~~S 74 E~~ N 15 1/2 E 44 poles to a stone; thence S 74 E 14.7 poles (cross-
 - ing Mad river) to a beech in the east line of the original survey,
 thence with said line S 15 1/2 W 11 poles to a stone and beech on
 the south side of a steep hollow; thence N 75 1/2 W, crossing Mad
 river at 120 poles, the Sandusky road at 218 poles, 410 poles to the
 beginning

being a beginning
 part of Calderwood's



- derwood's said survey

David Antium }
 R. A. Marmou } 66

Ja. W. Marmou
 C. S. L. C.

Isaac Zane }
 no 151 }
 9th mo, Sept, 9th 1830

Survey no 151

(8150)

Surveyed 196 2/3 acres for Isaac Zane

Beginning at a stone and beech on the north declivity of
 a steep bank in the east line of James Calderwood's sur-
 - vey no 3137 N.E. corner to E. Zane's land, thence with his
 north

(122)

north $\approx 75^{\circ}$ in ≈ 410 poles crossing crossing Mad River at 120 poles the Sandusky road at 218 poles to a large buck elm and Sugar tree in the west line of the original survey thence with said line $\approx 15^{\circ}$ ≈ 76.7 poles to a stake ≈ 11 corner to Isaac Zanc's land as per deed from L. Sullivan

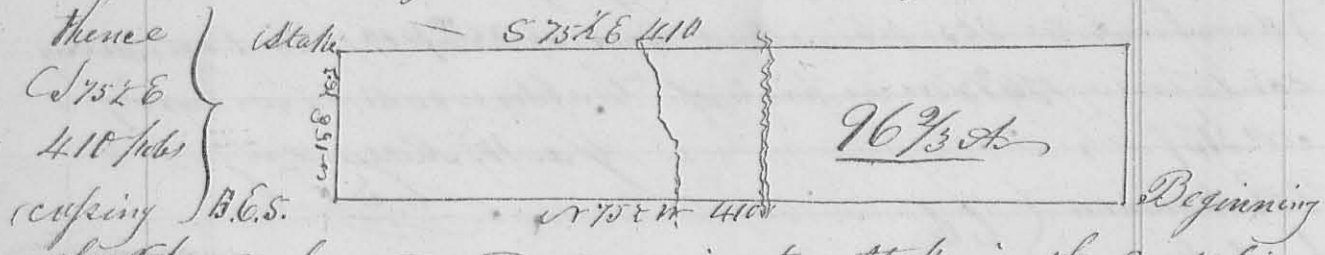

thence with said line $\approx 15^{\circ}$ ≈ 76.7 poles to the beginning it being part of Ja. Calderwood's said survey

Ja. M. Harmon
 Robert Harmon }
 Ja. M. Harmon }
 C. L. C.

Lynne Starling 9th Mo. 21st 1830.
 No 151

Survey No 151

Survey 160 acres for Lynne Starling

Beginning at the ≈ 11 corner of A. J. Smith's survey ≈ 3225 and ≈ 11 corner of Holland Haney's survey ≈ 3224 the corner trees all being down I set a stake thence with the west line of Haney's survey $\approx 21^{\circ}$ $\approx 112^{\circ}$ variation west therefrom, crossing a branch at 34 poles, 160 poles to 4 dogwoods on the north declivity of a knob - thence $\approx 16^{\circ}$ ≈ 160 poles, crossing a branch at 136 poles, again at 139, again at 141 poles to 2 small elms and lynn; thence $\approx 21^{\circ}$ ≈ 160 poles, crossed the dry channel of a branch at 36, 40, & 44 poles, 160 poles to small Hickory, ash, dogwood, and lynn in the south line of the original survey - thence with said $\approx 16^{\circ}$ ≈ 160 poles to the beginning, being in the south west corner of H. Haney's said survey

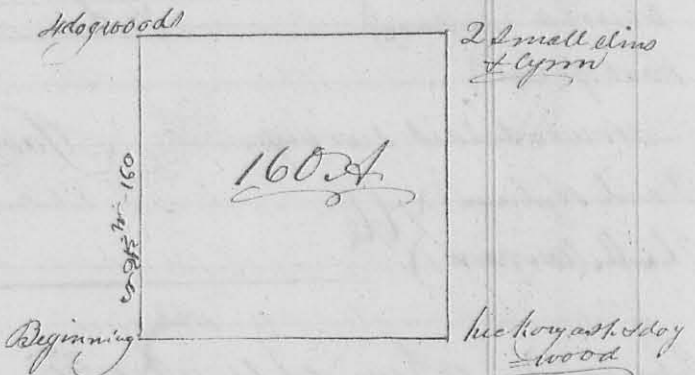

Henry M. Harmon }
 Robert M. Harmon }
 Ja. M. Harmon }
 C. L. C.