

Sept-22-1943

Dailey
Dyert
Burket
Knief

Conc. Pavement

Drilled 3/4" hole -
Countersunk brass marker in
conc. pavement - cemented - 1/4" below
surface

This Mon Removed by City when
they placed storm sewer on
E. of Lake Ave.

(S-34)
1/4 S-34
S-33

Silver Lake Pile at NYC-RR

22

N

SEC. 34-4-14

SE < NW Q

SE-Q

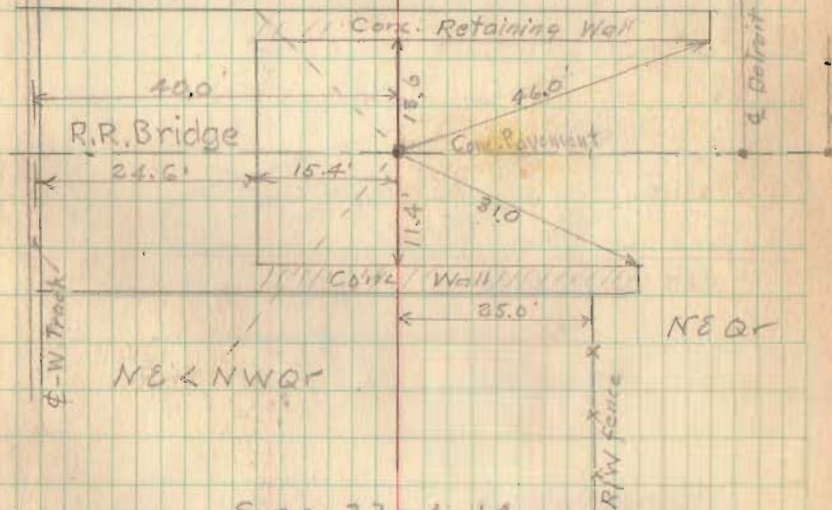

SEC. 33-4-14

2636

INDEXED ON MAP