

South 35 links, a hickory S 62 E 18 links, to the west line of the sea, a white oak S 78 E 26 links, a hickory S 35 E 19 links. — For Ct. Howell Beginning at a stake and chestnut sprout S 77 W 17 1/2 links, in the west line of the c. r. w. gr. 81 poles from the ~~SW~~ corner thereof thence east 161 poles to a white oak S 72 E 56 links, a white oak S 79 W 76 links in the center line, dividing said quarter into two equal parts

George Linkwater }
Henry Sherist } J. W. Morrison Jr.

4th Mo, April 25th 1827 ✓ Survey No 75 (8204)

Surveyed and divided 350 acres of land for John Smith as follows: Beginning at 2 ironwoods, south west corner to Henry King's land thence with the south line thereof S 80 E 17 1/2 poles to 2 sugar trees and dogwood.

thence N 10 E (cropping a branch) 182 poles to 2 small hickories and ash in the south line of Layton Gancy's survey No 3322 — thence with said line S 80 W, passing 2 beech and elm at 17 1/2 poles, 14 3/4 poles

to a elm and fallen white ash south west corner to Gancy's said survey (here I marked a sugar tree and black ash and ironwood. thence with the west line of the original survey N 10 W, cropping a branch at 96 poles, another at 144 poles, 416 poles to 2 ashes and an elm north west corner to the original survey; one of the ashes being broken off, I marked a small elm thence S 80 E with the original line, cropping a branch at 30 poles, one at 96 poles 126 poles to a lynn elm and beech, c. r. w. corner to Henry King's land — thence with

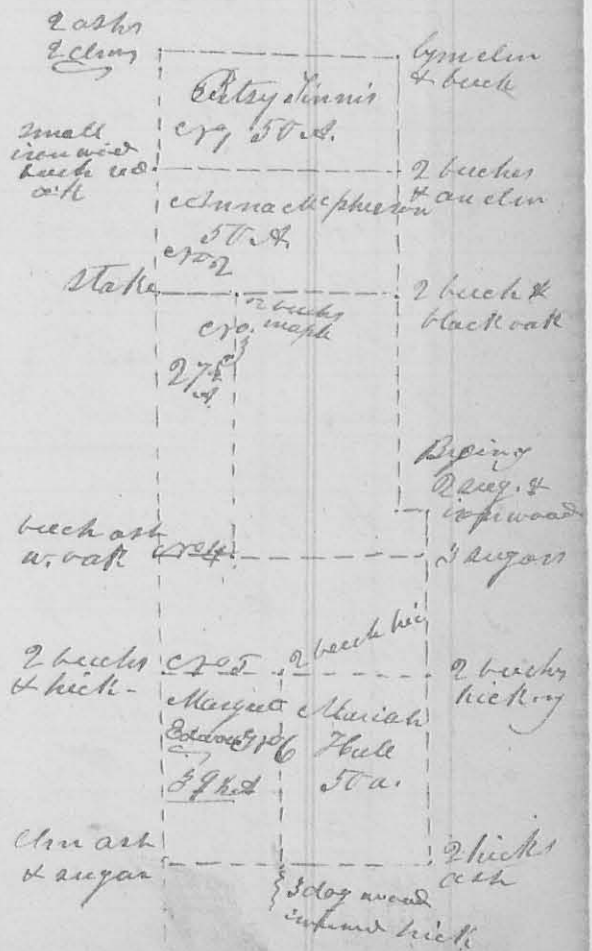

thence with

the west line of King's land S.W. corner, cuping a bunch at 42 poles 134 poles to the beginning containing 350 acres off the west end of Layton Young's Survey
 cr^o 1 32 22 → The division lines are, cr^o 1. Beginning at a small ironwood, beech, red oak and bur oak in the west line of the original survey. — thence cr^o 2 80 6 126 poles, to 2 beeches and an elm in the east line of this survey. — cr^o 3. Begins at 2 beeches and black oak in the east named line 63 poles from the best named corner. thence S 80 W 126 poles to a stake in the west line of the old survey. — cr^o 4 begins at 2 beeches maple and dogwood in line cr^o 3. 80 poles from the east end thereof. thence S 100 E 100 poles to a lym ash and beech. — cr^o 5 begins at a beech red oak and white oak in the line of the original survey thence N 80 E 140 1/2 poles to 3 sugar trees in the east line of this survey. — cr^o 6 begins at 2 beeches and hickory in the west line of the old survey and 60 poles south of the beginning of cr^o 4. thence cr^o 7 140 1/2 poles to 2 beeches and hickory in the east line of this survey. — cr^o 8 begins at 2 beeches and hickory in cr^o 5 45 1/2 poles east of the beginning thereof. — thence S 100 E 100 poles to three dogwoods ironwood, and hickory in the south line of the original survey — See the plot

John Vance }
 Daniel Hall } Co. La. Wellerman G.P.

8109

11th May April, 26 1827. Survey No. 76
 Surveyed 100 acres of land for Eliakin Dugg

Beginning at 2 ironwoods south west corner to Henry King's land and easterly corner to Abel Smith's land. — thence cr^o 1 80 6 76 poles to a sugar tree ironwood and beech — thence cr^o 2 110 cuping a bunch at 94 poles 211 poles to 2 ironwoods dogwood and hickory —

2 iron woods beech	33 22	2 iron woods dogwood
	100.0	
Beginning 2 ironwoods		dogwood

60 Thence S 81° W 76 poles to 2 iron woods and beech
 on the east bank of a branch, and in the east line
 of Joel Smith's land: Thence with said line
 S 10° E (crossing crossing a branch) 211 poles to the
 beginning containing one hundred acres, part
 of Layton Yancy's Survey no. 3322
 John Bame }
 Daniel Hall } C. C.

J. M. Harmon C. C.

4th Mo. April, 28th 1827 ✓ Survey no 77 (8205)
 Surveyed 7 1/2 acres of land for James Stanley and
 Nicholas Williams, beginning at an ash and sugar tree
 a corner in the road leading from Goshen to the
 head of King's creek, and in the north line of
 Augustine J. Smith Survey no. 3926 - Thence S 19° W
 with said road 12 poles to a stake; thence S 37° W 53
 poles to 3 small iron woods in a line between Nich-
 olas Williams and George Green - thence E 22° W with
 said line 36 poles to a sugar tree
 in the original line -
 thence with said line
 E 69° E 52 3/4 poles to the
 beginning containing
 seven and one fourth
 acres, part of Augustine
 J. Smith's Survey no. 3926
 David Norton }
 Micajah Williams } C. C.

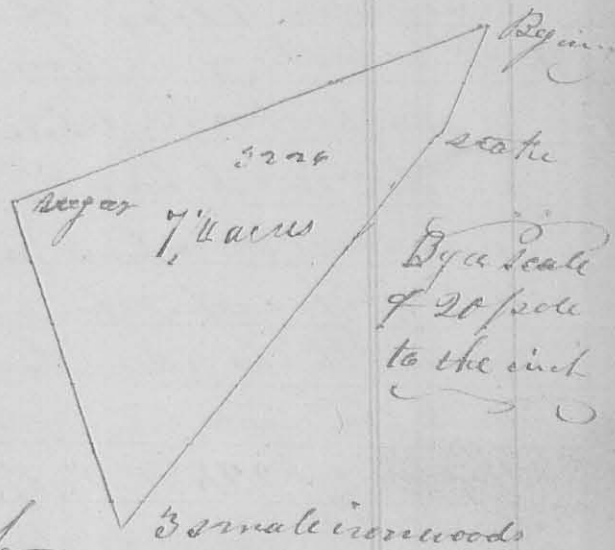

4th Mo. (April) 28th 1827 ✓ Survey no 78 (8205)
 Surveyed 60 acres of land for Charles Hunt, beginning
 at a white walnut elm and sycamore, north east cor-
 -ner to Augustine J. Smith's Survey no. 3926. Thence
 N 68° W with the north line of said survey, 41 poles to
 2 small iron woods and 2 beeches. Thence S 22° E 242
 poles to the centre of the channel of Mackhachac, 2 elms