

Survey 468 Surveyed for James Meedy November 18th 1839 as follows part of military survey No 3442, Beginning at A. Red oak and cherry cherry dead thence N 80° E 80 pole to 2 Sassafras and 1 White oak grubbed all down the stumps standing thence South 12° E 216 pole to three lines 2 down 1 standing corner to Williams Marquis and

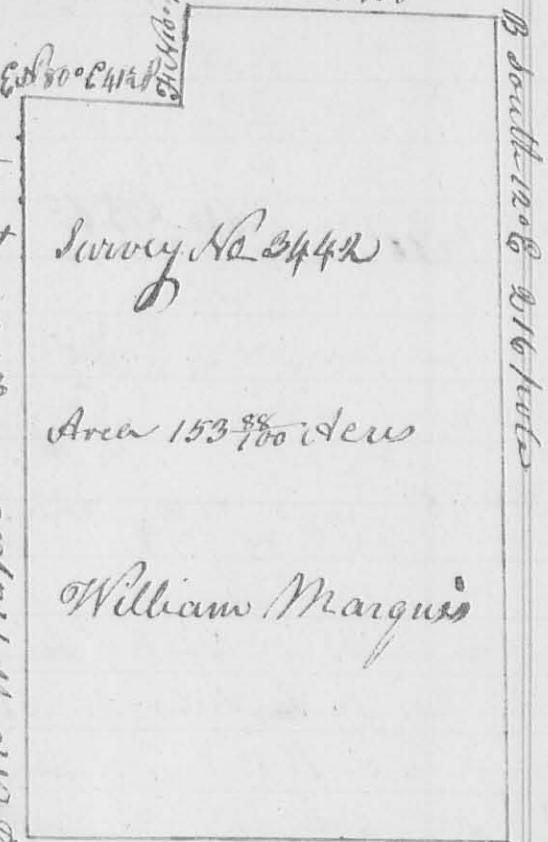

Steven Lease, thence S 78° West 124 pole to a stake, thence N 10° West 194 pole to a stake, thence North 80° East 4 1/2 pole to a stake, thence North 10° West 26 1/2 pole to the beginning containing 153 7/80 acres

L. W. P. Kin. S. L. C. John Abel, Deputy

Survey 469 Surveyed November the 13th 1839 for Daniel Wany as follows, the East line of military survey Number as follows first 5870 for 200 acres and part of eight other warrants making the ^{in all} of 1093 Acres patented to Walter Sum, Survey bearing date January 8th 1821. Bounded on the West by Roberts line on the South by the Greenville treaty line,

Beginning at 2 White oaks and two Red oaks 1 down in the Greenville treaty line and South East corner to said survey thence N 11° 40' W 509 pole to a Burk oak and small Elm down North East corner to said survey

L. W. P. Kin. S. L. C.

John Abel Deputy