

TRACT 6

The following described real estate situated in Monroe Township, Logan County, Ohio, and being a part of a 10.2 acre tract in the West 1/2, Section 23, Town 5, Range 13, B.T.M.R.S.; and more particularly described as follows:

Beginning, for reference, at an iron pin in the center of Logan County Highway No.5 and in the West line of Section 23, Town 5, Range 13, B.T.M.R.S.; thence with the centerline of County Highway No.5 North 65° East 691.05 feet to an iron pin and the principal place of beginning of the tract hereinafter described; thence North 6° 07' East 263.89 feet to an iron pin in the South line of Chris Rotroff's 122.84 acre tract; thence with Rotroff's South line South 84° 52' East 226.36 feet to an iron pin in the corner of Rotroff's property; thence with Rotroff's West line South 1° 34' West 125.61 feet to an iron pin in the center of County Highway No. 5, said pin being Sta. 113+92.6 as shown in Logan County Engineer's field book 509, page 59; thence with the centerline of said County Highway No.5, South 65° West 276.00 feet to the principal place of beginning, containing 1.04 acres, more or less, but subject to all legal highways.

Last Deed Reference Vol. 323, page 968.

Survey and description by

Benjamin H. Cartwright, P.S.
Registration Number 5456.

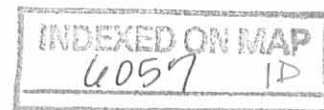

Chris Retroff



Survey and plat by: Benjamin H. Cartwright P.S.
Registration #5456

⊕ Denotes Iron Pin
Scale 1" = 50'

Survey for: Donald Powell

Being a part of the N.W. Quarter
Sec. 23, T. 5, R. 13; B.T.M.R.S.,
Monroe Twp., Logan Co., Ohio

Survey completed 5-23-69 BHC

TRACT 4

The following described real estate situated in Monroe Township, Logan County, Ohio, and being a part of a 10.2 acre tract in the West 1/2, Section 23, Town 5, Range 13, M.T.M.R.S.; and more particularly described as follows:

Beginning, for reference, at an iron pin in the center of Logan County Highway No.5 and in the West line of Section 23, Town 5, Range 13, B.T.M.R.S.; thence with the centerline of County Highway No. 5, North 65° East 223.83 feet to an iron pin and the principal place of beginning of the tract, hereinafter described; thence North 6° 07' East 498.49 feet to an iron pin in the South line of Chris Rotroff's 122.84 acre tract; thence with Rotroff's South line South 84° 52' East 200.03 feet to an iron pin; thence South 6° 07' West 381.19 feet to an iron pin in the center of County Highway No.5; thence with the centerline of said County Highway No.5 South 65° West 233.61 feet to the principal place of beginning, containing 2.06 acres, more or less, but subject to all legal highways.

Last Deed Reference: Vol. 323. page 968.

Survey and description by

Benjamin H. Cartwright, P.S.
Registration Number 5456.

INDEXED ON MAP

6057 2D

Chris Rotroff

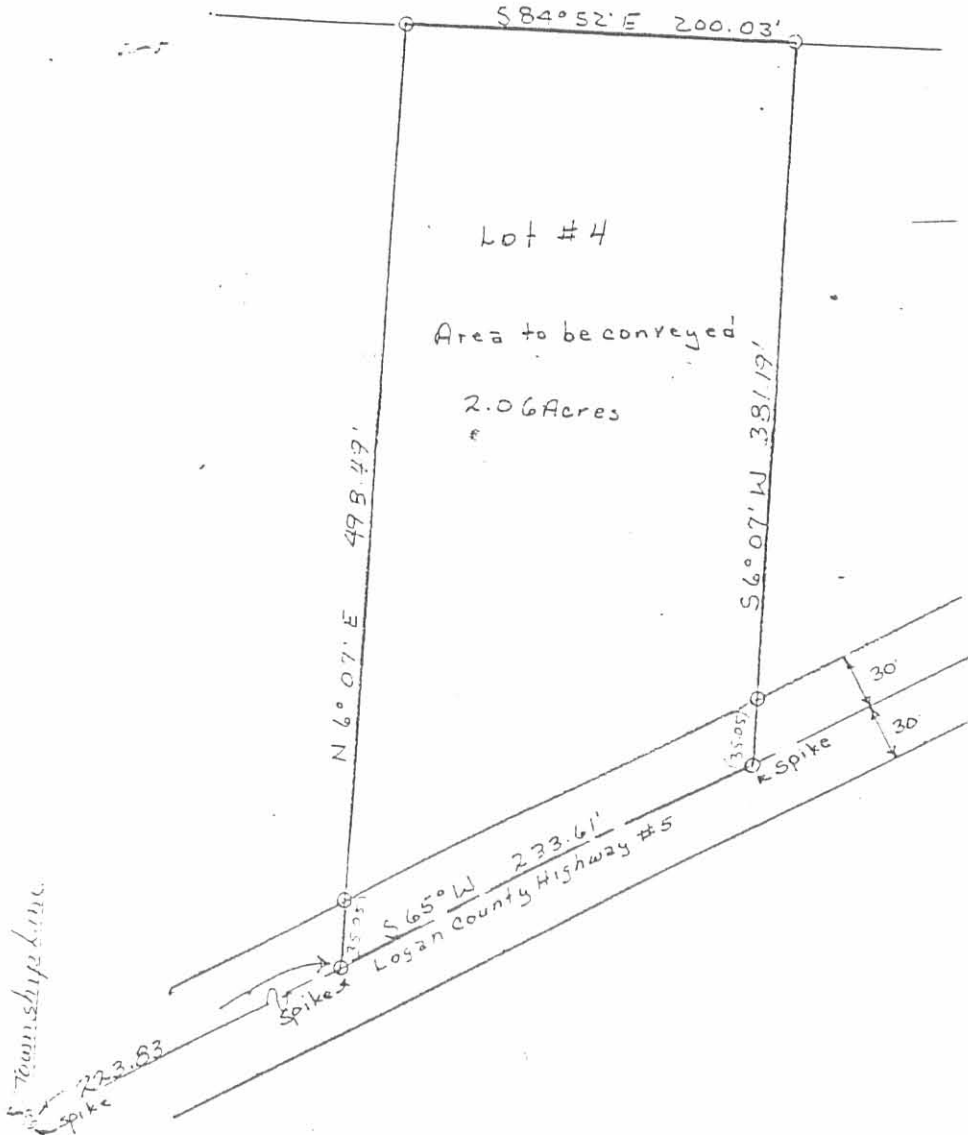
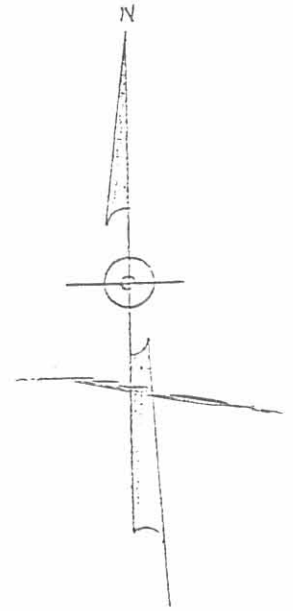

Lot #4

Area to be conveyed
2.06 Acres

Survey and plat by: Benjamin H. Cantelero A.P.S.
Registration # 5456

⊙ Denotes Iron pin
Scale 1" = 100'

INDEXED ON MAP
6057 2P

Survey for: <u>Donald Powell</u>
Being a part of the West Half of Sec. 23, T. 5, R. 13, B.T.M.R.S., Monroe Twp., Logan Co., Ohio
Survey completed 5-23-69 BHC.

The following described real estate situated in Monroe Township, Logan County, Ohio and being a part of a 10.2 acre tract in the West Half Section 23, Town 5, Range 13, B.T.M.R.S., and more particularly described as follows:

Beginning at an iron pin in the center of Logan County Highway Number 5 and in the West line of said Section 23, Town 5, Range 13, B.T.M.R.S.; thence with the West line of said Section 23 North $04^{\circ} 31'$ East 269.95 feet to an iron pin in the Half Section line; thence continuing with said West line of said Section 23 North $06^{\circ} 07'$ East 341.00 feet to an iron pin in the Southwest corner of Chris Retroff's 122.84 acre tract; thence with Retroff's South line South $84^{\circ} 52'$ East 200.03 feet to an iron pin; thence parallel with the West line of said Section 23 South $06^{\circ} 07'$ West 498.49 feet to an iron pin in the center of said County Highway Number 5; thence with the centerline of said County Highway Number 5 South $65^{\circ} 00'$ West 223.83 feet to the place of beginning; containing 2.53 acres, more or less, subject to legal highways.

Survey and description by:

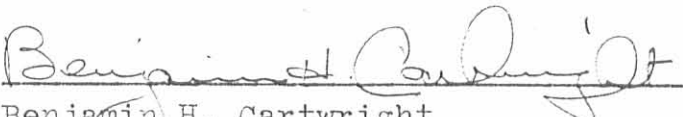
Benjamin H. Cartwright
Registered Surveyor Number 5456
Urbana, Ohio

Description based upon a survey made by me in May 1959

Deed reference: Vol. 323, Page 968

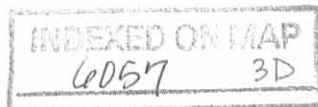

Liberty Twp.

Orin J. Foulk

Chris Rotroff

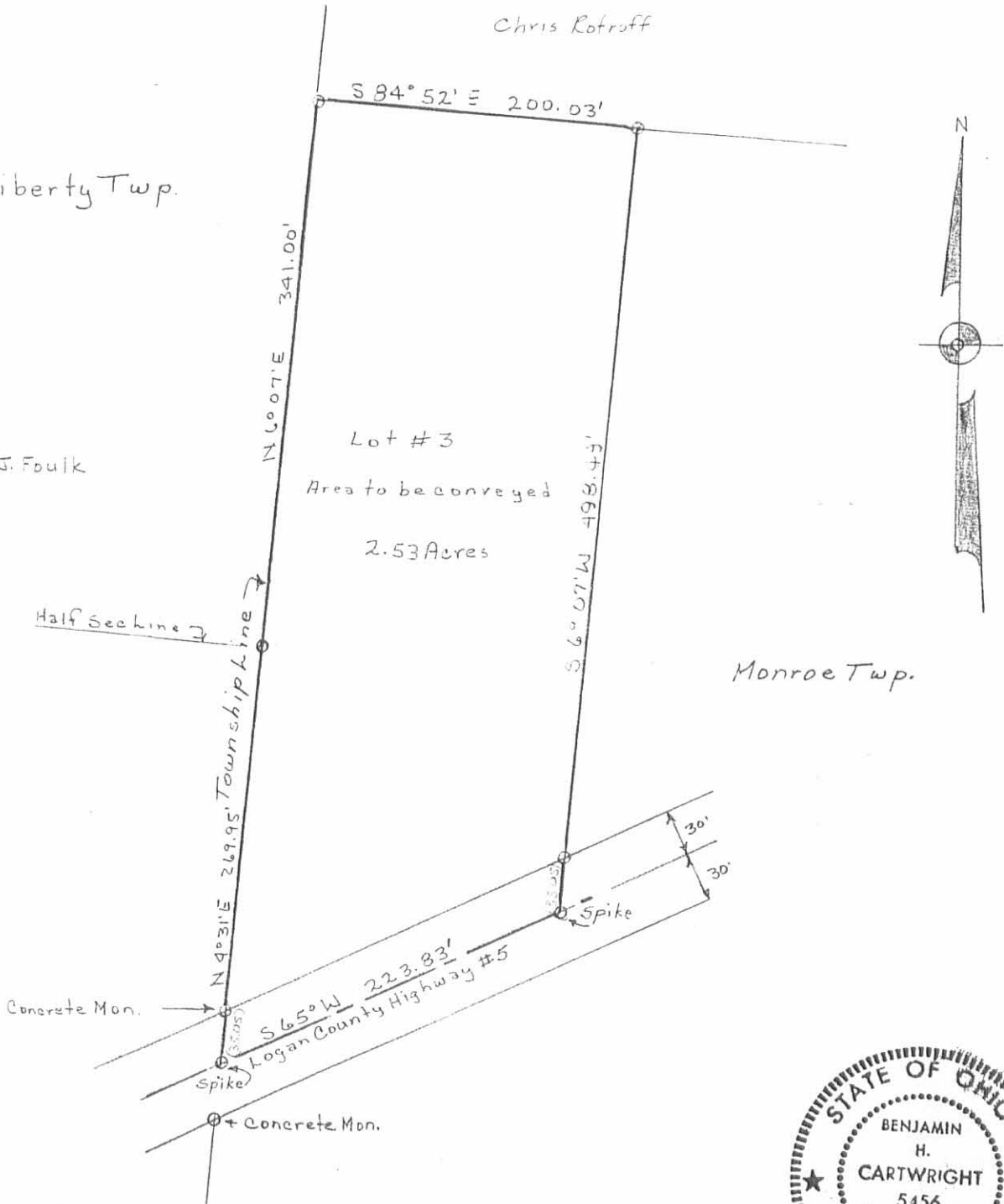

Monroe Twp.

Concrete Mon.

Spike

Spike

Survey and plat by: Benjamin H. Cartwright & P.S.
Registration # 5456



⊕ Denotes Iron Pin
Scale 1" = 100'

6057 3P
INDEXED ON MAP

Survey for: <u>Donald Powell</u>
Being a part of the West Half of Sec. 23, T. 5, R. 13, B.T.M.R.S. Monroe Twp., Logan Co., Ohio
Surveyed 5-23-67 B.H.C.

TRACT I

The following described real estate situated in Liberty Township, Logan County, Ohio, and being a part of a 30.2 acre tract in the Southwest 1/4 Section 29, Town 5, Range 13, B.T.M.R.S., and more particularly described as follows:

Beginning at an iron pin in the center of County Highway No. 5 and in the East line of Orva J. Foulk's 44.50 acre tract, said pin being Sta. 99+77.5 as shown in Logan County Engineer's field book 509, page 50; thence with Foulk's East line North 5° 17' East 581.50 feet to an iron pin at the Northeast corner of said tract and in the North line of the Southeast 1/4 of Section 29, Town 5, Range 13, B.T.M.R.S.; thence with said 1/4 section line South 81° 55' East 158.00 feet to an iron pin; thence parallel with Foulk's East line South 82° 17' East 422.42 feet to an iron pin in the center of said County Highway No. 5; thence with the centerline of said County Highway No. 5, South 59° 01' West 224.60 feet to the place of beginning; containing 1.82 acres more or less, but subject to all legal highways.

Last Deed Reference: Vol. 323, page 968.

Survey and description by

Benjamin H. Cartwright
Benjamin H. Cartwright, J.S.
Registration Number 5456.

6057 AP
4D

Half Sec. Line J
S 84° 55' E 158.00'

Orra J. Foulk

Lot # 1
Area to be
Conveyed
1.82 Acres

N 5° 17' E 591.50'

S 5° 17' W 422.42'

28.35

Township Line

S 65° W

Iron
Bar

Iron Pin

Concrete Post

S 55° 00' W 224.69'
Logan County Highway # 5

Survey and plat by: Benjamin H. Cartwright
Registration # 5456 J

6057 4P

INDEXED ON MAP

Denotes Iron Pin
Scale 1" = 100'

Survey for: Donald Powell

Being a part of the South
1/4 Sec. 29, T. 5, R., 13, B.T.M
Liberty Twp., Logan Co., Oh

Survey completed 5-23-69 B.S.

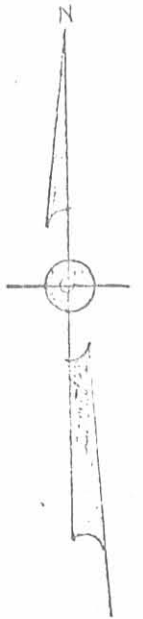

Liberty Twp.
Section 29, Town 5, Range 13
B.T.M.R.S.
Logan County, Ohio

N.E. 1/4

S.E. 1/4

Orva J. Foulk

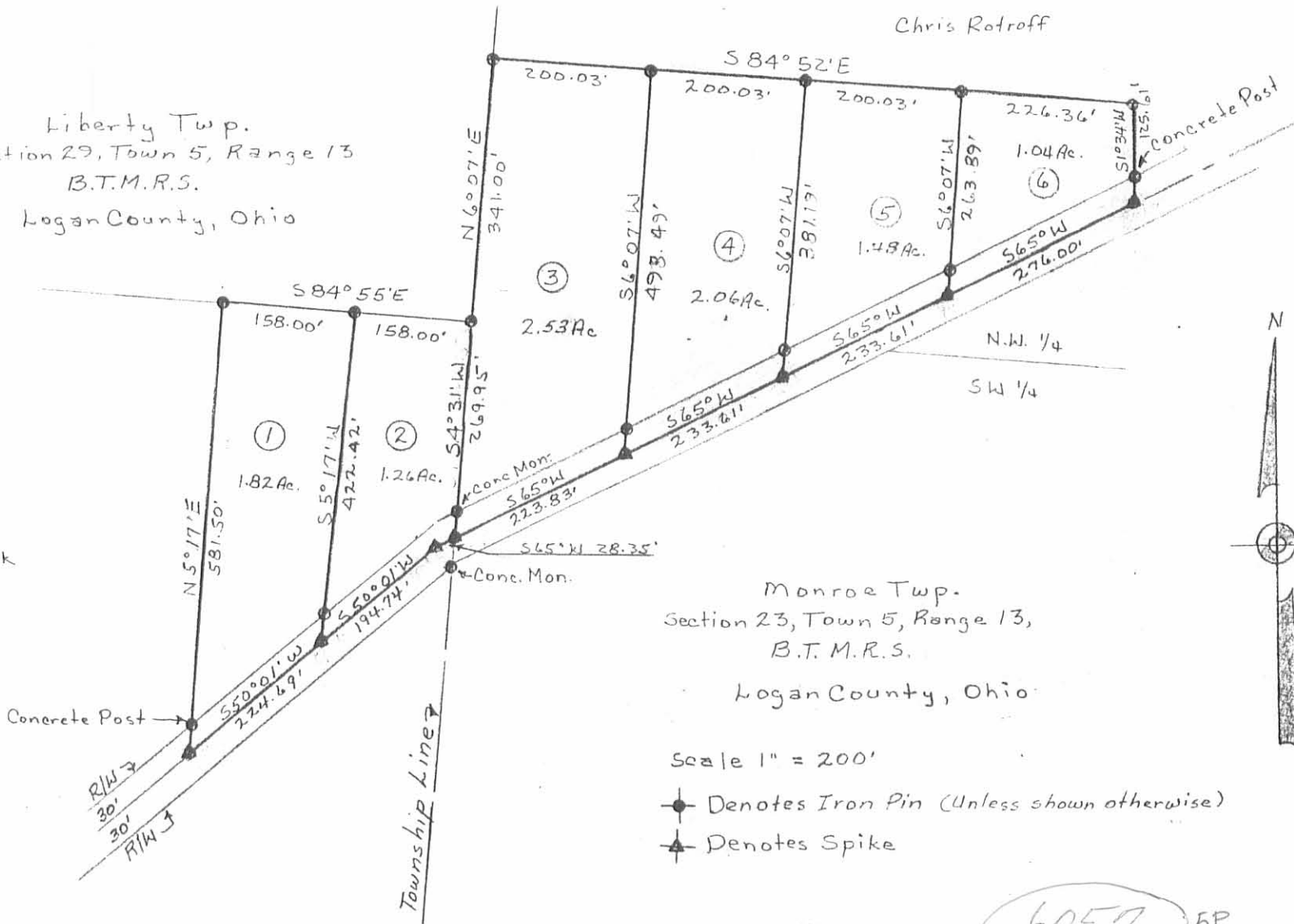

Monroe Twp.
Section 23, Town 5, Range 13,
B.T.M.R.S.
Logan County, Ohio

Scale 1" = 200'

- Denotes Iron Pin (Unless shown otherwise)
- ▲ Denotes Spike

6057 5P

INDEXED ON MAP



I hereby certify this plat to be correct:
Benjamin H. Cartwright P.S.
Registration Number 5456

Survey for: Donald Powell

Monroe Twp. 7.12 Acres
Liberty Twp. 3.08 Acres
Total 10.20 Acres

Survey completed 5-23-69