

234

Feb 7 1836

N^o 312

Surveyed February 11. 1836 for Wm McMillin
 the NW cor of 17 T³ R 14 S 18. Beginning at the
 NW corner of said Sect. a stone corner tree down the
 S 1/4 W 40. Ch 60 links to a Jack Oak 3rd S 9 E 12 Pl
 um bush 2nd N 56 W 5 links, thence S 89 E 39 ch 15
 links to a white oak 15th S 50 E 40 and N. O. 15th
 N 54 W 23 links, thence N 74 E 40 ch. 30 links to the
 original gr corner in the North line of the section bearing
 tree gone, thence N 89 W 40 ch. 25 links to the beginning
 containing 162 00/100 acres -

8371

Sparsing Chamberlain
 Samuel Seeger } ch. ex.
 Feb 7 11. 1836

San Hopkins Co. Surveyor
D.C.

N^o 313

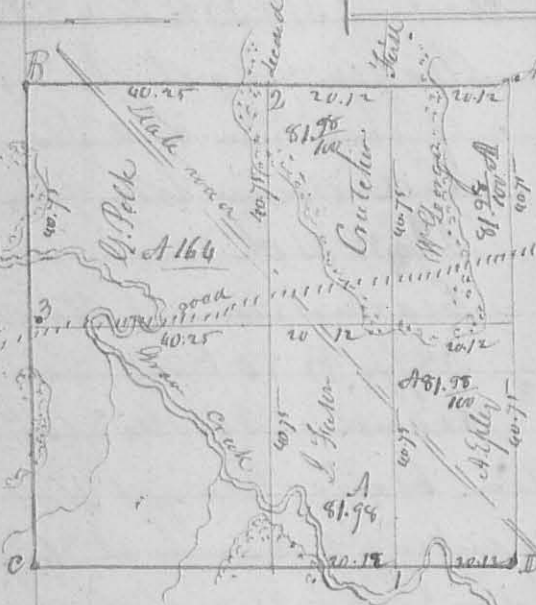

Surveyed Feb 7, 18. 1836 for William
 George & others (see the plat) S 34 1/2 W 4 R 12
 N. R. 1 as follows Beginning at the N E
 corner of said section (the letter A) at a
 stake the original tree gone, thence
 with the North line of said section S 89 1/2 W
 80 ch. 48 links to the north west corner of
 the section cupping a Big pond at 70 ch
 to a white oak 12th N 68 W 30 links
 & white oak 16th N 55 E 26 links, thence

8372

this line

S 1/2 W 81 ch 50 links cupping creek at 20.50 road at 42 ch & oak
 at 77 ch to a stake in a prairie, thence S 89 1/2 E 80. ch 50 links
 cupping a small branch at 29.50 on at 45.25. 69.75 & 73 ch to South
 East corner of the section original bearing tree a Bur Oak 18th
 N 86 12 links, on recently marked S 36 35 links, thence N 7/2 E 81.50
 cupping two roads to the beginning. The first division line
 begins west of the SE corner of the Sect. 20.12 (see fig 1) at a
 W. Oak 16th West 6 link thence N 7/2 E 81.50 cupping two roads to a
 stake in a prairie 20.12 from the N E corner of the section -
 the second line begins west of the above termination 20 ch 12
 at a stake in a prairie, thence S 1/2 West cupping two roads 82.50
 creek at 78.50 to a stake in a prairie a willow 2nd East 22 link

235

The third line begins at a stake in the edge of a field in
 the West line of the section, and 162 poles from either corner
 then S 89° E 80 ch 50 L crossing road & grass creek 5 times passing
 the center corner on the 2nd division at 40 ch 25 links a white oak
 36 L S 30 E 8 1/2 links a white oak 12 L N 48 W 75 links a road at
 52 ch passing center corner on the 1st Division line a willow 8 L
 N 60 E 4 links in the edge of a prairie 162 poles from either end of the
 division line to a stake in the East line of the section. 162 poles from
 either corner (no timber near on which to make a corner) Course in paces
 & quantities of acres marked on the plat.

Nathan George
 George Fuson } ch. men
 and Carter

David Hopkins Surveyor Logan County

8373
 N^o 314 Surveyed February 23rd 1836 for John Grindle the South East 1/4 of
 Benjamin Wall the N^o 1/4 of Sect. 15th R 14th M. 1st as follows Beginning at the South East corner of said section
 a stone thence N 89° W 40 ch 50 links entering a pond at 162 poles left
 at 123 making the pond 34 poles a cord to a stone a white oak
 22 inches diameter N 70° W 69 1/2 links and a white oak 12 L
 S 63° W 69 links, thence N 1/4° E 39 ch 75 links to a stone a white oak
 8 L N 67° W 16 links a white oak 18 L N 81° E 25 links thence
 S 89° E 41 ch to a stone a white oak 55° E 8 links corner made by
 Mr Marmion thence S 50° W 40 ch to the beginning containing
 162^{1/4} poles. For Beginning of B. Wall, Sth 1/4. See second
 corner as above thence with Grindle West line N 1/4° E 39 75 to
 Grindle 3rd corner at above thence N 89° W 40 ch 25 links to
 a stone in Alex. Dokes East line thence N 1/4° W 40 ch crossing
 the lake to the South West corner of the section in a prairie
 a white oak bears S 14° E 11.8 poles thence S 89° E 40 ch 50 links
 to the beginning containing 162^{1/4} poles.

John Grindle Jr.
 William Sharp } ch. evr. David Hopkins S. D. C.

8374
 N^o 315 Surveyed March 3rd 1836 for Philip Diehnich the
 Sth 1/4 of Sect. 15th R 14th M. 1st as follows Beginning at
 the 1st corner between 2nd & 2nd an Oak 8 L S 50° E 19 links
 a white oak (now cut down) 12 L N 86° W 21 links