

296

Magnetic Mer. var. 30° E

Description of Corner.

S10. T3 R13

M. 128.

N<sup>o</sup> 433

8442

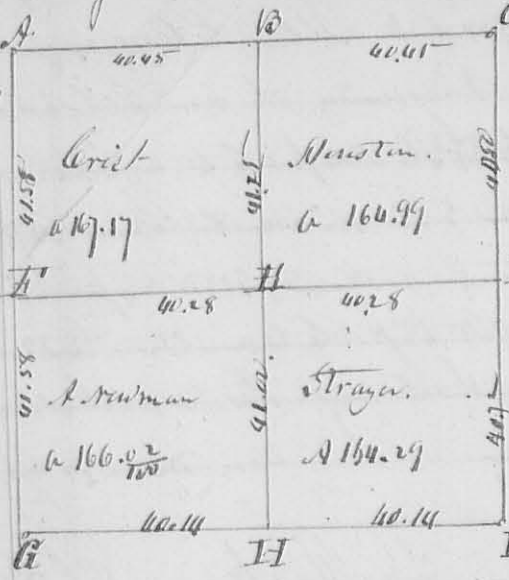

- A Hickory 12 L. S. 11 W. 21 S. (down)
- ditto 12 L. S. N 26 W 30. (down) planted Stam.
- B White Oak 15 L. S. 54 E 23 Links
- ditto - S. N 80 W 15 Links.
- C Corner tree all down. Stam planted.
- D Jack O. 6 L. S. 20 S 48 W 5 Links & Stam.
- Elm 12 L. S. N 80 E 61 "
- E White O. 15 L. S. East 7 "
- ditto 6 L. S. N 14 W 17 "
- F Buckskin 8 L. S. 55 W 31 "

a White Oak 20 L. S. N 80 E 57 Links, + Stam - C Buck 6 L. S. 58 E 3 Links. then 18. 1/2 24 W 19 S. H Sycamore 15 L. S. 58 E 52 Links, + Stam. cap of creek - I. S. E Corner of Sect. Bearing tree all decayed. at same time Survey for N. Straya. Beginning at D. thence East 12 chains to Red Oak 18 L. S. E. Corner thence S 1/2 W 25 chains to a 12 inch Walnut 3 L. S. Corner tree, thence West 12 chains to a Dogwood 6 L. S. Corner tree, thence N 1/2 E 25 chains to the beginning containing 30 acrs. Survey on Dec. 4. 5. & 6th. L. S. H. S. P. K. S. C. S. L. C. O.

Strayer

Charlinton Street.

434

8443

Liberty Street.

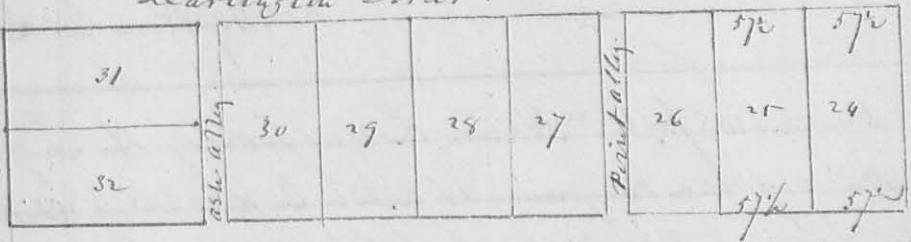

The foregoing plat represents an addition to Chambers addition to Quinay made by Chambers Jan. 1. 1839. The Survey continues from the former addition, on the same course, the lots all being 4 poles front by 8 poles back, excepting N<sup>o</sup> 24.5 which front only 5 poles.

L. S. H. S. P. K. S. C. S. L. C. O.

435

8444

Survey Jan. 1. 1839 for Man. C. S. Chambers, part of the 1/4 quarter of S 28. T 3. R 13 M. R. S. as follow: Beginning at a Buck 6 L. S. 51 S W 7. and Buck 6 L. S. 58 E 11 Links East of the SW Corner of said q. 280 ch. thence N 1/2 E 11.7 chains to an Ash 3 L. S. East 24 links. Buck Oak 15 L. S. N 11 W 17 Links thence East 17 chain to a Buck 8 L. S. N 18 E 25 Links White Oak 48 L. S. N 45 W 7 Links, thence S 1/2 W