

10-29-28

50

F. N. Johnson Survey.

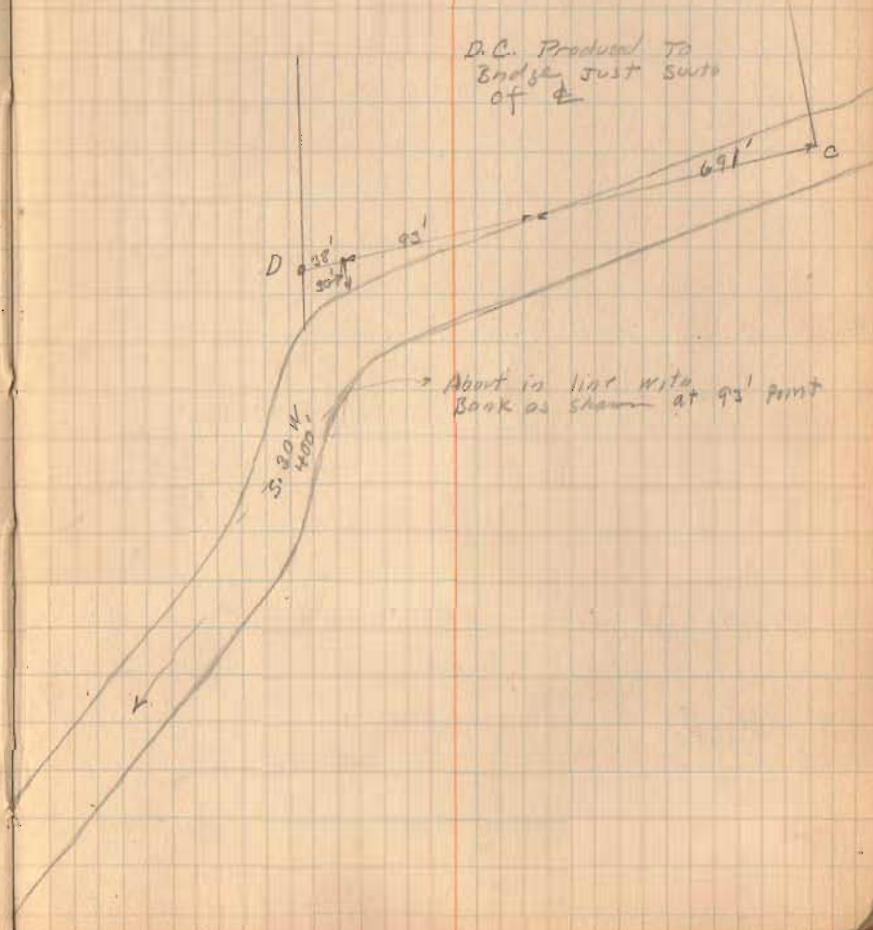

30

Monroe

Before 1929

F.N. Johnson - Survey

Beginning at the center of the North abutment of Mad River at the Ludlow Pike, thence S.E. with the center of said pike 36 feet to the center of Mad River (new channel dredged 1927) thence with the center of the creek S. 48 W. 2035 feet; S. 20 W. 115 feet; S. 35 W. 90 feet, thence N.E. with Smith's West line 128 feet to an old post, thence N. 46 E. 822 feet, thence N. 3° 30' W. 123.42 feet; thence N. 48° 30' E. 1250.70 feet to beginning, said tract containing 2.24 acres, more or less and being the same tract as marked "A" in Surveyor's Book 480 Page 55.

671 ID-1

INDEXED ON MAP

INDEXED ON MAP
6618

F.N. Johnson - Survey

Beginning at a point in the center of Mad River (new channel dredged 1927) thence S. 5 W. 216 feet to a large stump about 20 feet high, said stump being one of the S.W. corners of Isiah Hartzler's land, thence S. 71 W. 138 feet to center of said Mad River, thence with center of said River upstream N. 30 E. 212 feet to place of beginning, said tract containing .32 of one acre more or less and being the same track marked "B" in Logan County Surveyor's Book 480 Page 55.

671
ID-2

INDEXED ON MAP

F.N. Johnson - Survey

Beginning at a large post at the N.W. corner of F.N. Johnson's farm, thence N. 71 E. 818 feet to the center of Mad River (new channel dredged in 1927) thence S. 33 W. with center of said River 1308 feet; thence with the East line of Isiah Hartzler's land, thence N. 4° 30' W. with said Hartzler's land 800 feet to the beginning, said tract containing 7.46 acres more or less and being the same tract as marked "C" in Logan County Surveyor's Book 680
Page 55 .

671

1D-3

INDEXED ON MAP

F.N. Johnson - Survey

Beginning at a point in Milroy's North line said point being the S.E. Corner of Isiah Hartzler's land, thence N.85 W. with Milroy's North line 347 feet to the center of Mad River (new channel dredged 1927) thence upstream with center of said channel N. 33 E. 525 feet; thence S. 4° 30' E. 484 feet to be - ginning, said tract containing 1.75 acres more or less and being the same tract as shown in Logan County Surveyor's Book 480 Page 55, being marked tract "D".

671

1D-4

INDEXED ON MAP

Oct. 29, 1928 55
Clair
Wright
Amthurs.

F. N. Johnson Surrey
Monroe Township.
sec. 23-T.5 R.13
see Book 390 Page 14
See Drawer R
A-B-C-D-E Same as Book 390 Page 14

