

Road # 47 MONROE Tp

Road Width 45'

See INDEX to ROADS #1 PAGE 26

STAKES WERE SET 200' APART
NUMBERED 0-2-4-6 ETC

1347
INDEXED ON MAP

Time filed for dinners Sept 18, 1924

8-28-29

CLEAR

McKerahan 28
Hntwin
WICKERSHAM
LIGGETT

18" cor 9" $\frac{16FT}{114.25}$

C.H. KING

~~64101~~ →

John F. Smith

N 53 E

BEN F. Stolfzous

Rd on W side of VMS # 10524

Road 166

8-28-29

29

Dmc
70+65

L.W. SHORT
XXXXXX

E.L. WIRICK (Eta)

G.H. KING

90+26
XXXX

XX 19+00

XXX 15+34

J.A. Stolfzous

N 53 1/2 E

1349
INDEXED ON MAP

Road #47

30+56
DRIVE →

28+179
LV
XXXXXXXXXX →

SAMUEL G Shull ← DRIVE
28+98

28+100
XXXXXXXXXX →

John Milton Standley

20+170
XXXXXXXXXX →

20+110
XXXXXX ←

1349

INDEXED ON MAP

9728+29

31

Road 47

R.H. WILLETS

~~Subst~~
~~243215~~

29480

29440

Road

R.H. WILLETS

~~28845~~

29430

Road

LEFT

~~28812~~

~~3685~~

N 51° 45' E

361+195

L.W. SHORT

TURN 10° 45' LEFT

32+00

L.W. SHORT

N 53° 45' E

1349
INDEXED ON MAP

8728+29

32

Road 77

Bridge 47+20
16 FT

LINE HIT Bridge
within 4 FT of N END

N 43.40

8 deg 5m

Turn
LEFT

44+20.5

1349

INDEXED ON MAP

Road # 47

John P. HIKEM

CHRISTIAN K HARTZLER

N 11° 0' 40"

62+92
~~Road~~
LEFT

62+22 LAND LINE

Road Right
~~62+7~~

62+22
LAND LINE

Wild Line something
lose the 62+22
accident in about
61+92.

LAND LINE

5754

1349

INDEXED ON MAP

8-28-29

34

Road # 47

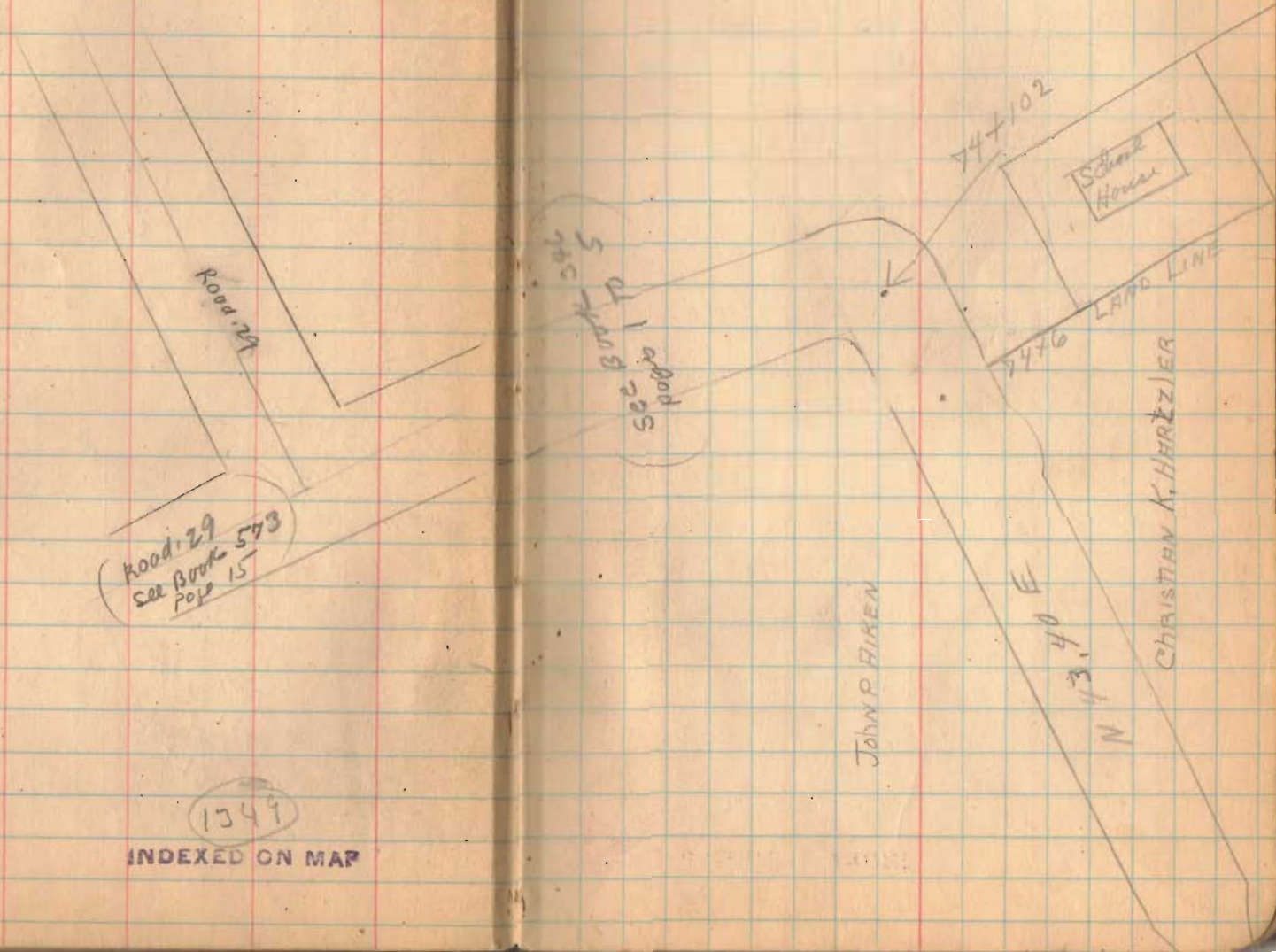

Road # 29
See Book 573
Page 15

1349

INDEXED ON MAP

See Book 573
Page 17

747102

School House

LAND LINE

7476

JOHN P. HIRN

N 13.40 E

CHRISTIAN K. HERRZLER

1

Road. 47 (Monroe Top)

BM 0
stone post 580
1380.00

1379.20

9.0 1371.00.5 + 0.1 8 + 0.2

18-06 14-1.2

0 + 20

8.8

20-04 20-1.2

24-0.2

1

8.4

2-0.1 10-0.1

8-0.7 17-1.0

10 + 0.2 18-0.1

20 + 0.5 20-0.1

2

6.4

4-0 2-0.2

11-1.4 7-0.2

12-0.3 14-0.5

20-1.0 16 + 0.7

18 f
20 + 1.5

3

4.0

5-0.2 5-0.1

12-1.0 13-0

3 + 50

3.5

14 + 0.3 14 + 1.2

14 f
20-0.8 20 + 1.9

4

4.8

6-0.3 8 + 0.1

13-0.8 12-0.5

14 + 0.2 20-0.8

15 f

20-0.5

Pickeral Town + West Liberty
Pike for Monroe Tp Trustees.
Aug 16 1921. No. 47E
5 3 3
5

4 + 20

← 23 → scale House
4 + 20

4

3 + 38 Angle

Drive 3 + 19 House 2 + 751349
INDEXED ON MAPE
5 3 3
5Stakes
set 20'
left of← 15 → stone post
B.M.

	1380.00		7-0.7	6-0.8
5		6.5	14-2.2	12-1.5
			15-1.1	13-0.8
			20-1.5	16-0.5
			16f	14f
				20-0.5

6	$\frac{1.61}{73.86}$	7.75 72.25	6-0.8	8-0
			13-2.1	12-1.5
			14-1.0	14-0.5
			20-2.0	20-0.5
			16f	14f

7		3.8	7-0.6	7-0
			12-1.6	12-0.7
			14+0.3	14+0.5
			14f	20+1.0
			20-0.5	14f

8		5.9	5-0.4	8-0.2
			13-1.7	12-0.6
			14-0.7	14+0.5
			20-1.7	20+0.9
			14f	14f

9		7.3	6-0.3	9-0
			12-1.6	13-1.0
			13-0.8	14+0.2
			20-2.1	20+0.5
			14f	14f

4207 20^{1/2}

1349
INDEXED ON MAP

	73.86		5-04	8+0.2
10		87	11-10	12-0.8
			13-01	14+0.6
			20-0.8	20+0.6
			14f	14f
11		98	6-08	8-0.5
Flow W		1215	11-21	13+1.4
Flow E		1260	12-15	16-0.3
			14f	14f
			20-16	20-0.3
12	9.60	1295	7-07	6-0.5
	<u>71.01</u>	61.41	13-28	11-1.8
			20-38	12-0.6
			14f	14 ^f -0.3+
				20-0.3
13		8.8	5-05	8-0.4
			12-22	12-0.9
			14-17	14 ^f +0.5
			20-30	20+0.8
14		64	8-0	8+0.2
			12-06	11-0.2
			14+0.2	14 ^f +1.3
			20-81	20+1.3

1349
INDEXED ON MAP

9-9+

11+90
12" Corq Iron
Oulvert + 18' long

15

4.6

5-04 6-0
^{74f}
 20-18 12+0.4
 14+0.5
 20+0.5

19+38
 end at
 Monroe Sch-house

16

5.3

5-03 5-01
 11-05
 13-01 12-0.3
 20-1.0 14+0.8
 14f 20+0.8

18+50
 8" vit. pipe culvert

17

5.6

5-05 5-03
 14-21
 15-16 12-0.9
 20-3.0 14-0
 16f 20-0
 14f

18

8.0

6-04 4-0.4

Flow W

10.35

14-13 12-0.8

" E

11.00

16-09 15+1.5
 15f

20-2.0 20+1.5

19

8.8

8-04 15-0.1

15-1.3 14-0.3

16-1.0 16+0.3

20-1.0 20+0.3

19+38

8.7

25' west

7.9

16f 16f

1349
 INDEXED ON MAP

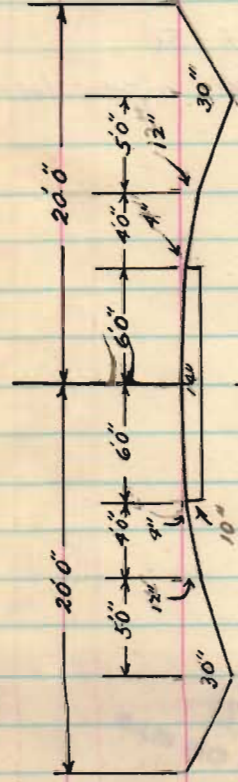

862 cu. yds. Required for 1940 feet

Cross Section of Road No 47.