

Thence $r 75^{\circ} W$ 268 poles (cropping a branch at 82 poles, Macajac River at 175, a spring branch at 211, a mill race at 228, a road at 255 poles) to the beginning. (no line marks on this nor the last mentioned line) contain = ing 1027 ac 20

Robert Marrison }
Benjamin Butler } *et al*

Note the lines shaded with red represent the recent survey and claims, the dotted lines represents the survey made by order of the court a direction of the parties. The depts. admitted that they are within the bounds of the p[er]ffs claims therefore they are not represented on the plat. I surveyed but one of the surveys on the diagram the others are laid down by the field notes of the original and recent surveys.

J. M. Marrison Surveyor
of Logan County

(8189)

10 Mo. Oct. 3rd & 4th 1825

Surveyed 829 acres of land for Benjamin M. Piatt and others, heirs of John H. Piatt dec. Beginning at a stake corner to sections 21, 22, 27 & 28 in Township 10.5 Range 13 E. M. R. thence between sect. 21 & 27 south (cropping Macajac at 163 poles) 261 poles to a stake in said line thence east $\frac{1}{2}^{\circ}$ westerly variation allowed cropping the south channel of Macajac at 144 poles 556 poles to 3 small hickories black oak and cherry bush in Sudlers line - thence

with said line $r 20^{\circ} W$ ($\frac{1}{2}^{\circ}$ westerly variation from the original line) 276 poles to a small and large jack oak at the corner of sect

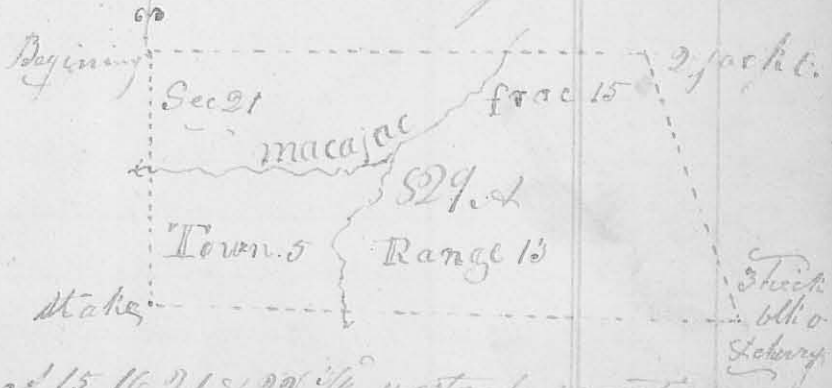

15 & 16 - thence between sect 15, 16, 21, & 22 $\frac{1}{2}^{\circ}$ westerly variation from the original line, cropping Macajac at 92 poles & 62 poles to the beginning containing eight hundred and

29
 twenty nine acres, part of Sec. 21 and fractional sec,
 15 Town. 5 Range 13 E. of M.

Saml. Burnside }
 Thomas Hubbard } Cb. } Jas. W. Harmon
 Joseph Sewell marker } Surveyor of Logans Co.

10th Mo. Oct. 1st 1825

46A

From a division line between Henry Robinson and Alex. Burnside. Beginning in the east line of Sec. 28 Town. 5 Range 13 E. of M. 80 poles north of the corner of Sec. 21, 22, 27 & 28 in said Town & Range thence east, $3\frac{1}{2}^{\circ}$ westerly variation allowed, to the east line of Sec 22 to 2 black oaks in said line

Jas. W. Harmon S. & C.

11th Mo. Nov. 11th 1825 Survey No. 47

8190

Surveyed 200 acres of land for James Taylor Beginning at the N.W. corner of survey No. 9887 north of the Penn-
 sylvania treaty line, a blue ash buck and sugar tree
 thence $S 72^{\circ} E 160$ poles crossing a branch at 106 poles
 to a white walnut haw-buck and buckeye. Thence
 $S 75^{\circ} E 200$ poles crossing Rush Creek at 52 poles to
 two bushes and
 buckeye, thence

$S 12^{\circ} W$ crossing
 a small branch
 at 60 poles, 160
 poles to two bushes
 and sugar tree in
 the north line of

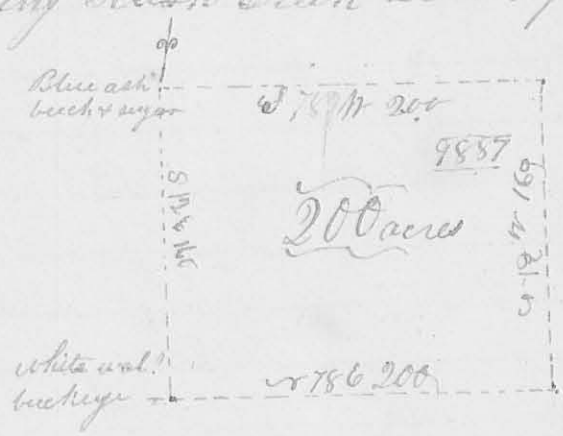

said survey - thence with said line and course thence
 $S 78^{\circ} W 200$ poles crossing Rush Creek to the begin-
 ning, containing 200 hundred acres in the S.W.
 corner of the original survey No. 9887

Thomas & Green }
 Hilthiah Rosebrook } Cb. } Jas. W. Harmon
 Henry Hendrickson marker } Surveyor Logans Co.