

89 said line 162 poles to the beginning containing 246 3/4 acres, the whole of the N.W. q. and the west half of the N.E. q. of sec. 24 & D.

Robert Moore }  
 Samuel Moore } C. S. L. C.  
 R. Moore master

8729 3<sup>rd</sup> Mo. (March) 23<sup>rd</sup> 1829

Survey No. 114

Surveyed 27 1/2 acres for Benjamin Watkins - Beginning at an elm and small red oak in the north line of Thomas Parker's survey No. 4497 13 poles N 67° E from Belms, corner to Parker's survey - Thence north 30 poles to 2 dogwoods - Thence N 67° E (cropping a road at 118 poles) 148 poles to a Sugar tree - Thence S 30 poles to 2 Sugar trees & hickory in Parker's line - Thence with his line (S 67° W) (cropping a road at 30 poles) 148 poles to the beginning containing 27 1/2 acres part of James M. Vult's survey No. 4495 & 4604 -

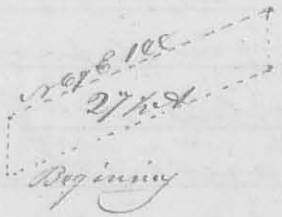

Robert Watkins }  
 Richard Robins } C. S. L. C.  
 Robert Marnon master

3<sup>rd</sup> Mo. 24<sup>th</sup> 1829

8230

Survey No. 115

Surveyed for George Moots Sr. 25 acres Beginning at white oak and black oak in the south line of Samuel Finley's Survey No. 4495 & 4525 on Mad River 74 poles N 70° E from the south west corner of said survey - Thence with said line N 70° E 25 1/4 poles (cropping a road at 154 poles) to a black oak and white oak - Thence N 20° W 76 poles to a bar oak and white oak - Thence S 70° W 122 poles to a white oak oak on the south side of a road - Thence N 20° W (cropping Mad River at 112 poles) 160 poles to a stake in a prairie - Thence S 70° W 131 1/7 poles to a stake in the prairie

90  
Thence  $S19^{\circ} E$  cropping  
a mill-pond at 60 poles  
235 poles to the begin-  
ning containing 250  
acres, part of Samuel  
Hinley's said survey -

P. Kelly  
Geo. Meets } etc.

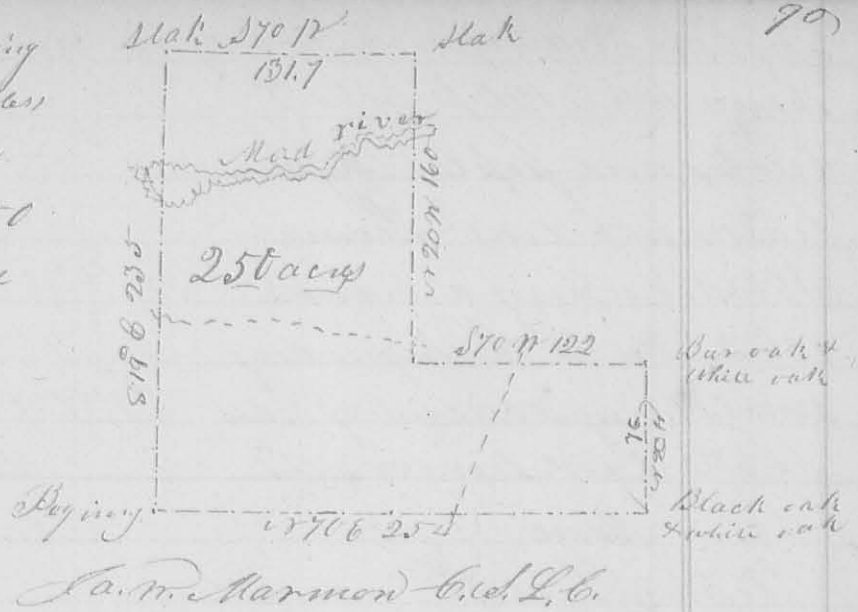

J. M. Harmon C. S. L. C.

3rd Mo. (March) 24<sup>th</sup> 1829 } Survey No. 116 (8233)  
Surveyed 109 acres for George Meets Sr.

Beginning at a black oak and white in Ludlow's line, at  
the S.E. corner of Sec. 16 Town 5 Range 15 M. P. and South  
west corner of Samuel Hinley's survey are 4493 & 4525 on  
Mad River - Thence with Ludlow's  
line  $N19^{\circ} W$  236 poles to the north bank  
of Mad river thence  $S70^{\circ} E$  74 poles  
to a stake - thence  $S19^{\circ} E$  (cropping  
a mill pond at 60 poles) 236 poles  
to 3 white oaks & black oak in the  
South line of the original survey  
thence with said line  $S20^{\circ} W$  74  
poles to the beginning contain-  
ing 109 acres in the S.W. corner  
of Hinley's said survey -

Peter Kelly } etc.  
Geo. Meets Jr. }

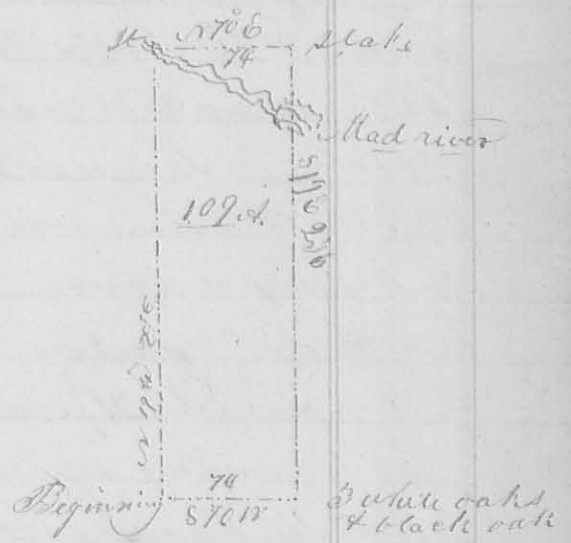

J. M. Harmon C. S. L. C.

4th Mo. (April) 20<sup>th</sup> 1829 (8234) Survey No. 117  
Surveyed 110 acres of land for Thomas Dundon Beginning  
at a stake in Meets' east line, & in the west line of John  
Scott's survey 3441 on the east side of a small branch  
thence with said line  $N42^{\circ} W$  (cropping a branch twice in  
4 poles distance) 123 poles to a stone corner to William  
Reams's land thence  $N80^{\circ} E$  (cropping 2 branches, 13.2