

(122)

north  $\approx 75^{\circ}$  in  $\approx 410$  poles crossing crossing Mad River at 120 poles the Sandusky road at 218 poles to a large buck elm and Sugar tree in the west line of the original survey thence with said line  $\approx 15^{\circ}$   $\approx 76.7$  poles to a stake  $\approx 11$  corner to Isaac Zanc's land as per deed from L. Sullivan

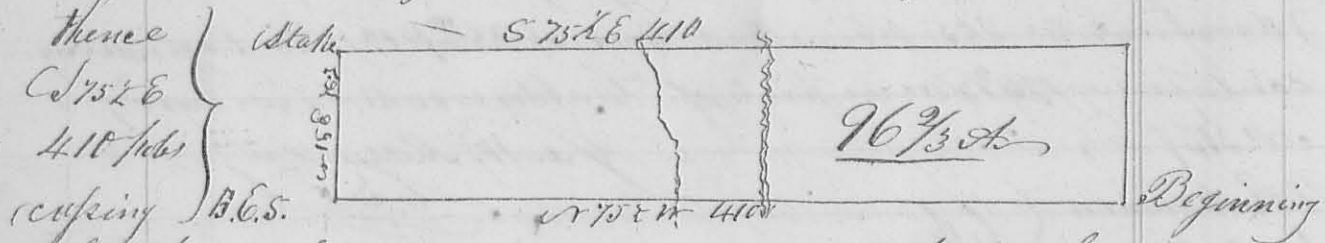

thence with said line  $\approx 15^{\circ}$   $\approx 76.7$  poles to the beginning it being part of Jas. Calderwood's said survey

James M. Harmon  
Robert M. Harmon

Lynne Starling  
No 151

Survey No 151

Survey 160 acres for Lynne Starling

Beginning at the  $\approx 11$  corner of A. J. Smith's survey  $\approx 3225$  and  $\approx 11$  corner of Holland Haney's survey  $\approx 3224$  the corner trees all being down I set a stake thence with the west line of Haney's survey  $\approx 21^{\circ}$   $\approx 112^{\circ}$  variation west therefrom, crossing a branch at 34 poles, 160 poles to 4 dogwoods on the north declivity of a knob - thence  $\approx 16^{\circ}$   $\approx 160$  poles, crossing a branch at 136 poles, again at 139, again at 141 poles to 2 small elms and lynn; thence  $\approx 21^{\circ}$   $\approx 160$  poles, crossed the dry channel of a branch at 36, 40, & 44 poles, 160 poles to small Hickory, ash, dogwood, and lynn in the south line of the original survey - thence with said  $\approx 16^{\circ}$   $\approx 160$  poles to the beginning, being in the south west corner of H. Haney's said survey

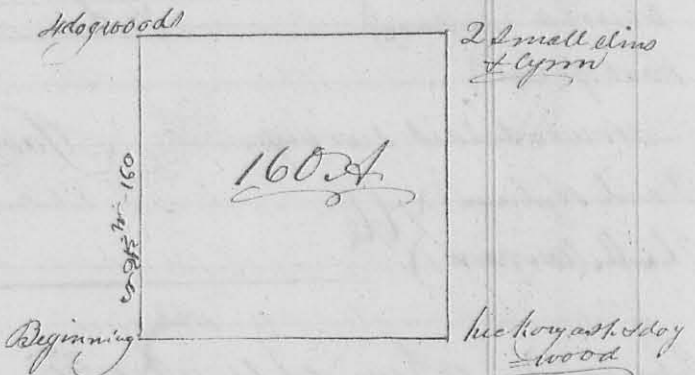

James M. Harmon  
Robert M. Harmon