

N. 81 3/4 E 4 1/2 Poles, to a Stake his S. O. cor.  
thence with his east line N 84 1/2 W 27 Poles, to  
the beginning containing 63 1/2 acres.  
John Michem C.S.L.C.

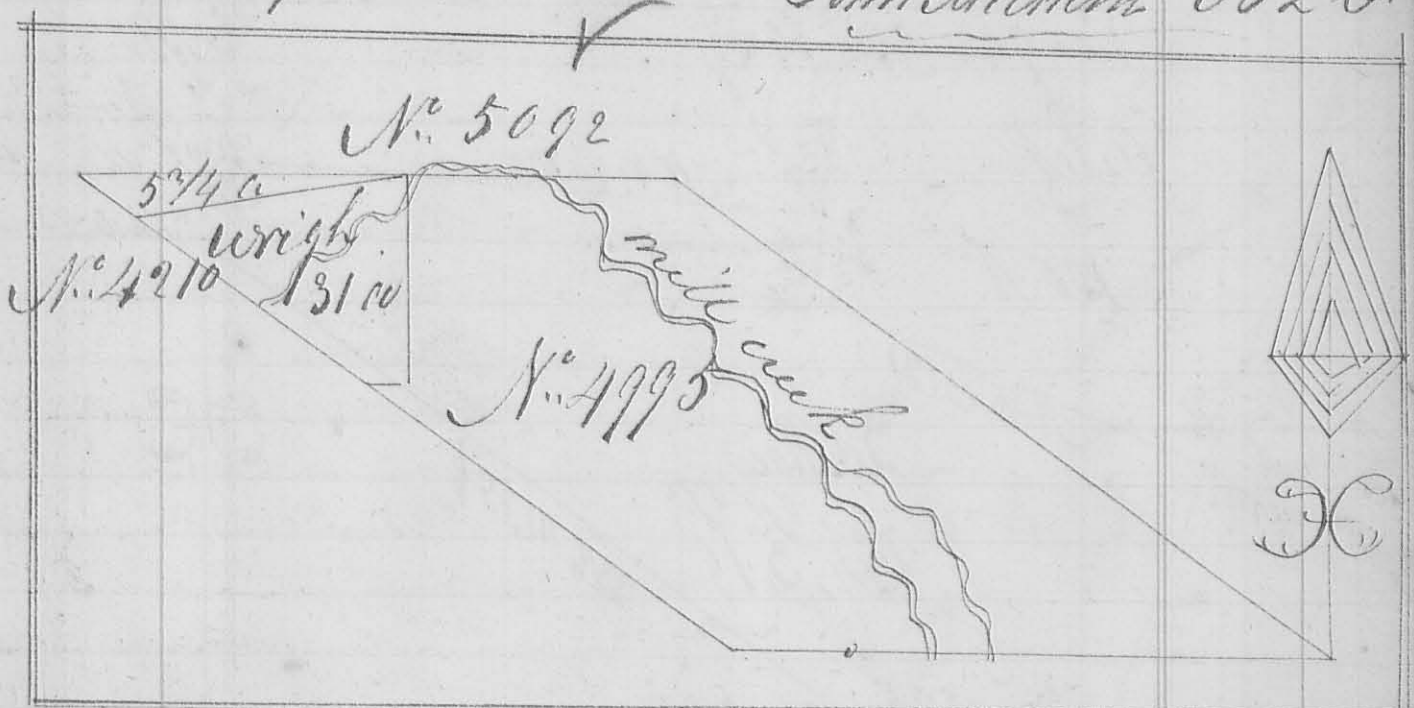

2<sup>nd</sup> mo. Feby. 2<sup>o</sup> & 3<sup>o</sup> 1842

Survey  
N. 488

8476

Surveyed for Daniel Wright - 31 acres of land  
being part of Survey N. 4210 in Survey N. 4995  
patented to Andrew Vance in trust for the heirs of  
Robert Vance as follows: - Beginning at a Hackberry  
and 2 Buckeye cor. to Survey 5092; thence west 11.8  
Poles, to a Stake in the west line of said Vance's said  
Survey N. 4995; thence with his said line S 50 E  
124 1/2 Poles crossing Mill creek to Wright's south line  
thence East 16 Poles, to his east line; thence North  
78 Poles, to the beginning.

Also Surveyed for Evans & Branson 5 3/4 acres  
of land being part of Survey 4210 in Survey 4995  
as follows: - Beginning at a Hackberry & 2 Buckeye  
in the north line of said Vance's said Survey N. 4995 cor.  
to Survey N. 5092; thence with Vance's said line N 82 1/2 W  
132 Poles, to a Stake, with up trees Beech, Sugar, Buckeye  
& Small Buckeye; thence with his west line S 50 E  
25 1/2 Poles, to a Stake in Wright's north line; thence with  
said East 11.8 Poles, to the beginning  
John Michem C.S.L.C.

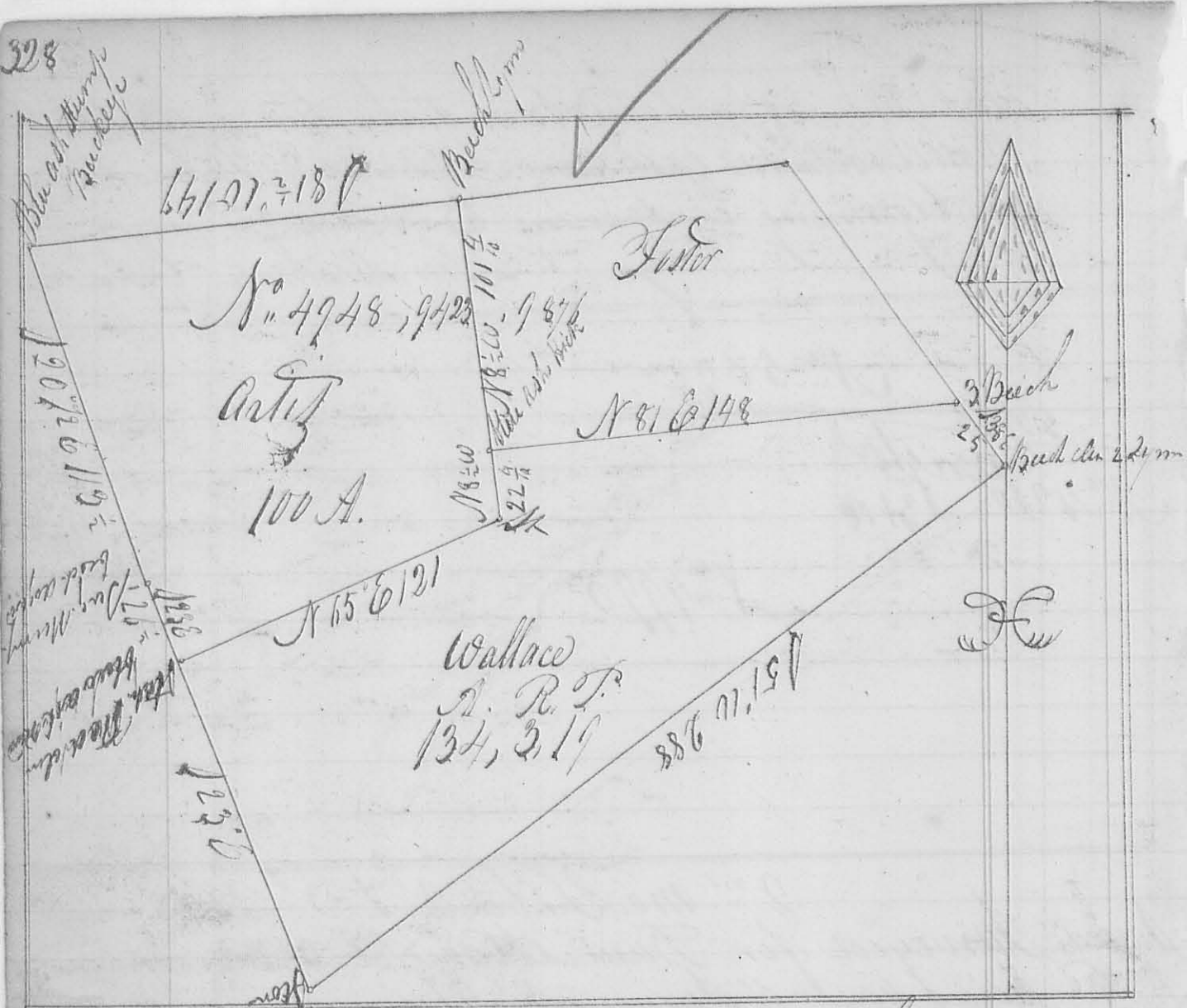

Survey  
No. 187

(134)

2<sup>nd</sup> Mo Feb 14<sup>th</sup> 1842

Surveyed for W<sup>m</sup> M. Donohoe Adm<sup>r</sup> of Duncan  
 M<sup>r</sup> Arthur Wood<sup>r</sup> under the direction of James Crew the  
 following described land being part of Survey  
 No. 4948, 9423, 9876, the 1<sup>st</sup> tract, beg. at a  
 Blue ash stump & Buckeye, S. W.  $\angle$  to Thomas Hotta  
 Survey No. 2674: thence S 20° E 113 $\frac{1}{2}$  poles, crossing a  
 small branch, to Sugar stump, Beech & Dogwood (the beech  
 is dead) cor. to S. Gickens: thence with said line S 25° E to  
 a Stake red Elm N 12° W 19 links, Blue ash & Cornwood:  
 thence N 65° E 121 poles to a Stake: thence N 81° W 101 $\frac{1}{2}$   
 poles, passing R. Blackleys S. W. cor. at 22 $\frac{1}{2}$  poles  
 & crossing a branch at 88 poles, to a beech & L<sup>r</sup> in the  
 South line of said Hotta said Survey No. 2674 N. W. Cor.  
 to Blackley: thence with Hotta's South line S 81° W 13 $\frac{1}{2}$   
 poles to the Beginning containing 100 acres