

(4)

Roads 45 & 33

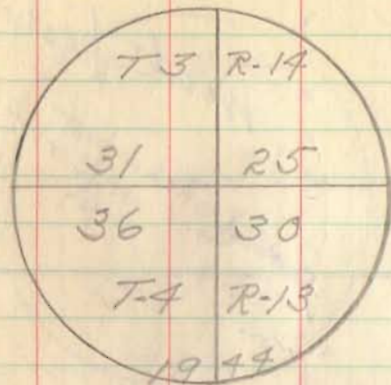

10-10-44
 Dyser
 Robbins
 Mr. Adams

Found pointed stone about 14" square by 34" long with broken bricks - removed same and placed concrete men. ^{4" long} Marked as above. Top 5" below surface of road 45

See Field Book 559 page 64

Found 2 Jan. 1969
 C.N. sign "Laffer Rd."

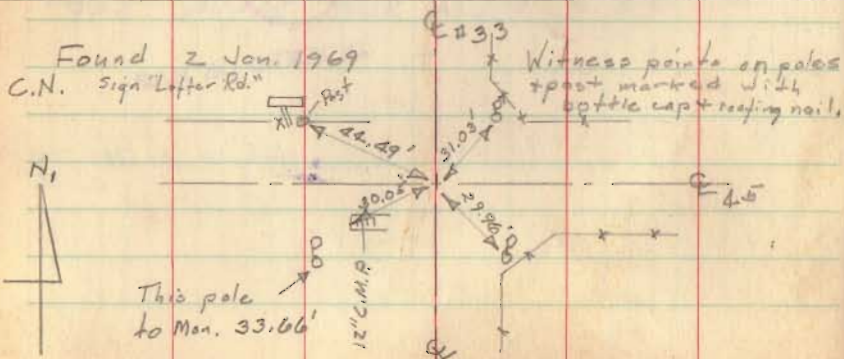

37

