



Recd 7-26-99 OKJCH

Lee Surveying and Mapping Co., Inc.



Land Surveys • Topography • Subdivisions • Construction Layout

117 N. Madriver Street
Bellefontaine OH 43311

Phone: (937) 593-7335
Fax: (937) 593-7444

COY 0.445 ACRES

Lying in Section 23, Town 3, Range 13, Village of Quincy, Miami Township, Logan County, Ohio.

Being the Franklin W. Coy 0.64 acre tract as deeded in Official Record 77, Page 824 of the Logan County Records of Deeds and being more particularly described as follows:

Beginning at a 1 inch square iron bar found at the intersection of center-lines of Mill Street and Miami Street (49.5 feet wide).

THENCE, with the center-line of Miami street, S 5°-34'-00" W, a distance of 387.92 feet to a point.

THENCE, N 84°-26'-58" W, a distance of 24.75 feet to a point at the TRUE POINT OF BEGINNING, referenced by a 5/8 inch iron rod found, N 84°-26'-58" W, a distance of 0.16 feet.

THENCE, with the west right-of-way of Miami street, S 5°-34'-00" W, a distance of 94.72 feet to a 5/8 inch iron rod set.

THENCE, with the north line of the Pearl Louise Heath 0.01 acre tract (O.R. 411, Pg. 691, Third Tract), N 84°-17'-04" W, a distance of 80.74 feet to a 3/4 inch iron rod found.

THENCE, with the west lines of the said 0.01 acre tract and the Pearl Louise Heath 0.073 acre tract (O.R. 411, Pg. 691, First Tract), S 5°-08'-19" W, a distance of 37.28 feet to a 5/8 inch iron rod set.

THENCE, with the northerly right-of-way of a 15.25 feet wide alley, N 84°-02'-31" W, a distance of 89.78 feet to a 5/8 inch iron rod set.

THENCE, with the east right-of-way of a 16.00 feet wide alley, N 5°-37'-44" E, a distance of 131.13 feet to a 3/4 inch iron rod found.

THENCE, with the southerly line of the John S. Hickman 0.367 acre tract (O.R. 295, Pg. 122), S 84°-26'-58" E, a distance of 170.10 feet to the point of beginning, passing a 5/8 inch iron rod found at 169.94 feet.

Containing 0.445 acre.

The basis for bearings is the center-line of Miami Street being S 5°-34'-00" W, and all other bearings are from angles and distances measured in a field survey by Lee Surveying and Mapping Co., Inc. on July 15, 1999.

Description prepared by:

Jeffrey I. Lee
Professional Surveyor 6359
July 19, 1999



ORIGINAL STAMP IN GREEN
L-1829

INDEXED ON MAP
4090 ID

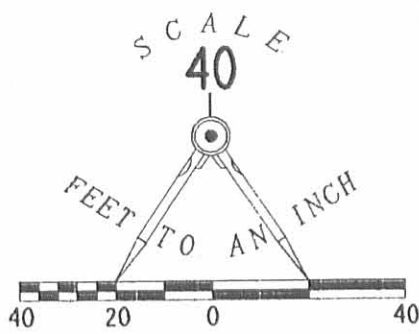

RED 1-26-99

- LEGEND**
- 5/8" IRON ROD SET
 - 5/8" IRON ROD FOUND
 - ⊙ 3/4" IRON ROD FOUND
 - 1" SQUARE IRON BAR FOUND
 - X — FENCE

MILL STREET

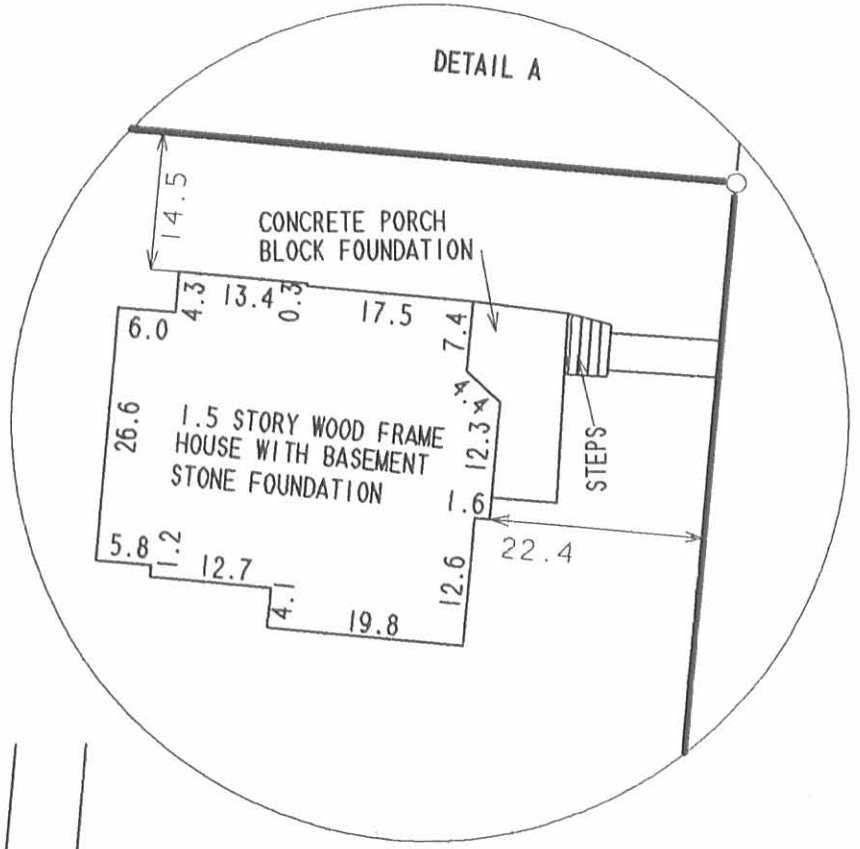

MIAMI STREET S 05° 34' 00" W (BASIS FOR BEARINGS)



**BOUNDARY SURVEY AND
MORTGAGE INSPECTION SURVEY
OF THE
FRANKLIN W. COY
0.64 ACRE TRACT
OFFICIAL RECORD 77, PG. 824
VILLAGE OF QUINCY
SECTION 23, TOWN 3, RANGE 13
MIAMI TOWNSHIP
LOGAN COUNTY, OHIO**

I HEREBY STATE TO MINSTER BANK THAT ON JULY 15, 1999 LEE SURVEYING AND MAPPING CO., INC. MADE AN ACCURATE SURVEY OF THE PREMISES SHOWN HEREON AND THAT THERE ARE NO EASEMENTS OR ENCROACHMENTS VISIBLE ON THE GROUND OTHER THAN THOSE SHOWN HEREON. THIS IS A MORTGAGE LOCATION SURVEY PREPARED IN ACCORDANCE WITH CHAPTER 4733-38 OF THE ADMINISTRATIVE CODE. IT IS NOT A BOUNDARY SURVEY PURSUANT TO CHAPTER 4733.37 OF SAID CODE. THIS MORTGAGE SURVEY IS NOT TO BE USED BY THE PROPERTY OWNER TO ESTABLISH PROPERTY LINES.

SURVEYED BY:

Jeffrey I. Lee
JEFFREY I. LEE
PROFESSIONAL SURVEYOR 6359
JULY 15, 1999



ORIGINAL STAMP IN GREEN

COPYRIGHT 1999 BY:
LEE SURVEYING & MAPPING CO., INC.
117 North Madriver Street
BELLEFONTAINE, OHIO 43311
(937) 593-7335

D-349 ROBBIN L-1829-3

2 WORKING DAYS
BEFORE YOU DIG
CALL TOLL FREE **800-362-2764**
OHIO UTILITIES PROTECTION SERVICE.

INDEXED ON MAP
4090 1P

Huffman Survey Quincy June 1967 0.01 Acre

The following described land in the Village of Quincy, Miami Township, Logan County, Ohio and being in Section 23 Town 3 Range 13.

Beginning at an iron at the N.E. corner of Lot Numer 226 and at the west side of Miami Street Thence with the west side if Miami Street North 49.00 feet to an iron said iron being the true beginning point of this survey. The last described line passing an iron at the North side of a sixteen foot Public Alley at 16.00 feet.

Thence with the North side of a 0.10 acre tract in the name of Marry Curl West 47.00 feet to an iron.

Thence South 3.00 feet to an iron.

Thence again with the North side of said Curl 1. 0.10 acre tract West 34.25 feet to an iron.

Thence North 7.00 feet to an iron.

Thence East 81.25 feet to an iron at the West sdie fo Miami Street.

Thence with the West side of Miami Street South 4.00 feet to the place of beginning.

The above described tract contains 0.01 of one acre and is out of the South side of a 0.65 acre tract now in the name of James S. Hoffman Jr.

cc
Logan County Engineer



4090 2D