

S 82 3/4 W 102.4 from buckeye
< trees set stake -

Then on forecast line of
25 a - S 7 1/2 W
set out 2'
set stake in road at
2000 + = 20.09 set stake

(1511)
INDEXED ON MAP

North line of 20 acres on
road - 9.80
set stake in north side of grade

North line of 25 acres on
road - 12.80
set stake -

Make all < to 25 acres
from fine -



S 7 1/2 W Survey -

At Bush S 64 3/4 W 1.9 poles -

(1512)
INDEXED ON MAP
Dec. 19, 1904

2 buckeye & red elm
xxx to survey

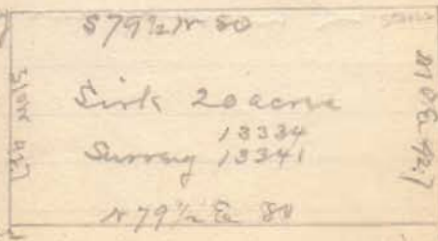

stake
1904

ash & Survey
in Survey

Harrod Survey

Line A with line of south
side of 10' lane. 26.11
7.15 to stake in Bondham
line

Line B. With Bondham
line - 117.50 8.20 stake
old Co line. 3000 -

Line C. with south line of
Zimmerman & south line
of Sirk 1182.3
at 2.01 1/2 stake at Mills
12 acres -

at 9.23 ash stump
in Zimmerman line -

Jan 11 - 1890

Line D. with east line

Mills 12 acres

112.58

to swamp ash 3" 1182.3

Mills 12 acres -

10.42

Line E -

with south line Sirk land

1181.58 7.17

to 15.50 of Sirk 200 -

Lynne stump & ground 2"

Line F with west line of

Zimmerman & Sirk -

2127.11 - facing ash &

to Sirk (20) at 10.46

17.29 to stake at "a"

(1512)

INDEXED ON MAP

43
Right-of-way 15' wide extending
from S.E. of Mills land and
extending to Richland road
length of lane
at 2.90 N.E. Zimmerman
tract
21.71 met line Richland
road

1572
INDEXED ON MAP