

Survey for R 49-6.00

59+84 0°41'R Stone & Iron found.

55+00 RR spike set

50+00 RR spike set

49+50 RR spike

48+00 RR spike set

45+00 RR spike

37+83.7 0°22'R

INDEXED ON MAP

4399

Parties -
O. Keyser
E. Haines
P. Rogers
W. Keyser

40

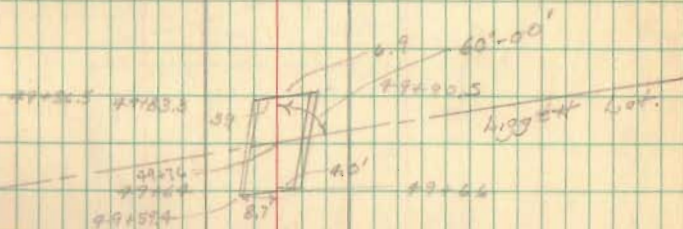

59+84

Hub reset

See Rk 560
pg 27 - 284

Stump practically gone.