

29
 twenty nine acres, part of Sec. 21 and fractional sec,
 15 Town. 5 Range 13 E. of M.

Saml. Burnside }
 Thomas Hubbard } Cb.
 Joseph Sewell marker

Ja. W. Harmon
 Surveyor of Logans Co.

10th Mo. Oct. 1st 1825

46A

From a division line between
 Henry Robinson and Alex. Burnside: Beginning
 in the east line of Sec. 28 Town. 5 Range 13 E. of M. 80 poles
 north of the corner of Sec. 21, 22, 27 & 28 in said Town &
 Range thence east, $3/4$ westerly variation allowed, to the
 east line of Sec 22 to 2 black oaks in said line

Ja. W. Harmon S. L. G.

11th Mo. Nov. 11th 1825

Survey No. 47

8190

Surveyed 200 acres of land for James Taylor Beginning
 at the N.W. corner of survey No. 9887 north of the Penn-
 sylvania treaty line, a blue ash buck and sugar tree
 thence $S 72^{\circ} E 160$ poles crossing a branch at 106 poles
 to a white walnut haw-bush and buckeye. Thence
 $S 75^{\circ} E 200$ poles crossing Rush Creek at 52 poles to
 two bushes and
 buckeye, thence

$S 12^{\circ} W$ crossing
 a small branch
 at 60 poles, 160
 poles to two bushes
 and sugar tree in
 the north line of

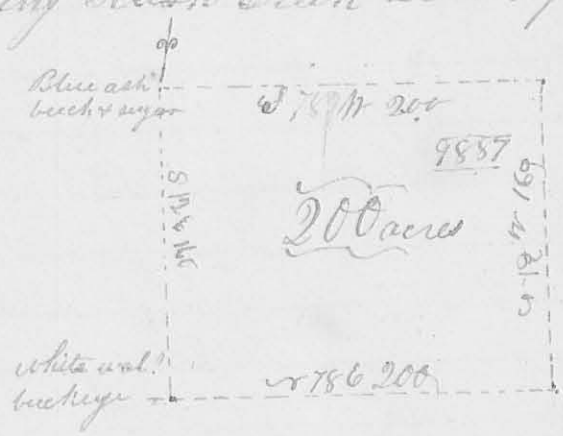

said survey - thence with said line and course thence
 $S 78^{\circ} W 200$ poles crossing Rush Creek to the begin-
 ning, containing 200 hundred acres in the S.W.
 corner of the original survey No. 9887

Thomas & Green }
 Hilthiah Rosebrook } Cb.
 Henry Hendrickson marker

Ja. W. Harmon
 Surveyor Logans Co.