

RUSSELS POINT
DEPOT

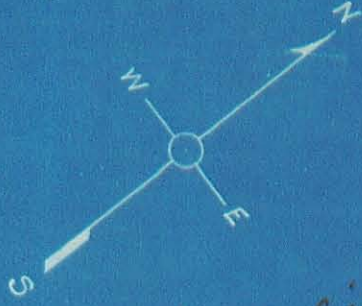

lost
1/4 Gas pipe
14" Walnut
N 37 1/4 W 95'
and 4
0 W end T 80 c Siding
S 56 E 42'
Iron bar
S 29 1/2 E
49.2'
Iron bar
Wit: - 14" Walnut N 63 W 76.8'

(104) 18

PROPERTY OF —
FRANK GILLENWATER

AT RUSSELS POINT

Pt. S.W. Qr. Sec. 36, T. 6. R. 8
WASHINGTON TP
LOGAN CO.
OHIO.

APR. 20, 1911.

Scale 1 inch = 40 feet

H.S. Dailey
Deputy County Surveyor

Center Line Ohio Elec. Rwy.

With curve of right-of-way, 27' from center of track

T. & O.C. Rwy.

Strip 16' wide

Frank
Gillenwater
.57 a.

Center of Reservoir bank road S 55 1/2 E 306.0'

Fence post

Iron bar

S 35 1/4 W
140.6'

6" Cottonwood
line 1907

20'

Iron bar

O. H. Himmelright

lost
6" Cottonwood
S 35 1/4 W 19.7'
to O. H. Himmelright

Scale 1" = 50'

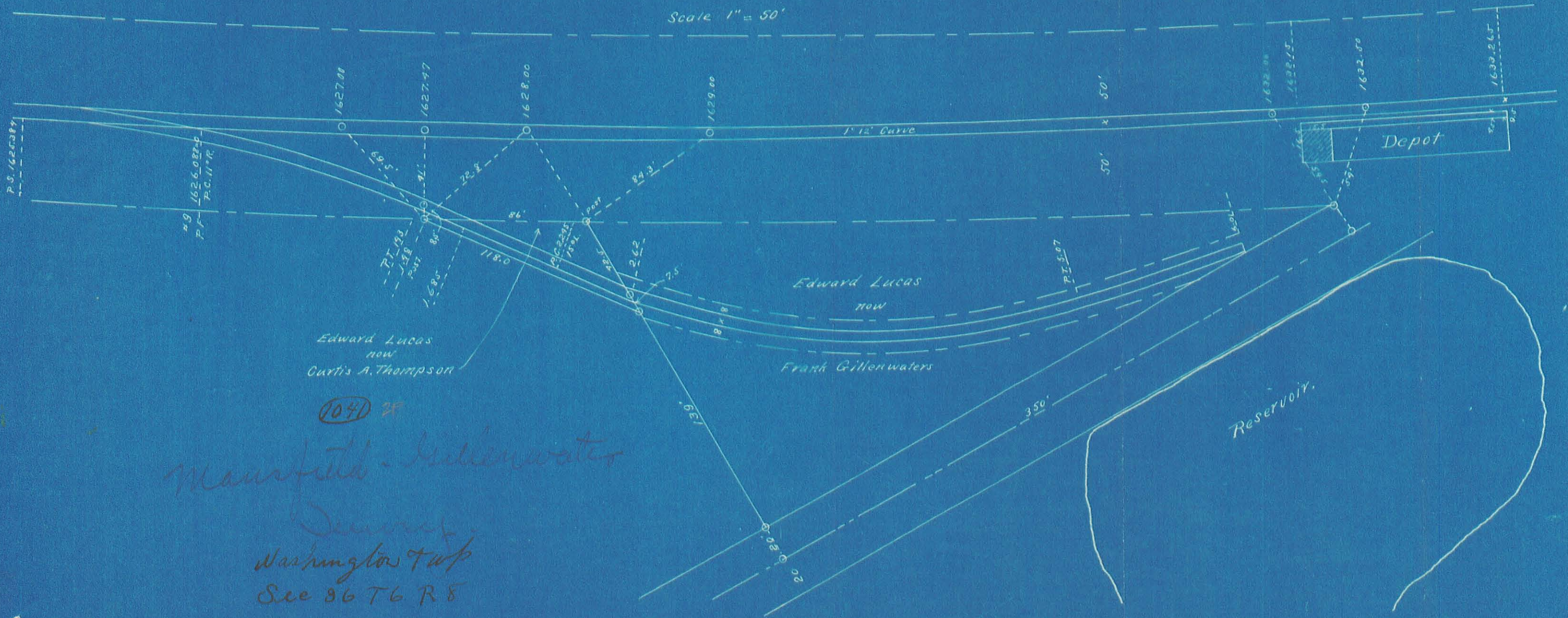

Edward Lucas
now
Curtis A. Thompson

Edward Lucas
now
Frank Gillenwaters

Depot

Reservoir

Manufact - Gillenwaters

Survey
Washington Twp
See 36 T6 R8