

WALNUT

AVE.

- 40'

80.025'

120.05'

Harrow Tooth Set

Harrow Tooth Set

Page 29

See F. B. No. 700



○ - 5/8" x 30" Rebars Found.
● - 5/8" x 30" Rebars Set.

Survey of Lots 86, 87, 88
Avondale Park Allotment No. 2
Stokes Township
Logan County, Ohio
June 16, 1989

INDEXED ON MAP
7930 1P

Daniel E. Gilbert
Daniel E. Gilbert, P.S.
Reg. Sur. No. 5402
400 North Park Street
Bellefontaine, Ohio
43311



Scale: 1" = 20'

3-18-13

APPROVED

WALNUT AVENUE (40')

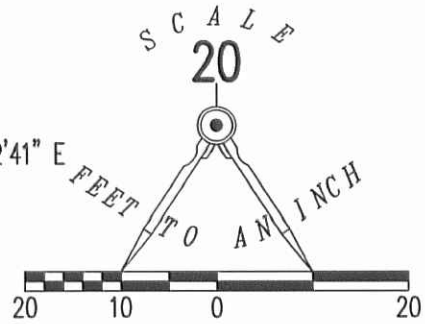

BASIS FOR BEARINGS
N 81°30'00" E
79.86'

ANTHONY D. HOSKINS
LOTS 86, 87, AND 88
O.R. 1044, PG. 1

0.290 ACRE
12639.486 SQ. FT.

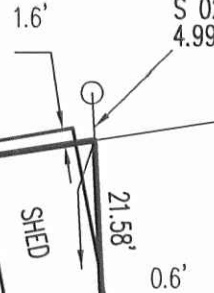

LEGEND

- 5/8 INCH IRON ROD SET
- 5/8 INCH IRON ROD FOUND

ASH STREET (40')

N 02°43'08" W
159.53'

30' SETBACK

LOT 86
LOT 87

4' CHAIN LINK FENCE

LOT 95
LOT 94

DAVID E. LINDSEY
LOTS 93, 94, AND 95
O.R. 1064, PG. 92

LOT 87
LOT 88

102.7'

LOT 94
LOT 93

5' SETBACK

LOT 88
LOT 89

LOT 93
LOT 92

RONALD L. REEDER AND MARY L. REEDER
LOT 92
O.R. 491, PG. 536

ANTHONY D. HOSKINS
LOT 89
O.R. 932, PG. 593

20' SETBACK

LOT 89
LOT 90

LOT 92
LOT 91

MOREQUITY, INC.
LOTS 90 AND 91
O.R. 1101, PG. 248

79.37'
S 81°32'39" W

S 02°32'41" E
159.65'

AVONDALE PARK ALLOTMENT NO. 2
PLAT CABINET A, SLIDE 243

RETRACEMENT SURVEY OF THE
ANTHONY D. HOSKINS
LOTS 86, 87 AND 88
OFFICIAL RECORD 1044, PAGE 1
ANTHONY D. HOSKINS
LOT 89
OFFICIAL RECORD 932, PAGE 593
AVONDALE PARK ALLOTMENT NO. 2
PLAT CABINET A, SLIDE 243
STOKES TOWNSHIP
LOGAN COUNTY, OHIO

SURVEYED BY:

William K. Bruce

WILLIAM K. BRUCE
PROFESSIONAL SURVEYOR 7437
MARCH 12, 2013

COPYRIGHT 2013 BY:
LEE SURVEYING & MAPPING CO., INC.
117 North Madriver Street
BELLEFONTAINE, OHIO 43311
(937) 593-7335
WWW.LSMINC.US
surveys@lsminc.us



ORIGINAL STAMP IN GREEN

INDEXED ON MAP
7930 2P

2 WORKING DAYS
BEFORE YOU DIG
CALL TOLL FREE **800-362-2764**
OHIO UTILITIES PROTECTION SERVICE.

ADW D0213 54840213 L-5484-3