

2-26-13

**HAVENAR
ENGINEERING &
SURVEYING, Inc.**



APPROVED

**Amy L. Havenar, P.E.
Britt R. Havenar, P.E., P.S.**

Legal Description for 71.257 Acres

Situate in the Southeast Quarter of Section One (1), Town Seven (7) South, Range Seven (7) East, Township of Stokes, County of Logan, State of Ohio, and being all of a 7.5 acre tract and 62.5 acre tract owned by Anna M. Kies in Official Record 428, Page 181, Tracts I and II of the Recorder's Office of Logan County, Ohio, as shown by a survey by Britt R. Havenar, Ohio P.S. No. 8266, and being more particularly described as follows:

Commencing at a 3/8" iron pin found at the Southeast corner of the Southeast quarter of Section One (1), Town Seven (7) South, Range Seven (7) East, also being the intersection of the centerline of right-of-ways of County Road 23 (60' R/W) and County Road 225 (50' R/W), said pin being the True Point of Beginning of the tract of land herein described;

Thence North 89 degrees 32 minutes 34 seconds West, along the centerline of right-of-way of County Road 225, also being the south line of Section One (1), a distance of 1170.13 feet to a Mag nail set in a bridge deck;

Thence North 00 degrees 00 minutes 39 seconds East, along the east line of Kenneth G. Seger 67.749 acre tract in OR 734, page 575, a distance of 2653.91 feet to a 5/8" capped iron pin set, passing through a 5/8" capped iron pin set at a distance of 25.00 feet which marks the north right-of-way line of County Road 225, said pin being on the east-west half-section line of Section One (1);

Thence South 89 degrees 29 minutes 01 seconds East, along said east-west half-section line, a distance of 1169.64 feet to 1 inch Mag Spike set, passing through an 8" steel pipe post found at a distance of 52.42 feet and passing through a 5/8" capped iron pin set at a distance of 1139.64 feet which marks the west right-of-way line of County Road 23, said spike being on the centerline of right-of-way of County Road 23 and also being the east line of Section One (1);

Thence South 00 degrees 00 minutes 00 seconds West, along said centerline of right-of-way and east section line, a distance of 2652.70 feet to a 3/8" iron pin found, said pin being the True Point of Beginning of the above described tract, containing 71.257 acres more or less, subject to all easements of record, of which 2.481 acres are in present right-of-way.

Basis of bearings based on County Road 23 as bearing South 00°00'00" West

Description prepared by:
Britt R. Havenar, P.E., P.S., Ohio P.S. No. 8266

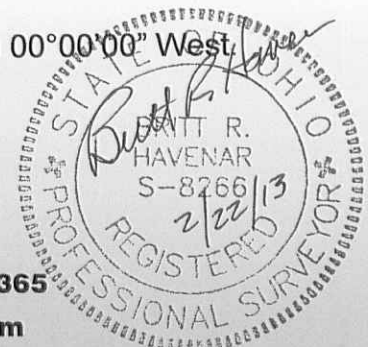

INDEXED ON MAP
8941 1D

**10860 Sidney-Freyburg Road • Sidney, Ohio 45365
(937) 492-7408 • abhavenar@embarqmail.com**

APPROVED

KIES SURVEY

SECTION 1, TOWN 7S, RANGE 7E

STOKES TWP., LOGAN CO., OHIO

BASIS OF BEARINGS:
BEARINGS ARE BASED C.R. 23 AS
BEARING S 00°00'00" W

REFERENCES

LOGAN COUNTY
ENGINEER'S SURVEYS:
NO. 351 NO. 8981
NO. 5461 NO. 9400
NO. 8724 NO. 9486
NO. 8830 NO. 9630

LEGEND

- 3/8" IRON PIN FOUND
 - 7/8" IRON PIN FND. IN MON. BOX
 - ⊙ PK NAIL FOUND
 - ⊗ RAILROAD SPIKE FOUND
 - ⊙ 8" STEEL PIPE POST FOUND
 - ⊙ MAG NAIL SET IN BRIDGE DECK
 - ⊙ 1" MAG SPIKE SET
 - 5/8" DIA. IRON PIN SET
- CAPPED "BRH PE PS,
OHIO PS 8266"

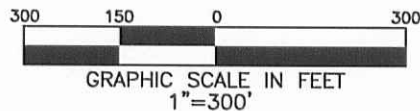

STONE IN MON. BOX

N.W. CORNER,
N.E. QUARTER,
SEC. 1, T-7S, R-7E.

☉ R/W C.R. 52
& SECTION LINE

N.E. CORNER,
N.E. QUARTER,
SEC. 1, T-7S, R-7E.

SHIRLEY ANN EBRIGHT &
BARBARA JANE SPATH
O.R. 153-874
70.16 ACRES

N.E. CORNER,
S.E. QUARTER,
SEC. 1, T-7S, R-7E.

HALF-SECTION LINE

S 89°29'01" E, 2339.28'

N.W. CORNER,
S.E. QUARTER,
SEC. 1, T-7S, R-7E.

IPS ON WEST BANK
OF OPEN DITCH

S 89°29'01" E, 1169.64'
52.42'
(PIPE ON E. BANK OF OPEN DITCH)

30.00'

N 00°01'18" E, 5310.23'

KENNETH G. SEGER
O.R. 734-575
67.749 ACRES

ANNA M. KIES
O.R. 428-181
71.257 ACRES
2.481 ACRES IN EX. R/W

2655.11'

HALF-SECTION LINE

N 00°00'39" E, 2653.91'

TRACT II
62.5 ACRES

S 00°00'00" W, 2652.70'

☉ R/W C.R. 23
& SECTION LINE
60' R/W & SECTION LINE

TRACT I
7.5 ACRES

S.W. CORNER,
S.E. QUARTER,
SEC. 1, T-7S, R-7E.

N 89°32'34" W, 1170.13'

N 89°32'34" W, 1170.13'

☉ R/W C.R. 225
50' R/W & SECTION LINE

S.E. CORNER,
S.E. QUARTER,
SEC. 1, T-7S, R-7E.

SURVEY OF 71.257 ACRES FOR ANNA KIES
IN STOKES TOWNSHIP. FEBRUARY 16, 2013.

Britt R. Havenar

BRITT R. HAVENAR, P.E., P.S.
OHIO REGISTERED PROFESSIONAL SURVEYOR #8266

HAVENAR ENGINEERING & SURVEYING, INC.
AMY L. HAVENAR, P.E.
BRITT R. HAVENAR, P.E., P.S.
10860 SIDNEY-FREYBURG ROAD
SIDNEY, OHIO 45365
(937) 492-7408
EMAIL: abhavenar@embarqmail.com

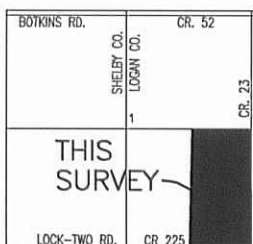

LOCATION MAP
NOT TO SCALE



INDEXED ON MAP
8941 1P