

Intersection of Road 43 - Road 33



Stamped Nov 12 1942 RMR.

G. C. M. Skeep
F. Hurst
R. McGarvey
9-18-42

16

Rd 43 Cor 25, 26, 31, 32 T3 R14
Found wooden hub, two large stones
below and brick around
Set concrete man 4" below surface

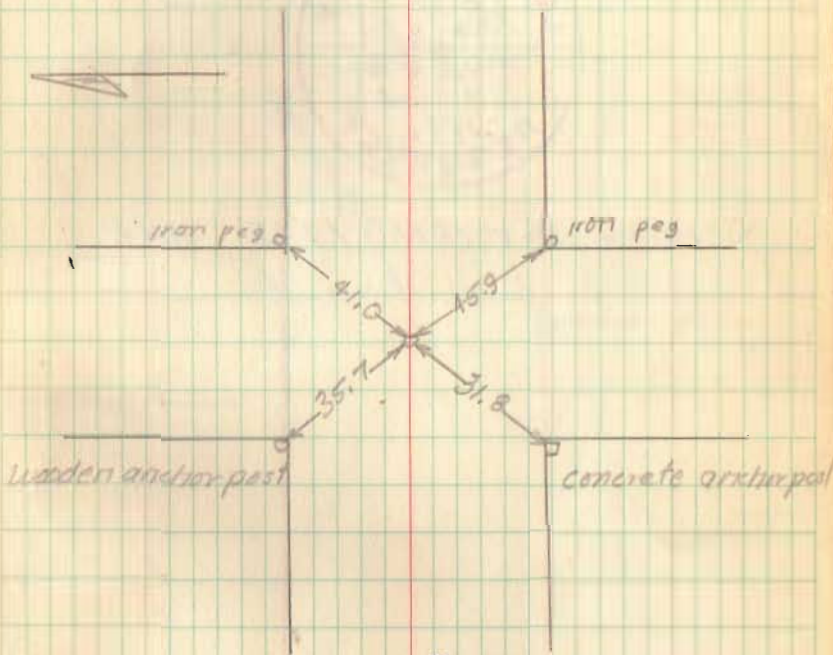

Elevation: 1009.27

INDEXED ON MAP

2632 Union &
Pleasant

INDEXED ON MAP