

in the west line of Davis's said survey, thence
 with said line, S 22° E 24 poles to 3 small hickories
 in said line, and corner to Samuel Scott's land
 thence with the north line of Scott's land S 82° E
 154 poles to a stake in a barren, thence $\text{r} 5^{\circ} \text{W}$
 3 poles to a stake in said barren thence $\text{r} 72^{\circ} \text{E}$
 66 1/2

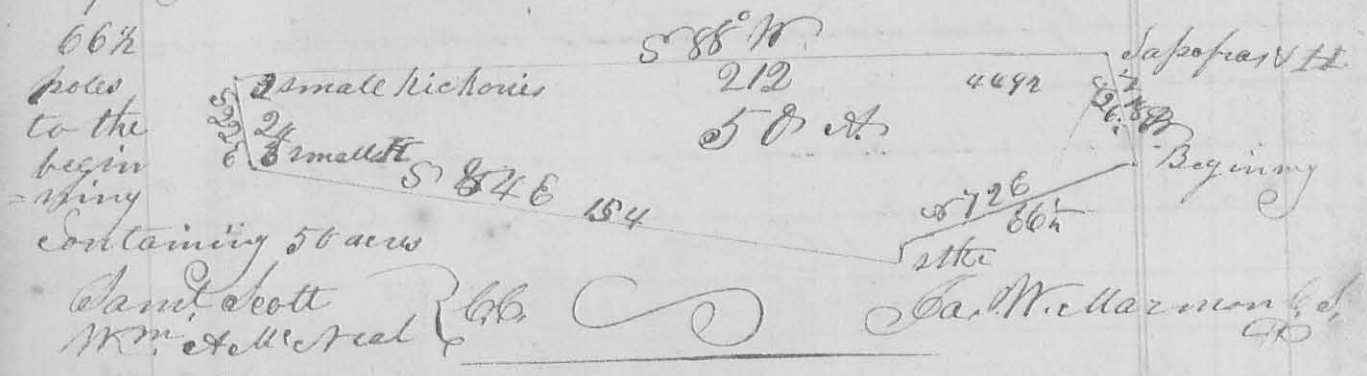

1st Mo (Jan.) 31st 1827 of Surveyor
 Surveyed six and a half acres of land for Lanson
 Curtis. Beginning at a stake in the line between
 Ebenezer Lane and Alex. Long where said line
 crosses the road leading from Zanesfield to Rep.
 -per Sandusky, thence $\text{r} 14^{\circ} \text{E}$ 17.1 poles to a stake
 on the west side of said road, thence $\text{r} 75^{\circ} \text{W}$ 16.9
 poles to a stake, thence $\text{r} 5^{\circ} \text{W}$ 7 poles to a stake near
 a small walnut thence $\text{r} 63^{\circ} \text{W}$ 40.3 poles to a stake
 thence $\text{r} 35^{\circ} \text{W}$ 20.2 poles to said line, thence with said
 line $\text{r} 75^{\circ} \text{E}$ 67.5 poles to the beginning, contain-
 -ing 6 1/2 acres; part of Surveyor 31st 27

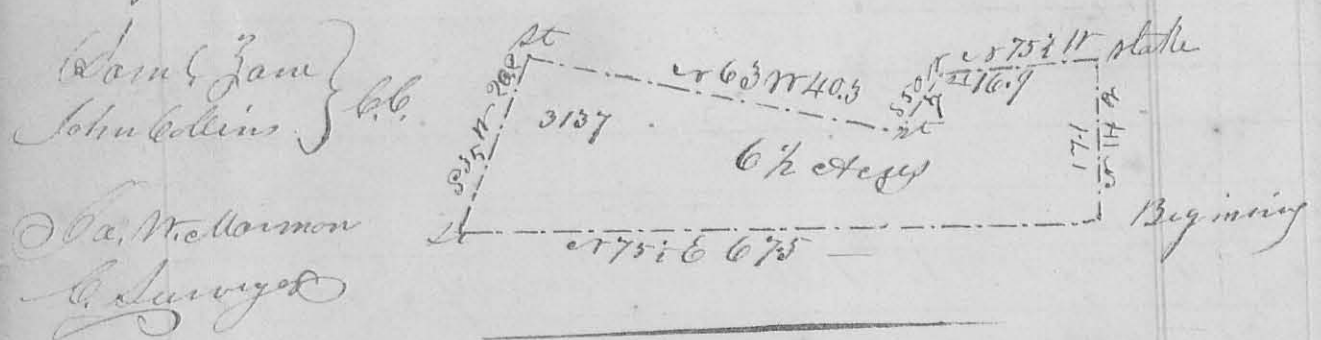

1st Mo (Feb.) 6th 1827 of Surveyor 63 (8198)
 Surveyed the S.W. quarter of Section 7 Town 3 Range
 14. E. of the great Miami for George St. Dunn. Beginning
 at the south west corner of said Sec. original bear-
 -ing trees now standing a white oak 22 inches in

58
 diameter & 69° E 51 links distant, a white oak 18
 inches in diameter & N 48° W 56 links distant, thence east
 with the south line of the section (allowing 1/2° easterly
 variation) 164 poles to the original quarter section corner
 a white oak 12 inches in diameter & S 9° W 112 links dist.
 a white oak 17 inches in diameter & S 7 1/2° E 104 links dist
 thence north 160 poles to a
 stone a white oak 26 inches
 diam. & S 85° E 31 links, a
 white oak 24 inch
 diam. 18 links north
 thence west thence west
 1/2° variation allowed
 164 poles to a stone in
 the west line, a small
 blue oak S 50° E 28 links distant, thence south 160 poles
 to the beginning containing 164 acres

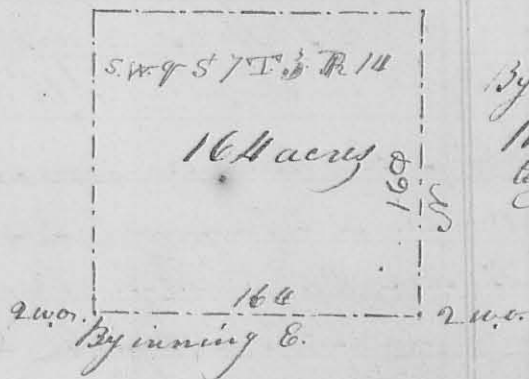

By a scale of
 110 poles
 to the inch

John Doke
 James Steakhouse } Ch. J. W. Harmon
 C. Surveys

2nd mo. (Feb) 7th 1827 Survey & Co. 64 (8198)

Surveyed 50 acres of land for James Craig: Beginning at
 the S. W. corner of section 7 Town. 3 Range 14 E. of the Great Mi-
 -amie a white oak 18 inches in diam. N 48° W 56 links dist.
 a white oak 22 inches in diam. & 69° E 51 links; thence east
 with the south line of said section (allowing 1/2° easterly
 variation) 164 poles to the original quarter section corner
 a white oak 15 in. in diam. & S 9° W 112 links dist thence
 a white oak 17 inches in diam. & S 7 1/2° E 104 links dist. thence
 north 148 1/2 poles to a stake
 thence west 164 poles to a stone
 and white oak 20 in. in diam.
 & N 74° W 9 links dist. 2 black
 oaks growing from one root
 south 22 links; thence with the west line of said sec. 148 1/2
 poles to the beginning containing 50 acres

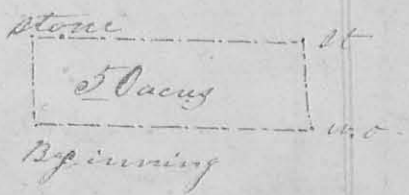

James Steakhouse } Ch. J. W. Harmon
 & John Doke } C. Surveys

D. W. M. (Feb.) 5th 1827 Survey No 65 (8198)

Surveyed the east half of sec 7 in Town 3 Range 14 E. N. S. for Alex. Duke Beginning at the S.W. corner of said half sec. a white oak 15 inches in diam. & 9th N. 12 links dist a white 17 in. in diam. & 7th E 104 links dist. Thence with the South line of said half sec. allowing ²/₃ Eastward variation) 157¹/₂ poles to a stake in a prairie a white oak 30 inches in diam. & 14th E 118 poles dist S.E. corner to said half sec. - Thence north 320 poles to the S.E. corner of said sec. a white oak 24 in. in diam. & 65th E 34 links dist - Thence west with the north

line of the sec. 156 poles to the original quarter sec. corner a black oak 110th E 31 links dist. a white oak east 33 links thence N. passing the center corner a stone & a white oak 28 links a white oak 20th E 21 links thence S 155 Thence South passing the center corner at 160 poles) 320 to the beginning - Division line - beginning at the center corner a stone. - a white oak 18 links a white oak 28th E 31 links - Thence east 155¹/₂ poles to a stake in the east line - containing in the whole 306 acres

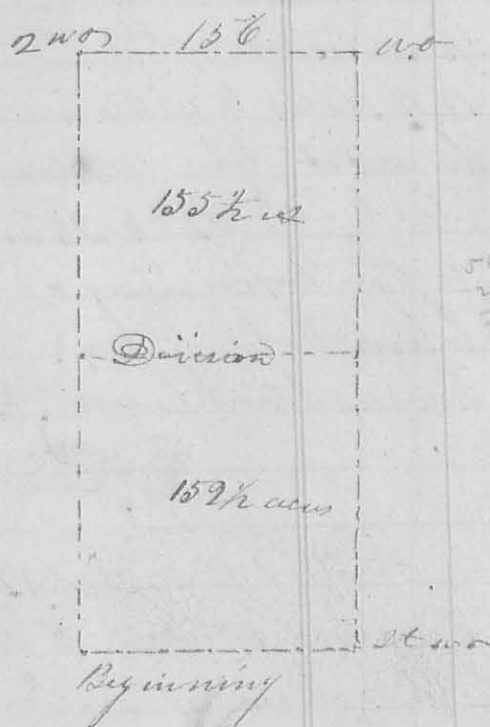

A. Craig }
John Duke } 66
J. W. Mearns }
Geo. }
Geo. }

D. W. M. (Feb.) 9th 1827 Survey No 66 (8199)

Surveyed half of the north west quarter of section 12 in Town 4 Range 13 E. N. S. for James Stackhouse Beginning at the north west corner of said sec. the original bearing has yet standing, a white oak 18 inches in diam. & 48th N 56 links dist, a white oak 22 inches in diam. & 69th E 51 links dist. Thence south with the original