

154 - thence between 23 & 24  $\text{S} 88\frac{1}{2}^{\circ} \text{W}$  320 poles, crossing a Spring branch, to the corner of 23, 24, 29, 30 a black oak  $\text{N} 11^{\circ} \text{E}$  9 links a black oak  $\text{N} 72^{\circ} \text{E}$  21 links - thence  $\text{N} 139$  poles to the gr. sec. corner between sec 24 & 30 a black oak  $\text{N} 76^{\circ} \text{W}$  12 links, a black oak north  $23$  links thence  $\text{S} 89\frac{1}{2}^{\circ} \text{E}$  320 poles, crossing the spring branch to the beginning con - taining 288 acres -

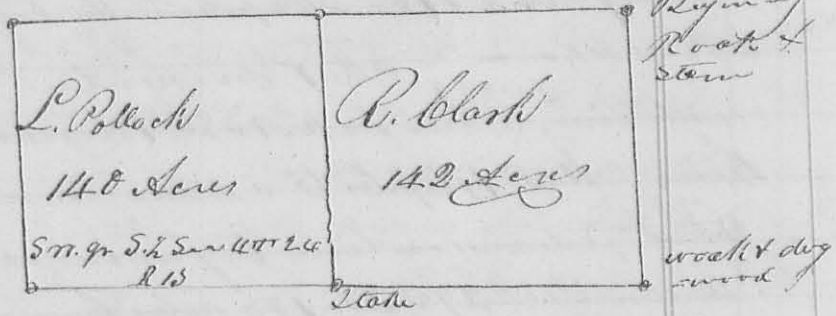

The division line begins at a stake in the south line of the sec. 160 poles from each corner & runs north 148 poles to a stake in the north line of the half sec. in the prairie - dividing the half sec. as above marked on the plat  
 James Pollock }  
 Robert Pittman } *J. C.* James Macammon & L. C.

1793  
 Saml. Moore - 9th mo. 27, Sept. 1832  
 Robt. Pittman }  
 Jno Macammon }  
 Wilson George }  
 Survey No 193  
 Surveyed Sec. 30. T. 4. R. 13. W. 1. For Samuel Moore, Robert Pittman, John Macammon & William George as follows - Beginning at a stake in a prairie the original of Secs 24 & 30 in T. 4. W. 1. thence  $\text{N} 88\frac{1}{2}^{\circ} \text{W}$  with the original line 320 poles to the corner of Secs 30 & 36 a stone in a prairie - thence 304 poles, passing the origin. - at gr. sec. corner between Secs 30 & 36 a bar oak  $\text{S} 22^{\circ} \text{E}$

29 links, a hickory East 12 links at 163 poles) 304 poles to the corner of Secs 29, 30, 35 & 36 original bearing trees a hickory  $\text{N} 76^{\circ} \text{E}$  14 links, a white oak  $\text{N} 72^{\circ} \text{W}$  33 links - thence between 29 & 30  $\text{S} 89\frac{1}{2}^{\circ} \text{E}$  320 poles passing the original

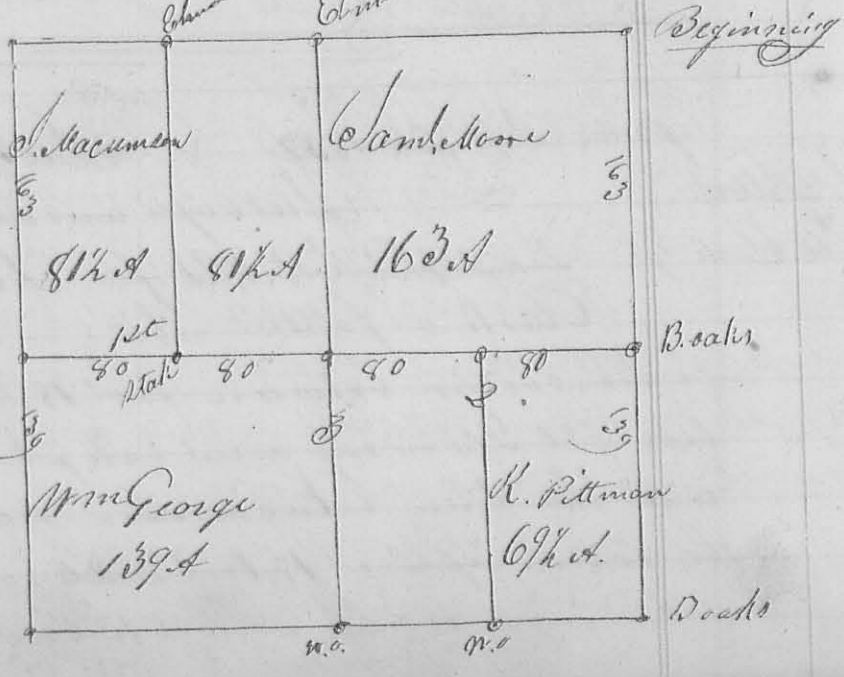

155  
 gr. Sec. corner at 160 poles, a W. oak (20 W 8 links  
 a white oak N 87° E 28 links) to the corner of Sec 23, 24, 29  
 & 30 a black oak N 11° E 9 links, a black oak N 72° E 21 links  
 thence between Sec 24 & 30 north 304 poles (passing the  
 gr. sec. corner at 139 poles) to the beginning containing  
 608 acy -

1st. The 1<sup>st</sup> division line begins at the original gr. sec.  
 corner in the line between Sec 29 & 30 - thence S 89° E at  
 80 poles set a stake in a prairie, at 160 poles set a stone in  
 a swamp at the centre of the sec., at 240 poles  
 set a stone on a hill side, 320 poles to the gr. sec. corner  
 between Sec 24 & 30 a black oak N 70° W 12 L. a black  
 oak north 23 L -

2nd. The 2<sup>nd</sup> division line begins at the stone  
 on the hill 80 poles west of the gr. sec. corner last named thence  
 South 139 poles to a white oak N 83° W 19 L in the south line  
 of the sec.

3rd. The 3<sup>rd</sup> line begins at the original gr. sec. corner  
 on the line between Sec 29 & 30 a W. oak - thence north  
 passed the stone in the swamp & centre of the sec. at 139 poles  
 304 poles to an elm in the north line of this sec 160 E

4th. 25 links - The 4<sup>th</sup> line begins in the north line of this  
 sec 80 poles east of the north west corner thence an elm N 80° W  
 12 links thence 163 poles to a stake in a prairie. All of which  
 may seen on the plat.

W. M. Marrison S. L. C.  
 Saml. Moore }  
 Wm Pittman } C. C.

184  
 D. Ashen }  
 J. Ashen }  
 Wm Pittman }  
 R. Clark }  
 Geo. McDonald }  
 Mrs. Wren et al }  
 9<sup>th</sup> mo. Sept, 28<sup>th</sup> 1832 } Survey 20 174  
 Surveyed and divided Sec. 23, T. 4 R. 13 N. R. 13.  
 as hereafter described for David Ashen, John Ashen  
 William Pittman Robert Clark John McDonald &  
 William Wren Beginning at the corner of  
 Secs. 17, 18, 23 & 24 a white oak S 38° W 13 links - a dog wood  
 N 85° E 26 L - thence on the line between Sec. 17 & 23  
 S 1/2 W 342 poles to the original corner of Secs. 16, 17, 22 &  
 23 a bur oak N 11° W 16 L - the other tree is across, which  
 is called for here - thence between Secs 22 & 23 -

8280

