

155  
 gr. sec. corner at 160 poles, a W. oak (20 W 8 links  
 a white oak N 87° E 28 links) to the corner of Sec 23, 24, 29  
 & 30 a black oak N 11° E 9 links, a black oak N 72° E 21 links  
 thence between Sec 24 & 30 north 304 poles (passing the  
 gr. sec. corner at 139 poles) to the beginning containing  
 608 acy -

1st. The 1<sup>st</sup> division line begins at the original gr. sec.  
 corner in the line between Sec 29 & 30 - thence S 89° E at  
 80 poles set a stake in a prairie, at 160 poles set a stone in  
 a swamp at the centre of the sec., at 240 poles  
 set a stone on a hill side, 320 poles to the gr. sec. corner  
 between Sec 24 & 30 a black oak N 70° W 12 L. a black  
 oak north 23 L -

2nd. The 2<sup>nd</sup> division line begins at the stone  
 on the hill 80 poles west of the gr. sec. corner last named thence  
 South 139 poles to a white oak N 83° W 19 L in the south line  
 of the sec.

3rd. The 3<sup>rd</sup> line begins at the original gr. sec. corner  
 on the line between Sec 29 & 30 a W. oak - thence north  
 passed the stone in the swamp & centre of the sec. at 139 poles  
 304 poles to an elm in the north line of this sec 160 E

4th. 25 links - The 4<sup>th</sup> line begins in the north line of this  
 sec 80 poles east of the north west corner thence an elm N 80° W  
 12 links thence 163 poles to a stake in a prairie. All of which  
 may seen on the plat.

W. M. Marrison S. L. C.  
 Saml. Moore }  
 Wm Pittman } C. C.

184  
 9<sup>th</sup> mo. Sept, 28<sup>th</sup> 1832 } Survey of 174  
 D. Ashen } Surveyed and divided Sec. 23, T. 4 R. 13 N. R. 13.  
 J. Ashen } as hereafter described for David Ashen, John Ashen  
 Wm Pittman } William Pittman Robert Clark John McDonald &  
 R. Clark } William Wren Beginning at the corner of,  
 Geo. McDonald } Secs. 17, 18, 23 & 24 a white oak S 38° W 13 links - a dog wood  
 Mrs Wren et al } N 85° E 26 L - thence on the line between Sec. 17 & 23  
 S 11° W 342 poles to the original corner of Sec. 16, 17, 22 &  
 23 a bur oak N 11° W 16 L - the other tree is across, which  
 is called for here - thence between Secs 22 & 23 -

8280

$r 89\frac{1}{2}^{\circ} N 322$  poles, passed a stone, the gr. sec. corner  
 at  $161\frac{1}{2}$  poles to the corner between sec. 22, 23, 28 & 29  
 a hickory  $S 24 N 22 L$ . a hickory  $N 76 W 21 L$ . Thence  
 $r 1^{\circ} E$ , with the line between 23 & 29 (crossed a road at  
 20 poles, passed the gr. sec. corner at 472 poles & red  
 oak.  $r 60 W 14 L$ , a black walnut  $r 68 E 21 L$ )  
 344 poles to the corner of sec. 23, 24, 29 & 30 a black  
 oak  $r 11 E 9 L$ . a black oak  $r 72\frac{1}{2} E 21 L$ . Thence  
 between sec. 23 & 24  $S 88\frac{3}{4} E 320$  poles to the corner  
 of sec. 17, 18, 23 & 24 a white oak  $r 38 W 13 L$ . a dogwood  
 $r 85 E 26 L$  is original corner - Thence between  
 sec. 17 & 23  $S 4 W$  with the old line 342 poles to the  
 beginning containing 688 acres -  
 Plat

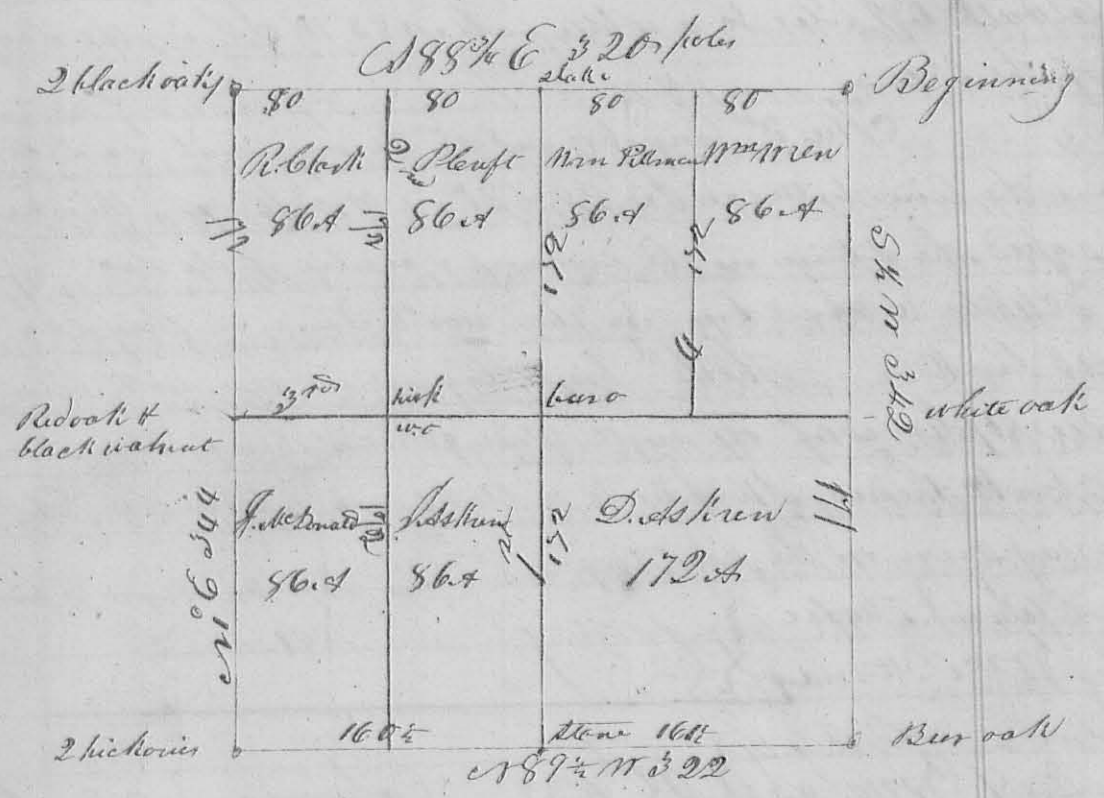

The 1<sup>st</sup> division line begins in the south line of the sec.  
 160 $\frac{1}{2}$  poles from the the southeast corner thereof, thence  
 $r 1^{\circ} E$  at 172 poles passed a bur oak  $r 72^{\circ} E 15 L$ . the center of the  
 sec. 342 poles to a stake in a prairie in the north line of the  
 sec. The 2<sup>nd</sup> division line begins at a hickory  $r 75^{\circ} E 6 L$  a  
 hickory south 64 in the north line 80 poles from the N.W.  
 corner of the sec. thence  $S 1^{\circ} W 172$  poles a white oak  $S 58 E 28 L$   
 a hickory  $r 63 E 17 L 344$  a stake in a prairie in the south line



of the sec 80 poles from the N.W. corner then of  
 The 3<sup>rd</sup> line begins at the gr. sec. corner in the west  
 line of the sec. Thence S 7 1/2° E 340 poles (passing the centre  
 corner) to a small white oak in the centre of the east  
 line - The 4<sup>th</sup> line begins at a stone 80 poles west  
 of the last named corner; Thence N 1° E 172 poles to a stone  
 a hickory S 25° W 26 L. in the north line 80 poles west of  
 the N.E. corner of the sec. The number of acres and the  
 owners names are marked on each division of  
 the plat

Saml. Moore }  
 David Piatt } C.C.

La Mettarron  
 Co, S, L, C.

Robert Clark 9<sup>th</sup> mo. (Sept. 29<sup>th</sup> 1832)

Survey # 195

Surveyed the east half of the N.E. qr of sec. 24 T4 R13  
 M. for Robert Clark. - beginning at the gr. sec. cor-  
 -ner between sec 18 & 24 a stone in a prairie from which  
 a red oak bears N 20° E 150 L. an original bearing tree  
 thence between sec 18 & 24 N 1/2° E 162 poles to the  
 N.E. corner of said sec. a white oak S 5° W 17 L  
 a white oak N 10 1/2° E 34 L - Thence N 89 1/2° W with  
 the original line 80 poles to a stone, a bar oak  
 S 70° E 68 L - Thence S 1/2° W

162 poles to a stake in a  
 prairie thence S 89 1/2° E  
 80 poles to the beginning,  
 containing 8 acres

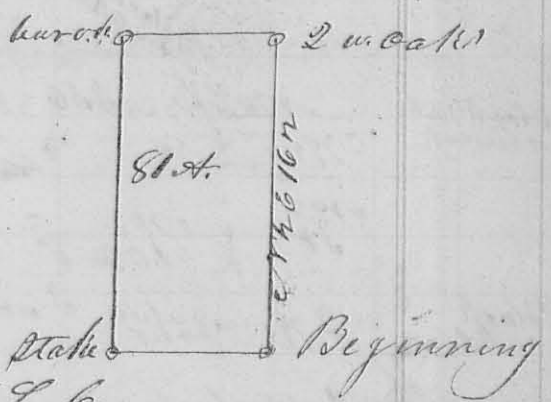

Layton Pollock }  
 John Wren } C.C.

La Mettarron Co, S, L, C.

Luke Simon }  
 by J. W. Farmer }

10 mo. 8<sup>th</sup> 1832 Survey # 196

resurveyed and divided Zedock  
 Walker's survey of 1816 for Luke Simon  
 at the request of his atty John W. Farmer  
 Beginning at a white a dead black oak in Lad.  
 Cow's line N.W. corner of Thomas Worthington's survey