

1-27-20



APPROVED



ARCHITECTURE • ENGINEERING • PLANNING
SURVEYING • CONSTRUCTION SERVICES

INNOVATIVE IDEAS
EXCEPTIONAL DESIGN
UNMATCHED CLIENT SERVICE

**NEWLAND TRACT 1
0.105 ACRE**

Lying in Section 36, Town 6 South, Range 8 East, South and East of the First Principal Meridian Distance, Washington Township, Logan County, Ohio (all records referenced herein refer to the Logan County Records of Deeds).

Being all of the Clarence O. Newland Lot 184 of Orchard Island (Plat Cabinet A, Slide 219) as deeded and described in Official Record 992, Page 942 and part of the Clarence Newland Lot 185 of said Island as deeded and described in Official Record 1367, Page 411 and being more particularly described as follows:

BEGINNING at an iron re-bar set at the westerly corner common to said Lot 184 and Lot 183 of said Island and being on the northeasterly right-of-way line of Maplewood Avenue (35 feet wide).

THENCE, with the southwesterly line of said Lots 184 and 185 and the northeasterly right-of-way line of Maplewood Avenue, **N 36°-23'-09" W**, a distance of **59.97 feet** to an iron re-bar set;

THENCE, with a new division line through said Lot 185, **N 53°-36'-51" E**, a distance of **76.27 feet** to an iron re-bar set on the easterly line of said Lot 185 and the southwesterly right-of-way line of a 15 feet wide alley;

THENCE, with the easterly line of said Lots 185 and 184 and the southwesterly right-of-way line of said alley, **S 36°-36'-51" E**, a distance of **59.97 feet** to an iron re-bar set at the easterly corner common to said Lots 184 and 183;

THENCE, with the line common to said Lots 184 and 183, **S 53°-36'-51" W**, a distance of **76.51 feet** to the **POINT OF BEGINNING**.

Containing **0.105 acre**, more or less.

Iron rebar set, where indicated, are 30 inches in length, 5/8 inch in diameter with a plastic I.D. cap stamped "DLZ OHIO INC."

INDEXED ON MAP
1714

117 N Madriver St, Bellefontaine, OH 43311 | OFFICE 937.593.7335 | ONLINE WWW.DLZ.COM



INNOVATIVE IDEAS
EXCEPTIONAL DESIGN
UNMATCHED CLIENT SERVICE

Property is subject to any and all previous easements and rights-of-way of record.

Bearings and distances, described herein, are derived from GPS observations based on Grid North, Ohio State Plane Coordinate System, North Zone, NAD83 (2011, Epoch 2010), with the southwesterly right-of-way line of Maplewood Avenue, having a bearing of S 36°-23'-09" E. Distances are expressed in U.S. Survey Feet. All other measurements are from angles and distances measured in a field survey by DLZ on January 23, 2020.

Description prepared by:

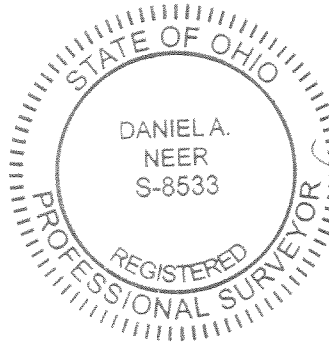

Daniel A. Neer
Daniel A. Neer

Professional Surveyor No. 8533

January 23, 2020

2020-2001.00



1-27-20



APPROVED



ARCHITECTURE • ENGINEERING • PLANNING
SURVEYING • CONSTRUCTION SERVICES

INNOVATIVE IDEAS
EXCEPTIONAL DESIGN
UNMATCHED CLIENT SERVICE

**NEWLAND TRACT 2
0.105 ACRE**

Lying in Section 36, Town 6 South, Range 8 East, South and East of the First Principal Meridian Survey, Washington Township, Logan County, Ohio (all records referenced herein refer to the Logan County Records of Deeds).

Being part of the Clarence Newland Lot 185 of Orchard Island (Plat Cabinet A, Slide 219) and all of Lot 186 of said Island as deeded and described in Official Record 1367, Page 411 and being more particularly described as follows:

BEGINNING at an iron re-bar set at the westerly corner common to said Lot 186 and Lot 187 of said Island and being on the northeasterly right-of-way line of Maplewood Avenue (35 feet wide).

THENCE, with the line common to said Lots 186 and 187, **N 53°-36'-51" E**, a distance of **76.04 feet** to a point at the easterly corner common to said Lots 186 and 187 and being on the southwesterly right-of-way line of a 15 feet wide alley, said point referenced by a 1-1/2 inch iron pipe found bearing **N 53°-29'-05" E**, a distance of 0.41 feet;

THENCE, with the easterly lines of said Lots 186 and 185 and the southwesterly right-of-way line of said alley, **S 36°-36'-51" E**, a distance of **59.97 feet** to an iron re-bar set;

THENCE, with a new division line through said Lot 185, **S 53°-36'-51" W**, a distance of **76.27 feet** to an iron re-bar set on the westerly line of said Lot 185 and the northeasterly right-of-way line of said Maplewood Avenue;

THENCE, with the westerly line of said Lots 185 and 186 and the northeasterly right-of-way line of said Maplewood Avenue, **N 36°-23'-09" W**, a distance of **59.97 feet** to the **POINT OF BEGINNING**.

INDEXED ON MAP
1714

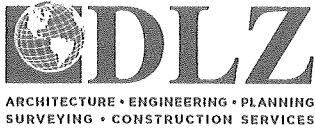

INNOVATIVE IDEAS
EXCEPTIONAL DESIGN
UNMATCHED CLIENT SERVICE

Containing **0.105 acre**, more or less.

Iron rebar set, where indicated, are 30 inches in length, 5/8 inch in diameter with a plastic I.D. cap stamped "DLZ OHIO INC."

Property is subject to any and all previous easements and rights-of-way of record.

Bearings and distances, described herein, are derived from GPS observations based on Grid North, Ohio State Plane Coordinate System, North Zone, NAD83 (2011, Epoch 2010), with the southwesterly right-of-way line of Maplewood Avenue, having a bearing of S 36°-23'-09" E. Distances are expressed in U.S. Survey Feet. All other measurements are from angles and distances measured in a field survey by DLZ on January 23, 2020.

Description prepared by:

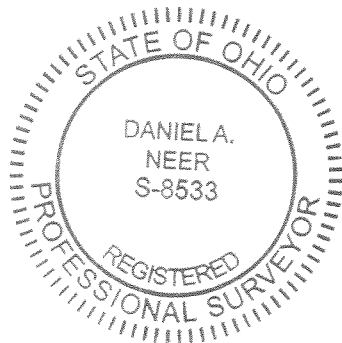

Daniel A. Neer
Daniel A. Neer

Professional Surveyor No. 8533

January 23, 2020

2020-2001.00

