

LEGEND:

- Denotes Irons.
- † Denotes Phone poles.
- ⊢ Denotes Electric poles.
- ⊣ Denotes utility pole carrying phone & electric.

NOTES:

1. Gas is on the east side of Rush Ave.. The D.P.&L.Co. will bring the gas across Rush Ave. to the approx area needed. The gas is a 3" low pressure line.
2. The sides setback line are 12.0' minimum, but the two must total 30.0'.

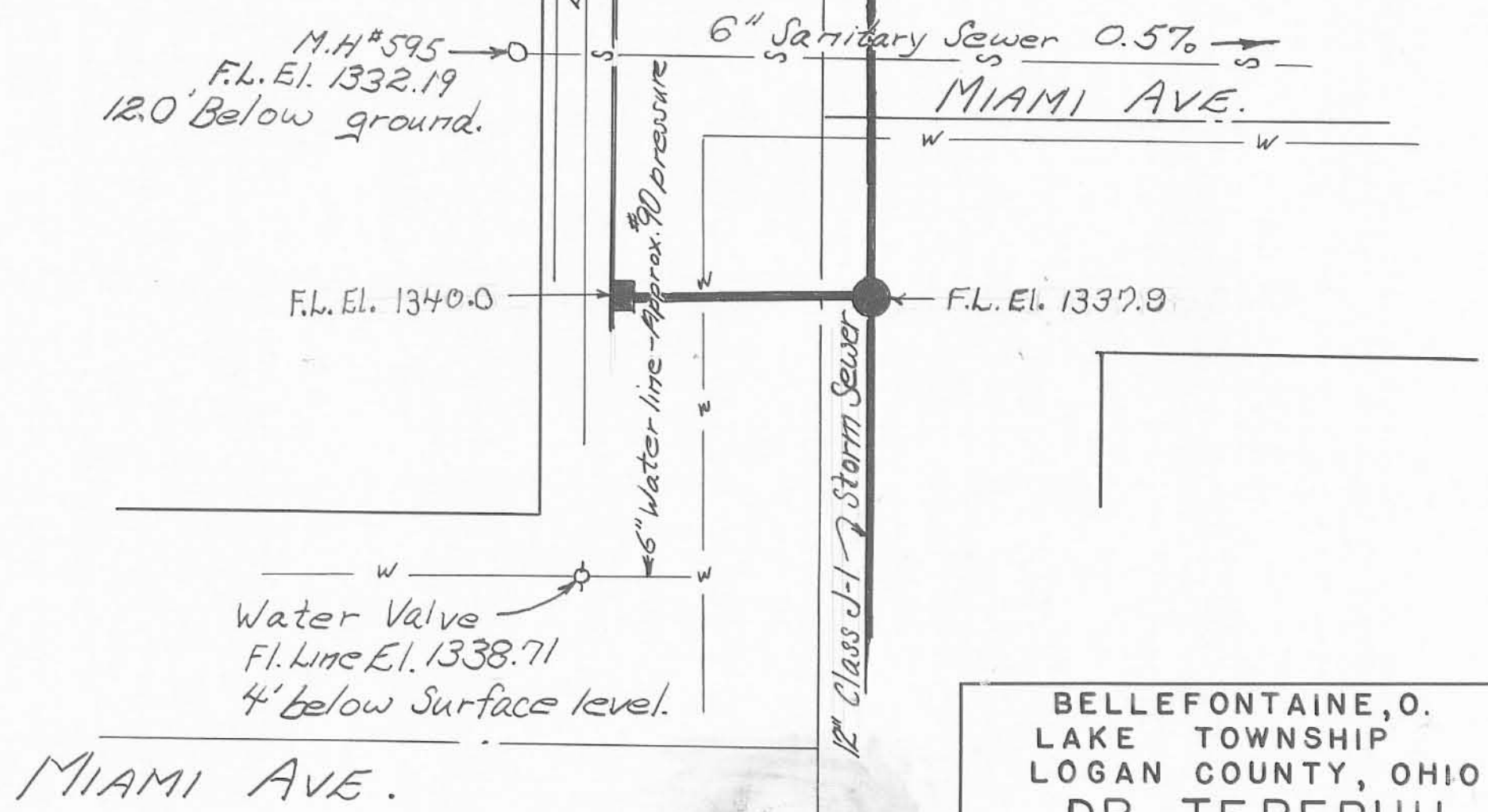

BELLEFONTAINE, O.
 LAKE TOWNSHIP
 LOGAN COUNTY, OHIO
DR. TEREBUH
 OWEN K. SHIRK; SURVEYOR 4271
 BELLEFONTAINE, OHIO
 1" = 20' MAR., 1967