

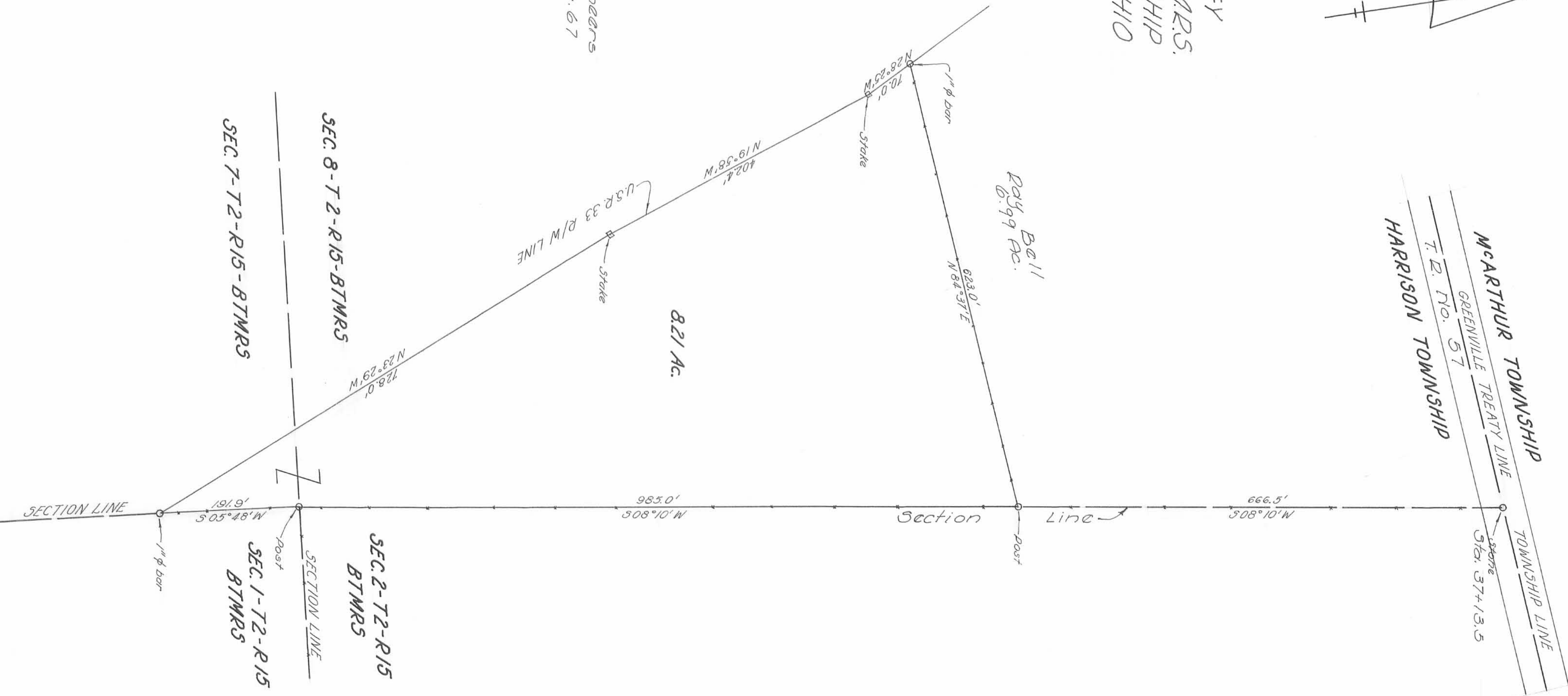

McKINNON SURVEY  
SEC. 7-8 T-2 R-15 B.M.R.S.  
HARRISON TOWNSHIP  
LOGAN COUNTY, OHIO  
MARCH 11, 1967  
SCALE 1" = 100'

REFERENCE  
Logan County Engineers  
Field Book 598, Pg. 67



  
Dan L. Dodson  
Reg. Surveyor No. 4270  
Bellevue, Ohio