

CHANNEL

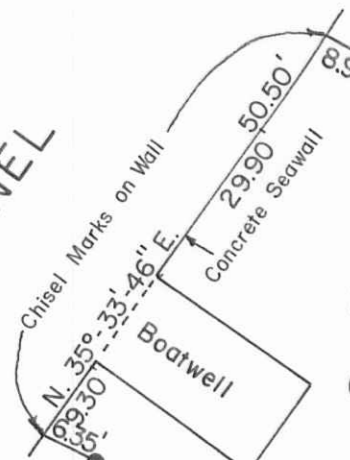

3,071.780<sup>sq</sup>  
or  
0.070 Acres

4,248.370<sup>sq</sup>  
or  
0.098 Acres

44.75'  
51.10'  
N. 64°-00'-00" W.

N. 56°-58'-21" E. Lot

100.00'  
151.10'

41

N. 26°-00'-00" E.  
Basis of Bearing

BEECHWOOD AVE. - 40'

58.29'

142.80'  
70.00'

42

S. 64°-00'-00" E.  
72.80'  
63.90'

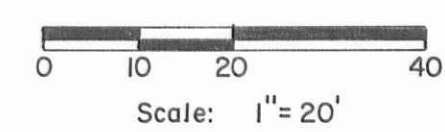
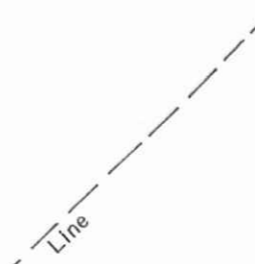

Per. Par. No. 36-019-10-01-042.000  
Lot No. 41  
Ora Newland, Jr. et ux.  
Vol. No. 371 P. 626 (7-18-1977).  
Vol. No. 371 P. 963 (7-31-1977).

SYMBOLS:  
⊙ - 1" Iron Pipe Fd.  
● - 5/8" x 30" Rebars Set.

Total Tract - 7,320.150<sup>sq</sup> or 0.168 Acres.

NEWLAND SURVEY - Lot No. 41 and Extension Thereto,  
Ferwood Subdivision No. 1 - Long Island, V.M.S. No. 13393,  
Richland Township, Logan County, Ohio.

SCALE: 1" = 20' APPROVED BY: DRAWN BY DEG  
DATE: 8-4-1994 REVISED

*Daniel E. Gilbert*  
Daniel E. Gilbert, P.S.  
Reg. Sur. No. 5402

DRAWING NUMBER  
094-027



Reference:  
Fernwood Subdivision No. 1 (7-11-1923).  
Plat Cab. A Slide 179.

INDEXED ON MAP  
8896

S-788