

PLAN
 REVISIONS
 DATE
 DRAWN BY
 CHECKED BY
 NO.

PROFILE
 REVISIONS
 DATE
 DRAWN BY
 CHECKED BY
 NO.

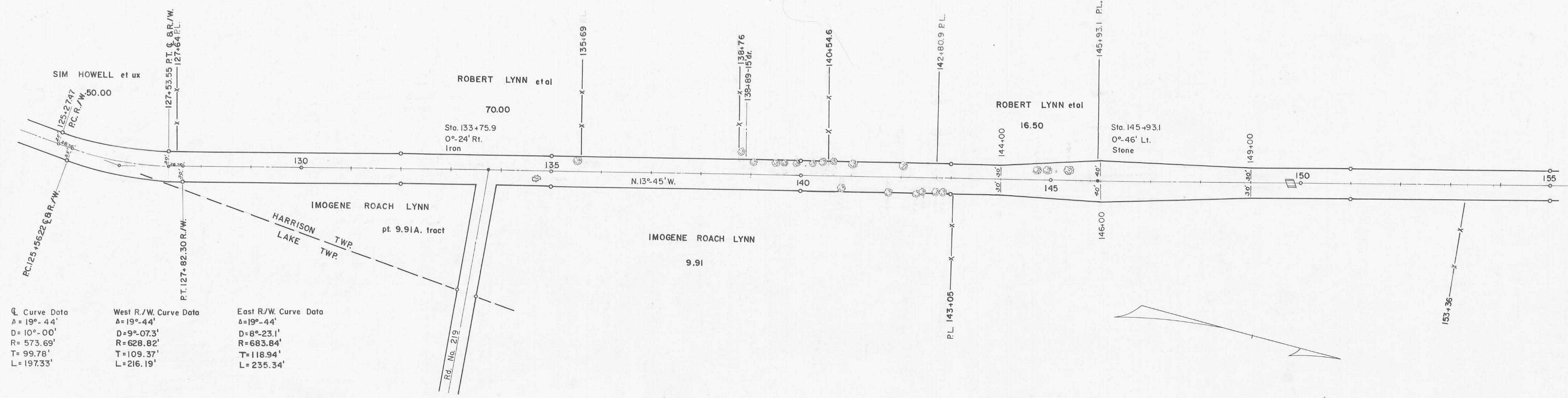

BM₄ RR spike E. side
 12" Elm, 12' above ground
 Lt. Sta. 127+60 Elev. 1226.97

BM₅ RR spike in S. root
 12" Maple, 2' from trunk
 Lt. Sta. 139+05 Elev. 1213.31

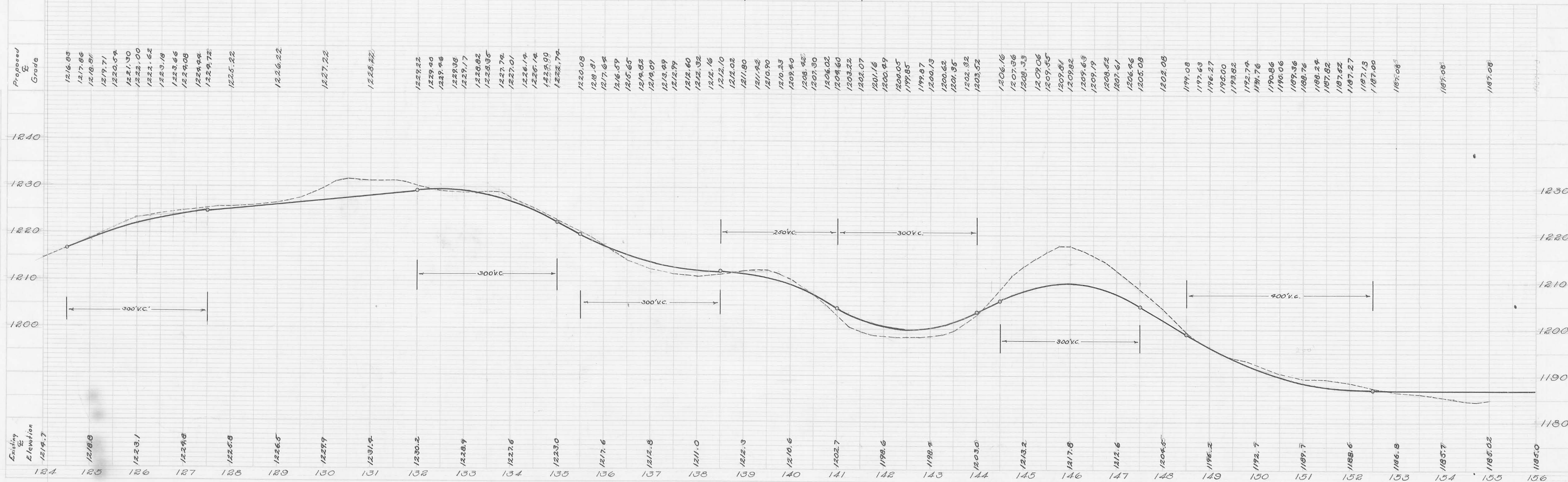

X-56-A

X-56-A

PLAN
 SURVEYED BY
 PLOTTED BY
 NOTE BOOK NO. & DATE
 CHECKED BY

PROFILE
 SURVEYED BY
 PLOTTED BY
 NOTE BOOK NO. & DATE
 CHECKED BY

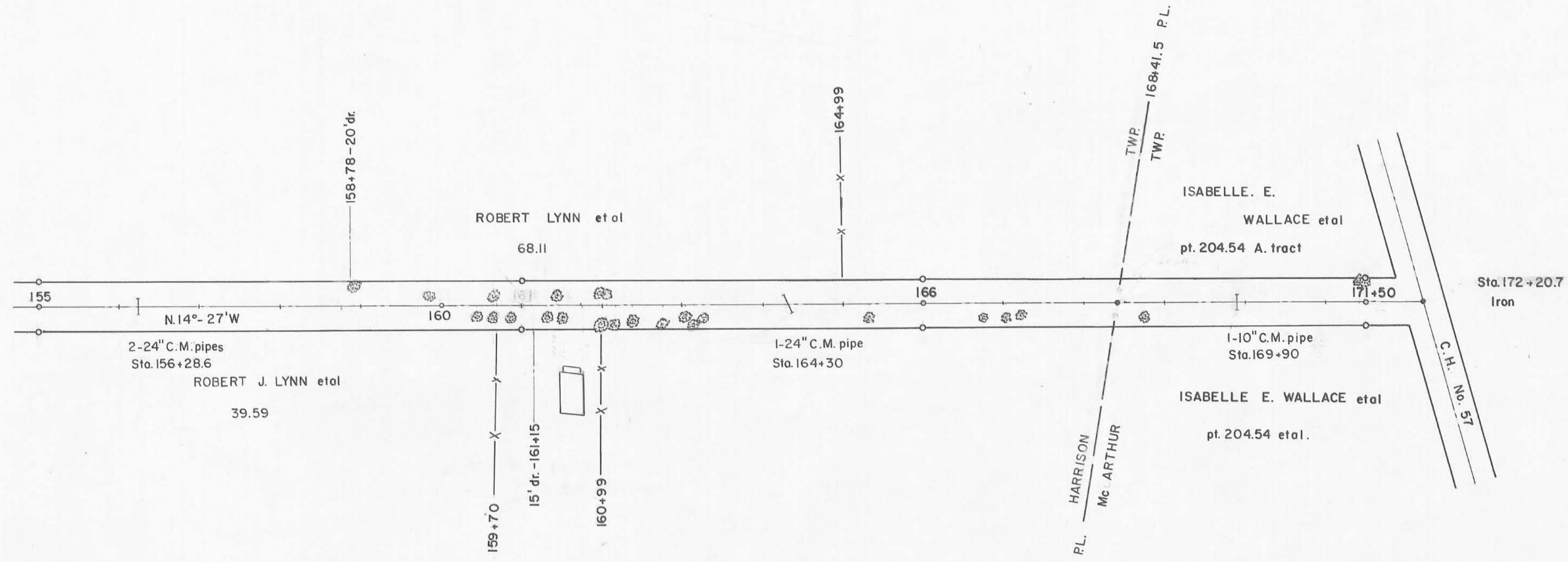

B.M. R.R. spike in N.E. root
 of 24" Maple Lt. of Sta.
 Elev. 1198.13

B.M. R.R. spike 90' Lt. of
 Sta. C.H. No. 56
 Elev. 1201.07

U.S.G.S. B.M. S.E. cor.
 S.R. 68 & C.H. 57, Iron post
 stamped "1299" Elev. - 1279.25'

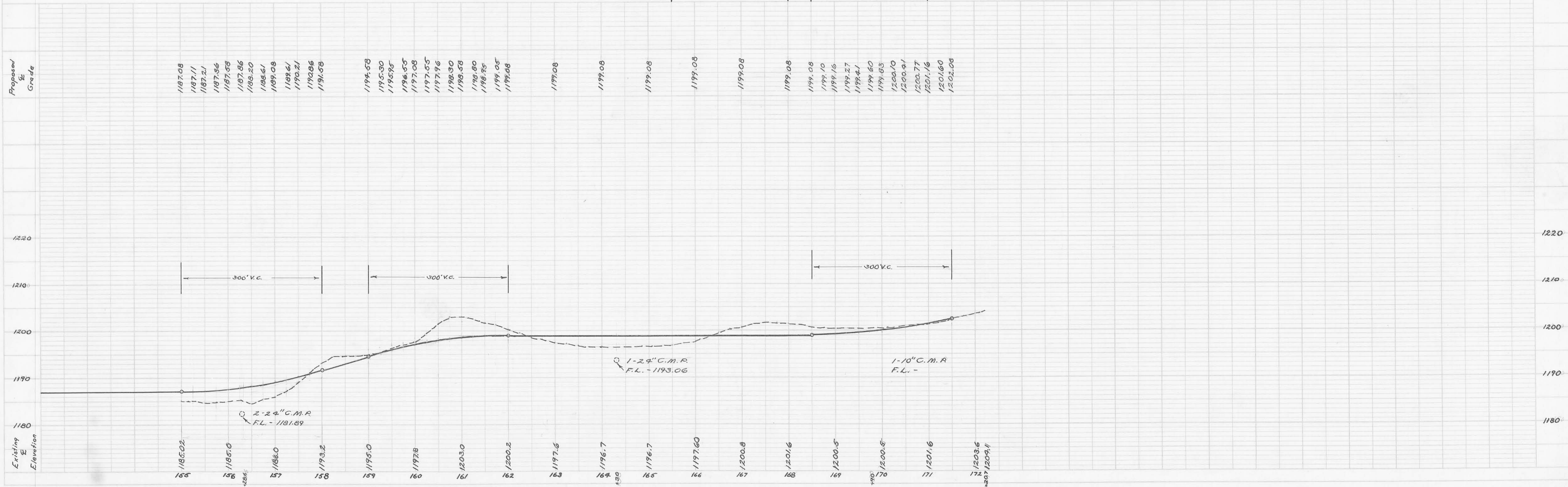

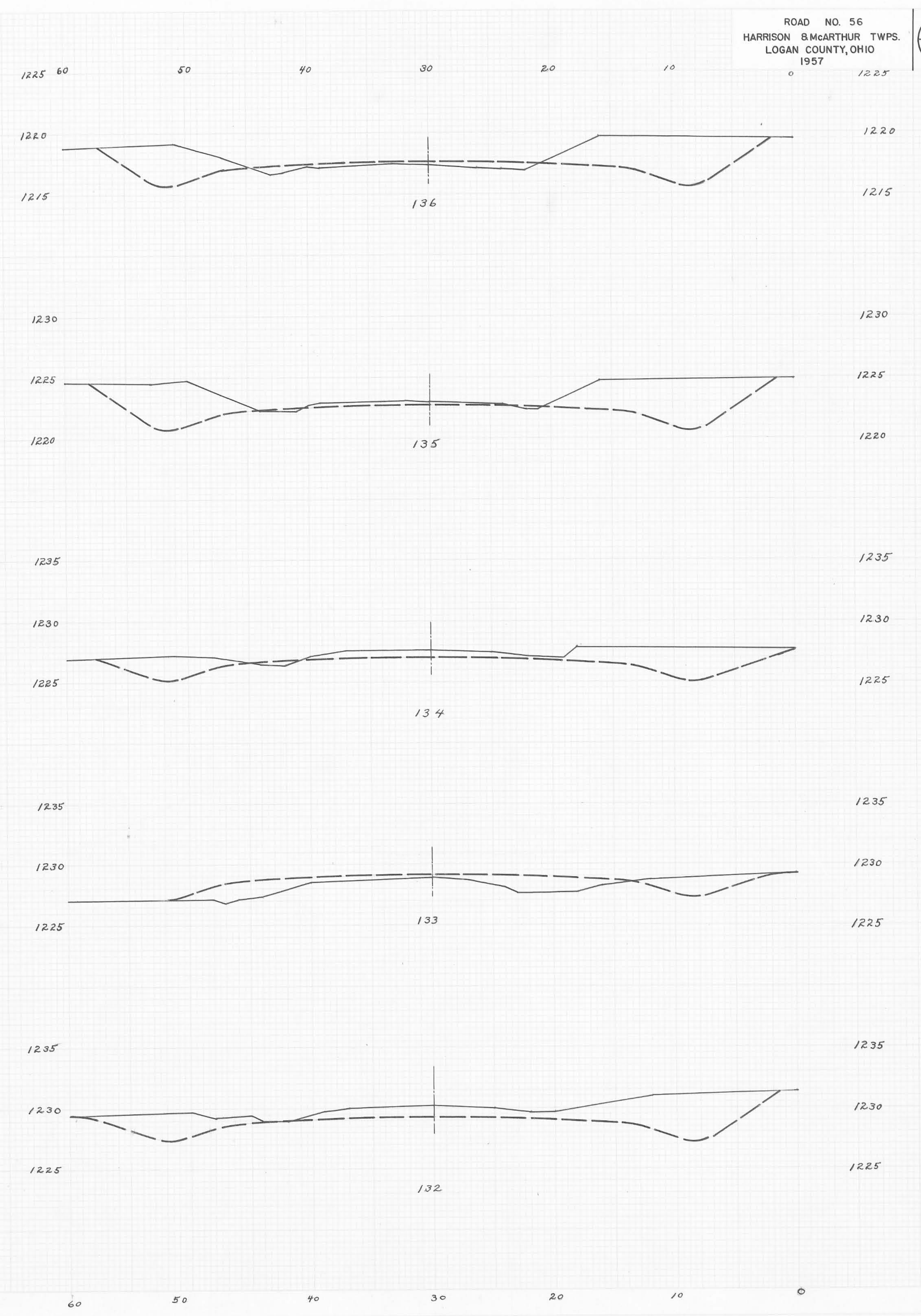
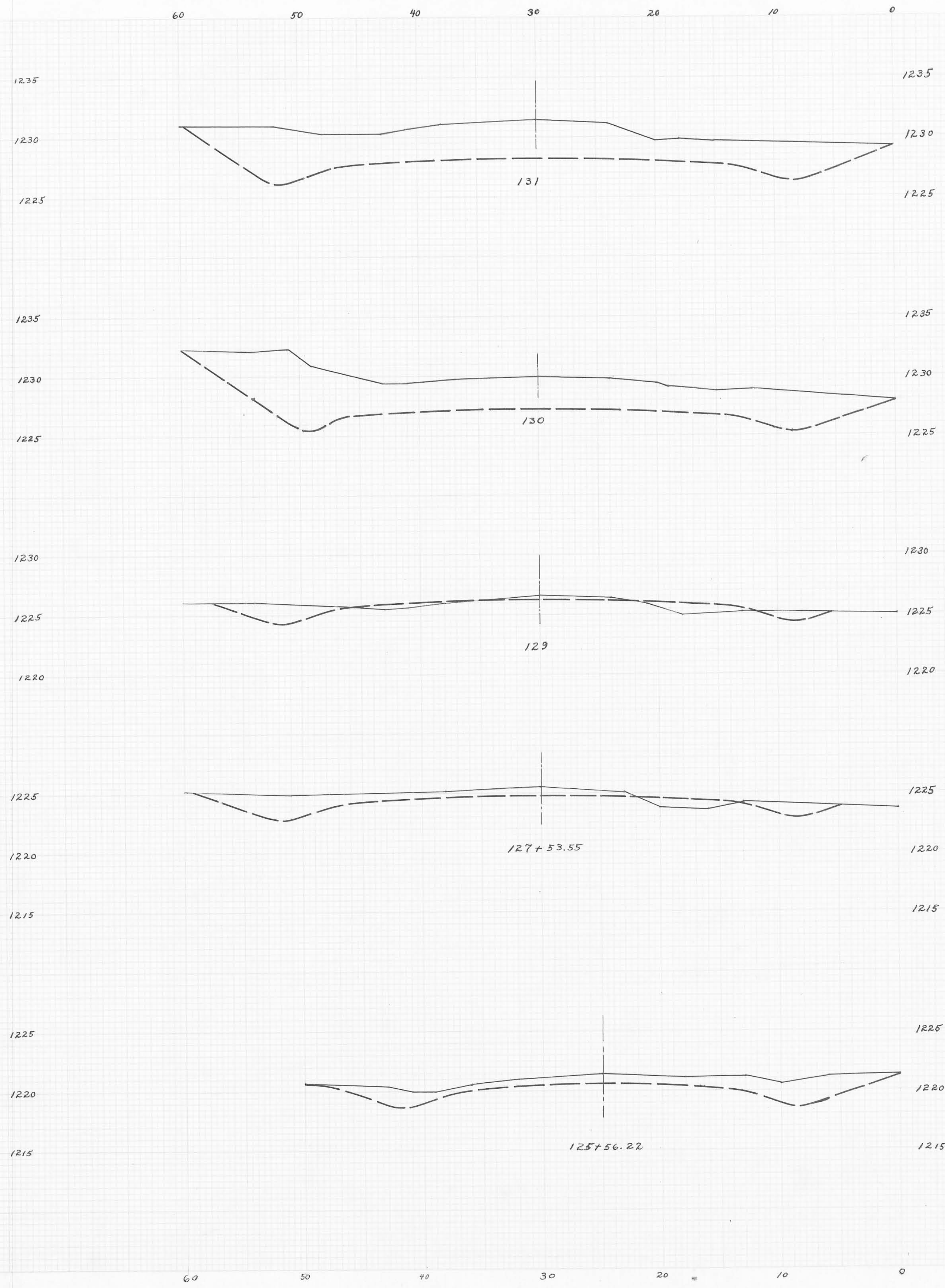

FINAL SURVEY

ORIGINAL SURVEY

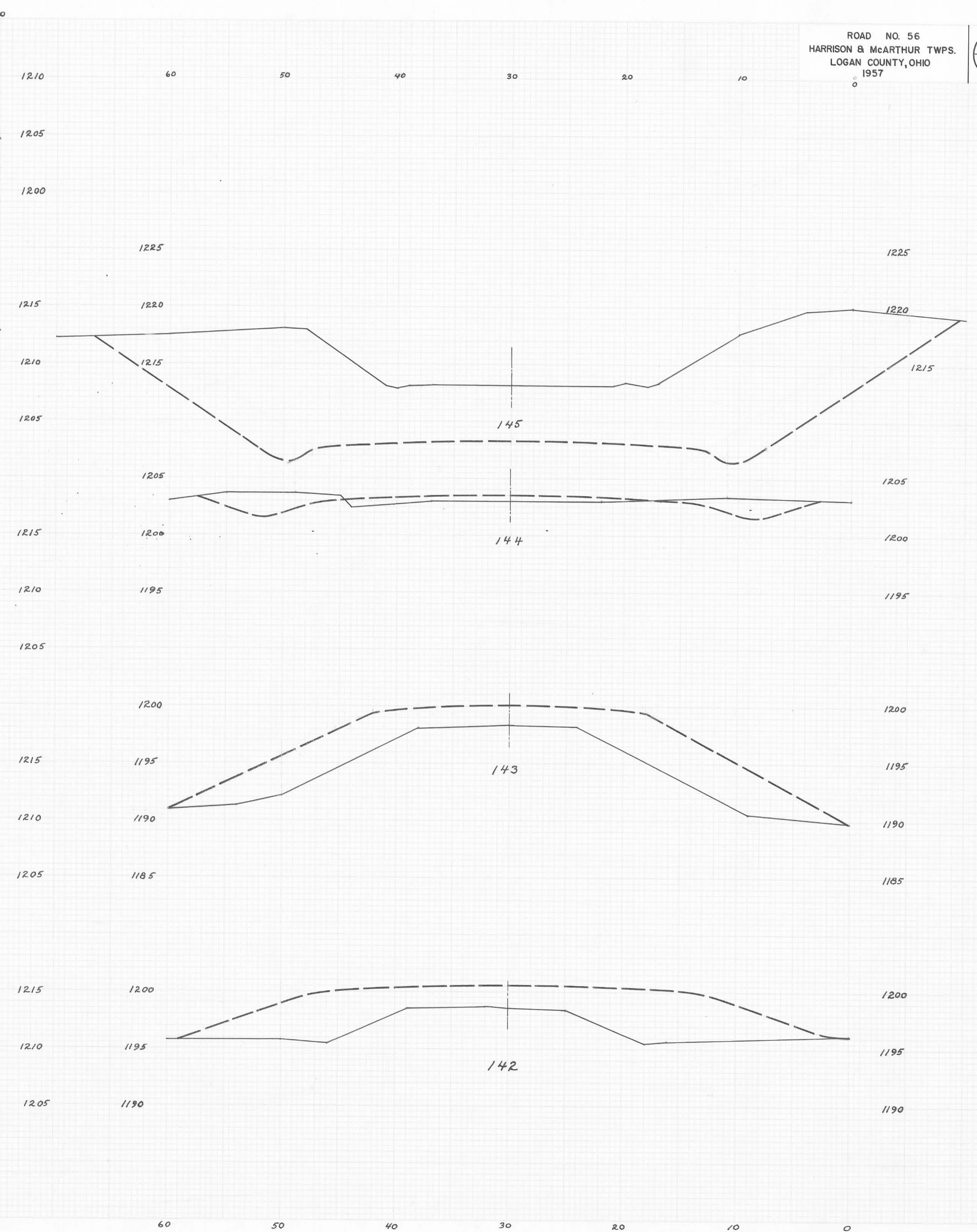
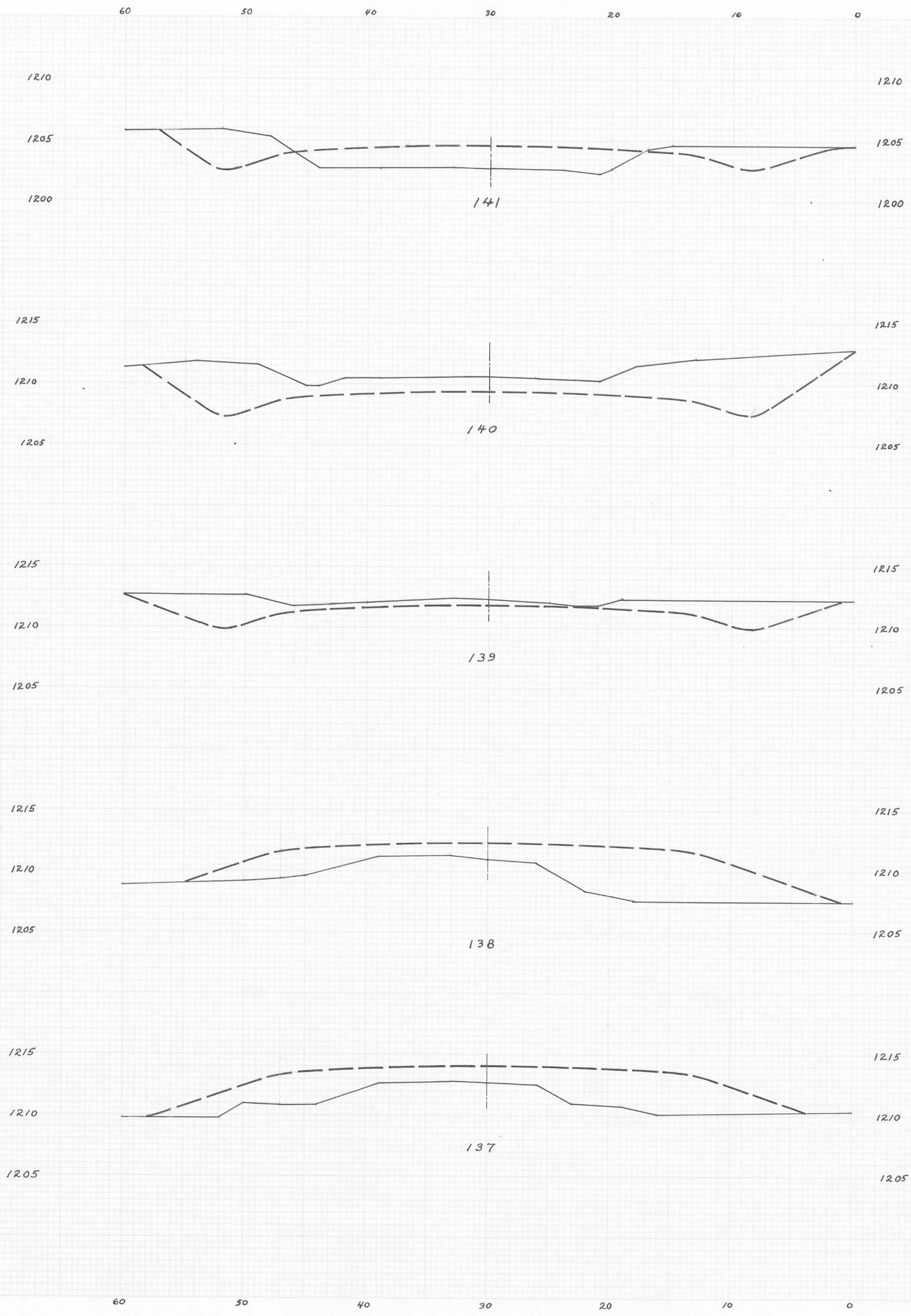

ORIGINAL SURVEY
 HARRISON & McARTHUR TWP.
 LOGAN COUNTY, OHIO
 1957

ORIGINAL SURVEY
 HARRISON & McARTHUR TWP.
 LOGAN COUNTY, OHIO
 1957

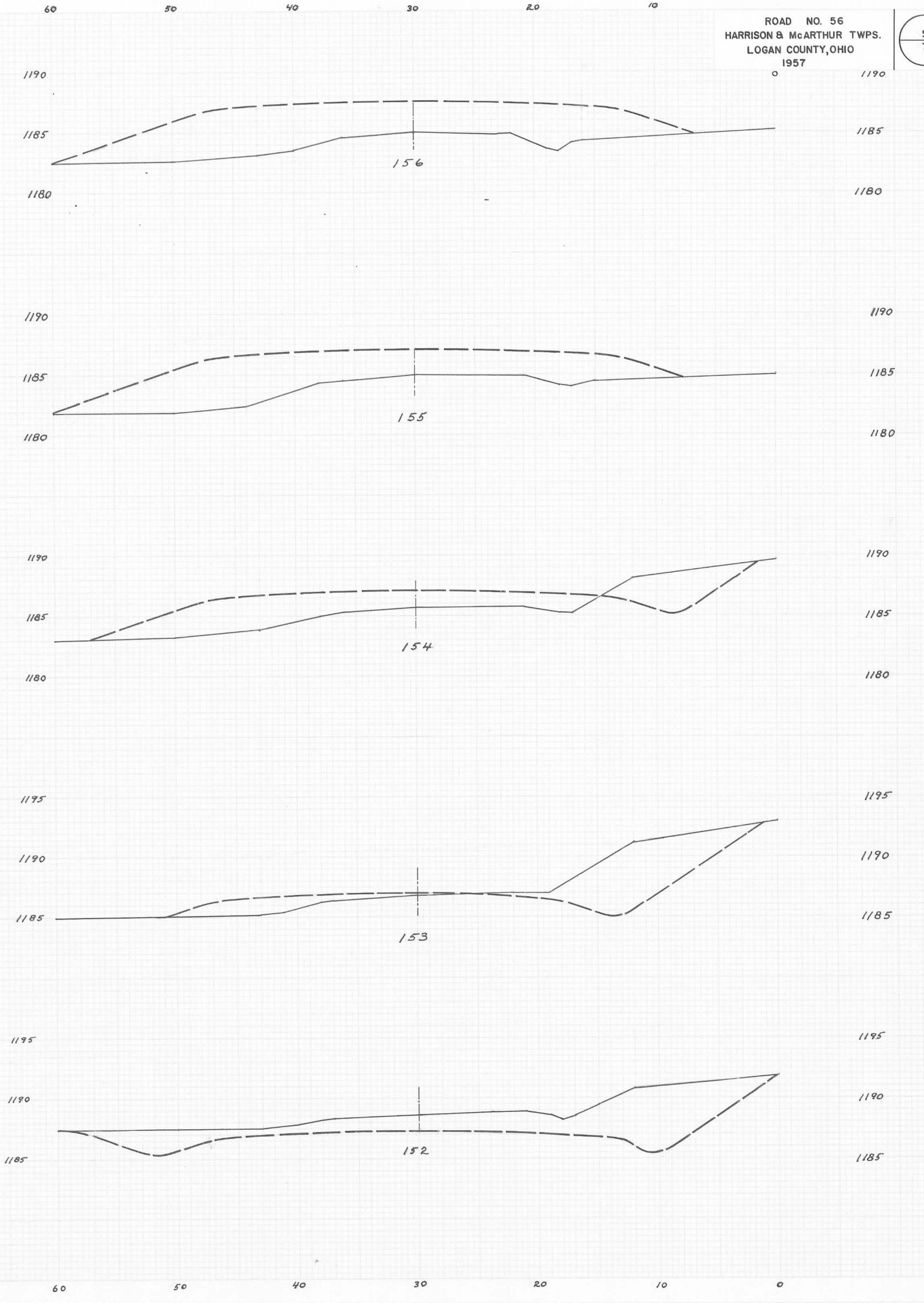
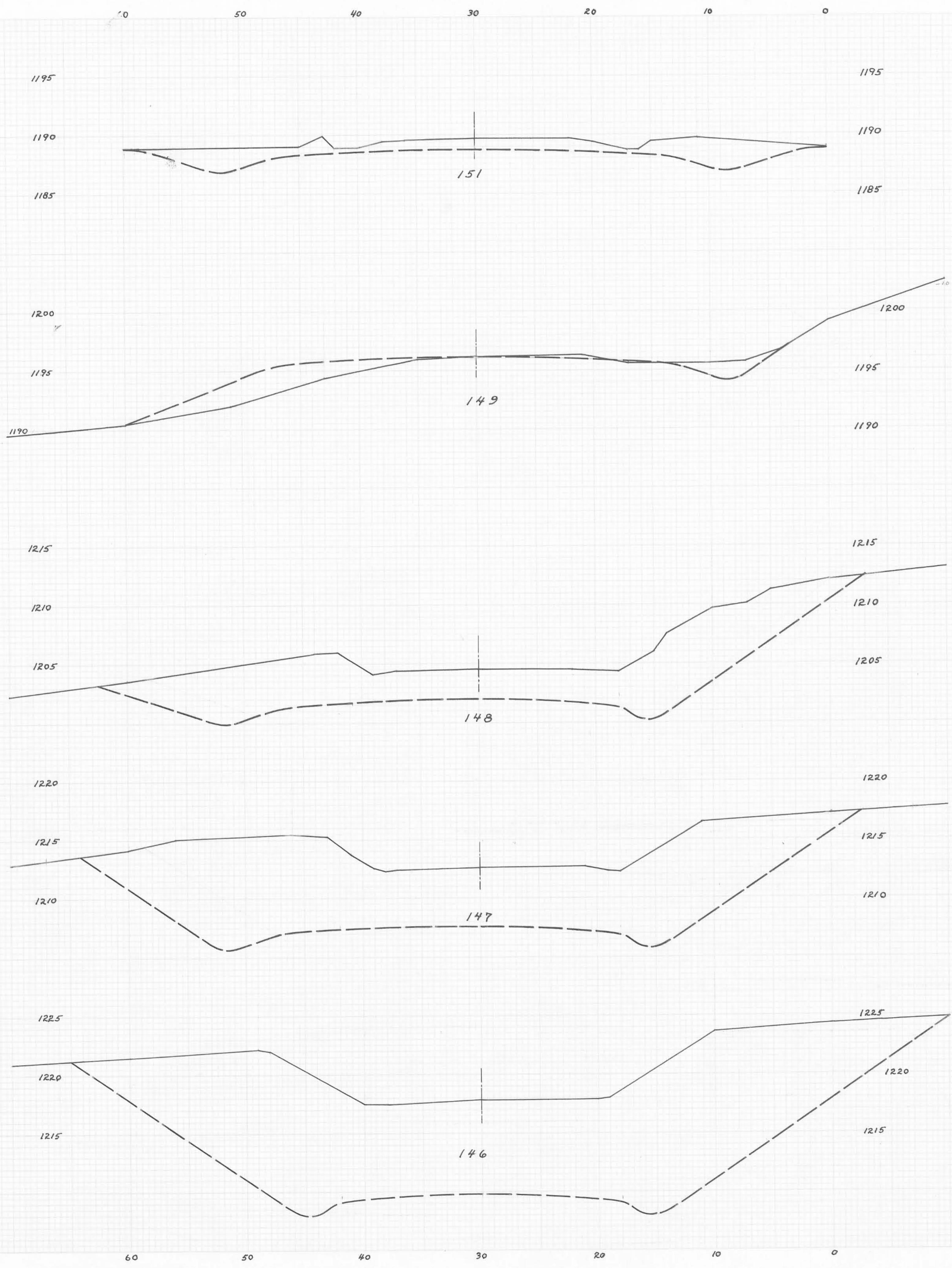

FINAL
 SURVEY

ORIGINAL
 SURVEY

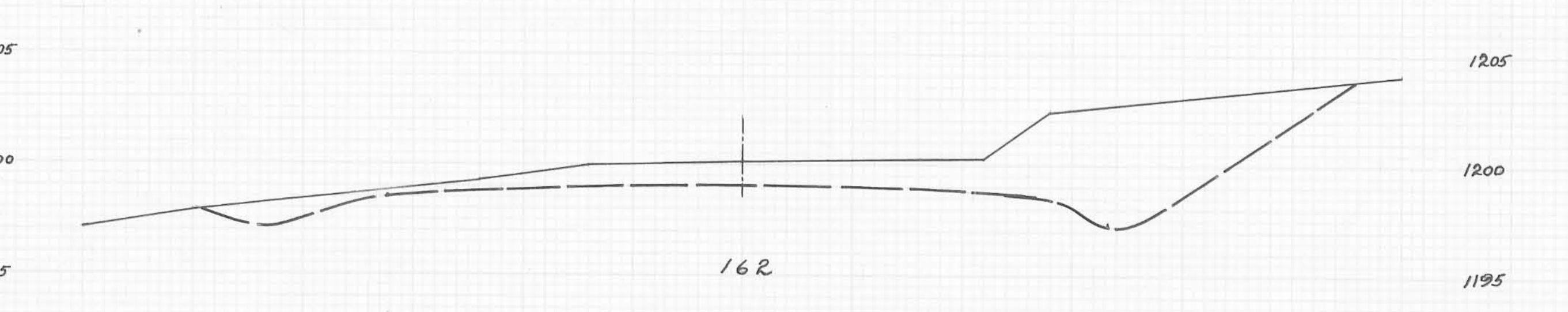
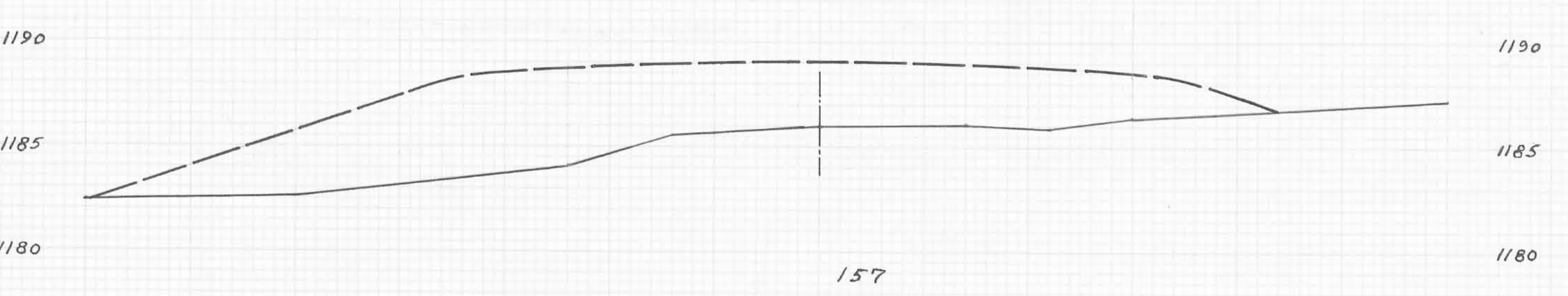
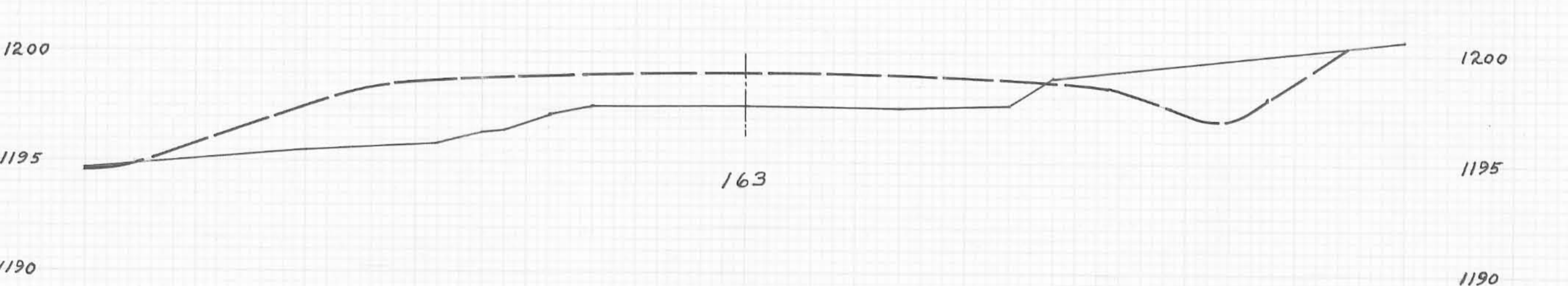
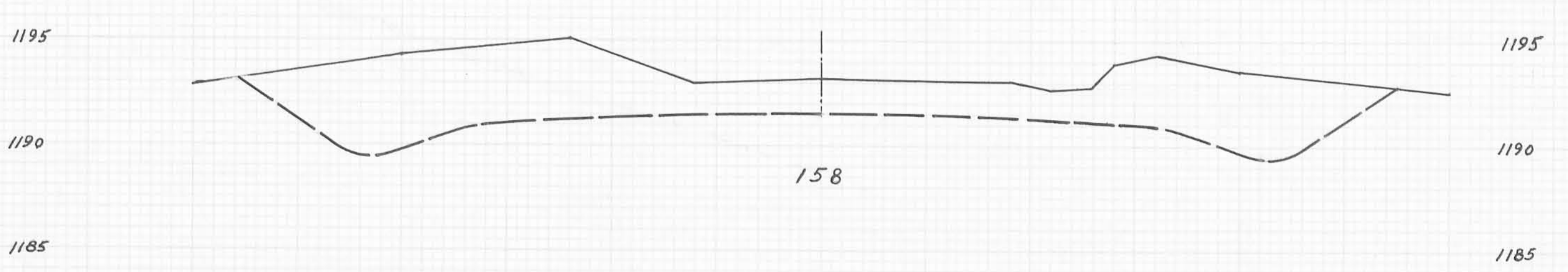
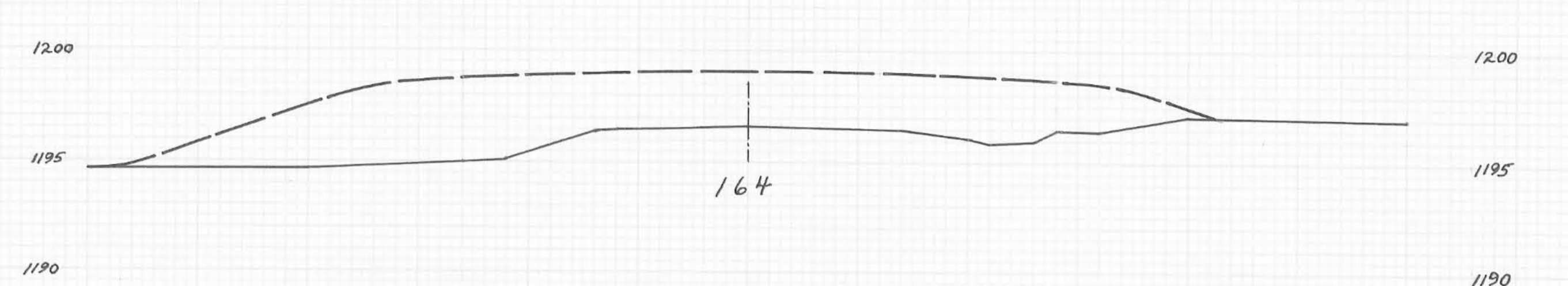
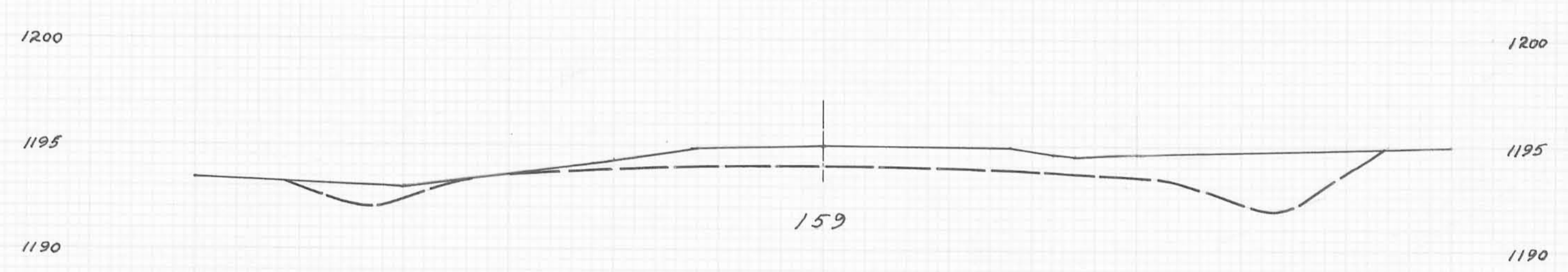
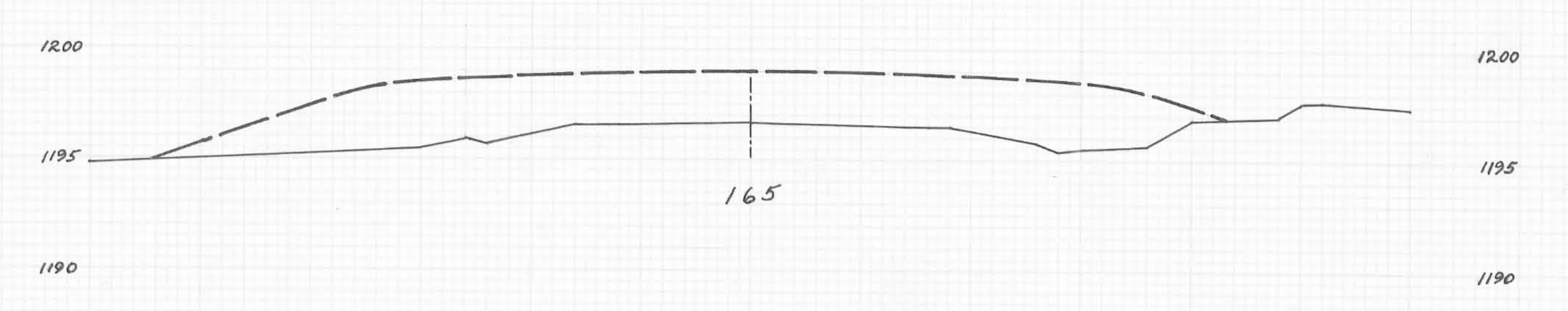
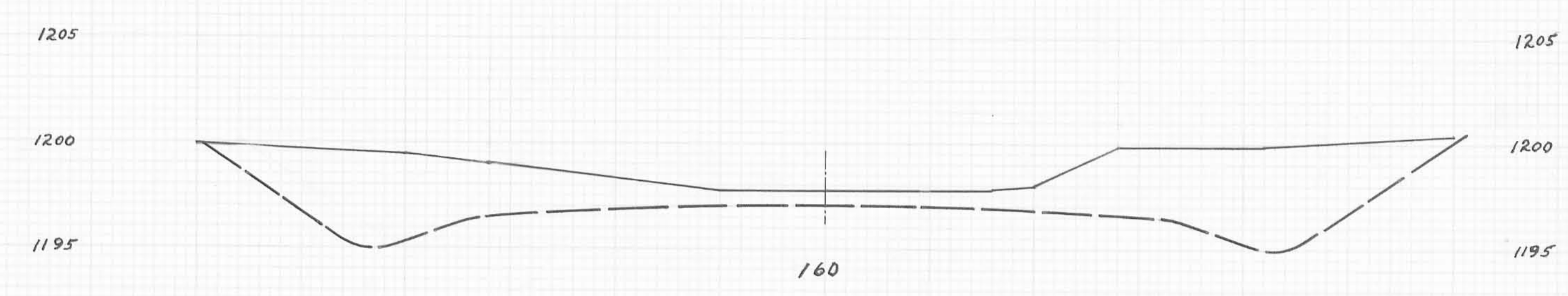
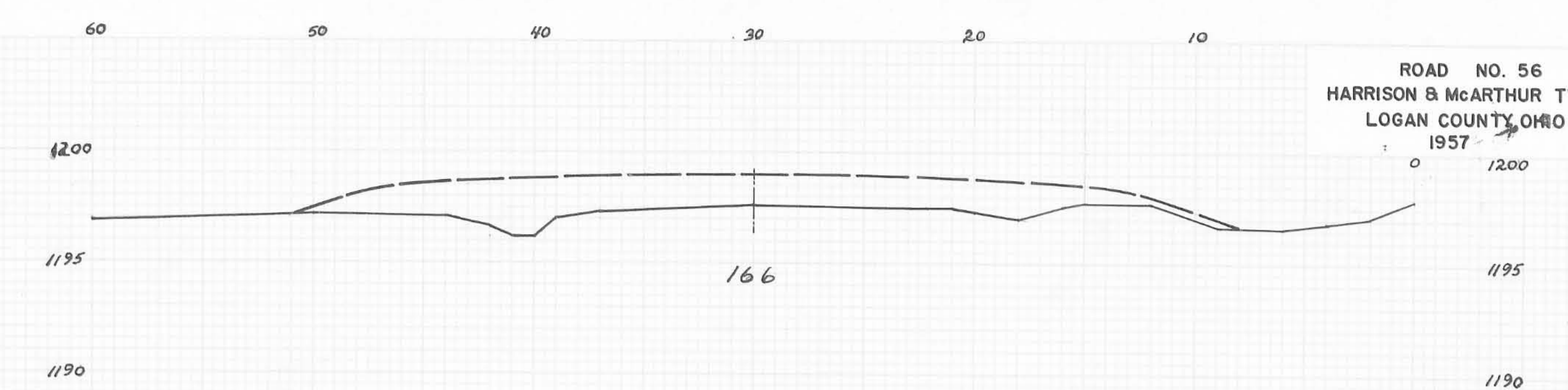
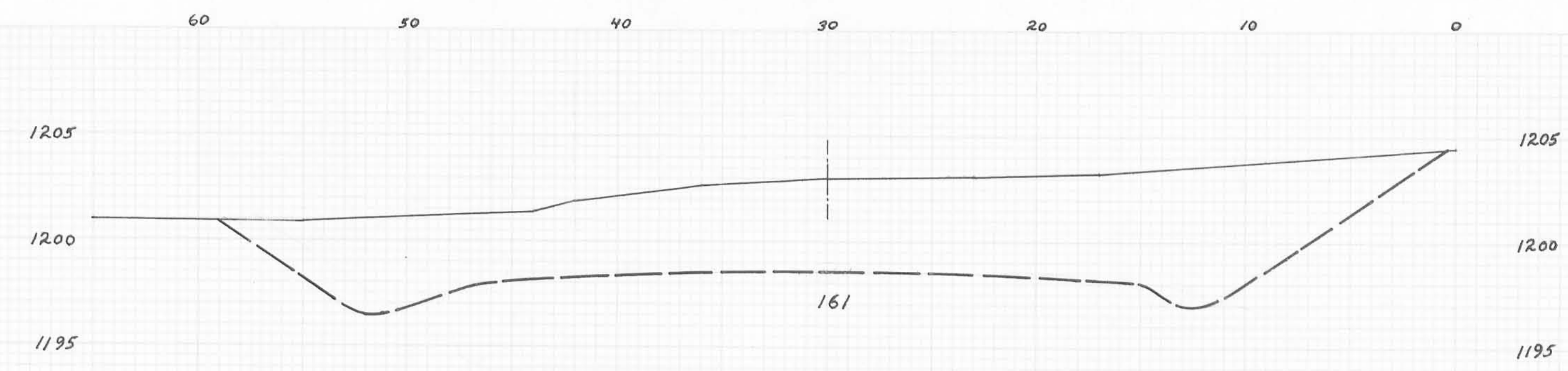

FINAL
 SURVEY

ORIGINAL
 SURVEY

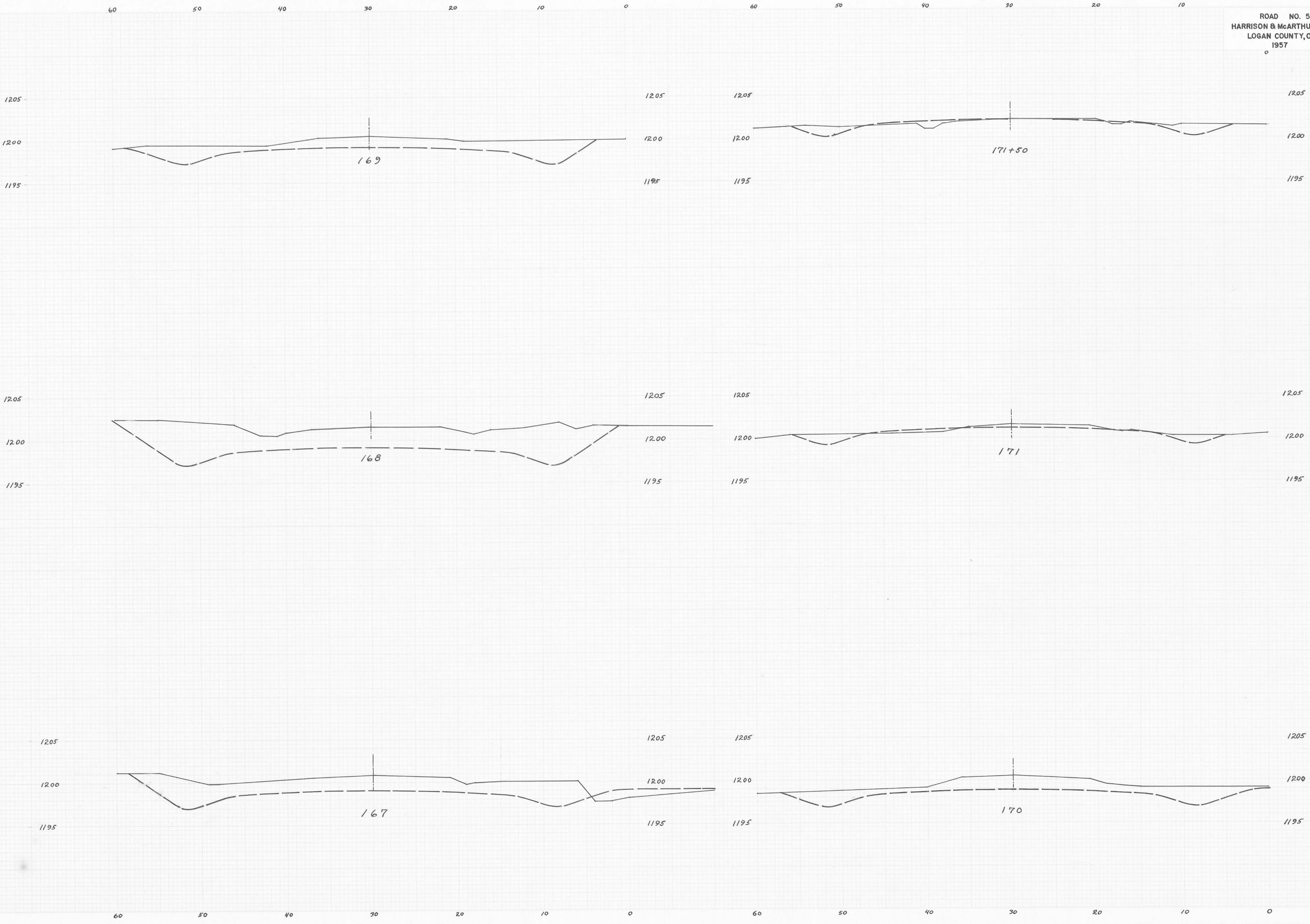

FINAL SURVEY

ORIGINAL SURVEY