

# FAIRVIEW CEMETERY ADDITION

PAVED ROAD

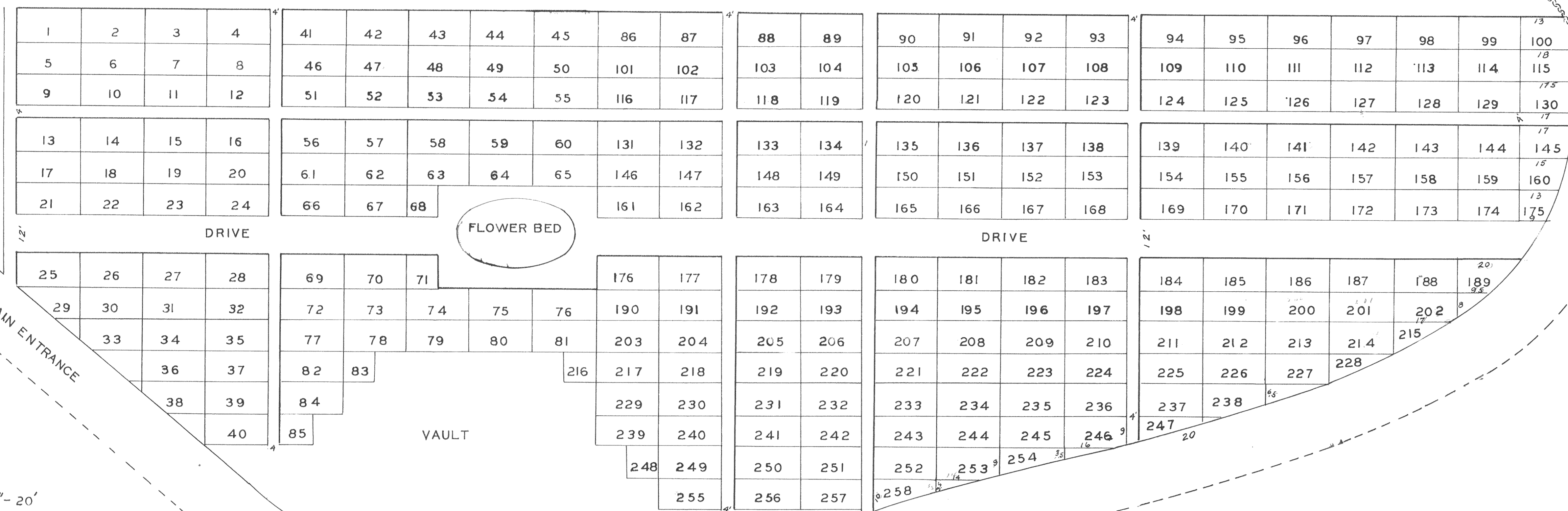

SCALE 1" = 20'

**Dedication**

Know all men by these presents:—  
 That the Trustees of Fair View Cemetery of West Liberty Ohio owners of the land represented in the above plat have caused the above plat and survey to be made by W.H. Montgomery and that we do hereby dedicate to the public use and convenience forever the drives and walks as shown upon above plat.  
 In Testimony whereof the said owners has hereunto set their hand this \_\_\_ day of \_\_\_\_\_ 1925  
 Signed in presence of us.

\_\_\_\_\_  
 \_\_\_\_\_  
 \_\_\_\_\_

Be it remembered that on this \_\_\_ day of \_\_\_\_\_ in the year of our Lord One thousand nine hundred and twenty five before me a notary Public in and for said County personally came the signers of the foregoing dedication and acknowledged the signing thereof to be his voluntary act for the uses and purposes mentioned in testimony whereof, I have hereunto subscribed my name and affixed my official seal on the day and year last mentioned

\_\_\_\_\_  
 Notary Public in and for said County of Logan State of Ohio

**Note**

All lots are 20'x10', half lots 10'x10', all others are as shown on plat Drives are as shown on plat and all walks are 4ft wide.

**Surveyors Certificate**

The annexed plat is a correct representation of the Fairview Cemetery Addition as surveyed and plated by me.

W.H. Montgomery Deputy Surveyor